

F.A.I. RTE.	SECTION	COUNTY	TOTAL SHEETS	SHEET NO.
74		TAZEWELL	1366	1165
STA. 10+375.000		TO STA. 10+375.000		
FED. ROAD DIST. NO. 4 ILLINOIS FED. AID PROJECT				
• 190-11R-2190(13, 14, 14-1R-1)				

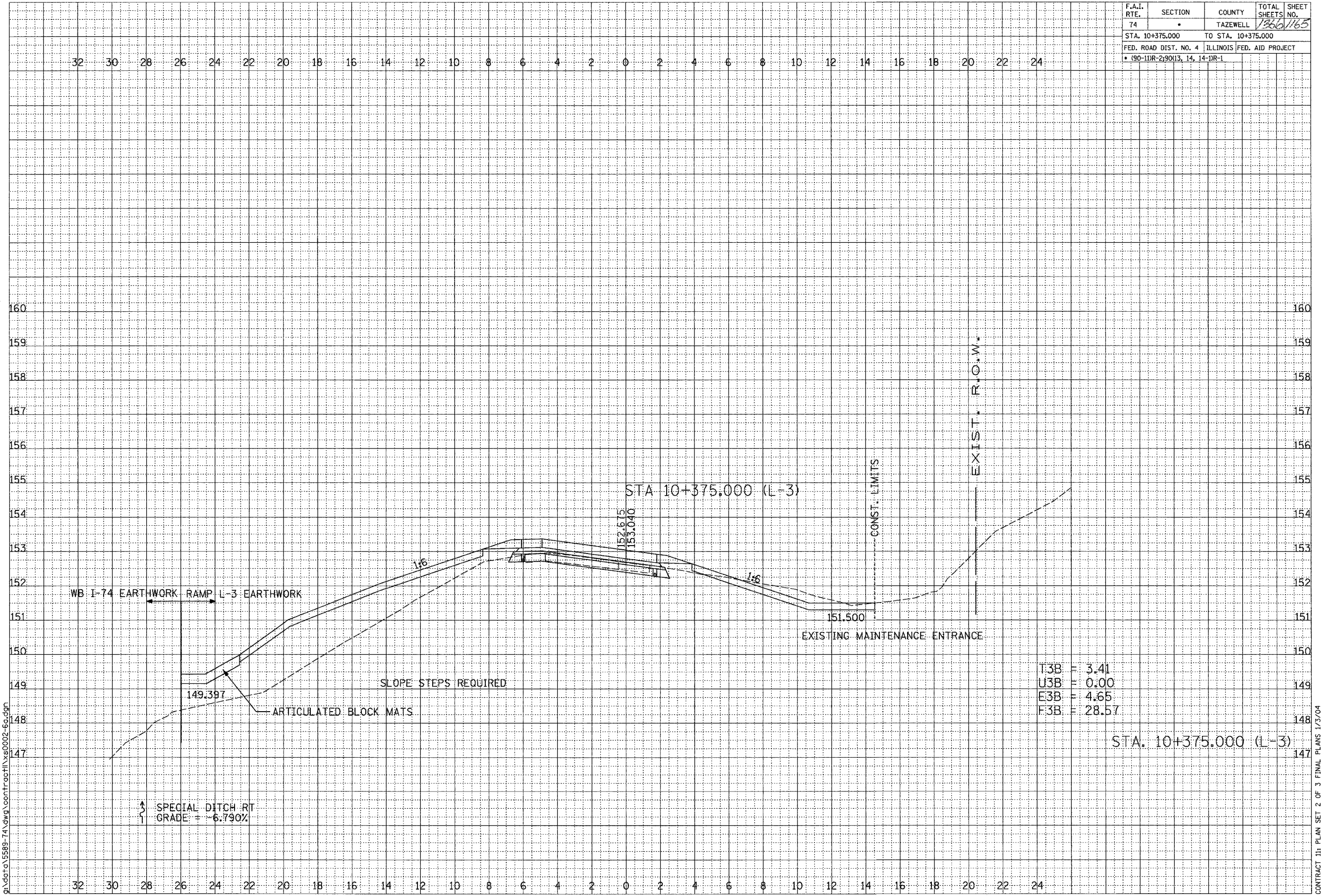

T3B = 3.41  
 U3B = 0.00  
 E3B = 4.65  
 F3B = 28.57

STA. 10+375.000 (L-3)

RAMP L-3  
 SHEET 4 OF 12

FINAL SURVEY	BY	DATE
NOTE BOOK		
AREAS CHECKED		



ORIGINAL SURVEY	BY	DATE
NOTE BOOK		
AREAS CHECKED		

SCALE  
 H 1: 100  
 V 1: 50  
 01/07/2005 09:19:53 AM  
 g:\data\5589-74\dwg\contract\1366\1165\002-6c.dgn

CONTRACT 11: PLAN SET 2 OF 3 FINAL PLANS 1/3/04

\\dgs\contract\1366\1165\002-6c.dgn 01/07/2005 09:25:35 AM