

F.A.I. RTE.	SECTION	COUNTY	TOTAL SHEETS	SHEET NO.
74		TAZEWELL	136	168
STA. 10+475.000		TO STA. 10+500.000		
FED. ROAD DIST. NO. 4		ILLINOIS	FED. AID PROJECT	
• (90-1DR-2)9013, 14, 14-1R-1				

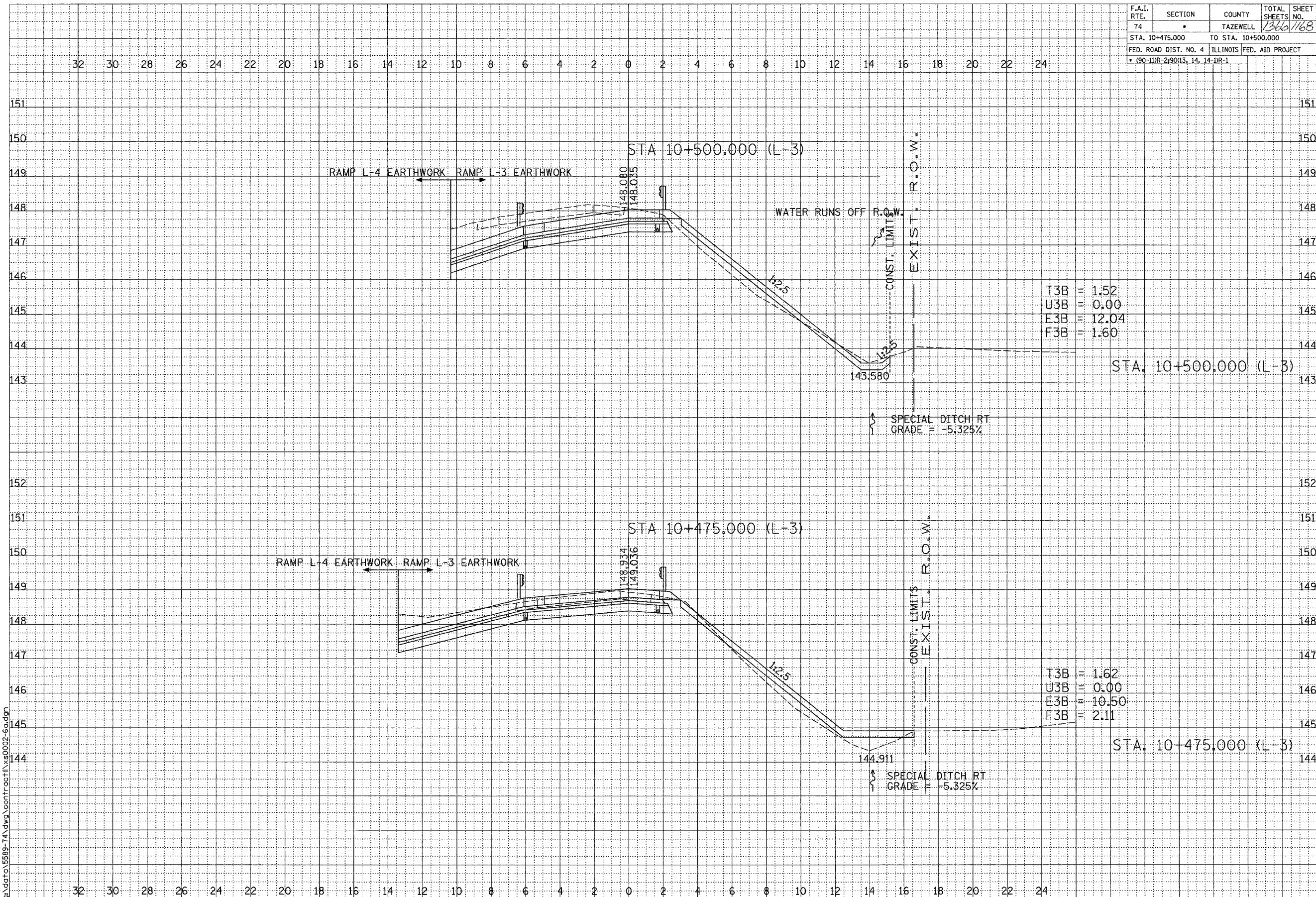

T3B = 1.52
 U3B = 0.00
 E3B = 12.04
 F3B = 1.60

T3B = 1.62
 U3B = 0.00
 E3B = 10.50
 F3B = 2.11

DATE	
BY	
SURVEYED	
PLOTTED	
PRINTED	
AREAS	
CHECKED	
FINAL SURVEY	
NOTE BOOK	
NO.	

DATE	
BY	
SURVEYED	
PLOTTED	
PRINTED	
AREAS	
CHECKED	
ORIGINAL SURVEY	
NOTE BOOK	
NO.	



SCALE
 H 1: 100
 V 1: 50

01/07/2005 09:19:54 AM
 g:\data\5589-74\dwg\contract\14s0002-6g.dgn

CONTRACT 11: PLAN SET 2 OF 3 FINAL PLANS 1/3/04