

68201

36201		TOTAL SHEETS	SHEET NO.
F.A.I. RTE.	SECTION	COUNTY	
74		TAZEWELL	13/16 13/17
STA.	TO STA.		
FED. ROAD DIST. NO.	ILLINOIS FED. AID PROJECT		

•(90-111R-2)90(13,14,14-1)R-1

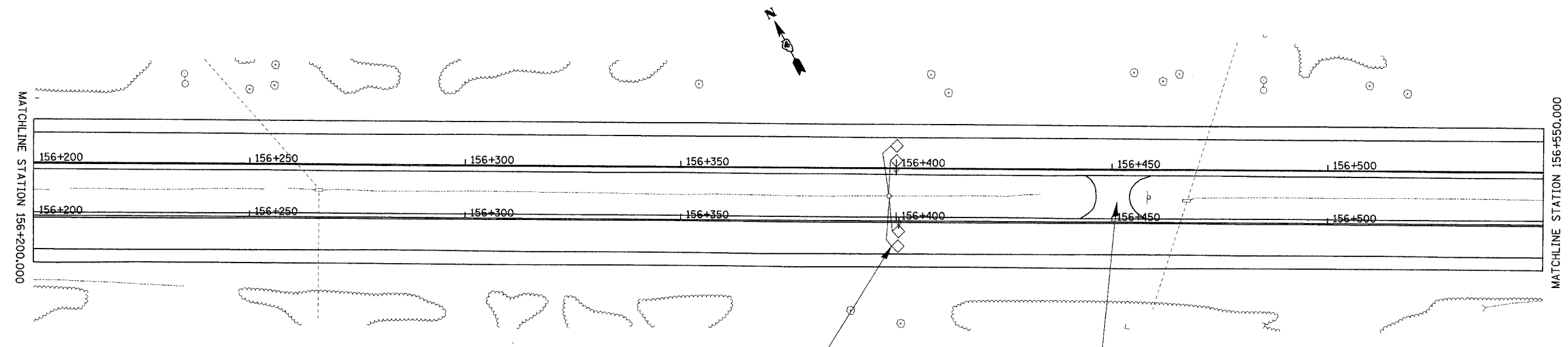

PROPOSED TRAFFIC COUNTER DETECTOR LOOPS
 STA. 156+400.000 EB/WB
 SEE DETAIL FOR TRAFFIC COUNTERS USING
 TERMINAL FACILITY FOR PAY ITEM LISTING AND DETAILS

RECONSTRUCT EXISTING CROSSOVER
 STA. 156+450.000
 SEE TYPICAL SECTIONS FOR RECONSTRUCTION
 DETAILS

cs-projects-174wb-plane.dgn

REVISIONS		ILLINOIS DEPARTMENT OF TRANSPORTATION PROPOSED ROADWAY PLAN STATION 156+200.000 WB TO 156+550.000 WB
NAME	DATE	
		DRAWN BY CEM CHECKED BY DATE 11/09/04