

PROJECT ENGR.: Maureen Addis 309671-3454

DESIGNER: Pattie Conover 309671-3475

CONTRACT NO. 68334

| F.A.P. RTE. | SECTION  | COUNTY    | TOTAL SHEETS | SHEET NO. |
|-------------|----------|-----------|--------------|-----------|
| 310         | (38-2)RS | McDONOUGH | 66           | 1         |

STATE OF ILLINOIS  
DEPARTMENT OF TRANSPORTATION  
DIVISION OF HIGHWAYS

**PROPOSED  
HIGHWAY PLANS**

FAP ROUTE 310 (US 67)  
SECTION (38-2)RS  
PROJECT NHF-0310(091)  
McDONOUGH COUNTY  
C-94-030-03

FOR INDEX OF SHEETS, SEE SHEET NO. 2

HIGHWAY STANDARDS

|           |           |           |
|-----------|-----------|-----------|
| 280001-02 | 635011-01 | 701422-01 |
| 542401    | 667101    | 701426-02 |
| 630001-05 | 701101-01 | 701602-02 |
| 631011-02 | 701106-01 | 701701-04 |
| 631026-02 | 701400-02 | 702001-05 |
| 631033-01 | 701401-03 | 720011    |
| 635001    | 701421-01 | 780001-01 |
| 635006-02 |           | 781001-02 |

ADT 9600 (2002)  
SU = 4.1%  
MU = 2.9%  
OTHER PRINCIPAL ATERIAL  
DESIGN (POSTED) SPEED : 65-45 MPH  
CLASS II TRUCK ROUTE

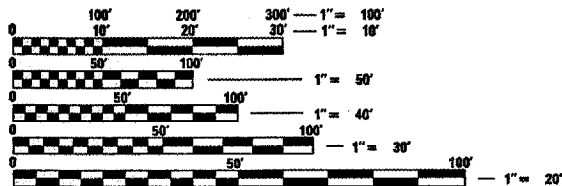

FULL SIZE PLANS HAVE BEEN PREPARED USING STANDARD ENGINEERING SCALES. REDUCED SIZED PLANS WILL NOT CONFORM TO STANDARD SCALES. IN MAKING MEASUREMENTS ON REDUCED PLANS, THE ABOVE SCALES MAY BE USED.

J.U.L.I.E.  
JOINT UTILITY LOCATION INFORMATION FOR EXCAVATION  
1-800-892-0123

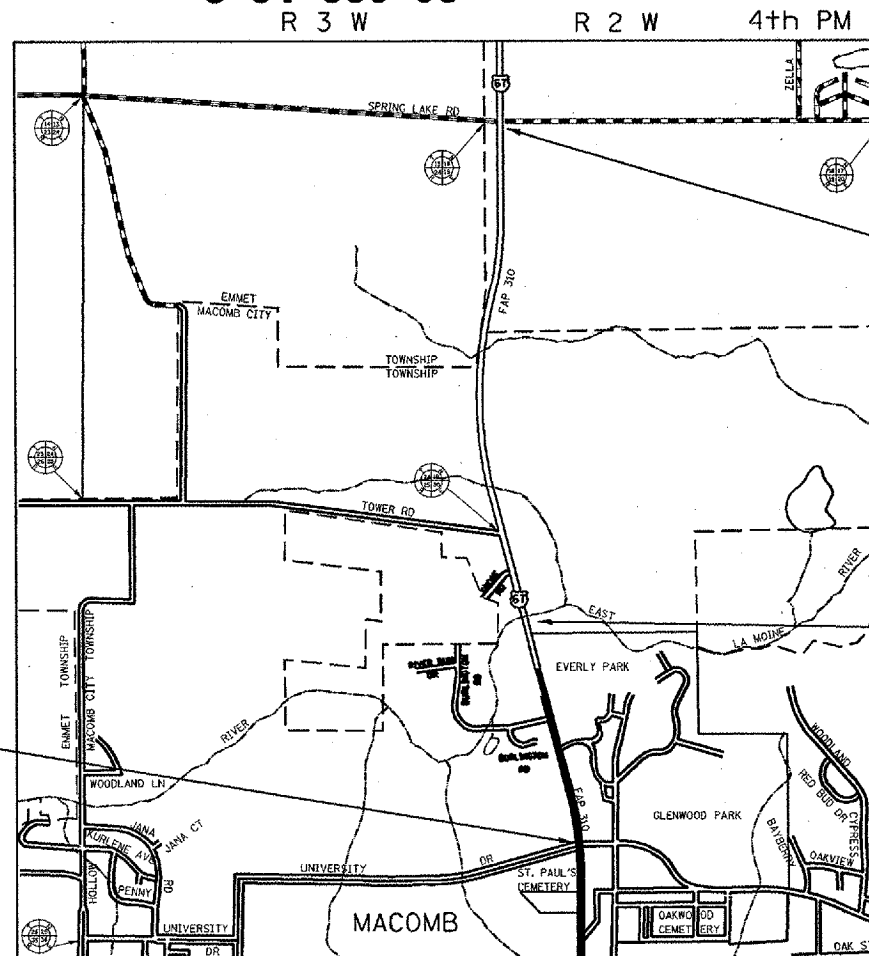

PROJECT BEGINS  
STA 61+60

PROJECT ENDS  
STA 140+42.87

MILLING AND RESURFACING,  
DRAINAGE IMPROVEMENTS,  
EROSION CONTROL, STRIPING,  
AGGREGATE SHOULDERS

BRIDGE OMISSION  
(SB) S.N. 055-0029  
STA. 84+15.06 - 86+85.40  
(NB) S.N. 055-0030  
STA. 83+90.30 - 86+60.64

SUPERPAVE PROJECT  
QC/QA BITUMINOUS

MAP NOT TO SCALE

GROSS LENGTH OF PROJECT = 7882.87 FEET = 1.49 MILES  
NET LENGTH OF PROJECT = 7711.47 FEET = 1.46 MILES

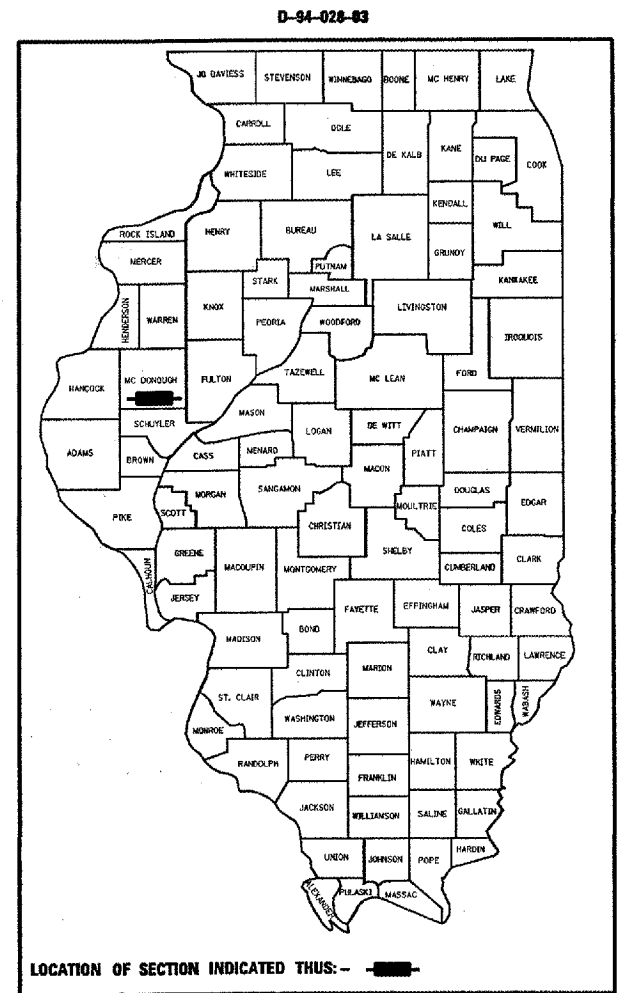

LOCATION OF SECTION INDICATED THIS: - [black rectangle] -



STATE OF ILLINOIS  
DEPARTMENT OF TRANSPORTATION  
DIVISION OF HIGHWAYS

SUBMITTED March 28 2005

*[Signature]*  
DEPUTY DIRECTOR OF HIGHWAYS, REGION ENGINEER

\_\_\_\_\_  
20\_\_\_\_  
ENGINEER OF DESIGN AND ENVIRONMENT

\_\_\_\_\_  
20\_\_\_\_  
DIRECTOR OF HIGHWAYS, CHIEF ENGINEER

**PRINTED BY THE AUTHORITY  
OF THE STATE OF ILLINOIS**