

F.A.P. RTE.	SECTION	COUNTY	TOTAL SHEETS	SHEET NO.
310	138-2RS	MCDONOUGH	66	27
STA. 71+00		TO STA. 85+00		
FED. ROAD DIST. NO.		ILLINOIS FED. AID PROJECT		

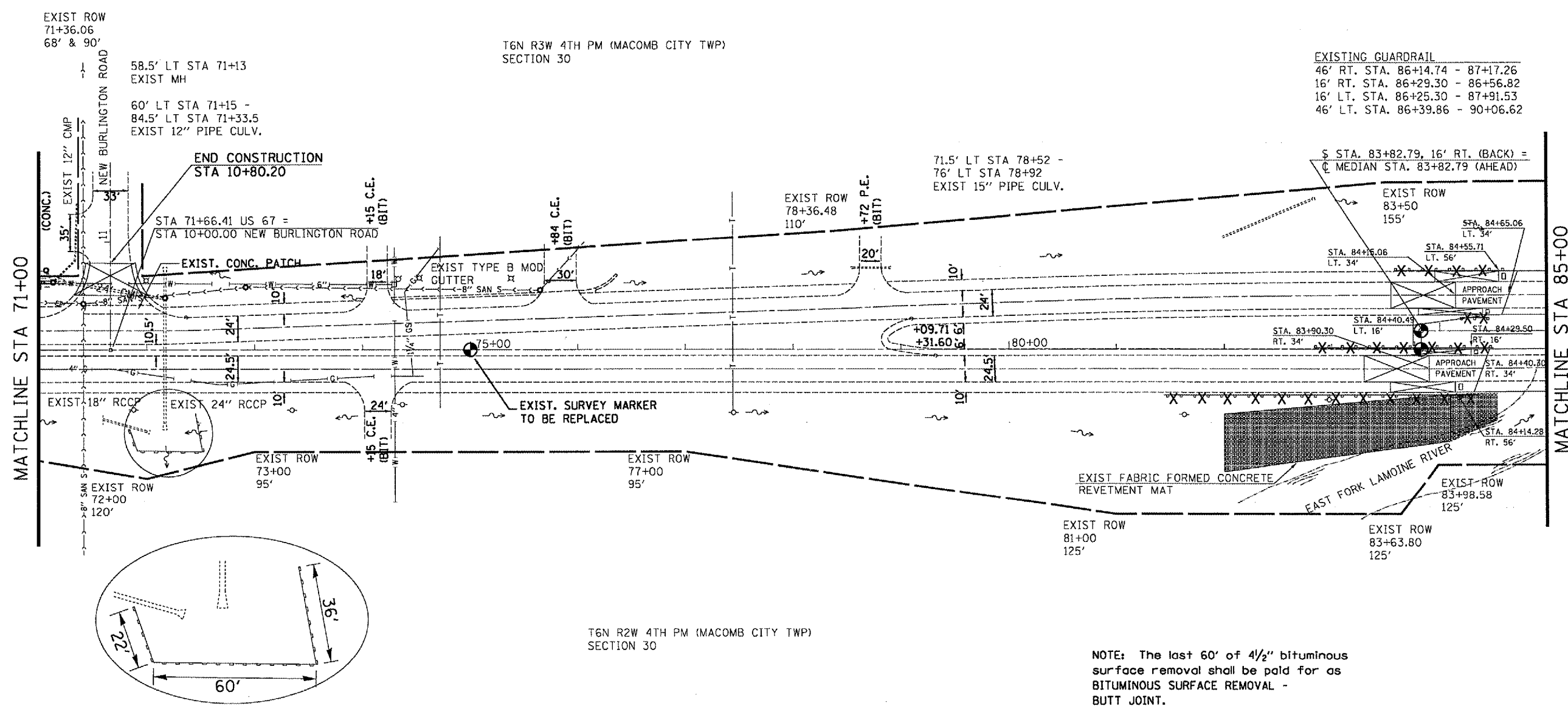

MATCHLINE STA 71+00

MATCHLINE STA 85+00

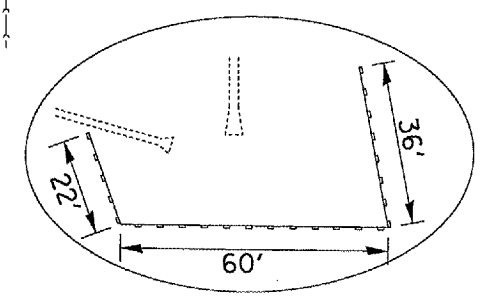

T6N R3W 4TH PM (MACOMB CITY TWP)
SECTION 30

T6N R2W 4TH PM (MACOMB CITY TWP)
SECTION 30

EXISTING GUARDRAIL
46' RT. STA. 86+14.74 - 87+17.26
16' RT. STA. 86+29.30 - 86+56.82
16' LT. STA. 86+25.30 - 87+91.53
46' LT. STA. 86+39.86 - 90+06.62

NOTE: The last 60' of 4 1/2" bituminous surface removal shall be paid for as BITUMINOUS SURFACE REMOVAL - BUTT JOINT.

REMOVAL LEGEND

- BUTT JOINT
- GUARDRAIL REMOVAL
- CULVERT REMOVAL

EROSION CONTROL LEGEND

- PERIMETER EROSION BARRIER
- INLET & PIPE PROTECTION
- GRADE & SHAPE DITCH

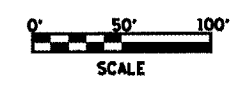

REVISIONS	
NAME	DATE

ILLINOIS DEPARTMENT OF TRANSPORTATION

EXISTING / REMOVAL

STA 71+00 - 85+00

SCALE: VERT. 1" = 50'
HORIZ. 1" = 50'

DATE: _____ DRAWN BY: CADD
CHECKED BY: _____

PLOT DATE: 3/28/2005
 FILE NAME: c:\projects\68334\sheet.dgn
 PLOT SCALE: 1/8"=1'-0"
 REFERENCE: 68334