

F.A.P. RITE	SECTION	COUNTY	TOTAL SHEETS	SHEET NO.
310	138-2/RS	MCDONOUGH	66	36
STA. 85+00 TO STA. 98+50				
FED. ROAD DIST. NO.			ILLINOIS FED. AID PROJECT	

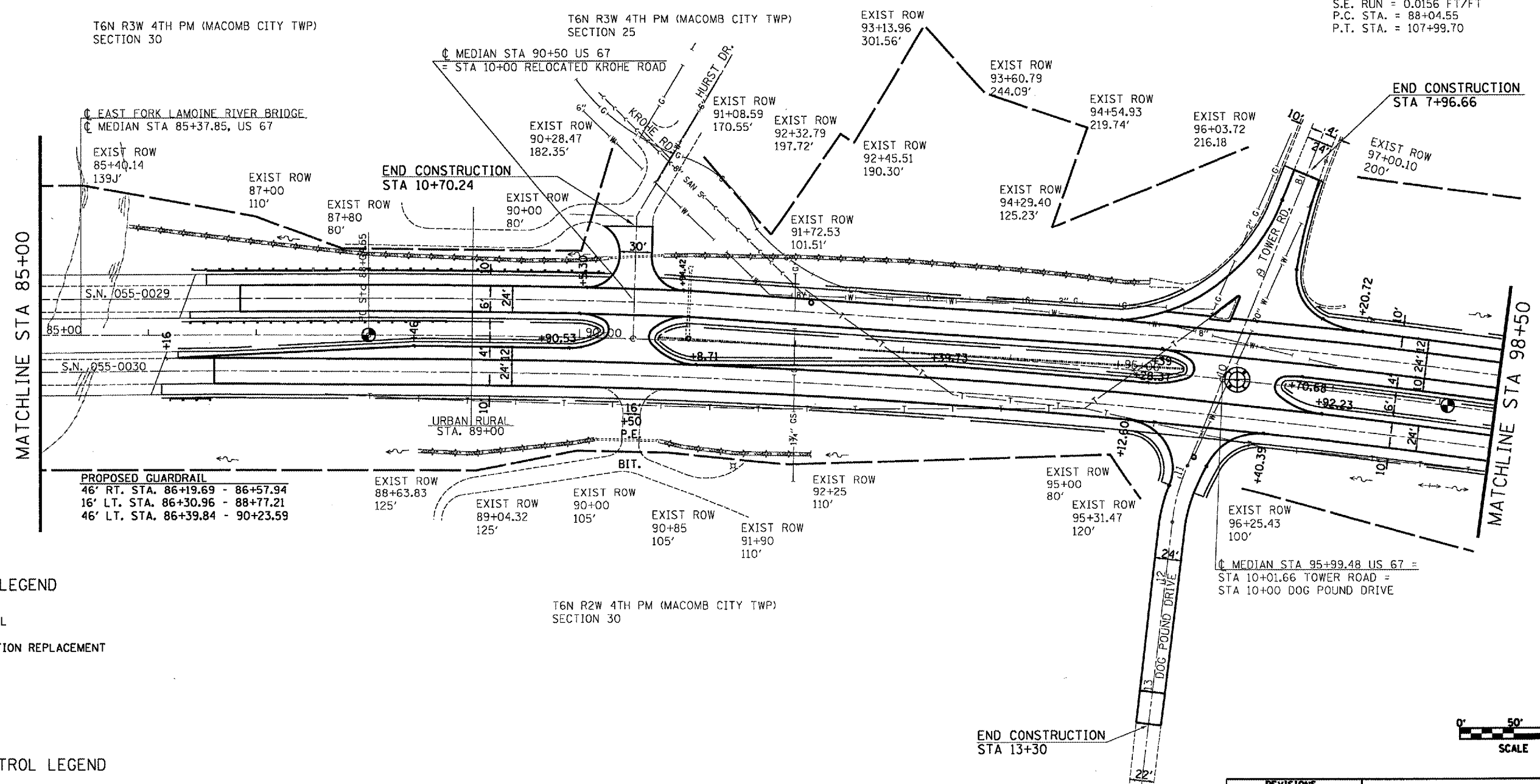

EXIST. CURVE ϕ MEDIAN
 PI STA. = 98+07.83
 Δ = 14° 57' 49" (RT)
 D = 0° 45' 00"
 R = 7,639.44'
 T = 1,003.28'
 L = 1,995.15'
 E = 65.60'
 S.E. RUN = 0.0156 FT/FT
 P.C. STA. = 88+04.55
 P.T. STA. = 107+99.70



PROPOSED GUARDRAIL
 46' RT. STA. 86+19.69 - 86+57.94
 16' LT. STA. 86+30.96 - 88+77.21
 46' LT. STA. 86+39.84 - 90+23.59

URBAN RURAL
 STA. 89+00

T6N R2W 4TH PM (MACOMB CITY TWP)
 SECTION 30

ϕ MEDIAN STA 95+99.48 US 67 =
 STA 10+01.66 TOWER ROAD =
 STA 10+00 DOG POUND DRIVE

PROPOSED LEGEND

- GUARDRAIL
- END SECTION REPLACEMENT
- RIPRAP

EROSION CONTROL LEGEND

- PERIMETER EROSION BARRIER
- INLET & PIPE PROTECTION
- GRADE & SHAPE DITCH



END CONSTRUCTION
 STA 13+30

REVISIONS	
NAME	DATE

ILLINOIS DEPARTMENT OF TRANSPORTATION
PROPOSED
STA 85+00 - 98+50
 SCALE: VERT. 1" = 50'
 HORIZ. 1" = 50'
 DRAWN BY CADD
 CHECKED BY

PLOT DATE = 3/23/2005
 FILE NAME = c:\projects\68334\sheet.dgn
 PLOT SCALE = 1/8" = 1' IN.
 REFERENCE = 1/8"