

F.A.P. RTE.	SECTION	COUNTY	TOTAL SHEETS	SHEET NO.
310	138-2RS	MCDONOUGH	66	39
STA. 126+00		TO STA. 140+00		
FED. ROAD DIST. NO.		ILLINOIS FED. AID PROJECT		

EXIST. CURVE @ MEDIAN
 PI STA. = 131+77.30
 $\Delta = 8^\circ 10' 02''$ (LT)
 $D = 1^\circ 30' 00''$
 $R = 3,819.72'$
 $T = 272.70'$
 $L = 544.48'$
 $E = 9.72'$
 $S.E. RUN = 0.030$ FT/FT
 P.C. STA. = 129+04.60
 P.T. STA. = 134+49.08

T6N R3W 4TH PM (EMMET TWP)
 SECTION 24

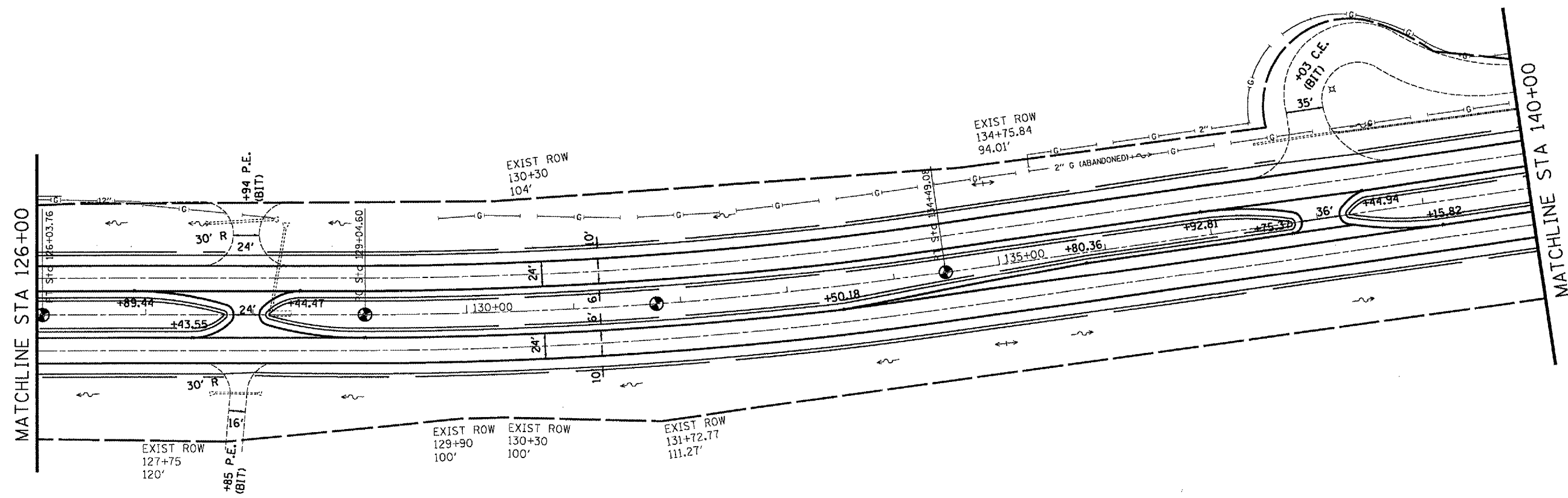

T6N R2W 4TH PM (MACOMB TWP)
 SECTION 19

- | | |
|-------------------------|-------------------------------|
| PROPOSED LEGEND | EROSION CONTROL LEGEND |
| GUARDRAIL | PERIMETER EROSION BARRIER |
| END SECTION REPLACEMENT | INLET & PIPE PROTECTION |
| RIPRAP | GRADE & SHAPE DITCH |

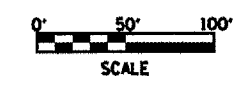

REVISIONS	
NAME	DATE

ILLINOIS DEPARTMENT OF TRANSPORTATION

PROPOSED
STA 126+00 - 140+00

SCALE: VERT. 1" = 50'
 HORIZ. 1" = 50'

DATE _____ DRAWN BY CADD
 CHECKED BY _____

PLOT DATE = 3/23/2006
 FILE NAME = c:\p\projects\68334\sheet.dgn
 PLOT SCALE = 1/8" = 1' IN.
 REFERENCE = #REF#