

F.A.P. RTE.	SECTION	COUNTY	TOTAL SHEETS	SHEET NO.
502		ADAMS	315	29
STA.		TO STA.		
FED. ROAD DIST. NO.		ILLINOIS FED. AID PROJECT		

• E53RS-7, P(RS-2)JN, TS
CONTRACT NO. 72897

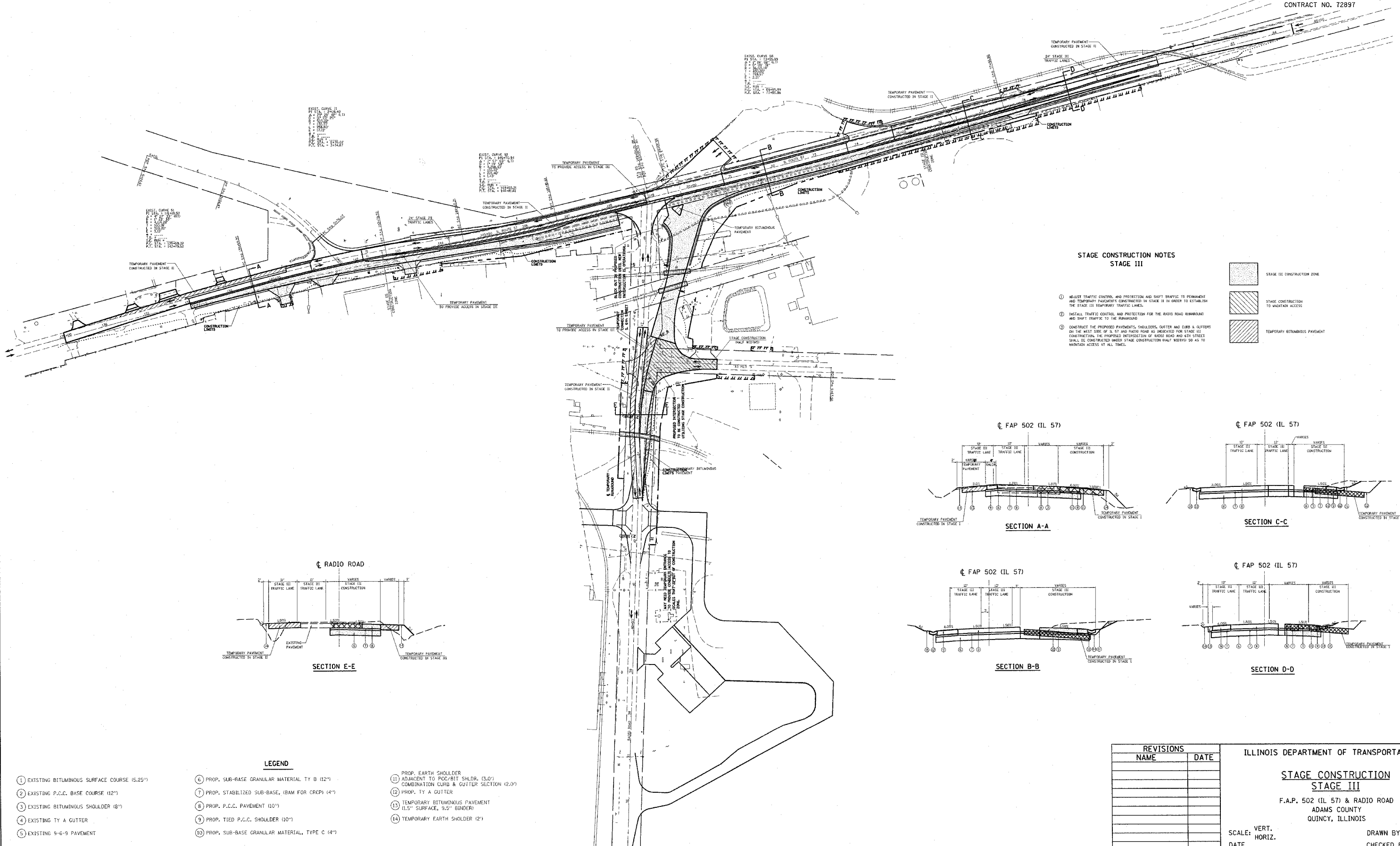

**STAGE CONSTRUCTION NOTES
STAGE III**

- ADJUST TRAFFIC CONTROL AND PROTECTION AND SHIFT TRAFFIC TO PERMANENT AND TEMPORARY PAVEMENTS CONSTRUCTED IN STAGE II IN ORDER TO ESTABLISH THE STAGE III TEMPORARY TRAFFIC LANES.
- INSTALL TRAFFIC CONTROL AND PROTECTION FOR THE RADIO ROAD ROUNDOFF AND SHIFT TRAFFIC TO THE ROUNDOFFS.
- CONSTRUCT THE PROPOSED PAVEMENTS, SHOULDERS, CUTTER AND CURB & GUTTERS ON THE WEST SIDE OF IL 57 AND RADIO ROAD AS INDICATED FOR STAGE III CONSTRUCTION. THE PROPOSED INTERSECTION OF RADIO ROAD AND 4TH STREET SHALL BE CONSTRUCTED UNDER STAGE CONSTRUCTION HALF WIDTH 50' AS TO MAINTAIN ACCESS AT ALL TIMES.

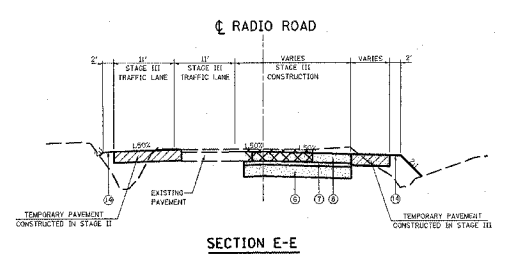
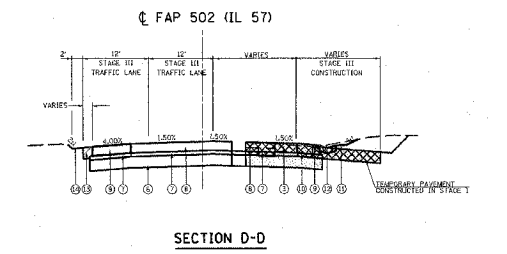
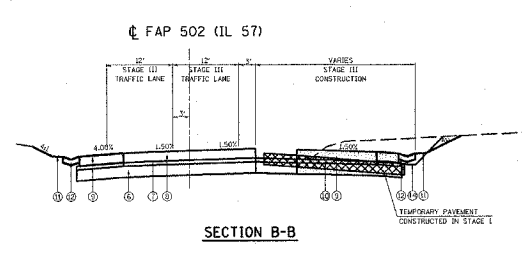
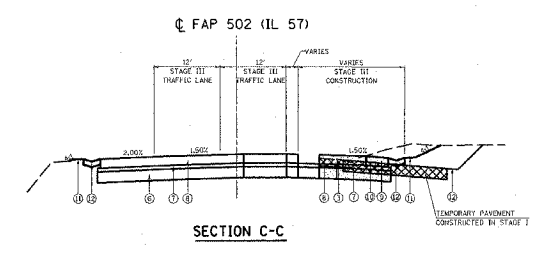
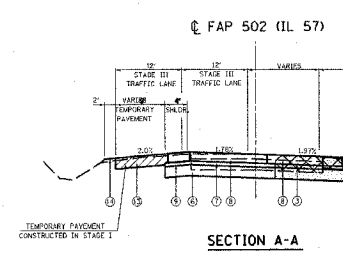
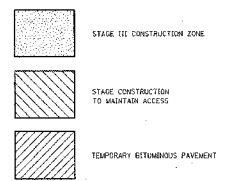

LEGEND

- | | | |
|--|--|--|
| 1 EXISTING BITUMINOUS SURFACE COURSE (5.25") | 6 PROP. SUB-BASE GRANULAR MATERIAL TY B (12") | 11 PROP. EARTH SHOULDER ADJACENT TO PCC/BIT SHDR. (3.0') |
| 2 EXISTING P.C.C. BASE COURSE (12") | 7 PROP. STABILIZED SUB-BASE, (BAM FOR CRCP) (4") | 12 PROP. TY A GUTTER |
| 3 EXISTING BITUMINOUS SHOULDER (8") | 8 PROP. P.C.C. PAVEMENT (10") | 13 TEMPORARY BITUMINOUS PAVEMENT (1.5" SURFACE, 9.5" BINDER) |
| 4 EXISTING TY A GUTTER | 9 PROP. TIED P.C.C. SHOULDER (10") | 14 TEMPORARY EARTH SHOULDER (2') |
| 5 EXISTING 9-6-9 PAVEMENT | 10 PROP. SUB-BASE GRANULAR MATERIAL, TYPE C (4") | |

REVISIONS	
NAME	DATE

ILLINOIS DEPARTMENT OF TRANSPORTATION

**STAGE CONSTRUCTION
STAGE III**

F.A.P. 502 (IL 57) & RADIO ROAD
ADAMS COUNTY
QUINCY, ILLINOIS

SCALE: VERT. _____
HORIZ. _____

DATE _____ DRAWN BY _____
CHECKED BY _____

c:\projects\d653004\woolpert_080204\radio rd stage 3.dgn
 2/23/2005
 *REF01