

F.A. RTE.	SECTION	COUNTY	TOTAL SHEET NO.
D-6 ITS #1	SANGAMON		7
STA.		TO STA.	
FED. ROAD DIST. NO.	ILLINOIS	FED. AID PROJECT	

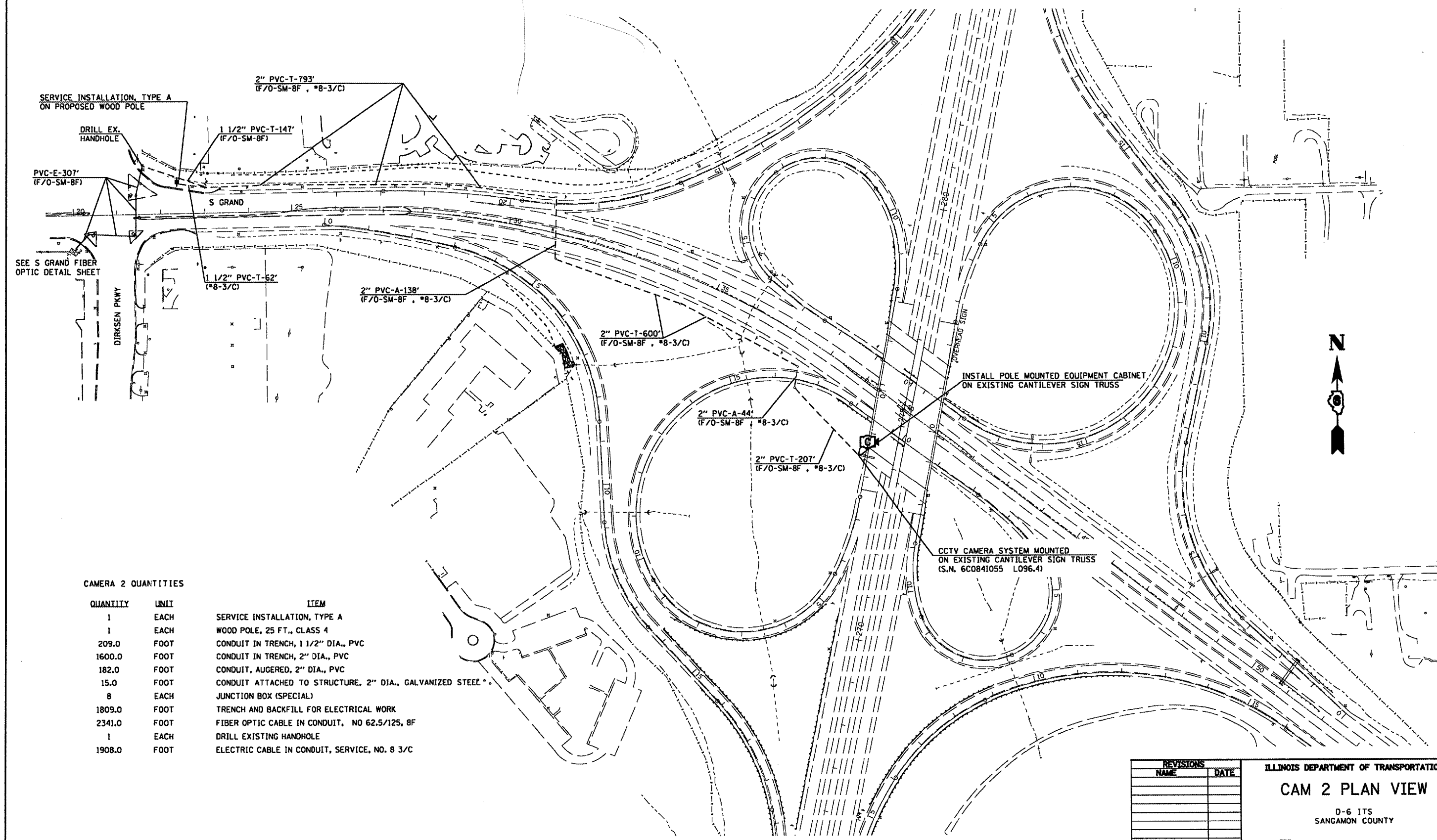

CAMERA 2 QUANTITIES

QUANTITY	UNIT	ITEM
1	EACH	SERVICE INSTALLATION, TYPE A
1	EACH	WOOD POLE, 25 FT., CLASS 4
209.0	FOOT	CONDUIT IN TRENCH, 1 1/2" DIA., PVC
1600.0	FOOT	CONDUIT IN TRENCH, 2" DIA., PVC
182.0	FOOT	CONDUIT, AUGERED, 2" DIA., PVC
15.0	FOOT	CONDUIT ATTACHED TO STRUCTURE, 2" DIA., GALVANIZED STEEL *
8	EACH	JUNCTION BOX (SPECIAL)
1809.0	FOOT	TRENCH AND BACKFILL FOR ELECTRICAL WORK
2341.0	FOOT	FIBER OPTIC CABLE IN CONDUIT, NO 62.5/125, 8F
1	EACH	DRILL EXISTING HANDHOLE
1908.0	FOOT	ELECTRIC CABLE IN CONDUIT, SERVICE, NO. 8 3/C

REVISIONS	
NAME	DATE

ILLINOIS DEPARTMENT OF TRANSPORTATION
CAM 2 PLAN VIEW
 D-6 ITS
 SANGAMON COUNTY
 SCALE: VERT. 1" = 100'
 HORIZ. 1" = 100'
 DATE _____ DRAWN BY KDA
 CHECKED BY _____

PLOT DATE
 FILE NAME
 USER NAME