

F.A. RTE.	SECTION	COUNTY	TOTAL SHEETS	SHEET NO.
	D-6 ITS #1	SANGAMON		11
STA.	TO STA.			
FED. ROAD DIST. NO.	ILLINOIS FED. AID PROJECT			

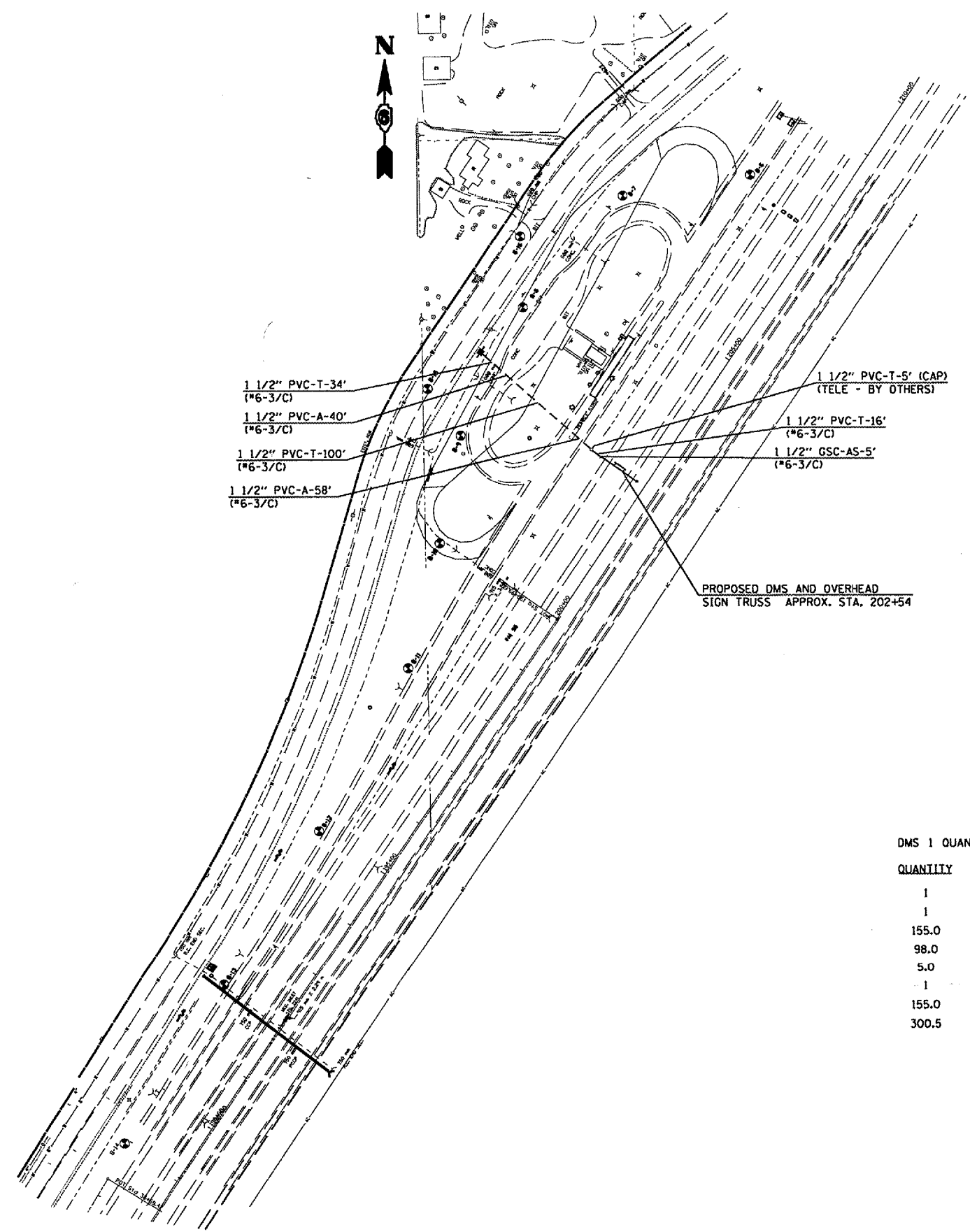

DMS 1 QUANTITIES

QUANTITY	UNIT	ITEM
1	EACH	SERVICE INSTALLATION, TYPE A ✓
1	EACH	WOOD POLE, 25 FT., CLASS 4 ✓
155.0	FOOT	CONDUIT IN TRENCH, 1 1/2" DIA., PVC ✓
98.0	FOOT	CONDUIT, AUGERED, 1 1/2" DIA., PVC ✓
5.0	FOOT	CONDUIT ATTACHED TO STRUCTURE, 1 1/2" DIA., GALVANIZED STEEL ✓
1	EACH	JUNCTION BOX (SPECIAL) ✓
155.0	FOOT	TRENCH AND BACKFILL FOR ELECTRICAL WORK ✓
300.5	FOOT	ELECTRIC CABLE IN CONDUIT, SERVICE, NO. 6 3/C ✓

REVISIONS	
NAME	DATE

ILLINOIS DEPARTMENT OF TRANSPORTATION

**DMS 1 PLAN VIEW**

D-6 ITS  
SANGAMON COUNTY

SCALE: VERT. 1" = 100'  
HORIZ. 1" = 100'  
DATE MAY 2005

DRAWN BY KDA  
CHECKED BY

DATE: \_\_\_\_\_  
 PLOT NAME: \_\_\_\_\_  
 PLOT SCALE: \_\_\_\_\_  
 USER NAME: \_\_\_\_\_