

steffenmk
 10/26/2004
 c:\projects\74048d\02904pa.dgn

FAP NO.	SECTION	COUNTY	TOTAL SHEETS	SHEET NO.
821		JEFFERSON	11	7
FED. ROAD DIST. NO. 1		ILLINOIS	FED. AID PROJECT NO.	

CONTRACT NO. 74048
 (13-2)RS-2,13ZRS-3

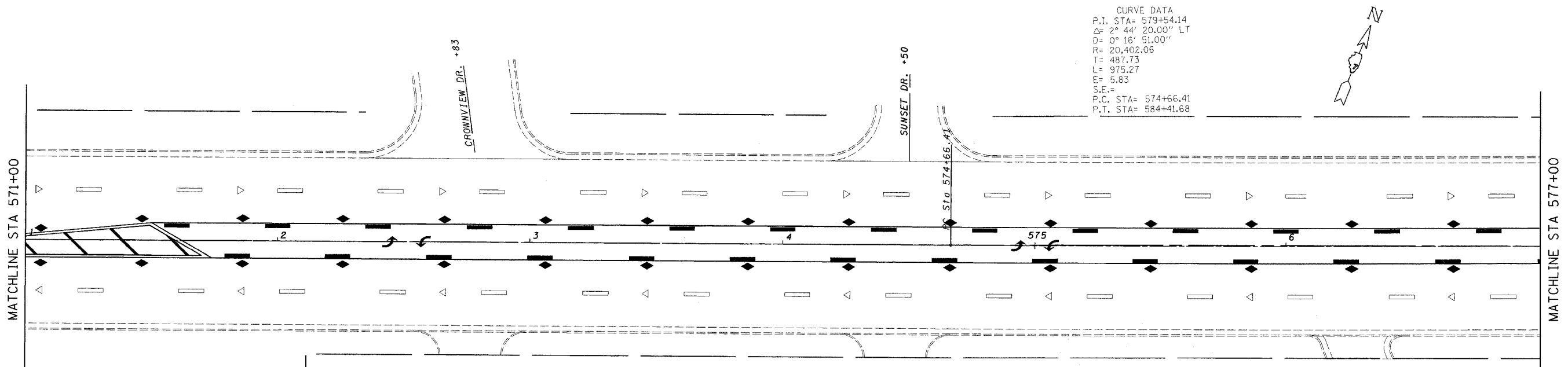
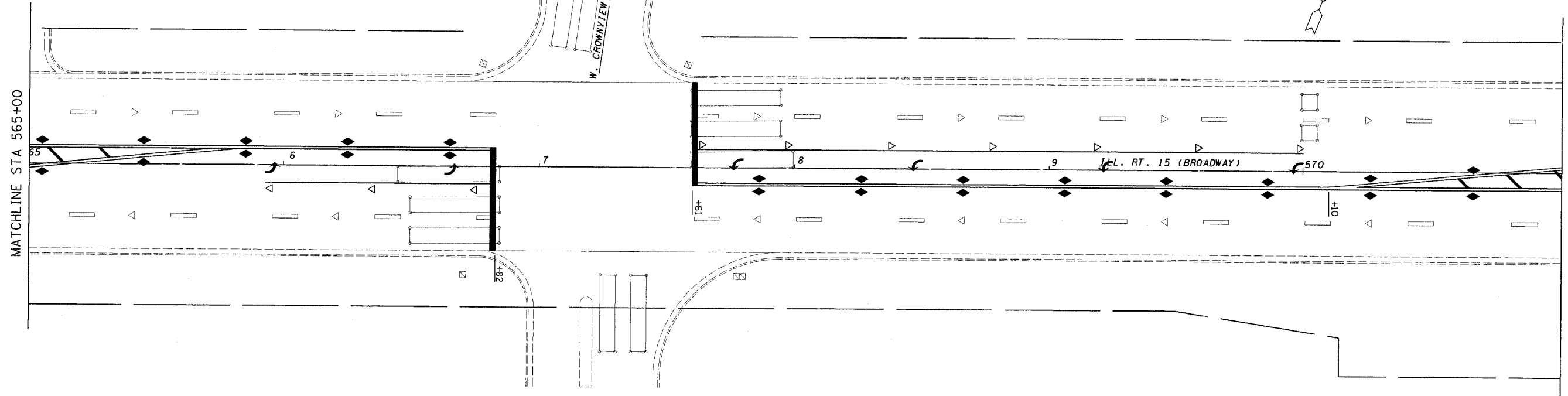

CURVE DATA
 P.I. STA= 579+54.14
 $\Delta I = 2^\circ 44' 20.00''$ LT
 $D = 0^\circ 16' 51.00''$
 $R = 20,402.06$
 $L = 487.73$
 $E = 975.27$
 $S.E. = 5.83$
 $S.F. =$
 P.C. STA= 574+66.41
 P.T. STA= 584+41.68

REVISIONS	
NAME	DATE

ILLINOIS DEPARTMENT OF TRANSPORTATION

**STA. 565 + 00
 TO
 STA. 577 + 00**

SCALE: VERT. _____
 HORIZ. _____

DATE _____ DRAWN BY _____
 CHECKED BY _____