

76563

PART OF THE S.W. 1/4 OF SECTION 28, T2S, R8W, OF THE 3RD PM, ST. CLAIR COUNTY, ILLINOIS

COORDINATES SHOWN HEREON ARE BASED ON SURVEY CONTROL DATA AS PROVIDED BY THE ILLINOIS DEPARTMENT OF TRANSPORTATION.

COORDINATE TABLE			
STATION	OFFSET	NORTH	EAST
24+099.890	5.836 LT	184406.4392	715054.3866
23+890.001	18.287 LT	184196.5121	715042.2709
23+890.001	22.859 LT	184196.5048	715037.6989
23+920.480	18.287 LT	184226.9921	715042.2223
23+920.480	22.859 LT	184226.9848	715037.6503
23+941.759	24.385 RT	184248.3380	715084.8603
23+941.759	22.861 RT	184248.3356	715083.3363
23+972.239	24.385 RT	184278.8181	715084.8117
23+972.239	22.861 RT	184278.8156	715083.2877
24+101.780	22+861 RT	184408.3557	715083.0809

BEARINGS SHOWN HEREON ARE BASED ON SURVEY CONTROL DATA AS PROVIDED BY THE ILLINOIS DEPARTMENT OF TRANSPORTATION.



LEGEND

CLASSIFICATION OF BUILDINGS

- C** = COMMERCIAL
- R** = RESIDENTIAL
- G** = GARAGE
- S** = SHED
- B** = BARN
- MBH** = MOBILE HOME
- APT** = APARTMENT

SECTION CORNER

QUARTER SECTION CORNER

EXISTING CENTERLINE
EXISTING RIGHT OF WAY LINE
EXISTING EASEMENT LINE
PROPOSED CENTERLINE
PROPOSED RIGHT OF WAY LINE
PROPOSED TEMPORARY EASEMENT LINE
PROPOSED PERMANENT EASEMENT LINE
SECTION LINE
QUARTER SECTION LINE
QUARTER QUARTER SECTION LINE
PROPERTY (DEED) LINE
APPL
APPROXIMATE PROPERTY LINE

MEASURED DIMENSION
121.456 m
123.456 m (COMP)
COMPUTED DIMENSION
(405.04')
RECORDED DIMENSION
(123.45)
FOUND IRON PIPE OR IRON ROD
SET 5/8 INCH IRON ROD
PERMANENT SURVEY MONUMENT
I.D.O.T. STD. 2135
(TO BE SET BY OTHERS)
CUT CROSS FOUND OR SET

STAKING OF PROPOSED RIGHT OF WAY. SET 5/8 INCH METAL ROD WITH DIVISION OF HIGHWAY SURVEY MARKER TO MONUMENT THE POSITION SHOWN. IDENTIFIED BY INSCRIPTION DATA AND SURVEYORS REGISTRATION NUMBER.

STAKING OF PROPOSED RIGHT OF WAY IN CULTIVATED AREAS. SET 5/8 INCH METAL ROD WITH DIVISION OF HIGHWAY SURVEY MARKER 20 INCHES BELOW GROUND SURFACE TO MONUMENT THE POSITION SHOWN. IDENTIFIED BY INSCRIPTION DATA AND SURVEYORS REGISTRATION NUMBER.

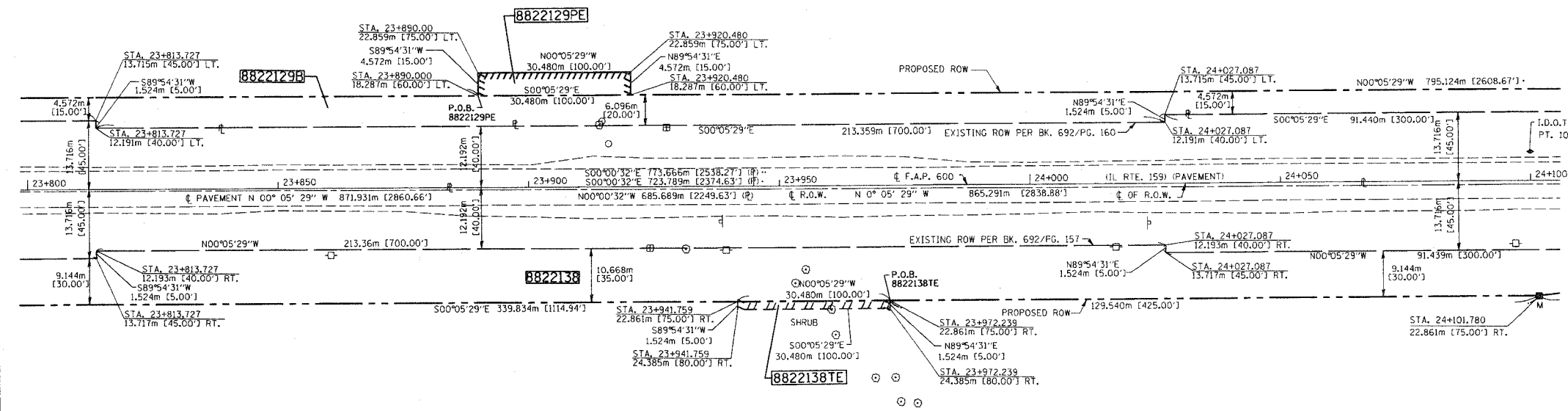

STATE OF ILLINOIS)
COUNTY OF ST. CLAIR) SS

THIS IS TO CERTIFY THAT I, EDGAR M. BARNAL AN ILLINOIS PROFESSIONAL LAND SURVEYOR, HAS SURVEYED THE PLAT OF HIGHWAYS SHOWN HEREON IN SECTION 28, TOWNSHIP 2 SOUTH, RANGE 8 WEST, OF THE THIRD PRINCIPAL MERIDIAN, ST. CLAIR COUNTY, THAT THE SURVEY IS TRUE AND COMPLETE AS SHOWN TO THE BEST OF MY KNOWLEDGE AND BELIEF, THAT THE PLAT CORRECTLY REPRESENTS SAID SURVEY, THAT ALL MONUMENTS FOUND AND ESTABLISHED ARE OF PERMANENT QUALITY AND OCCUPY THE POSITIONS SHOWN THEREON AND THAT THE MONUMENTS ARE SUFFICIENT TO ENABLE THE SURVEY TO BE RETRACED, MADE FOR THE DEPARTMENT OF TRANSPORTATION, STATE OF ILLINOIS.

DATED 9/15/2004
Edgar M. Barnal
EDGAR M. BARNAL, PLS #2750

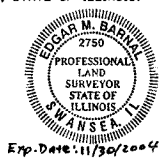

RIGHT OF WAY ESTABLISHED FOR ILLINOIS ROUTE 159 USING INFORMATION SUPPLIED BY THE ILLINOIS DEPARTMENT OF TRANSPORTATION AND PLAT BOOK 28 ON PAGE 9 & 10

THOUVENOT, WADE & MOERCHEN, INC.
4940 OLD COLLINSVILLE ROAD
SWANSEA, ILLINOIS 62226
(618) 624-4488

ILLINOIS DEPARTMENT OF TRANSPORTATION
PLAT OF HIGHWAYS
FAP ROUTE 600 (IL 159)
SECTION (45,46,51) RS-3
ST. CLAIR COUNTY
JOB NO. R-98-022-98
STATION 23+800 TO STATION 24+100

SCALE 1:500

ILLINOIS DEPARTMENT OF TRANSPORTATION
DIVISION OF HIGHWAYS/DISTRICT 8
1102 EASTPORT PLAZA DRIVE
COLLINSVILLE, ILLINOIS 62234-6198

SHEET 09 OF 90

SHEET 1 OF 90 IS A COVER SHEET

PARCEL NO.	OWNER	TOTAL HOLDING	R.O.W. REQUIRED	PREVIOUSLY DEDICATED	REMAINDER	EASEMENTS		EASEMENT PURPOSE	PERMANENT TAX NUMBER	PROPERTY ACQUIRED BY
						TEMP	PERM			
8822129	EDWARD J. PARKER, AS TRUSTEE OF EDWARD J. PARKER DECLARATION OF TRUST (1/2 INTEREST) ELEANOR H. PARKER AS TRUSTEE OF ELEANOR H. PARKER DECLARATION OF TRUST (1/2 INTEREST) TITLE REPORT NO. SC-2051	166.8393 AC 7,267,519 SF	6,426 SF 1,3575 AC 59,131 SF		165.3343 AC 7,201,962 SF	0.1475 AC 2,416 SF	0.0344 AC 1,500 SF	GRADING AND DRAINAGE	17-28-300-002 17-33-100-015 17-33-100-008 17-33-100-017	BK. 3967 PG. 1586
8822138	CHARLES J. HARBAUGH AND DEBRA A. HARBAUGH TITLE REPORT NO. SC-2031	190.7823 AC 8,310,477 SF	3,1787 AC 138,465 SF	2,0340 AC 88,600 SF	187.6036 AC 8,172,012 SF	0.0115 AC 500 SF	0.0459 AC 2,000 SF	GRADING AND DRAINAGE	17-28-300-009 17-28-300-010 17-28-400-005	BK. 3867 PG. 2353

DATE: 9/15/2004
SCALE: 1:500
SHEET: 09 OF 90

DATE: 9/15/2004