

F&P ROUTE	SECTION	COUNTY	TOTAL SHEETS	SHEET NO.
789	1T	MADISON	15	4
STA. TO STA.		CONTRACT NO.: 76648		



Exlst. Curve TESTCL1
 PI Sta. 220+69.50
 $\Delta = 36^\circ 25' 12''$ (LT)
 $D = 3^\circ 09' 15''$
 $T = 597.60'$
 $R = 1,816.55'$
 $L = 1,154.68'$
 $E = 95.77'$
 PC Sta. 214+71.90
 PT Sta. 226+26.58

DATE	BY

SURVEYED
 PLOTTED
 CHECKED
 NOTE BOOK NO. _____
 DATE OF CHECK _____
 CADD FILE NAME _____

LEGEND

- DITCH CHECK
- INLET PROTECTION

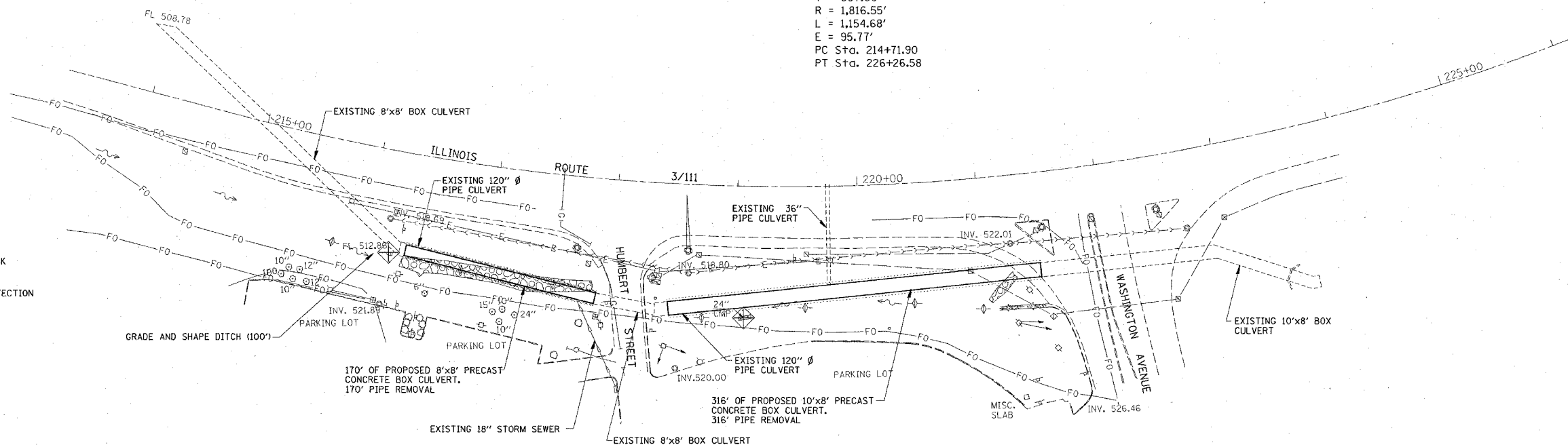

DATE	BY

PROFILE SURVEYED
 PLOTTED
 CHECKED
 NOTE BOOK NO. _____
 DATE OF CHECK _____
 STRUCTURE NOTATION CHRD _____

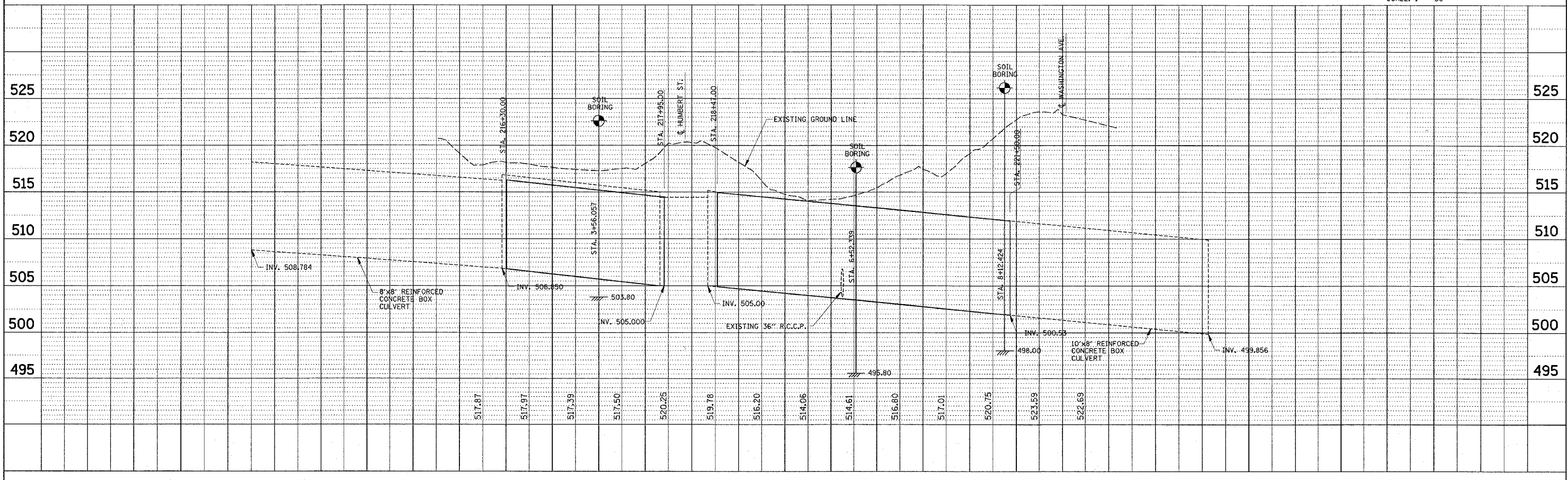

PLOT DATE: 3/30/2005