

FAI ROUTE	SECTION	COUNTY	TOTAL SHEETS	SHEET NO.
64	82-TRS-1, 82-THB-1, 2I	ST. CLAIR	89	19
STA. 740+00		TO STA. 755+00		
CONTRACT NO.: 76813				

PLAN	DESIGNED	DATE
NO.	BY	
	CHECKED	
	DATE	
	FILE NAME	

EXIST. CURVE 182-1
 PI STA. = 746+87.12
 $\Delta = 32^\circ 48' 00''$ (LT)
 $D = 1^\circ 15' 00''$
 $R = 4,583.66'$
 $T = 1,349.05'$
 $L = 2,624.00'$
 $E = 194.40'$
 $\phi = \text{-----}$
 $T.R. = \text{-----}$
 $S.E. RUN = \text{-----}$
 $P.C. STA. = 733+38.08$
 $P.T. STA. = 759+62.08$

BEGIN PROJECT - STA. 744+30
 (SEE WEST END BUTT JOINT DETAIL)

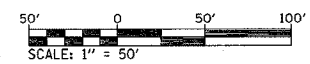
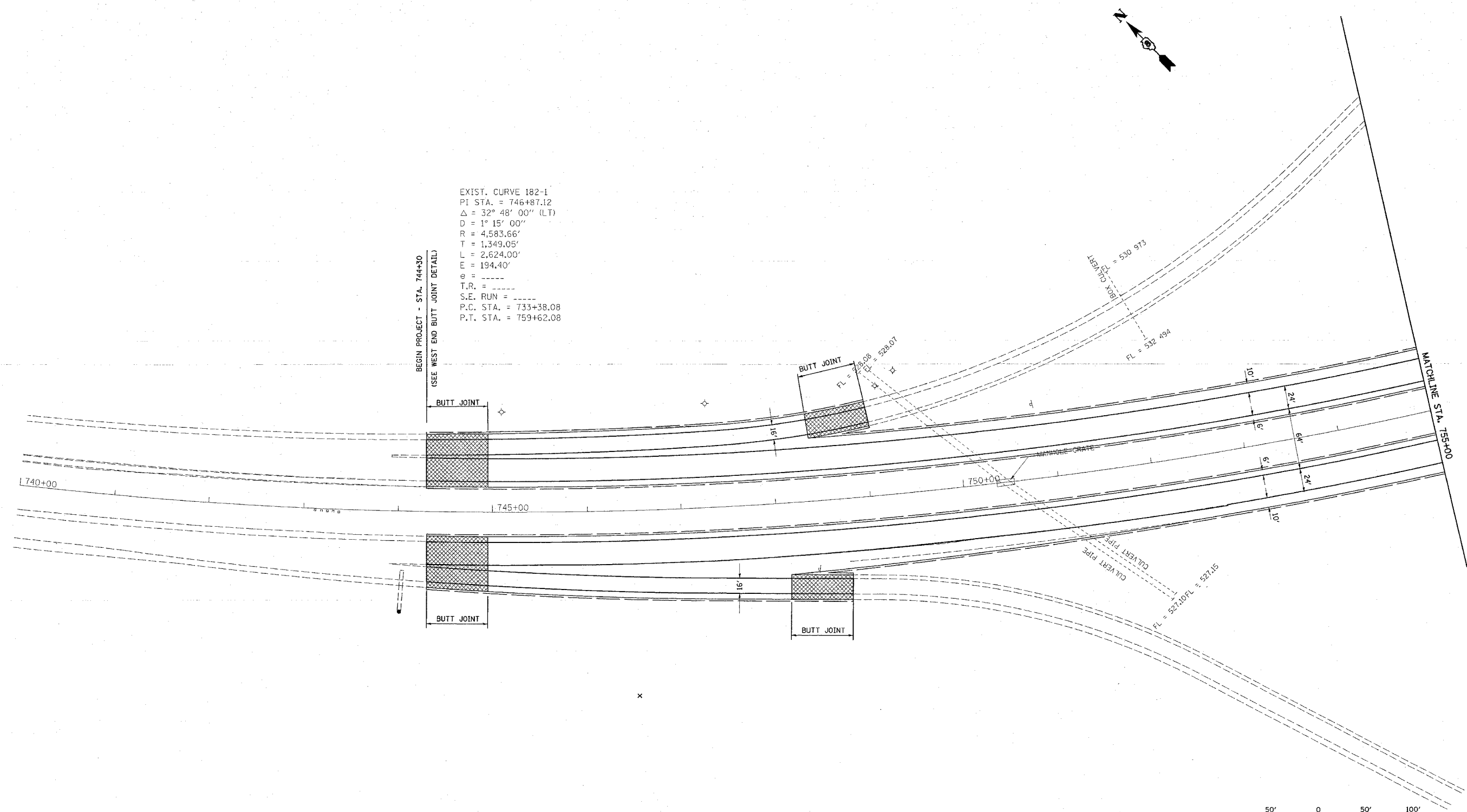

REVISIONS	
NAME	DATE

ILLINOIS DEPARTMENT OF TRANSPORTATION
PLAN VIEW
 FAI ROUTE 64
 SECTION 82-TRS-1, 82-THB-1, 2I
 ST. CLAIR COUNTY
 DRAWN BY:
 PLOT DATE: *DATE-TIME*

DATE
 DATE-TIME
 REF-PL
 REF-PL