

F.A.P. ROUTE	CONTRACT NO.	COUNTY	TOTAL SH.
0126	83776	McHENRY	77
STATE SECTION			
95-00090-00-PP			
CROSS SECTION STA. 193+00 TO STA. 193+10			
F.H.W.A. REG. 5 ILLINOIS PROJECT M-8003 (3)			

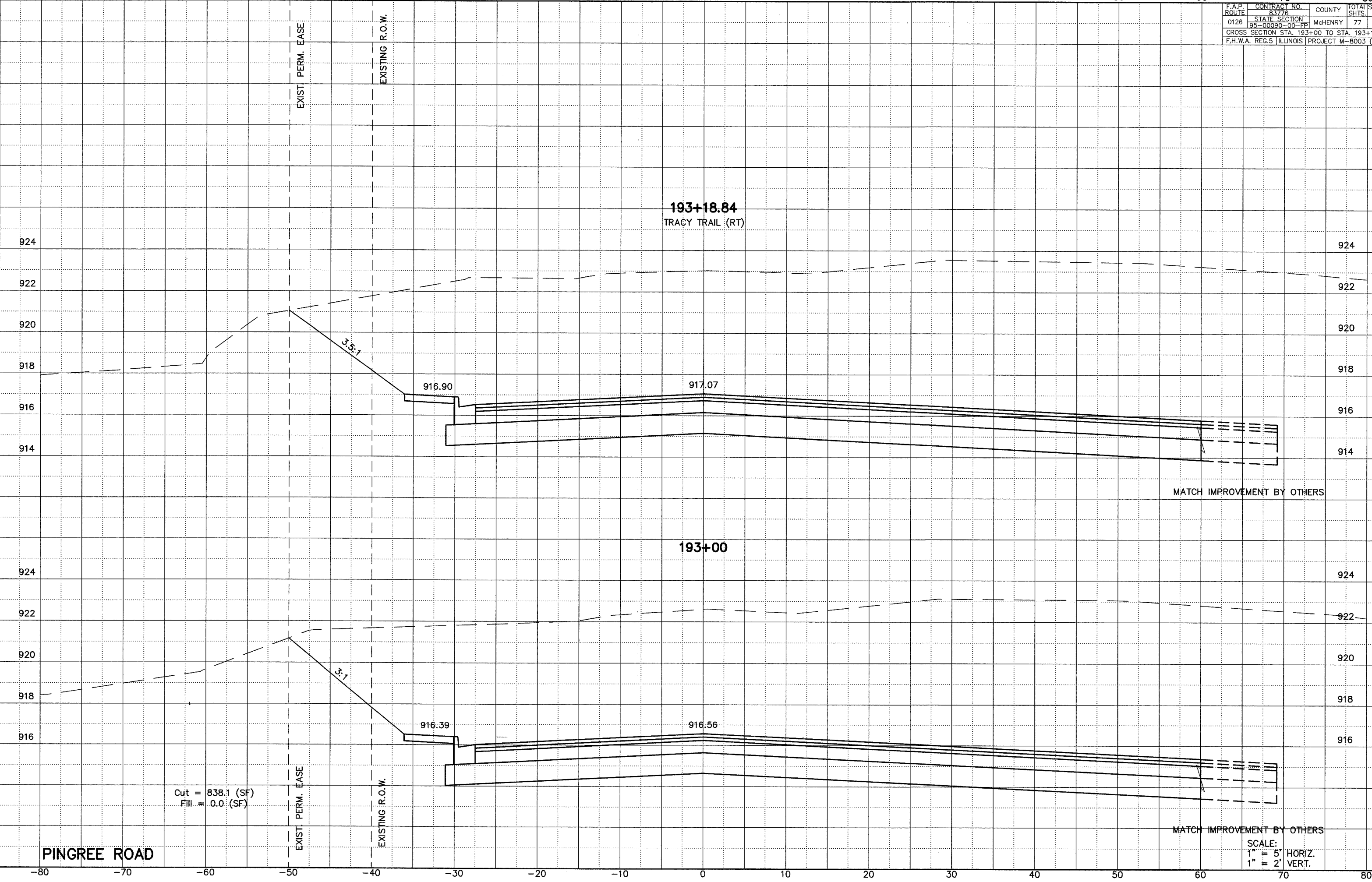

PINGREE ROAD

MATCH IMPROVEMENT BY OTHERS
SCALE:
1" = 5' HORIZ.
1" = 2' VERT.