

F.A.P. ROUTE	CONTRACT NO.	COUNTY	TOTAL SHTS.
305	83776	McHENRY	77
STATE SECTION			
95-0090-00-EP			
CROSS SECTION STA. 99+00 TO STA. 100+00			
F.H.W.A. REG.5 ILLINOIS PROJECT M-8003 (3)			

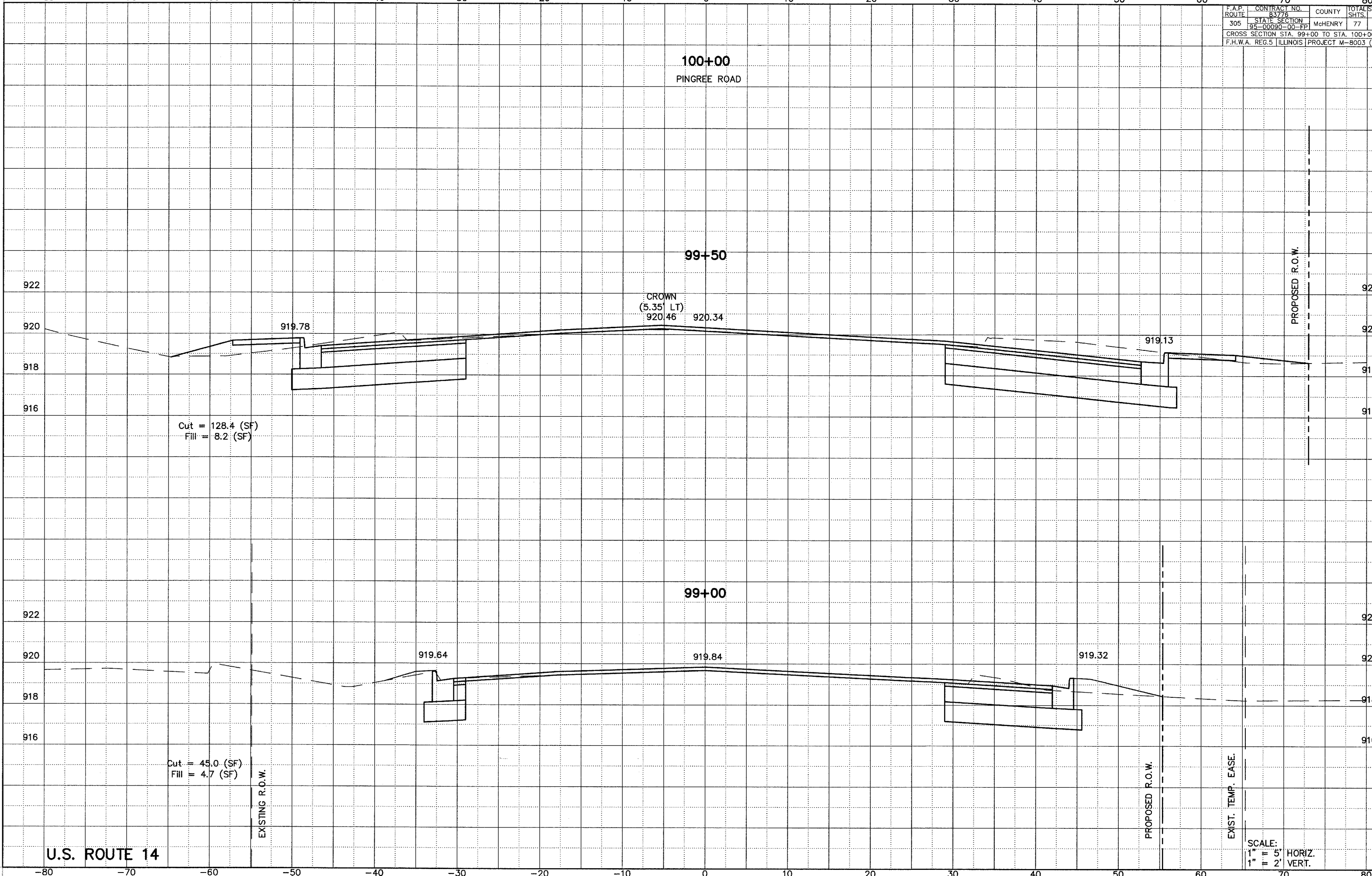

Cut = 128.4 (SF)
Fill = 8.2 (SF)

Cut = 45.0 (SF)
Fill = 4.7 (SF)

EXISTING R.O.W.

PROPOSED R.O.W.

EXIST. TEMP. EASE.

U.S. ROUTE 14

SCALE:
1" = 5' HORIZ.
1" = 2' VERT.