

F.A.U. RTE.	SECTION	COUNTY	TOTAL SHEETS	SHEET NO.
2652	00-00069-00-PV	DUPAGE	146	33
STA. 10+70.70		TO STA. 66+16.00		
FED. ROAD DIST. NO.	ILLINOIS	FED. AID PROJECT		
CONTRACT NO. 83781				

PLAN	SURVEYED	DATE
NOTE BOOK	PLOTTED	
NO.	CHECKED	
	BY	
	DATE	
	NO.	
	FILE NAME	

PROFILE	SURVEYED	DATE
NOTE BOOK	PLOTTED	
NO.	CHECKED	
	BY	
	DATE	
	NO.	
	FILE NAME	

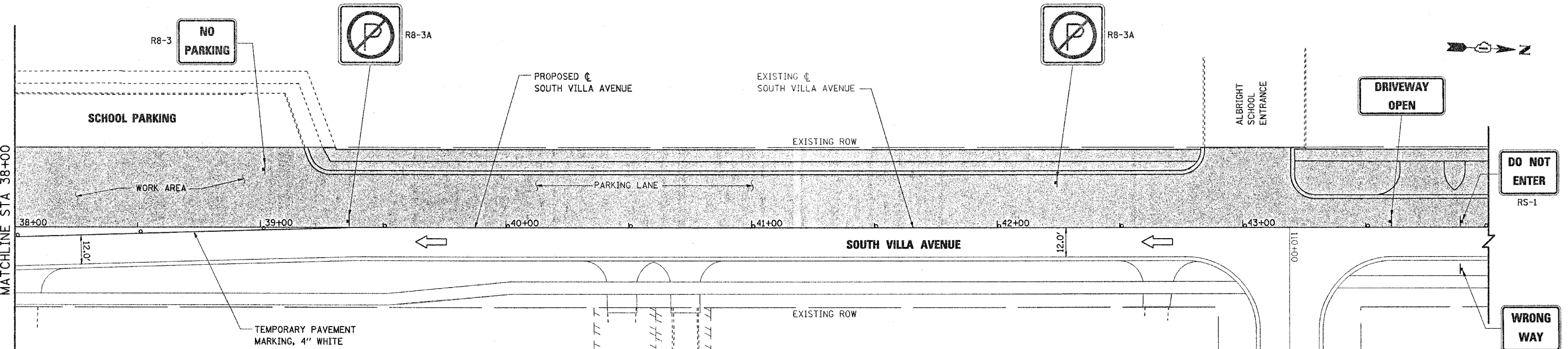
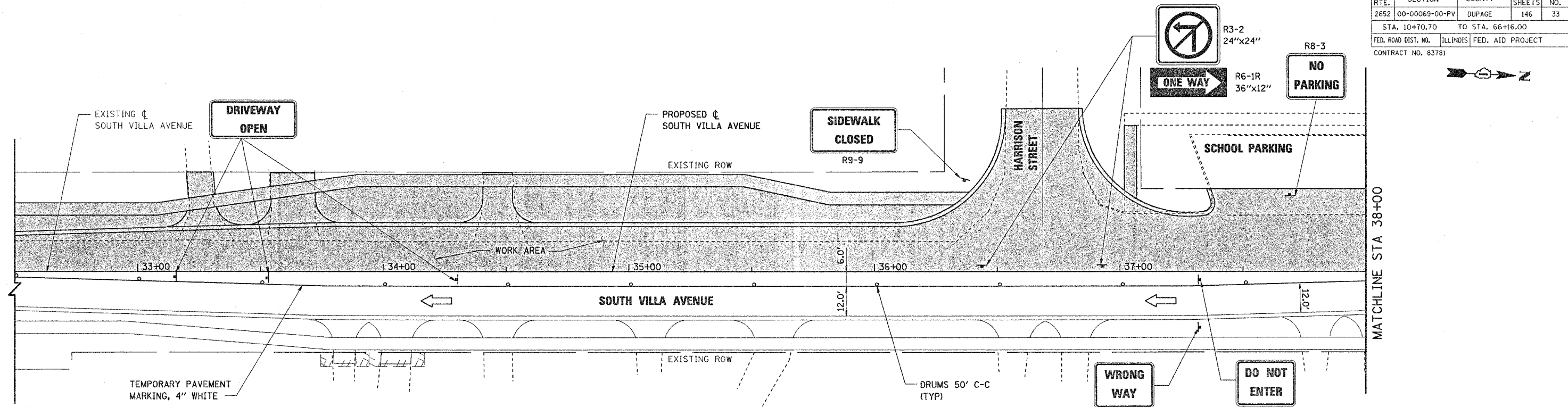

- LEGEND**
- ⇨ TRAFFIC FLOW DIRECTION
 - DRUMS WITH STEADY BURN LIGHTS
 - VERTICAL PANELS WITH STEADY BURN LIGHTS
 - TT TYPE III BARRICADES WITH TWO STEADY BURN LIGHTS
 - TRAFFIC CONTROL SIGNS
 - WORK AREA

- NOTES:**
- SEE ALSO TEMPORARY ONE WAY DETOUR PLAN FOR ADDITIONAL SIGNING DETAILS.
 - THE CONTRACTOR SHALL PLACE ONE (1) TEMPORARY DRIVEWAY SIGN AT EACH DRIVEWAY LOCATION.
 - THE CONTRACTOR SHALL PLACE THE FOLLOWING SIGNS AT ALL INTERSECTIONS AS DIRECTED BY THE ENGINEER:
 - R3-1
 - R3-2
 - R6-1L
 - R6-1R
 - R5-1A
 - R9-9

NOTE:
SCHOOL PARKING AND DROP OFF AREA SHALL REMAIN OPEN AT ALL TIMES WHILE SCHOOL IS IN SESSION.

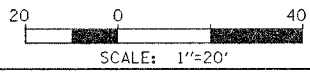

REVISIONS	
NAME	DATE

VILLAGE OF VILLA PARK, ILLINOIS
SUGGESTED MAINTENANCE OF TRAFFIC
SOUTH VILLA AVENUE
STAGE 2
SHEET 9 OF 10
 SCALE: 1"=20' DRAWN BY: E.D.
 DATE: 11-NOV-2004 CHECKED BY: J.T.G.