

F.A. RTE.	SECTION	COUNTY	TOTAL SHEETS	SHEET NO.
	00-00070-00-FP	COOK	98	43
STA.	TO STA.			
FED. ROAD DIST. NO.	ILLINOIS FED. AID PROJECT			
CONTRACT No. 83799				

TRAFFIC SIGNAL LEGEND

- | PROPOSED | EXISTING |
|--|----------|
| CONTROLLER | |
| SERVICE INSTALLATION | |
| SIGNAL HEAD | |
| SIGNAL HEAD WITH BACKPLATE | |
| SIGNAL HEAD, PEDESTRIAN | |
| SIGNAL POST | |
| MAST ARM ASSEMBLY AND POLE, STEEL | |
| MAST ARM ASSEMBLY AND POLE, ALUMINUM | |
| COMBINATION MAST ARM ASSEMBLY AND POLE, STEEL WITH LUMINAIRE | |
| UNIT DUCT | |
| COMMON TRENCH | |
| HANDHOLE | |
| HEAVY DUTY HANDHOLE | |
| DOUBLE HANDHOLE | |
| G.S. CONDUIT IN TRENCH (T) OR PUSHED (P) | |
| PEDESTRIAN PUSHBUTTON DETECTOR | |
| DETECTOR LOOP | |
| CAST IRON JUNCTION BOX | |
| EMERGENCY VEHICLE LIGHT DETECTOR | |
| CONFIRMATION BEACON | |
| SIGNAL HEAD OPTICALLY PROGRAMMED | |
| CONDUIT SPLICE | |
| WOOD POLE | |
| RACEWAY FOR MAGNETIC DETECTOR, TYPE I OR TYPE II | |
| VEHICLE DETECTOR, NON COMPENSATED MAGNETIC TYPE | |
| RAILROAD CONTROL CABINET | |
| TELEPHONE CONNECTION | |
| ILLUMINATED SIGN "NO LEFT TURN" | |
| ILLUMINATED SIGN "NO RIGHT TURN" | |
| RELOCATED | |

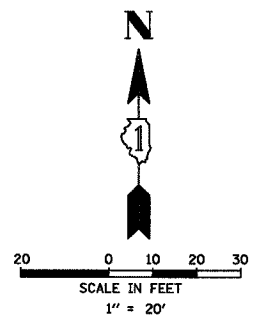

NOTE:
THE TRAFFIC SIGNAL CONTROLLER EQUIPMENT FOR THIS PROJECT SHALL BE "ECONOLITE" TO MATCH THE EXISTING ADJACENT SYSTEM.

RESTORATION OF WORK AREA. RESTORATION OF THE TRAFFIC SIGNAL WORK AREA SHALL BE INCIDENTAL TO THE RELATED PAY ITEM SUCH AS FOUNDATION, CONDUIT, HANDHOLE, TRENCH AND BACKFILL, ETC., AND NO EXTRA COMPENSATION SHALL BE ALLOWED. ALL ROADWAY SURFACES SUCH AS SHOULDERS, MEDIANS, SIDEWALKS, PAVEMENT, ETC. SHALL BE REPLACED IN KIND. ALL DAMAGE TO MOWED LAWNS SHALL BE REPLACED WITH AN APPROVED SOD, AND ALL DAMAGE TO UNMOWED FIELDS SHALL BE SEEDED IN ACCORDANCE WITH STANDARD SPECIFICATIONS 252 AND 250 RESPECTIVELY.

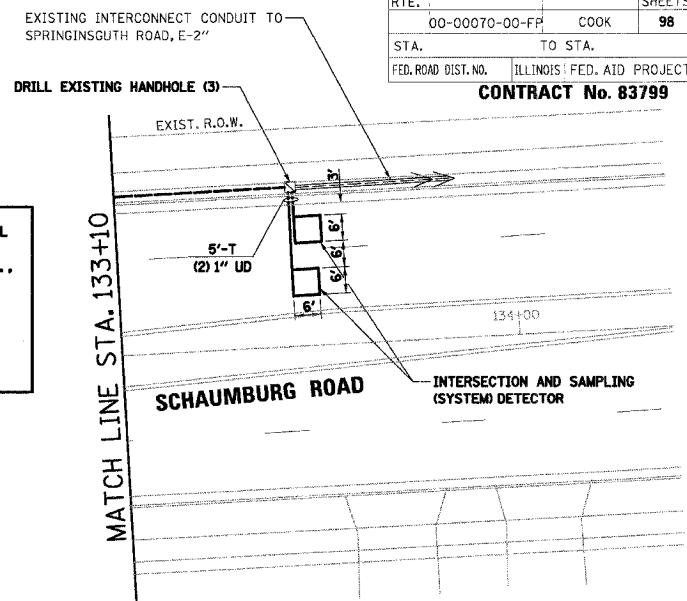

MATCH LINE STA. 126+80

MATCH LINE STA. 133+10

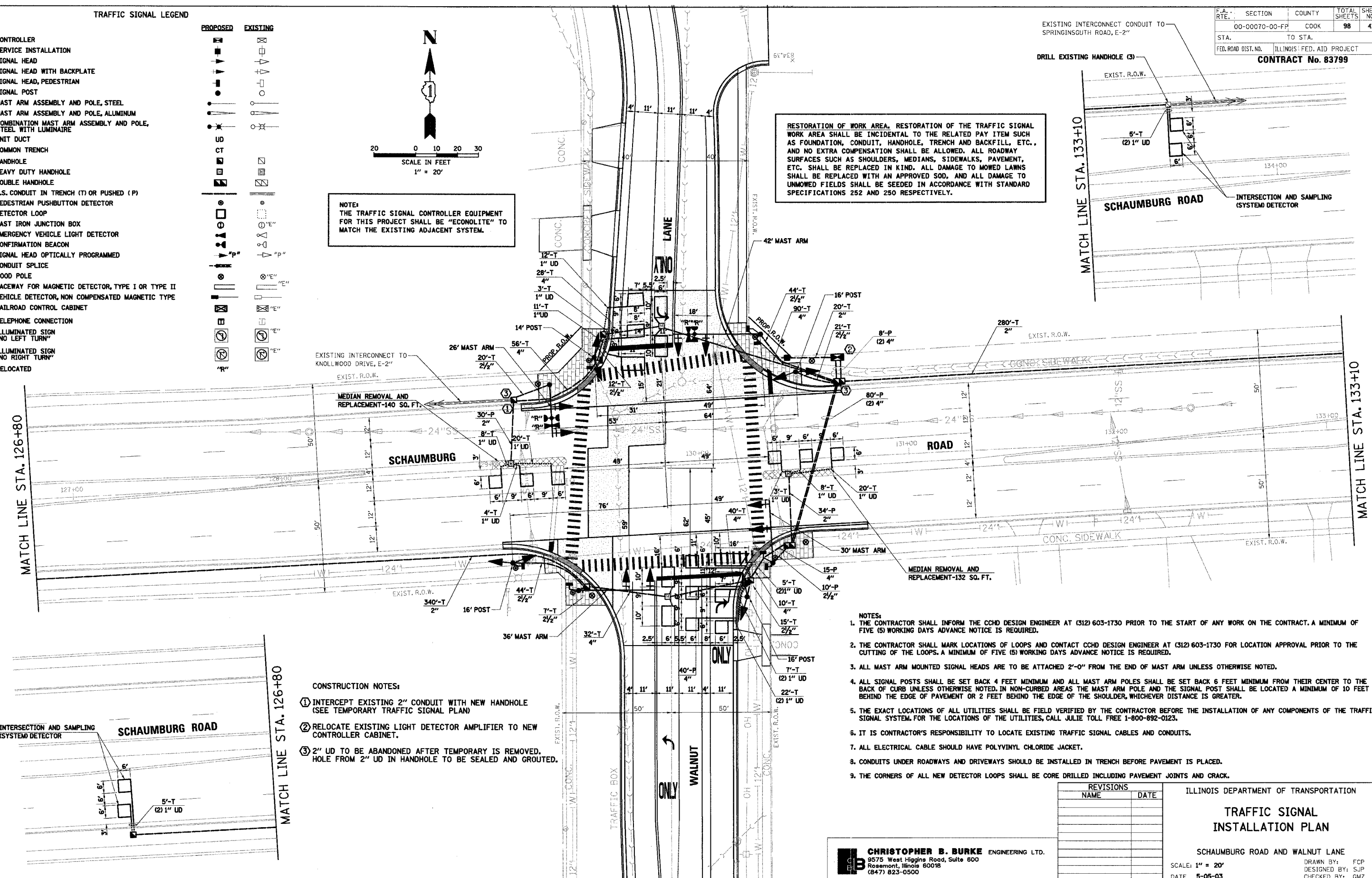

- CONSTRUCTION NOTES:**
- INTERCEPT EXISTING 2" CONDUIT WITH NEW HANDHOLE (SEE TEMPORARY TRAFFIC SIGNAL PLAN)
 - RELOCATE EXISTING LIGHT DETECTOR AMPLIFIER TO NEW CONTROLLER CABINET.
 - 2" UD TO BE ABANDONED AFTER TEMPORARY IS REMOVED. HOLE FROM 2" UD IN HANDHOLE TO BE SEALED AND GROUTED.

- NOTES:**
- THE CONTRACTOR SHALL INFORM THE CCHD DESIGN ENGINEER AT (312) 603-1730 PRIOR TO THE START OF ANY WORK ON THE CONTRACT. A MINIMUM OF FIVE (5) WORKING DAYS ADVANCE NOTICE IS REQUIRED.
 - THE CONTRACTOR SHALL MARK LOCATIONS OF LOOPS AND CONTACT CCHD DESIGN ENGINEER AT (312) 603-1730 FOR LOCATION APPROVAL PRIOR TO THE CUTTING OF THE LOOPS. A MINIMUM OF FIVE (5) WORKING DAYS ADVANCE NOTICE IS REQUIRED.
 - ALL MAST ARM MOUNTED SIGNAL HEADS ARE TO BE ATTACHED 2'-0" FROM THE END OF MAST ARM UNLESS OTHERWISE NOTED.
 - ALL SIGNAL POSTS SHALL BE SET BACK 4 FEET MINIMUM AND ALL MAST ARM POLES SHALL BE SET BACK 6 FEET MINIMUM FROM THEIR CENTER TO THE BACK OF CURB UNLESS OTHERWISE NOTED. IN NON-CURBED AREAS THE MAST ARM POLE AND THE SIGNAL POST SHALL BE LOCATED A MINIMUM OF 10 FEET BEHIND THE EDGE OF PAVEMENT OR 2 FEET BEHIND THE EDGE OF THE SHOULDER, WHICHEVER DISTANCE IS GREATER.
 - THE EXACT LOCATIONS OF ALL UTILITIES SHALL BE FIELD VERIFIED BY THE CONTRACTOR BEFORE THE INSTALLATION OF ANY COMPONENTS OF THE TRAFFIC SIGNAL SYSTEM. FOR THE LOCATIONS OF THE UTILITIES, CALL JULIE TOLL FREE 1-800-892-0123.
 - IT IS CONTRACTOR'S RESPONSIBILITY TO LOCATE EXISTING TRAFFIC SIGNAL CABLES AND CONDUITS.
 - ALL ELECTRICAL CABLE SHOULD HAVE POLYVINYL CHLORIDE JACKET.
 - CONDUITS UNDER ROADWAYS AND DRIVEWAYS SHOULD BE INSTALLED IN TRENCH BEFORE PAVEMENT IS PLACED.
 - THE CORNERS OF ALL NEW DETECTOR LOOPS SHALL BE CORE DRILLED INCLUDING PAVEMENT JOINTS AND CRACK.

REVISIONS	
NAME	DATE

ILLINOIS DEPARTMENT OF TRANSPORTATION

**TRAFFIC SIGNAL
INSTALLATION PLAN**

SCHAUMBURG ROAD AND WALNUT LANE

SCALE: 1" = 20'
DATE: 5-05-03

DRAWN BY: FCP
DESIGNED BY: SJP
CHECKED BY: GMZ

CHRISTOPHER B. BURKE ENGINEERING LTD.
9575 West Higgins Road, Suite 600
Rosemont, Illinois 60018
(847) 823-0500