

F.A.U. RTE.	SECTION	COUNTY	TOTAL SHEETS	SHEET NO.	SHEET NO. B7 OF 18 SHEETS
6325	02-00090-00-BR	LIVINGSTON	31	14	
STA.	TO STA.				
FED. ROAD DIST. NO. 7		ILLINOIS FED. AID PROJECT+			
CONTRACT NO. 87238					

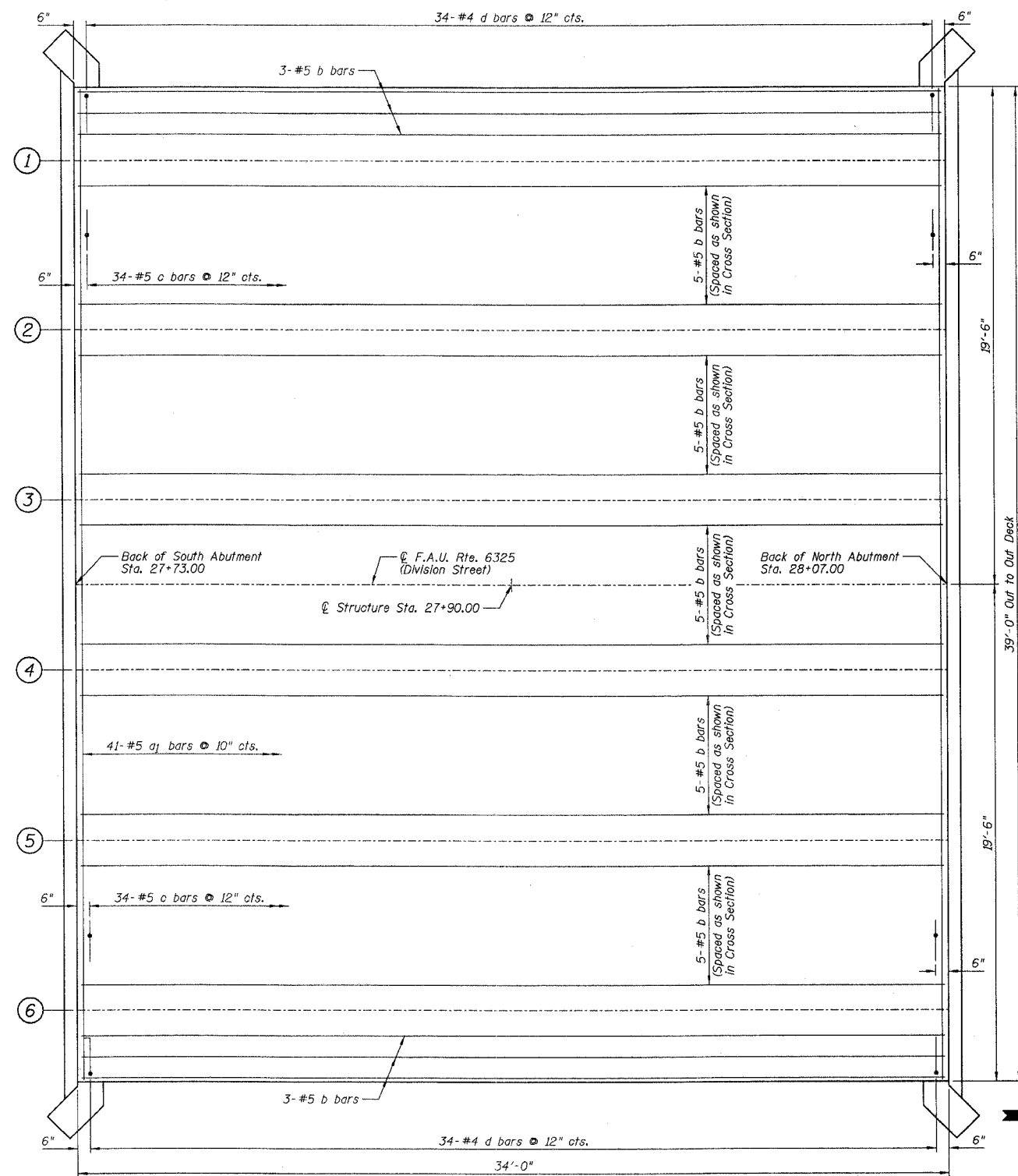

BOTTOM OF SLAB PLAN

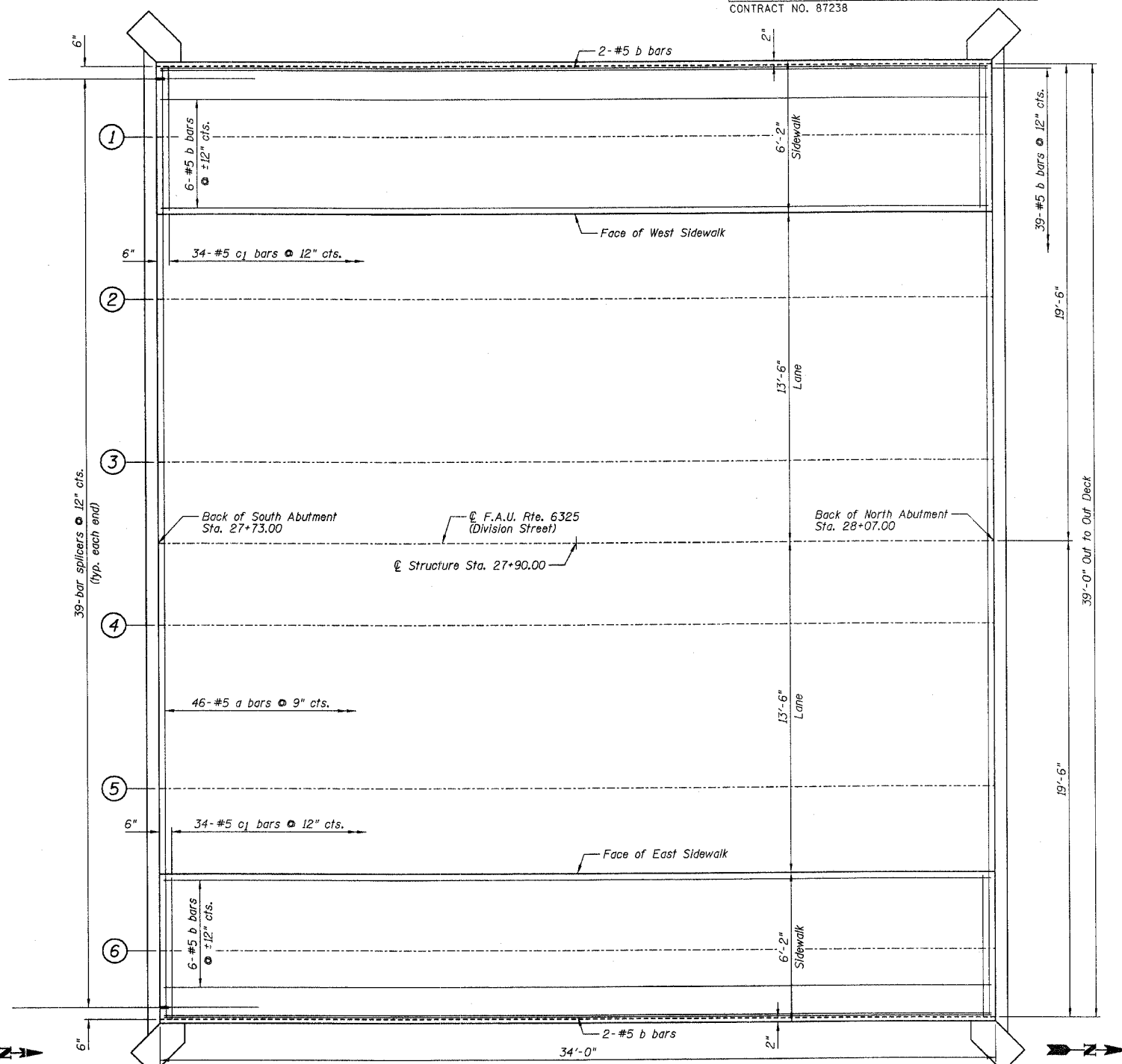

TOP OF SLAB PLAN

- NOTES:**
- 1.) Work this sheet with Sheets B4-B6, B8 & B9.
 - 2.) For Superstructure Bill of Materials see Sheet B8.

SECTION 02-00090-00-BR
LIVINGSTON COUNTY
PONTIAC, ILLINOIS

SUPERSTRUCTURE DECK

DESIGNED BY J.M.L.	<p>3700 McGraw Drive Bloomington, Illinois 61704 309/885-6136, 309/885-1871 fax</p>	FILE NO. 24-6884
DRAWN BY D.J.M.		DATE 01-14-05
CHECKED BY M.S.W.		SHEET NO. 14 of 31