

F.A.P. RTE.	SECTION	COUNTY	TOTAL SHEETS	SHEET NO.
310	(38-1) RS	MCDONOUGH	83	44
STA. 143+00		TO STA. 158+00		
FED. ROAD DIST. NO.		ILLINOIS FED. AID PROJECT		

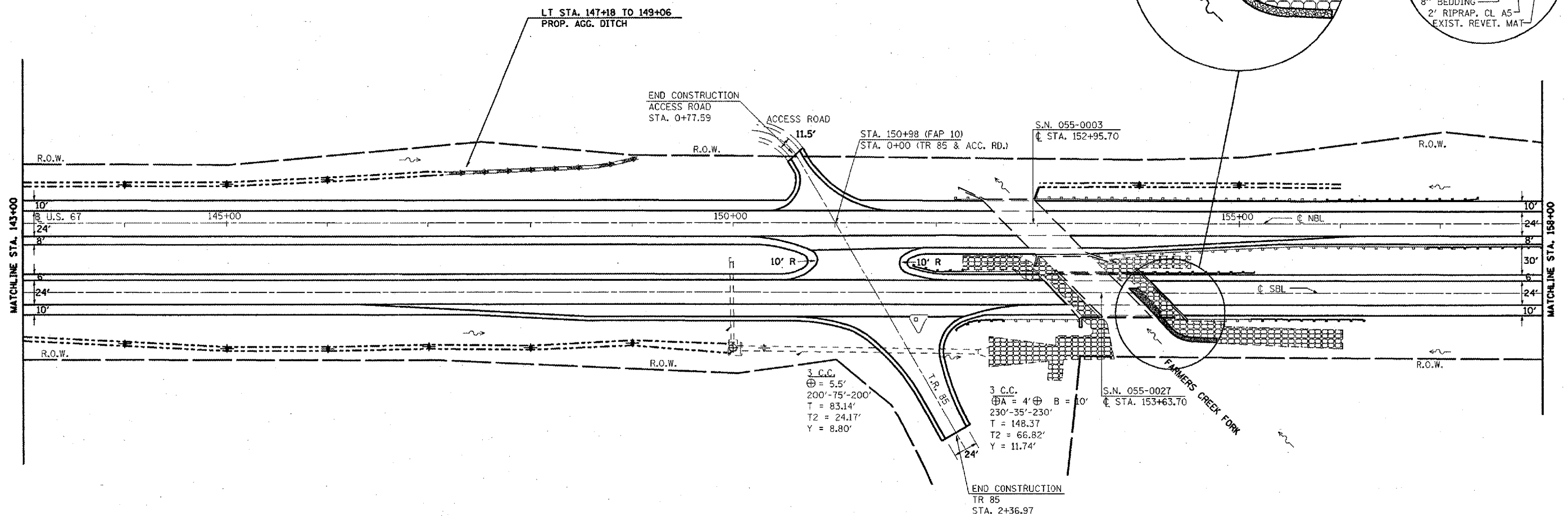

T6N R2W 4th P.M. (MACOMB TWP.)
SECTION 6

PLAN VIEW

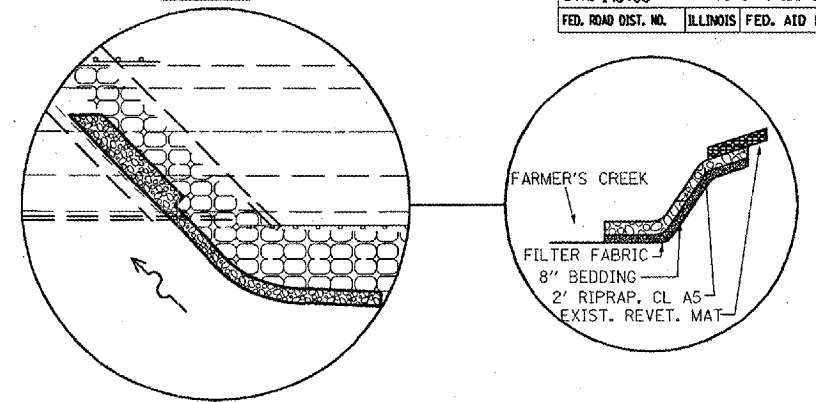

T6N R3W 4th P.M. (EMMET TWP.)
SECTION 1

EXISTING LEGEND

- CONCRETE REVETMENT MAT
- R.O.W. MARKER
- SUMMIT
- EXIST. DITCH CHECK
- PAVED DITCH
- EXIST. GUARDRAIL

PROPOSED LEGEND

- GUARDRAIL
- DITCH CHECK
- END SECTION REPLACEMENT
- PIPE CULVERT REPLACEMENT
- DITCH GRADING
- INLET PROTECTION
- RIPRAP A-5
- AGGREGATE DITCH

NOTE: MEDIAN CROSSOVER AND SIDE ROAD PAVEMENT TO BE TREATED THE SAME AS THE TURN LANE PAVEMENT.



REVISIONS	
NAME	DATE

ILLINOIS DEPARTMENT OF TRANSPORTATION
PROPOSED PLAN SHEET
STA. 143+00 TO 158+00
SCALE: VERT. 1" = 50'
HORIZ. 1" = 100'
DATE: ##DATE##
DRAWN BY: CADD
CHECKED BY: