

SW 1/4 SEC 25, T13N, R1E, 3RD PM

VIVIAN WENDLING
PARCEL NO. 6085171

F.A.P. RTE.	SECTION	COUNTY	TOTAL SHEETS	SHEET NO.
322	11-10	CHRISTIAN	310	55
STA.		TO STA.		
FED. ROAD DIST. NO.		ILLINOIS FED. AID PROJECT		

SEE SHEET 73
FOR AD 758 PLAN AND PROFILE

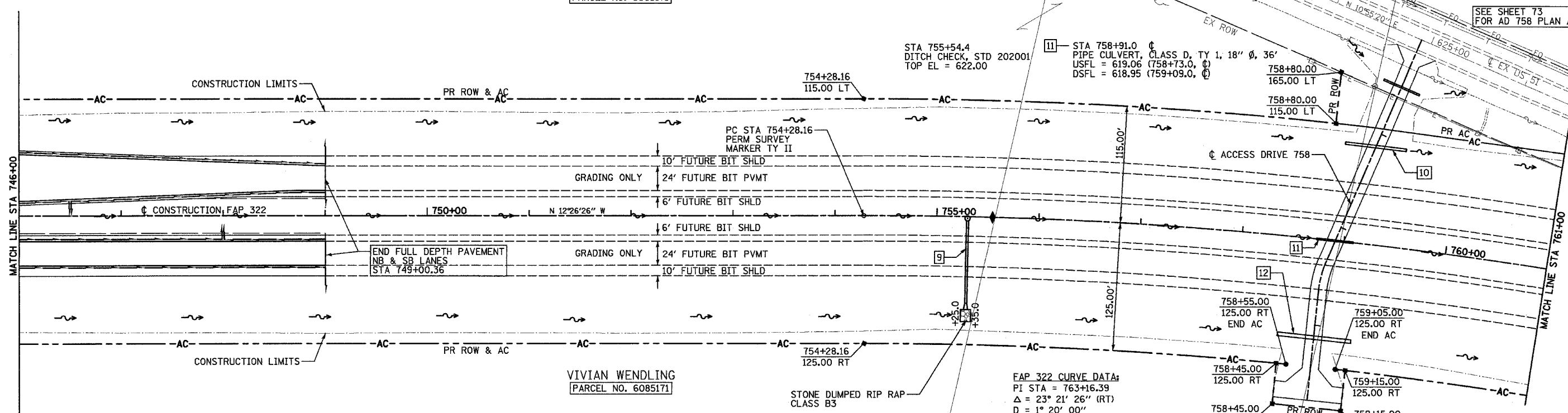

FAP 322 CURVE DATA:
 PI STA = 763+16.39
 $\Delta = 23^\circ 21' 26''$ (RT)
 $D = 1^\circ 20' 00''$
 $R = 4,297.18'$
 $T = 888.23'$
 $L = 1,751.79'$
 $E = 90.84'$
 $SE = 4.2\%$
 PC STA = 754+28.16
 PT STA = 771+79.95
 SE ATTAINED STA 752+61 TO STA 754+91
 (TR STA 752+61 TO STA 753+02)
 SE REMOVED STA 771+17 TO STA 773+47
 (TR STA 773+06 TO STA 773+47)

9- STA 755+30.0 1.25' RT
 MANHOLE, TYPE A, 5'-DIAMETER, WITH MEDIAN INLET (STD 60410),
 FLAT SLAB TOP, 1 EACH
 PIPE CULVERT, RCCP, TYPE 2, 24" X 82' (PAY LENGTH)
 USFL = 614.48 DSFL = 613.65
 CONCRETE FLARED END SECTION 24", STD 542301, 1 EACH
 TRENCH BACKFILL, 45.3 CU YD

SW 1/4 SEC 25, T13N, R1E, 3RD PM

VIVIAN WENDLING
PARCEL NO. 6085171

IRENE MORRISON TRUST
PARCEL NO. 6085172

