

NE 1/4 SEC 12, T13N, R1E, 3RD PM

STA 959+64.9  
DITCH CHECK, STD 202001  
TOP EL = 618.96

SE 1/4 SEC 1, T13N, R1E, 3RD PM

F.A.P. RTE.	SECTION	COUNTY	TOTAL SHEETS	SHEET NO.
322	11-10	CHRISTIAN	310	69
STA.		TO STA.		
FED. ROAD DIST. NO.		ILLINOIS FED. AID PROJECT		

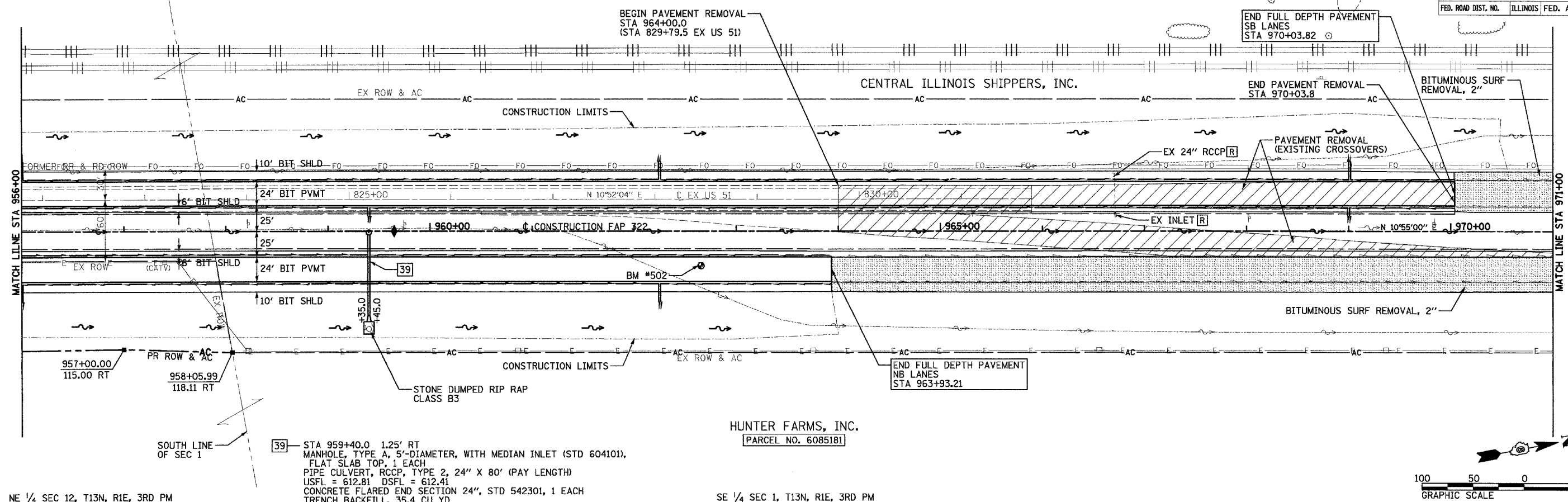

PLAN  
SURVEYED  
ALIGNED  
CHECKED  
BY  
DATE  
NO.

STRUCTURE NOTATIONS CHECKED  
BY  
DATE  
NO.

39 - STA 959+40.0 1.25' RT  
MANHOLE, TYPE A, 5'-DIAMETER, WITH MEDIAN INLET (STD 604101),  
FLAT SLAB TOP, 1 EACH  
PIPE CULVERT, RCCP, TYPE 2, 24" X 80" (PAY LENGTH)  
USFL = 612.81 DSFL = 612.41  
CONCRETE FLARED END SECTION 24", STD 542301, 1 EACH  
TRENCH BACKFILL, 35.4 CU YD

BM #502 - FOUND 60d NAIL IN PP  
0.86 MILES SOUTH OF SHELBY COUNTY LINE  
STA 962+65.15, 32.35' RT (PR US 51), ELEV = 616.35  
STA 828+44.60, 63.85' RT (EX US 51)

