

F.A.P. RTE.	SECTION	COUNTY	TOTAL SHEETS	SHEET NO.
322	11-10	CHRISTIAN	310	71
STA.		TO STA.		
FED. ROAD DIST. NO.		ILLINOIS FED. AID PROJECT		

SB TRANSITION CURVE #1 DATA:
 PI STA = 101+54.01
 = 771+85.44 22.24' LT FAP 322
 $\Delta = 2^\circ 12' 21''$ (LT)
 $D = 0^\circ 42' 58''$
 $R = 8,000.00'$
 $T = 154.01'$
 $L = 307.98'$
 $E = 1.48'$
 $SE = RC$
 PC STA = 100+00.00
 = 770+32.26 24.81' LT FAP 322
 PRC STA = 103+07.98
 = 773+39.34 28.16' LT FAP 322

SB TRANSITION CURVE #2 DATA:
 PI STA = 105+38.40
 = 775+69.58 37.00' LT FAP 322
 $\Delta = 2^\circ 12' 00''$ (RT)
 $D = 0^\circ 28' 39''$
 $R = 12,000.00'$
 $T = 230.42'$
 $L = 460.78'$
 $E = 2.21'$
 $SE = NC$
 PRC STA = 103+07.98
 = 773+39.34 28.16' LT FAP 322
 PT STA = 107+68.76
 = 778+00.00 37.00' LT FAP 322

SEE SHEETS 56 & 57 FOR FAP 322 PLAN & PROFILE

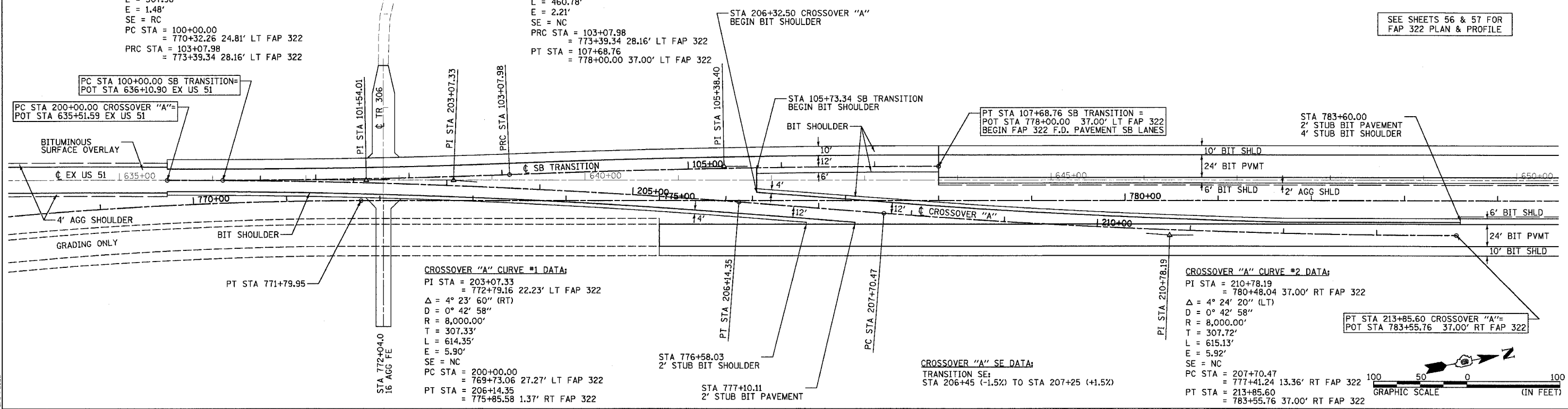

CROSSOVER "A" CURVE #1 DATA:
 PI STA = 203+07.33
 = 772+79.16 22.23' LT FAP 322
 $\Delta = 4^\circ 23' 60''$ (RT)
 $D = 0^\circ 42' 58''$
 $R = 8,000.00'$
 $T = 307.33'$
 $L = 614.35'$
 $E = 5.90'$
 $SE = NC$
 PC STA = 200+00.00
 = 769+73.06 27.27' LT FAP 322
 PT STA = 206+14.35
 = 775+85.58 1.37' RT FAP 322

CROSSOVER "A" CURVE #2 DATA:
 PI STA = 210+78.19
 = 780+48.04 37.00' RT FAP 322
 $\Delta = 4^\circ 24' 20''$ (LT)
 $D = 0^\circ 42' 58''$
 $R = 8,000.00'$
 $T = 307.72'$
 $L = 615.13'$
 $E = 5.92'$
 $SE = NC$
 PC STA = 207+70.47
 = 777+41.24 13.36' RT FAP 322
 PT STA = 213+85.60
 = 783+55.76 37.00' RT FAP 322

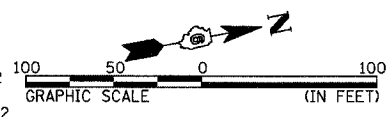

DATE	BY
DATE	BY
DATE	BY

DATE	BY
DATE	BY
DATE	BY

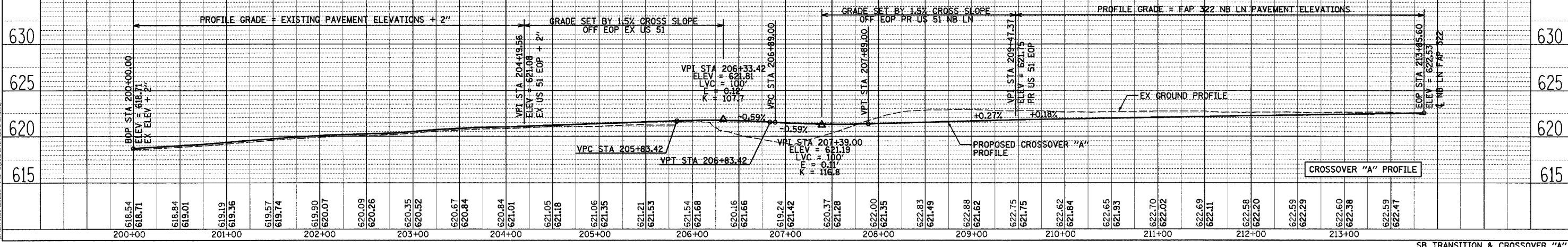
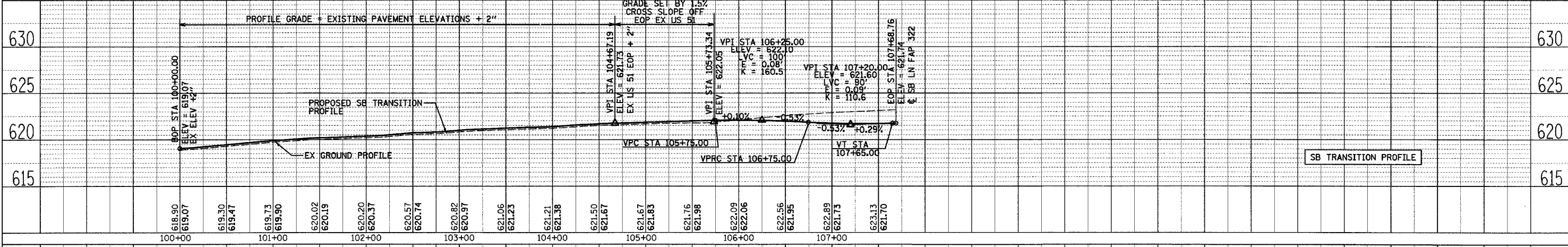

SB TRANSITION & CROSSOVER "A"