

1/31/2005  
 c:\projects\94652d\0210101.dgn  
 REV: 1  
 1 2 3 4 5 6 7 8 9  
 10 11 12 13 14 15 16 17 18  
 19 20 21 22 23 24 25 26 27  
 28 29 30 31 32 33 34 35  
 36 37 38 39 40 41 42 43 44 45  
 46 47 48 49 50 51 52 53 54  
 55 56 57 58 59 60 61 62 63

FAP NO.	SECTION	COUNTY	TOTAL SHEETS	SHEET NO.
332	1101Z\WRS	WHITE/EDWARDS	198	34
FED. ROAD DIST. NO. 7		ILLINOIS	FED. AID PROJECT NO.	

CONTRACT NO. 94652

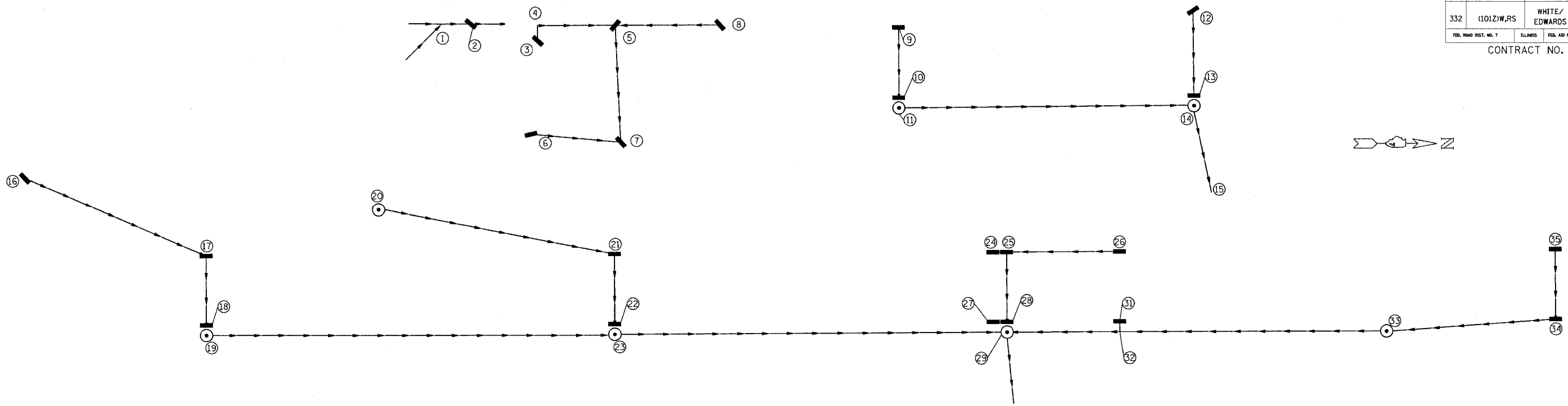

PT. TO PT.	RG TYPE 2 15 In	TYPE 2 15 In	TRENCH BACKFILL
	FT	FT	CU YD
3 - 4		5.1	1.6
4 - 5	29.7		8.4
8 - 5	39.8		8.0
5 - 7	43.9		15.4
6 - 7	34.5		23.3
9 - 10	27.0		8.9
10 - 11		2.1	0.8
11 - 14		116.2	80.5
12 - 13	57.9		18.3
13 - 14		2.2	1.4
14 - 15		31.5	1.3
16 - 17	76.8		6.5
17 - 18	25.9		7.6
18 - 19		2.1	0.7
19 - 23		167.4	58.9
20 - 21	95.3		25.8
21 - 22		25.9	4.9
22 - 23		2.0	0.5
23 - 29		156.6	47.8
26 - 25		43.1	6.2
24 - 25		2.0	0.3
25 - 28		25.4	5.1
27 - 28		2.0	0.4
28 - 29		2.0	0.5
35 - 34		26.5	6.3
34 - 33		65.5	16.2
33 - 32	161.7		43.8
31 - 32		4.6	1.0
32 - 29		44.8	13.2
29 - 30		25.2	2.8
TOTAL	592.5	752.2	416.4

PT	LOCATION STATION	OFFSET	DESCRIPTION	LID OR GRATE	INLET INVERT	INLET INVERT	OUTLET INVERT	SYM
1	5+31	25' LT.	MH TO BE ADJUSTED W/ NEW TIFCL					⊙
2	5+42	25' LT.	MH TY A 4' DIA T3F&G	443.40	440.26 (S)	-	440.16 (N)	⊙
3	8+40	18' LT.	INLET TY A T3F&G	438.37	-	-	433.43 (W)	—
4	8+40	24' LT.	PIPE TEE 15P 15R	-	433.35 (S)	433.35 (E)	433.35 (N)	T
5	8+71	24' LT.	MH TY A 4' DIA T3F&G	437.15	432.68 (N)	432.68 (S)	432.38 (E)	⊙
6	8+37	18' RT.	INLET TY A T3F&G	438.48	-	-	432.03 (N)	—
7	8+74	23' RT.	MH TY A 4' DIA T3F&G	436.75	431.52 (S)	431.52 (W)	428.53 (E)	⊙
8	9+13	24' LT.	INLET TY A T3F&G	436.31	-	-	433.46 (S)	—
9	10+29	14.5' LT.	INLET TY A T3F&G	433.13	-	-	428.63 (E)	—
10	10+29	14.5' RT.	INLET TY B T3F&G	433.13	428.10 (W)	-	428.00 (E)	—
11	10+29	20' RT.	MH TY A 4' DIA TIFCL	433.54	427.95 (W)	-	427.75 (N)	⊙
12	11+48	45' LT.	INLET TY A T3F&G	431.93	-	-	427.81 (E)	—
13	11+48	14.5' RT.	INLET TY B T3F&G	432.24	426.95 (W)	-	426.85 (E)	—
14	11+48	20' RT.	MH TY A 4' DIA TIFCL	432.65	426.60 (S)	426.70 (W)	426.40 (E)	⊙
15	11+55	53' RT.	END SECTION - 15"	-	-	-	425.93 (E)	—
16	12+77	45' LT.	INLET TY A T3F&G	431.54	-	-	427.04 (N)	—
17	13+50	14.5' LT.	MH TY A 4' DIA T3F&G	430.43	426.28 (S)	-	426.08 (E)	⊙
18	13+50	14.5' RT.	INLET TY B T3F&G	430.43	425.70 (W)	-	425.60 (E)	—
19	13+50	20' RT.	MH TY A 4' DIA TIFCL	430.84	425.55 (W)	-	425.35 (N)	⊙
20	14+20	32' LT.	INLET TY A T8G	427.40	-	-	422.05 (N)	—
21	15+15	14.5' LT.	MH TY A 4' DIA T3F&G	422.96	419.73 (S)	-	419.53 (E)	⊙
22	15+15	14.5' RT.	INLET TY B T3F&G	422.96	419.15 (W)	-	419.05 (E)	—
23	15+15	20' RT.	MH TY A 4' DIA TIFCL	423.37	418.91 (S)	419.01 (W)	418.71 (N)	⊙
24	16+67	14.5' LT.	INLET TY A T3F&G	419.72	-	-	416.59 (N)	—
25	16+72.5	14.5' LT.	MH TY A 4' DIA T3F&G	419.72	416.55 (S)	416.40 (N)	416.25 (E)	⊙
26	17+18	14.5' LT.	INLET TY A T3F&G	420.18	-	-	417.03 (S)	—
27	16+67	14.5' RT.	INLET TY A T3F&G	419.72	-	-	416.02 (N)	—
28	16+72.5	14.5' RT.	MH TY A 4' DIA T3F&G	419.72	415.98 (S)	415.88 (W)	415.78 (E)	⊙
29	16+72.5	20.5' RT.	MH TY A 4' DIA TIFCL	420.12	415.64 (N,S)	415.74 (W)	415.44 (E)	⊙
30	16+75	47' RT.	END SECTION - 15"	-	-	-	414.82 (E)	—
31	17+18	14.5' RT.	INLET TY A T3F&G	420.18	-	-	417.04 (E)	—
32	17+18	20' RT.	PIPE TEE 15P 15R	-	416.95 (N)	416.95 (W)	416.95 (S)	T
33	18+77	20' RT.	MH TY A 4' DIA TIFCL	425.82	421.95 (W-EX)	422.05 (N)	421.65 (S)	⊙
34	19+45	14.5' RT.	MH TY A 4' DIA T3F&G	427.79	423.53 (W)	-	423.33 (S)	⊙
35	19+45	14.5' LT.	INLET TY A T3F&G	427.79	-	-	424.05 (E)	—

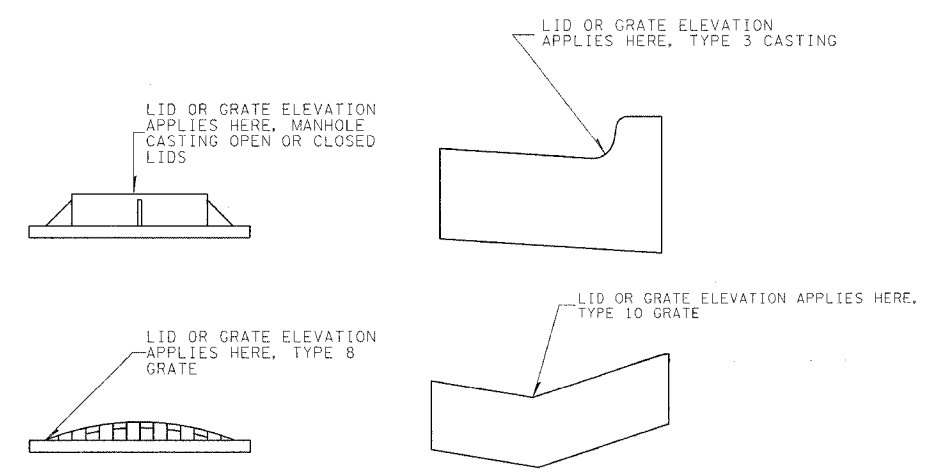

NAME	DATE

ILLINOIS DEPARTMENT OF TRANSPORTATION

**STORM SEWER**

SCALE: VERT.  
 HORIZ.  
 DATE

DRAWN BY  
 CHECKED BY

c:\projects\94652d\0210101.dgn  
 steffenmk\j... DATE