

1 2 3 4 5 6 7 8 9 1/31/2005
 10 11 12 13 14 15 16 17 18
 19 20 21 22 23 24 25 26
 27 28 29 30 31 32 33 34
 35 36 37 38 39 40 41 42 43 44 45
 46 47 48 49 50 51 52 53 54
 55 56 57 58 59 60 61 62 63

c:\projects\94652d\02101pa.dgn
 steffenk\+ DATE

REV: MRW5

LOCATION #5 = RT. STA. 29+05.00 TO RT. STA. 30+10.00
 WALL AREA = 422 SQ. FT.

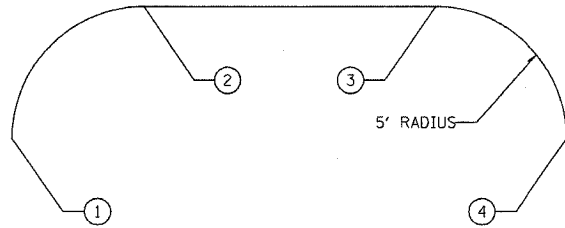

NO.	MAINLINE STATION	MAINLINE OFFSET
1	29+05.00	32.33' LT
2	29+10.00	27.33' LT
3	30+05.00	27.33' LT
4	30+10.00	32.33' LT

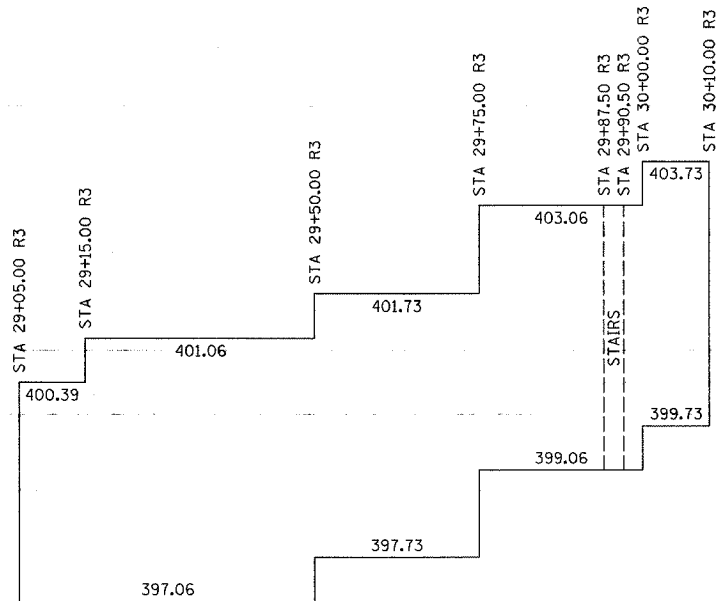

TOP AND BOTTOM OF WALL ELEVATIONS
 NOTE: BOTTOM OF WALL NOT BOTTOM OF FOOTING

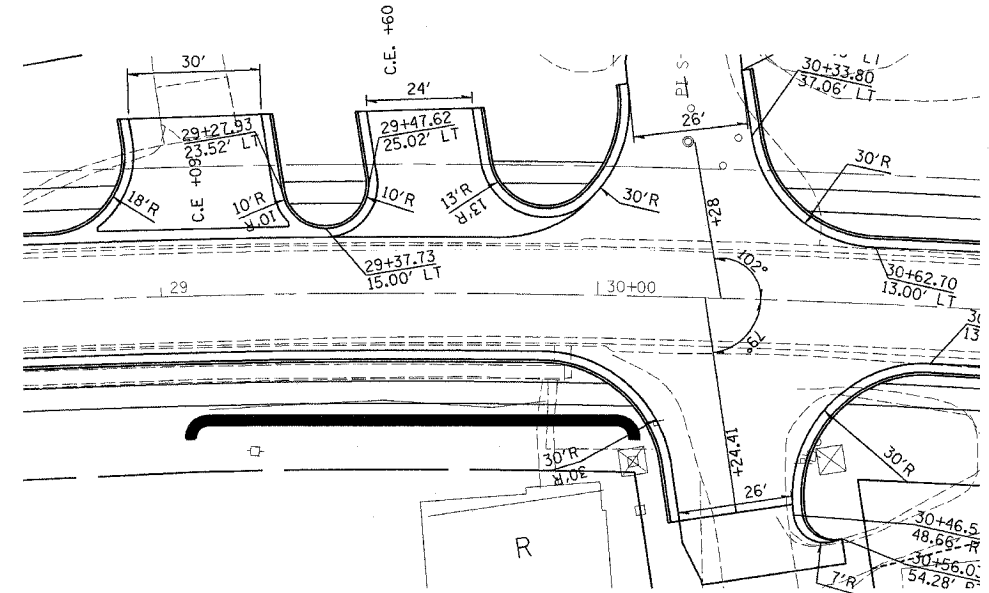

FAP NO.	SECTION	COUNTY	TOTAL SHEETS	SHEET NO.
332	(101Z)W,RS	WHITE/EDWARDS	198	58

FED. ROAD DIST. NO. 7 ILLINOIS FED. AID PROJECT NO.

CONTRACT NO. 94652

REVISIONS	
NAME	DATE

ILLINOIS DEPARTMENT OF TRANSPORTATION
MODULAR RETAINING WALL
RT STA 29 + 05.00
TO
RT STA 30 + 10.00

SCALE: VERT. _____
 HORIZ. _____
 DATE _____

DRAWN BY _____
 CHECKED BY _____