

F.A.P. RTE.	SECTION	COUNTY	TOTAL SHEETS	SHEET NO.
774	*	EFFINGHAM	273	72A
FED. ROAD DIST. NO. 7 ILLINOIS FED. AID PROJECT				
* 107WRS-1, 107BY, 107BY-1 & 107B-2				
CONTRACT NO. 94827				

NOTE: INDIVIDUAL TREE REMOVALS NOT SHOWN. SEE SCHEDULE

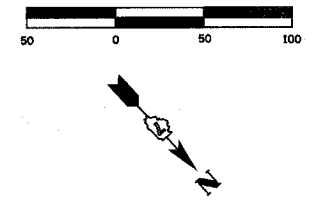

PLAN	DATE
REVISIONS	
NO.	
BY	
DATE	
NOTED	
DATE	
BY	
DATE	

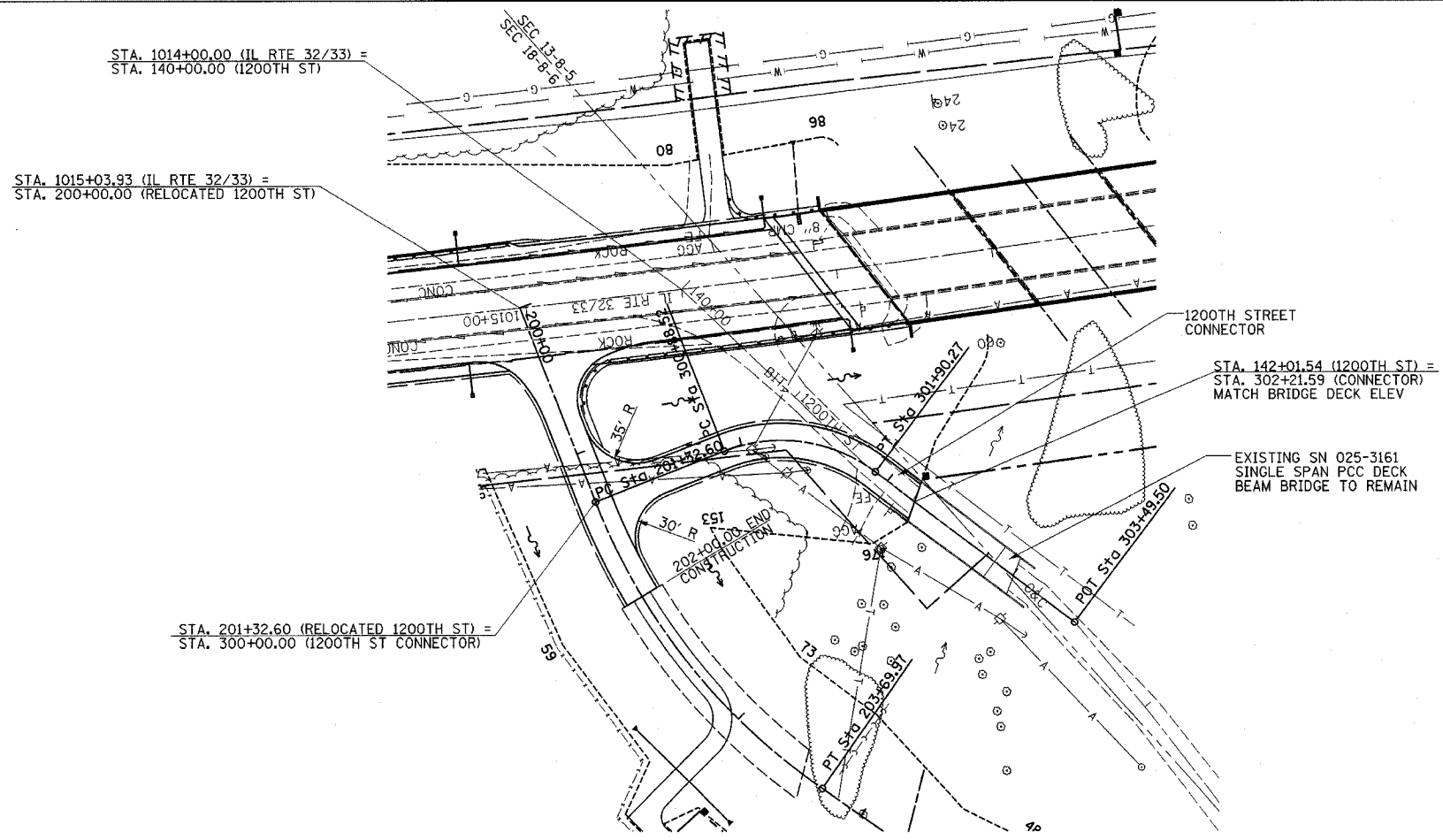

PROP. CURVE ALT001
 PI STA. = 301+44.29
 $\Delta = 58^\circ 17' 47.2''$ (RT)
 $D = 57^\circ 17' 44.8''$
 $R = 100.00'$
 $T = 55.77'$
 $L = 101.75'$
 $E = 14.50'$
 $e = N/C$
 P.C. STA. = 300+88.52
 P.T. STA. = 301+90.27

FOR INTERSECTION GEOMETRICS
 SEE SHEET 77

PROFILE	DATE
REVISIONS	
NO.	
BY	
DATE	
NOTED	
DATE	
BY	
DATE	

