

F.A.P. RTE.	SECTION	COUNTY	TOTAL SHEETS	SHEET NO.
774	*	EFFINGHAM	273	85
FED. ROAD DIST. NO. 7		ILLINOIS	FED. AID PROJECT	
*107WRS-1, 107BY, 107BY-1 & 107B-2				
<b>CONTRACT NO. 94827</b>				

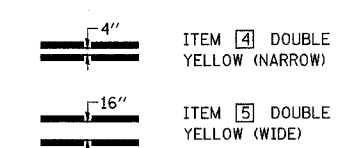
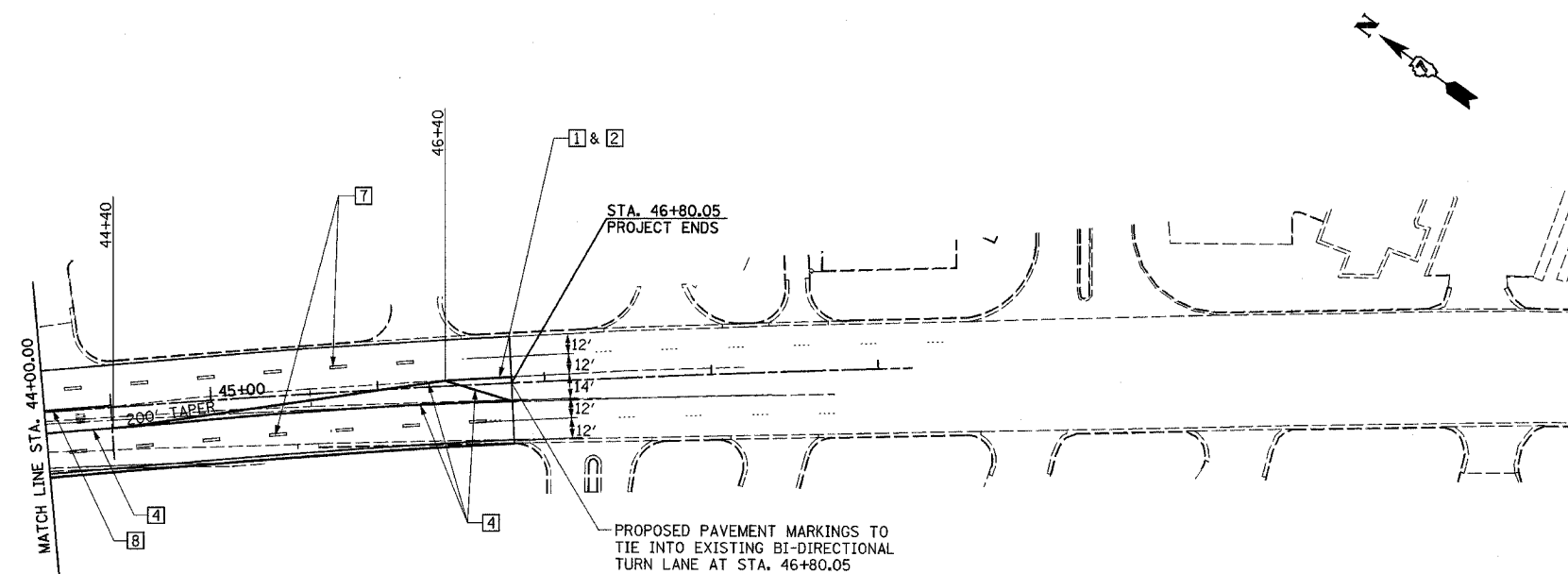
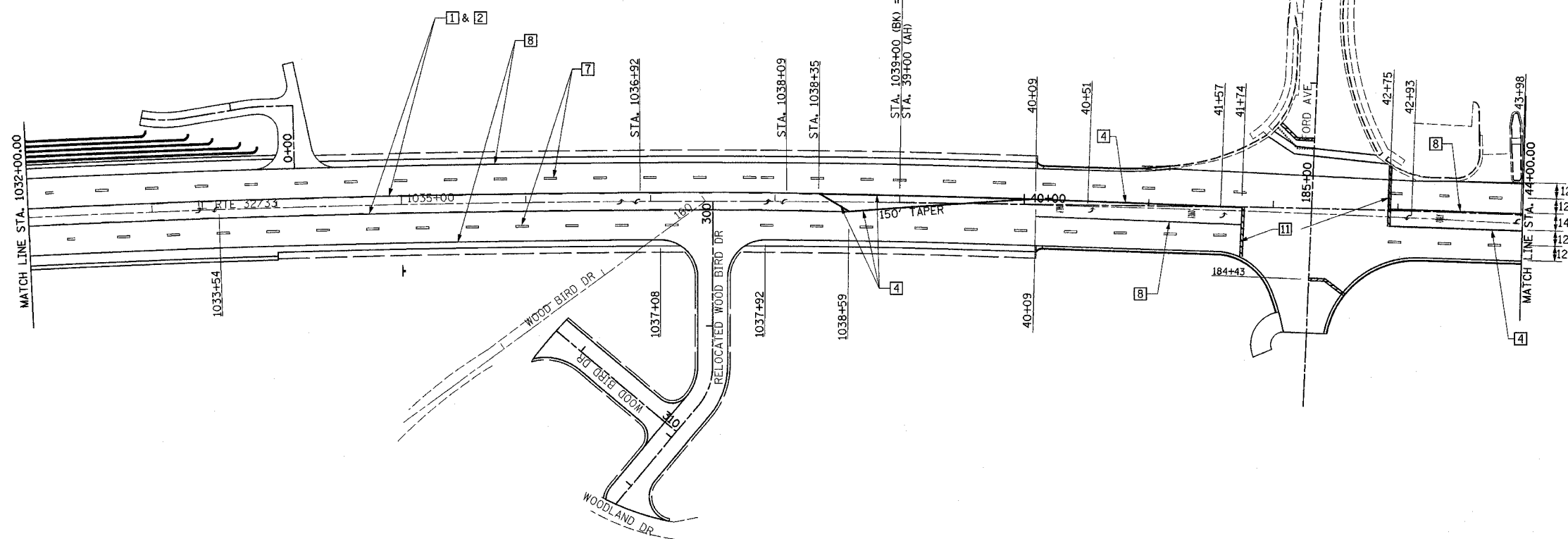

- TYPICAL PAVEMENT MARKING LEGEND**
- |   |                         |    |                    |
|---|-------------------------|----|--------------------|
| 1 | 4" SKIP-DASH YELLOW     | 7  | 6" SKIP-DASH WHITE |
| 2 | 4" SOLID YELLOW         | 8  | 4" SOLID WHITE     |
| 3 | 12" DIAGONAL YELLOW     | 9  | 12" DIAGONAL WHITE |
| 4 | 4" DOUBLE YELLOW NARROW | 10 | 6" SOLID WHITE     |
| 5 | 4" DOUBLE YELLOW WIDE   | 11 | 24" STOP BAR WHITE |

SEE STANDARD 780001 AND DISTRICT PAVEMENT MARKING DETAILS FOR ADDITIONAL DETAILS FOR PAVEMENT MARKING.

REVISIONS	
NAME	DATE

ILLINOIS DEPARTMENT OF TRANSPORTATION

**PAVEMENT MARKING PLAN**  
SHEET 6 OF 6

DATE 8/02

DRAWN BY ASB  
CHECKED BY SJK