

Benchmarks:
 BM #8: 78' RT, Sta. 981+01, Elev. 600.57
 RR Spike in Power Pole
 BM #9: 121' RT, Sta. 991+87, Elev. 558.84
 Chisled "X" in North Bolt of Fire Hydrant at
 Wabash River Hills & IL 32/33

Existing Structure: None
 Two lane, two way traffic to be maintained
 at all times per Stage Construction Plans.

STATE OF ILLINOIS
 DEPARTMENT OF TRANSPORTATION

F.A.P. SECTION	COUNTY	TOTAL SHEETS	SHEET NO.
774	EFFINGHAM	273	86

FED. ROAD DIST. NO. 7 ILLINOIS FED. AID PROJECT
 * 107WRS-1, 107BY, 107BY-1 & 107B-2
CONTRACT NO. 94827

SHEET NO. 1
 OF 3 SHEETS

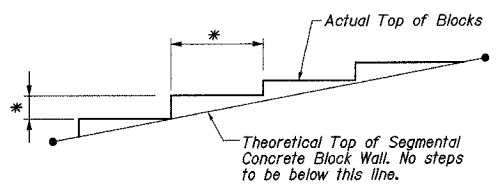
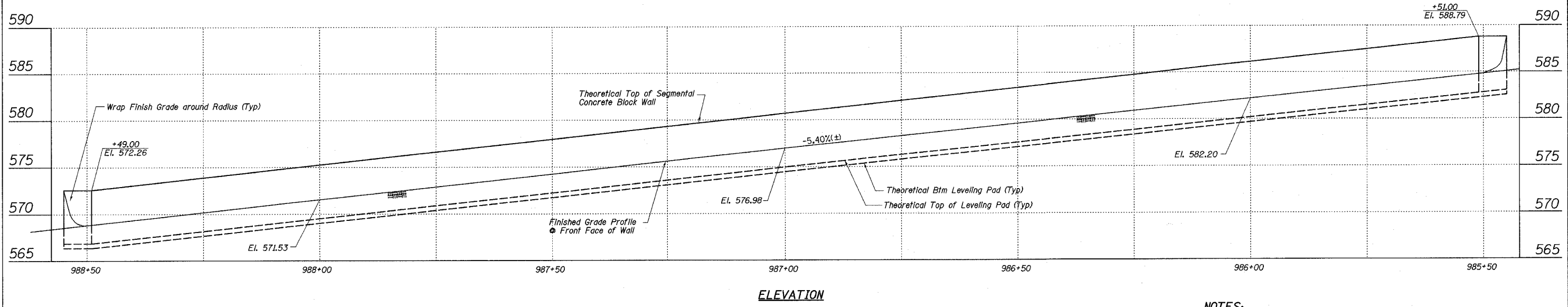
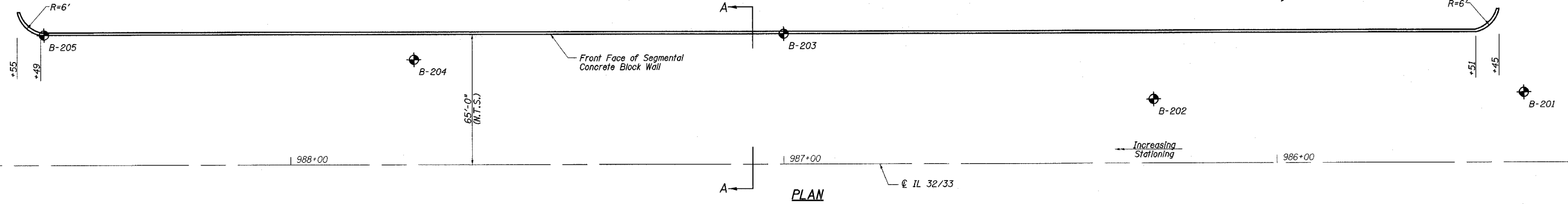

TOP OF WALL DETAIL
 * Actual Length, Location & Height of steps to be shown on shop drawings.

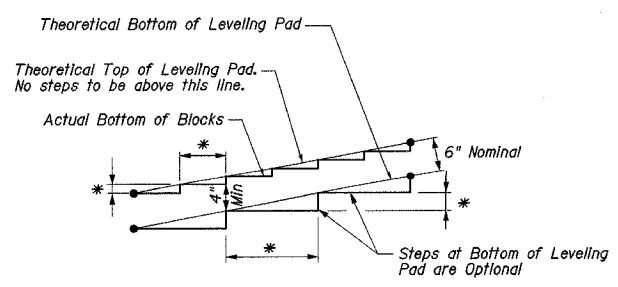

BOTTOM OF WALL DETAIL

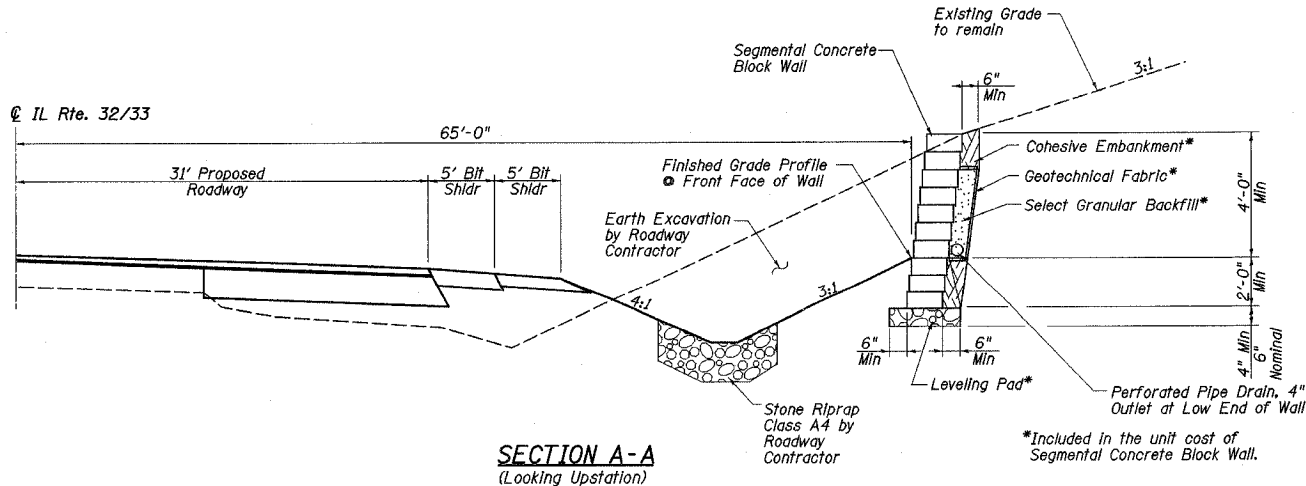

SECTION A-A
 (Looking Upstation)

NOTES:

- Block size, batter, setback and number of courses per Wall Supplier Design. See Special Provisions for additional requirements.
- Ground Line behind Wall to match Top of Segmental Concrete Block Wall Elevation.
- See Sheets 2 & 3 of 3 for Soil Borings.
- See Roadway Cross Sections, Sheets 131 & 132.

TOTAL BILL OF MATERIAL

ITEM	UNIT	QUANTITY
SEGMENTAL CONCRETE BLOCK WALL	50 FT	1901
PIPE DRAINS, 4"	FOOT	320

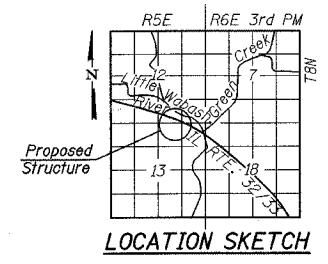

GENERAL PLAN
 ILLINOIS ROUTE 32/33
 F.A.P. ROUTE 774
 SECTION 107 WRS-1, 107BY,
 107BY-1 & 107B-2
 EFFINGHAM COUNTY
 RETAINING WALL
 STA. 985+45.00 RT. TO STA. 988+55.00 RT.