

1 2 3 4 5 6 7 8 9 10/26/2004
 10 11 12 13 14 15 16 17 18
 19 20 21 22 23 24 25 26 27
 28 29 30 31 32 33 34 35 36
 37 38 39 40 41 42 43 44 45
 46 47 48 49 50 51 52 53 54
 55 56 57 58 59 60 61 62 63

PROJECT ENGINEER : MARK DAUCHERTY
 SQUAD LEADER :
 DESIGNER : MATT HIRTZEL
 TELEPHONE : 217/342-3951 EX 313

SEE SHEET NUMBER 2
 FOR INDEX OF SHEETS

STATION EQUATIONS
 STA. 717+34.17 BK = STA. 717+12.79 AH
 STA. 820+40.90 BK = STA. 820+41.17 AH

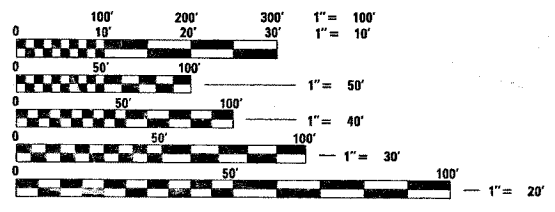

FULL SIZE PLANS HAVE BEEN PREPARED USING STANDARD ENGINEERING SCALES, REDUCED SIZED PLANS WILL NOT CONFORM TO STANDARD SCALES, IN MAKING MEASUREMENTS ON REDUCED PLANS, THE ABOVE SCALES MAY BE USED.

J.U.L.I.E.
 JOINT UTILITY LOCATION INFORMATION FOR EXCAVATION
 1-800-892-0123

CONTRACT NO. 94866
 TOWNSHIP : PATOKA, CARRIGAN

ADT = 2850

GROSS LENGTH = 12844 FEET = 2.43 MILES
 NET LENGTH = 12844 FEET = 2.43 MILES

SEAL

STATE OF ILLINOIS
 DEPARTMENT OF TRANSPORTATION
 DIVISION OF HIGHWAYS
**PLANS FOR PROPOSED
 FEDERAL HIGHWAY PROJECT**
 FAP ROUTE 322 (US ROUTE 51)
 SECTION 26RS-2
 PROJECT: NHF-0322(072)
 MARION COUNTY
 BITUMINOUS RESURFACING

C-97-051-04

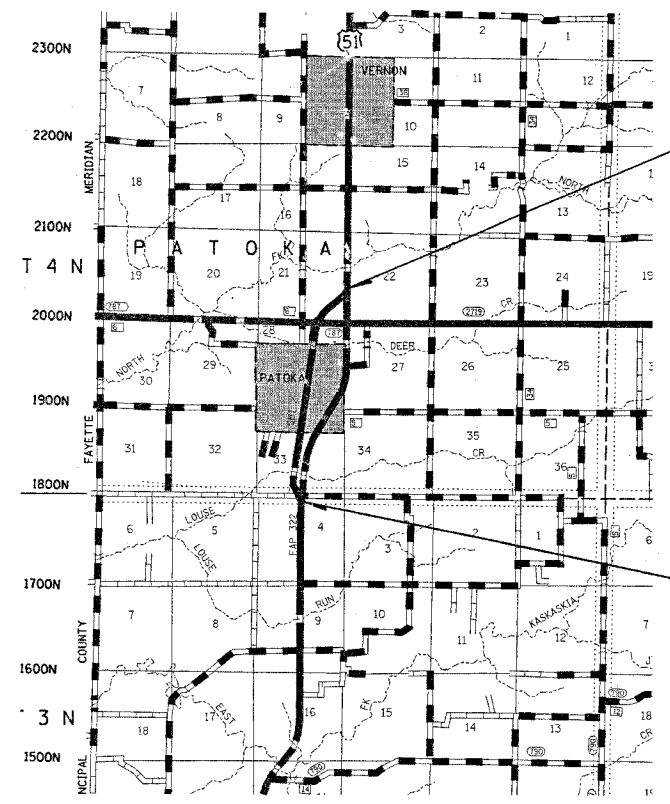

FAP ROUTE 322 (US ROUTE 51)
 SECTION 26RS-2
 MARION COUNTY
 BEGINS STA. 708+13.00

FAP ROUTE 322 (US ROUTE 51)
 SECTION 26RS-2
 MARION COUNTY
 ENDS STA. 836+36.00

FAP NO.	SECTION	COUNTY	TOTAL SHEETS	SHEET NO.
322	26RS-2	MARION	18	1

D-97-022-04

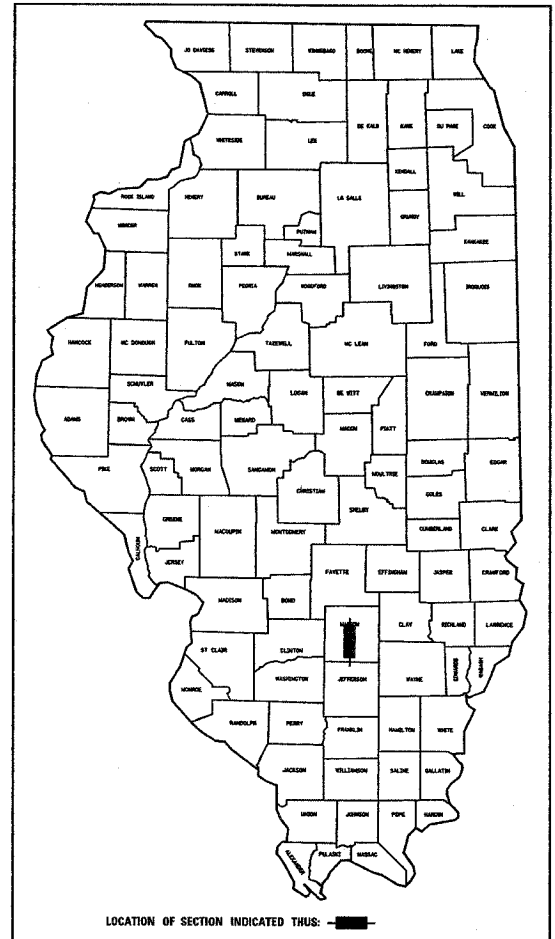

STATE OF ILLINOIS
 DEPARTMENT OF TRANSPORTATION
 DIVISION OF HIGHWAYS

SUBMITTED 10/27 20 04
Stacy E. ... DISTRICT ENGINEER

ENGINEER OF PROJECT DEVELOPMENT AND IMPLEMENTATION
May 13, 20 05
Mike Hine ENGINEER OF DESIGN AND ENVIRONMENT

ENGINEER OF DESIGN AND ENVIRONMENT
May 13, 20 05
Victor Moden DIRECTOR, DIVISION OF HIGHWAYS

PRINTED BY THE AUTHORITY OF
 THE STATE OF ILLINOIS

94866

teasleuck
4/4/2005
c:\projects\94866d\02204pa.dgn

GN & I

FAP RTE.	SECTION	COUNTY	TOTAL SHEETS	SHEET NO.
322	26RS-2	MARTON		2
FED. ROAD DIST. NO. 7		ILLINOIS	FED. AID PROJECT NO.	

CONTRACT NO. 94866

GENERAL NOTES

THIS SECTION SHALL BE CONSTRUCTED IN ACCORDANCE WITH THE PLANS, THE "STANDARD SPECIFICATIONS FOR ROAD AND BRIDGE CONSTRUCTION", ADOPTED JANUARY 1, 2002, THE "SUPPLEMENTAL SPECIFICATIONS AND RECURRING SPECIAL PROVISIONS" INDICATED ON THE CHECK SHEET, AND "THE SPECIAL PROVISIONS" INCLUDED IN THE PROPOSAL.

THE WORK INCLUDED IN THIS SECTION 26 RS-2 CONSISTS OF MILLING, LEVEL BINDER, SURFACE COURSE, CULVERT EXTENSIONS, NEW BITUMINOUS SHOULDERS, PAVMENT MARKING AND ANY OTHER WORK NECESSARY TO COMPLETE THE SECTION.

THE CONTRACTOR WILL PROVIDE INTERNET ACCESSIBILITY TO THE BITUMINOUS PLANT QUALITY CONTROL LAB SO THAT BITUMINOUS PLANT REPORTS CAN BE E-MAILED TO THE DISTRICT HEADQUARTERS. THIS WORK SHALL BE INCLUDED IN THE COST OF BITUMINOUS ITEMS.

FOR THE PAY ITEM BITUMINOUS MATERIALS (PRIME COAT), THE CONTRACTOR SHALL USE EITHER RC-70 OR AN EMULSIFIED POLYMER PRIME SS-1HP.

THE ACTUAL LOCATIONS OF PAVEMENT PATCHING SHALL BE DETERMINED BY THE ENGINEER IN THE FIELD.

MATERIAL NEEDED TO CONSTRUCT EARTH SLOPES AT FLARED END SECTIONS MAY BE OBTAINED FROM EXCAVATION AND GRADING EXISTING SHOULDERS. THIS WORK WILL NOT BE PAID FOR SEPARATELY BUT SHALL BE CONSIDERED INCLUDED IN THE BID PRICE. EXCESS MATERIAL REMOVED DURING THE EXCAVATION AND GRADING EXISTING SHOULDERS OPERATION SHALL BE DISPOSED OF OUTSIDE THE LIMITS OF THE JOB SITE IN ACCORDANCE WITH ARTICLE 202.03 OF THE STANDARD SPECIFICATIONS FOR ROAD AND BRIDGE CONSTRUCTION.

PORTIONS OF EXISTING CULVERTS MAY BE REMOVED TO FACILITATE THEIR END SECTIONS. THE ENGINEER SHALL DETERMINE THE LOCATIONS AND REMOVAL AREAS. THE COST FOR THE REMOVAL SHALL BE CONSIDERED INCLUDED IN THE UNIT PRICE OF THE PROPOSED CULVERTS INVOLVED.

ANY SPOIL MATERIAL EXCAVATED, DREDGED OR OTHERWISE PRODUCED MUST NOT BE RETURNED TO THE WATERWAY BUT MUST BE DEPOSITED IN A SELF-CONTAINED AREA IN COMPLIANCE WITH ALL STATE STATUTES, REGULATIONS AND PERMIT REQUIREMENTS WITH NO DISCHARGE TO WATERS OF THE STATE UNLESS A PERMIT HAS BEEN ISSUED BY THE ILLINOIS EPA.

ON 3R PROJECTS WHERE ROADWAY TOP WIDTH IS ADEQUATE, INCLUDE EXCAVATION FOR FULL DEPTH AGGREGATE SHOULDERS WITH EXCAVATION AND GRADING EXISTING SHOULDERS. ALL EXCAVATION IS TO BE REMOVED OFF OF PROJECT EXCEPT AS NEEDED FOR FLARED END SECTION BACKFILL OR AS DIRECTED BY THE ENGINEER.

THE TOTAL QUANTITY OF PAINT PAVEMENT MARKING - LINE 4" CONSISTS OF 3211 FT OF YELLOW AND 25295 FT OF WHITE.

SHORT TERM PAVEMENT MARKINGS ON MILLED SURFACES SHALL BE PAINT. ALL OTHER SHORT TERM PAVEMENT MARKINGS SHALL BE TAPE.

THE MATERIAL USED FOR AGGREGATE SHOULDERS, TYPE B SHALL BE CRUSHED STONE OR RAP.

THE MATERIAL USED FOR AGGREGATE SURFACE COURSE, TYPE B SHALL BE CRUSHED STONE.

THE LOCATIONS AND/OR DEPTHS OF UNDERGROUND UTILITIES SHOWN HAVE BEEN TAKEN FROM INFORMATION FURNISHED BY THE UTILITY OWNERS AND MUST BE CONSIDERED APPROXIMATE. FIELD MARKINGS OF FACILITIES IN CRITICAL AREAS MAY BE OBTAINED BY PROVIDING A MINIMUM OF 96 HOURS ADVANCE NOTICE THROUGH THE J.U.L.I.E. SYSTEM BY CALLING 800-892-0123.

THE FOLLOWING BITUMINOUS CONCRETE MIXTURE REQUIREMENTS ARE APPLICABLE TO THIS PROJECT.

MIXTURE USE(S): LEVEL BINDER MACHINE METHOD SUPERPAVE N50
AC/PG: PG 64-22
RAP %: 15%
DESIGN AIR VOIDS: 4.0% @ NDESIGN=50
MIXTURE COMPOSITION: IL-9.5
FRICTION AGGREGATE: N/A

MIXTURE USE(S): BITUMINOUS CONCRETE SURFACE COURSE SUPERPAVE MIX "C" N50
AC/PG: PG 64-22
RAP %: 15%
DESIGN AIR VOIDS: 4.0% @ NDESIGN=50
MIXTURE COMPOSITION: IL-9.5
FRICTION AGGREGATE: MIXTURE C

MIXTURE USE(S): BITUMINOUS SHOULDER
AC/PG: PG 58-22
RAP %: 15%
DESIGN AIR VOIDS: 2.0% @ NDESIGN=30
MIXTURE COMPOSITION: N/A
FRICTION AGGREGATE: N/A

INDEX OF SHEETS

SHEET NO.	DESCRIPTION
1	COVER SHEET
2	GENERAL NOTES, INDEX OF SHEETS & LIST OF STANDARDS
3	SUMMARY OF QUANTITIES
4-5	TYPICAL SECTIONS & DETAILS
6	PAVEMENT SHCHEDULE
7	ENTRANCE SCHEDULE
8	TIES
9-18	PLAN SHEETS STANDARDS

THE FOLLOWING STANDARDS ARE A PART OF THESE PLANS AND ARE INCLUDED AFTER SHEET NUMBER 18

STD. NO.	DESCRIPTION
000001-04	STANDARD SYMBOLS, ABBREVIATIONS, PATTERNS
001006	DECIMAL OF AN INCH AND OF A FOOT
442201-01	CLASS C AND D PATCHES
701006-02	OFF-ROAD OPERATIONS 2L, 2W, 4.5 m (15') TO PAVEMENT EDGE FOR SPEEDS >= 45MPH
701011-01	OFF-ROAD OPERATIONS 2L, 2W, DAY ONLY FOR SPEEDS >= 45 MPH
701201-02	LANE CLOSURE, 2L, 2W, DAY ONLY ON-ROAD TO 600 mm (24") OFF-ROAD FOR SPEEDS >= 45 MPH
701301-02	LANE CLOSURE 2L, 2W SHORT TIME OPERATIONS
701306-01	LANE CLOSURE, 2L, 2W, SLOW MOVING OPERATIONS - DAY ONLY FOR SPEEDS >= 45 MPH
701311-02	LANE CLOSURE 2L, 2W MOVING OPERATIONS-DAY ONLY
701326-02	LANE CLOSURE 2L, 2W PAVEMENT WIDENING FOR SPEEDS >= 45 MPH
701336-04	LANE CLOSURE 2L, 2W, WORK AREAS IN SERIES FOR SPEEDS >= 45 MPH
702001-05	TRAFFIC CONTROL DEVICES
780001-01	TYPICAL PAVEMENT MARKINGS
781001-02	TYPICAL APPLICATIONS RAISED REFLECTIVE PAVEMENT MARKERS

REVISIONS	
NAME	DATE

ILLINOIS DEPARTMENT OF TRANSPORTATION

**GENERAL NOTES
&
INDEX OF SHEETS**

SCALE: VERT. _____
HORIZ. _____
DATE _____

DRAWN BY _____
CHECKED BY _____

SUMMARY OF QUANTITIES

FAP NO.	SECTION	COUNTY	TOTAL SHEETS	SHEET NO.
322	26RS-2	MARION	18	3
FED. ROAD DIST. NO. 7		ILLINOIS		FED. AID PROJECT NO.
CONTRACT NO. 94866				

CKT 10/28/04
 \94866\d02204pa.dgn
 SOO

SUMMARY OF QUANTITIES			BOI/FED. 20% STATE	CONSTRUCTION TYPE CODE	
CODE NO	ITEM	UNIT	TOTAL QUANTITIES	1000	SFTY-2A
20200600	EXCAVATING AND GRADING EXISTING SHOULDER	UNIT	257	257	
20300100	CHANNEL EXCAVATION	CU YD	305	305	
25001000	SEEDING, CLASS 2 (SPECIAL)	ACRE	0.5	0.5	
20100100	STONE RIPRAP, CLASS A2	CG YD	87	87	
20100107	STONE RIPRAP, CLASS A4	SG YD	87	87	
20000100	FILTER FABRIC FOR USE WITH RIPRAP	SG YD	154	154	
40200800	AGGREGATE SURFACE COURSE, TYPE B	TON	30	30	
40600100	BITUMINOUS MATERIALS (PRIME COAT)	GALLON	4281	4281	
40600300	AGGREGATE (PRIME COAT)	TON	86	86	
40600895	CONSTRUCTING TEST STRIP	EACH	1	1	
40600980	BITUMINOUS SURFACE REMOVAL - BUTT JOINT	SG YD	267	267	
40600990	TEMPORARY RAMP	SG YD	27	27	
44000030	BITUMINOUS SURFACE REMOVAL (VARIABLE DEPTH)	SG YD	33984	33984	
44201815	CLASS D PATCHES, TYPE II, 14 INCH	SG YD	1400	1400	
44201819	CLASS D PATCHES, TYPE III, 14 INCH	SG YD	204	204	
44201821	CLASS D PATCHES, TYPE IV, 14 INCH	SG YD	281	281	
48101200	AGGREGATE SHOULDERS, TYPE B	TON	754	754	
48101500	AGGREGATE SHOULDERS, TYPE B 6"	SG YD	1890	1890	
48202315	BITUMINOUS SHOULDERS SUPERPAVE 5 3/4"	SG YD	8563	8563	
54213669	PRECAST REINFORCED CONCRETE FLARED END SECTIONS 24"	EACH	4	4	
54213675	PRECAST REINFORCED CONCRETE FLARED END SECTIONS 30"	EACH	1	1	
54213693	PRECAST REINFORCED CONCRETE FLARED END SECTIONS 48"	EACH	4	4	
54248515	CONCRETE COLLAR	EACH	9	9	
63000000	STEEL PLATE BEAM GUARD RAIL, TYPE A	FOOT	1062.5	1062.5	
63100167	TRAFFIC BARRIER TERMINAL TYPE 1, SPECIAL (TANGENT)	EACH	0	0	
66700205	PERMANENT SURVEY MARKERS, TYPE I	EACH	9	9	
67000500	ENGINEER'S FIELD OFFICE, TYPE B	CAL MO	3	3	
67100100	MOBILIZATION	L SUM	1	1	
70100450	TRAFFIC CONTROL AND PROTECTION, STANDARD 701201	L SUM	1	1	
70100460	TRAFFIC CONTROL AND PROTECTION, STANDARD 701306	L SUM	1	1	
70100500	TRAFFIC CONTROL AND PROTECTION, STANDARD 701326	L SUM	1	1	
70100600	TRAFFIC CONTROL AND PROTECTION, STANDARD 701336	L SUM	1	1	

SUMMARY OF QUANTITIES			BOI/FED. 20% STATE	CONSTRUCTION TYPE CODE	
CODE NO	ITEM	UNIT	TOTAL QUANTITIES	1000	SFTY-2A
70103815	TRAFFIC CONTROL SURVEILLANCE	CAL DA	7	7	
70300100	SHORT-TERM PAVEMENT MARKING	FOOT	5136	5136	
70300220	TEMPORARY PAVEMENT MARKING - LINE 4"	FOOT	28506	28506	
70301000	WORK ZONE PAVEMENT MARKING REMOVAL	SG FT	428	428	
* 78001110	PAINT PAVEMENT MARKING - LINE 4"	FOOT	28506	28506	
* 78100100	RAISED REFLECTIVE PAVEMENT MARKER	EACH	161	161	
* 78200410	CHADBALL MARKERS, TYPE A	EACH	20	20	
* 78301000	TERMINAL MARKER - DIRECT APPLIED	EACH	0	0	
X4066414	BITUMINOUS CONCRETE SURFACE COURSE, SUPERPAVE, MIX "C", N50	TON	3596	3591	5
X4066765	LEVELING BINDER (MACHINE METHOD), SUPERPAVE N50	TON	1798	1793	5
X4080020	INCIDENTAL BITUMINOUS SURFACING, SUPERPAVE, N50	TON	61	61	

* SPECIALTY ITEMS

REVISIONS	
NAME	DATE

ILLINOIS DEPARTMENT OF TRANSPORTATION

SUMMARY OF QUANTITIES

SCALE: VERT. DATE
HORIZ. DATE

DRAWN BY
CHECKED BY

teesleyck
4/4/2005
c:\projects\94866\d02204pa.dgn
TYP 1

FAP NO.	SECTION	COUNTY	TOTAL SHEETS	SHEET NO.
322	26RS-2	MARION	18	4
FED. ROAD DIST. NO. 7		ILLINOIS	FED. AID PROJECT NO.	

CONTRACT NO. 94866

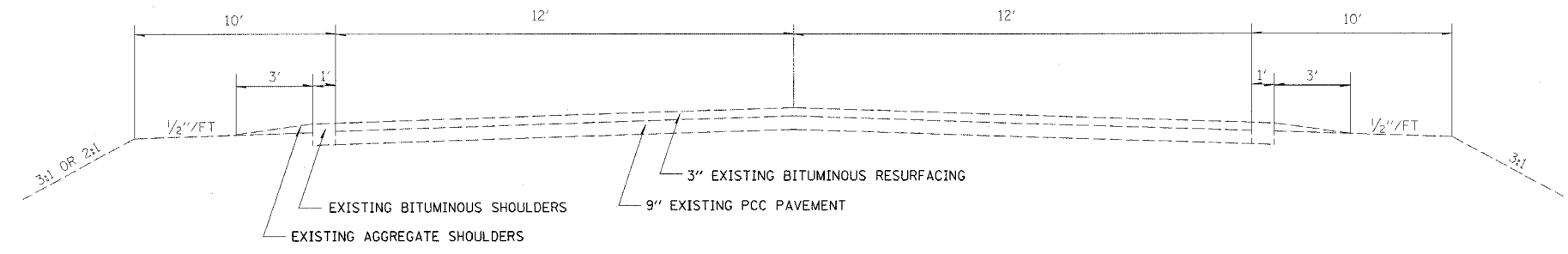

EXISTING

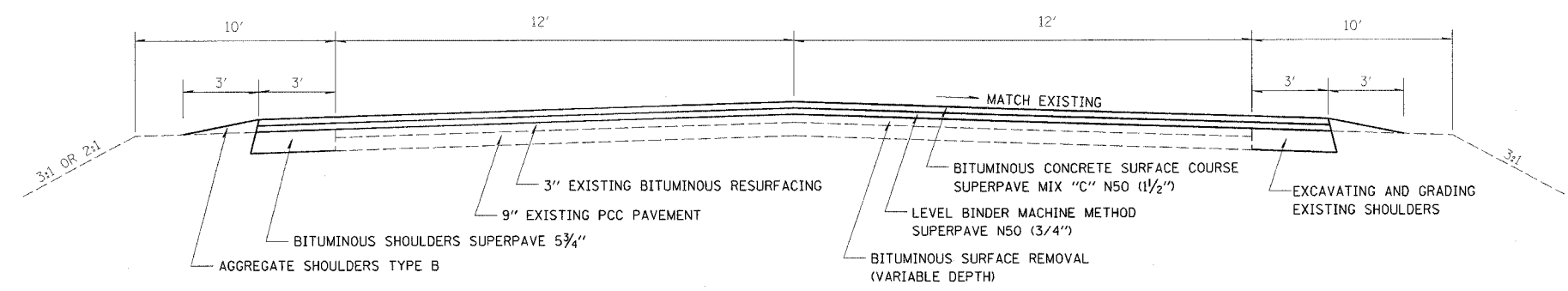

PROPOSED

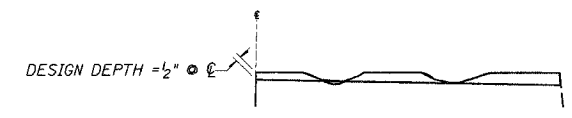

NOTES:

- MILLING SHALL BE DONE TO ATTAIN A 3/16"'/ SLOPE IN CROWN SECTIONS
- EXISTING S.E. AND S.E. TRANSITIONS SHALL BE MAINTAINED UNLESS OTHERWISE SHOWN ON THE PLANS.
- MILLING TO THE BOTTOM OF WHEEL RUTS SHALL NOT BE NECESSARY UNLESS REQUIRED TO OBTAIN SLOPE OR THE DESIGN DEPTH AT CENTERLINE.
- THE AVERAGE DEPTH OF MILLING IS ESTIMATED TO BE 1/2" BUT MAY VARY IN ISOLATED LOCATIONS.

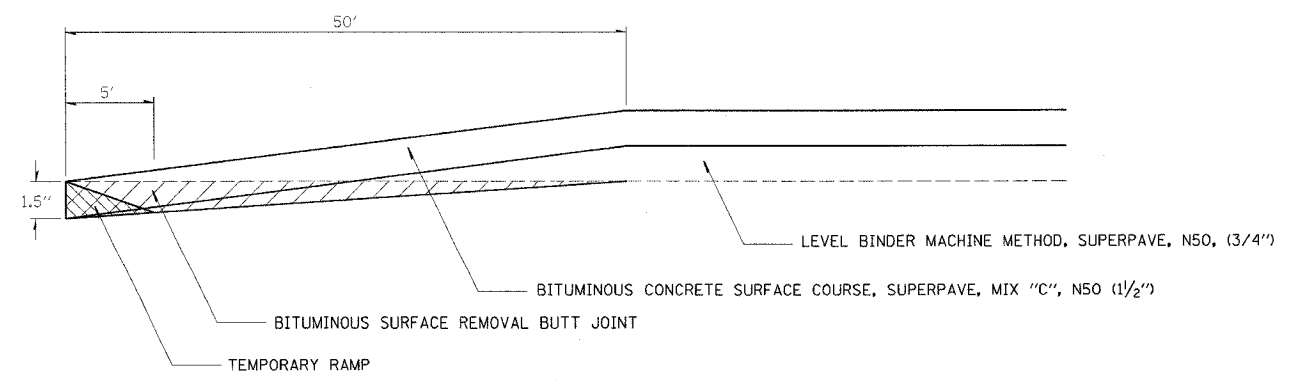

BUTT JOINT DETAIL

STATION 708+13 TO STATION 708+63
STATION 835+86 TO STATION 836+36

REVISIONS	
NAME	DATE

ILLINOIS DEPARTMENT OF TRANSPORTATION

TYPICALS

SCALE: VERT.
HORIZ.
DATE

DRAWN BY
CHECKED BY

tees\eyck
4/4/2005
c:\projects\94866\d02204pa.dgn
TYP 2

FAP NO.	SECTION	COUNTY	TOTAL SHEETS	SHEET NO.
322	26RS-2	MARION	18	5

FED. ROAD DIST. NO. 7 ILLINOIS FED. AID PROJECT NO.
CONTRACT NO. 94866

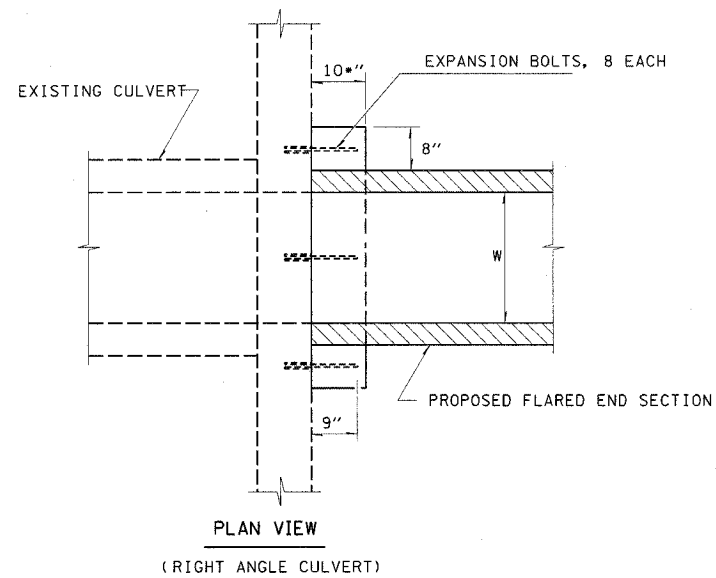

CONCRETE COLLAR
STA. 718+79 LT
STA. 746+94 LT
STA. 746+94 RT
STA. 784+20 LT
STA. 784+20 RT

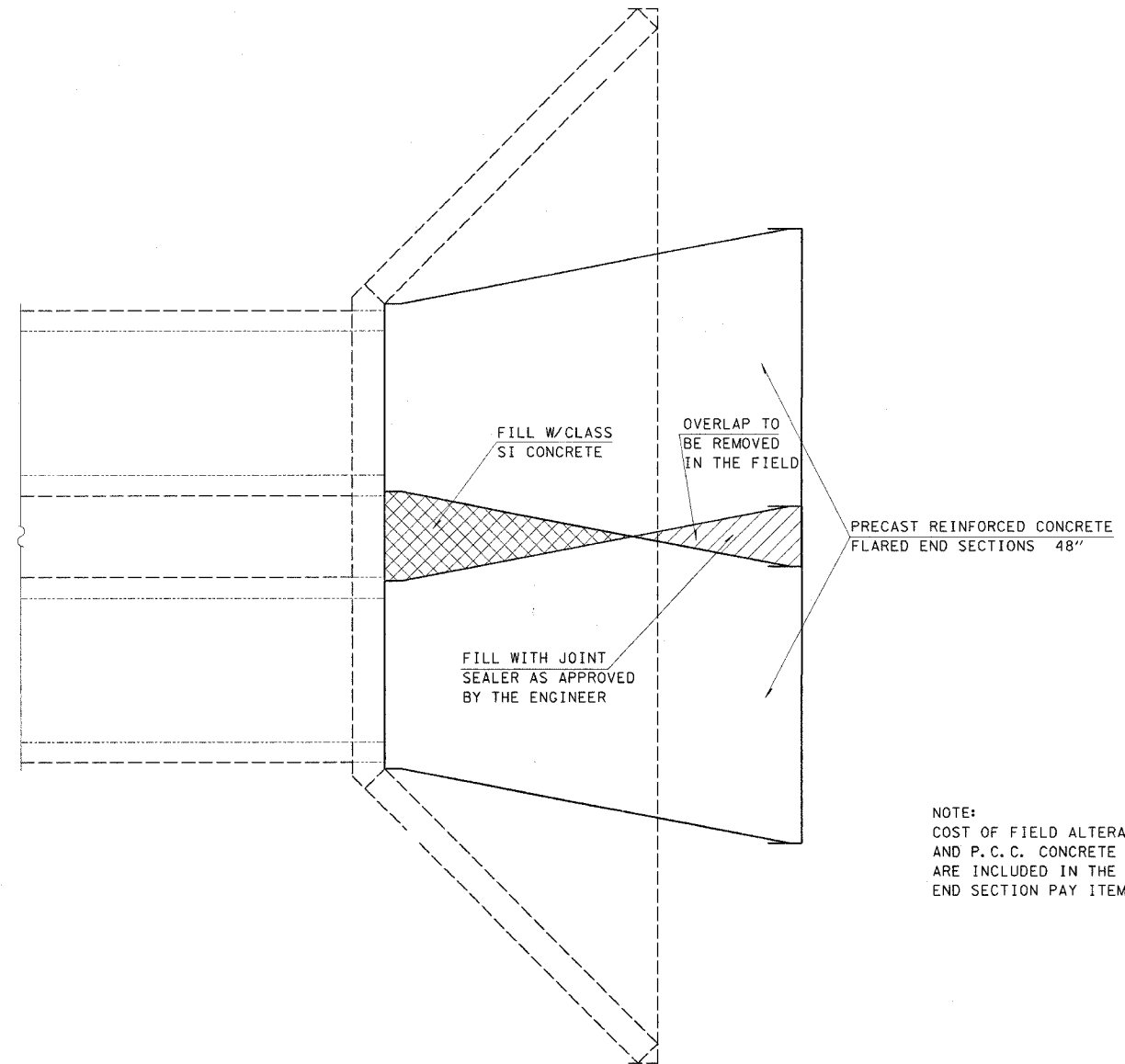

NOTE:
COST OF FIELD ALTERATIONS
AND P.C.C. CONCRETE FILLER
ARE INCLUDED IN THE FLARED
END SECTION PAY ITEM.

F.E.S. DETAIL
STA. 784+20 LT
STA. 784+20 RT

REVISIONS	
NAME	DATE

ILLINOIS DEPARTMENT OF TRANSPORTATION

DETAILS

SCALE: VERT.
HORIZ.
DATE

DRAWN BY
CHECKED BY

teos\eyck
4/4/2005
c:\projects\94866d\02204pa.dgn
PVS

FAP RTE.	SECTION	COUNTY	TOTAL SHEETS	SHEET NO.
322	26RS-2	MARION	/B	6
FED. ROAD DIST. NO. 1		ILLINOIS	FED. AID PROJECT NO.	

CONTRACT NO. 94866

PAVING SCHEDULE

STATION TO STATION	LENGTH	EXISTING PAVEMENT WIDTH	AREA	EXCAVATING AND GRADING EXISTING SHOULDERS	BITUMINOUS MATERIALS (PRIME COAT)	AGGREGATE (PRIME COAT)	BITUMINOUS SURFACE REMOVAL - BUTT JOINT	TEMPORARY RAMP	BITUMINOUS SURFACE REMOVAL (VARIABLE DEPTH)	AGGREGATE SHOULDERS, TYPE B	BITUMINOUS SHOULDERS SUPERPAVE 5 3/4"	SHORT-TERM PAVEMENT MARKING	TEMPORARY PAVEMENT MARKING - LINE 4"	WORK ZONE PAVEMENT REMOVAL	BCSC, SUPERPAVE, MIX "C", N50	LEVEL BINDER (MACHINE METHOD), SUPERPAVE N50
	LIN FT	FEET	SQ YD	UNIT	GAL	TON	SQ YD	SQ YD	SQ YD	TON	SQ YD	FOOT	FOOT	SQ FT	FOOT	TON
708+13.00 TO 717+34.17	921.2	24	2456.5	18.4	307.1	6.1	133.3	13.3	2323.1	61	614	368	2072	31	258	129
STA. EQ 717+34.17 BK = 717+12.79 AH																
717+12.79 TO 820+40.90	10328.1	24	27541.6	206.6	3442.7	68.9			27541.6	591	6886	4132	22955	344	2892	1446
STA. EQ. 820+40.90 BK = 820+41.17 AH																
820+41.17 TO 836+36.00	1594.8	24	4252.8	31.8	531.6	10.6	133.3	13.3	4119.5	102	1063	636	3479	53	446	223
TOTAL QUANTITIES	12844.10		34251	257	4281	86	267	27	33984	754	8563	5136	28506	428	3596	1798

REVISIONS	
NAME	DATE

ILLINOIS DEPARTMENT OF TRANSPORTATION

**PAVEMENT
SCHEDULE**

SCALE: VERT.
HORIZ.
DATE

DRAWN BY
CHECKED BY

FAP #/E.	SECTION	COUNTY	TOTAL SHEETS	SHEET NO.
322	26RS-2	MARION	18	7
FED. ROAD DIST. NO. 7		S.L. LINES		FED. AID PROJECT NO.
CONTRACT NO. 94866				

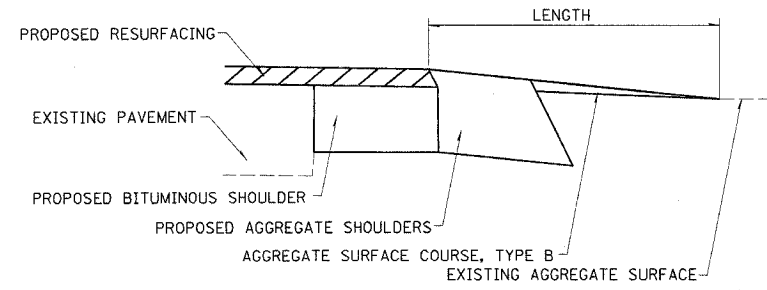
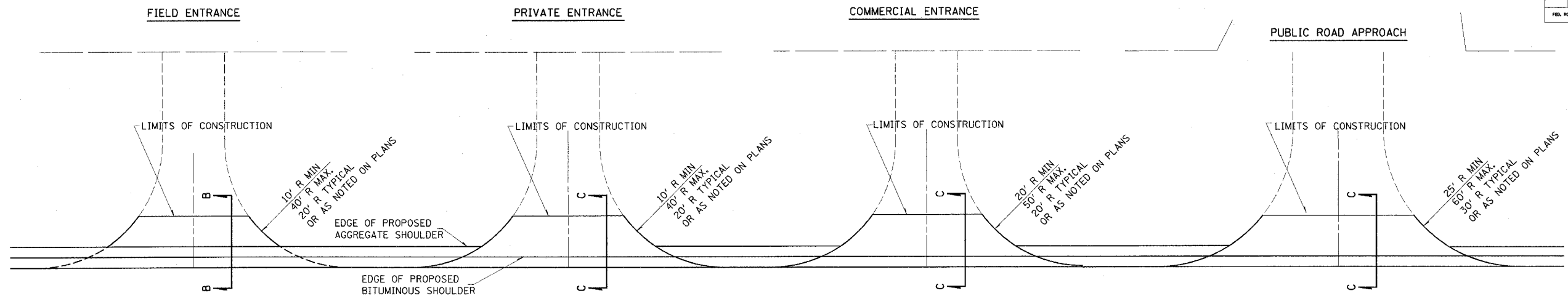

SECTION B-B

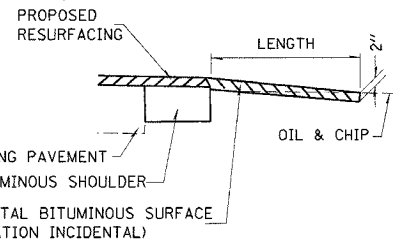
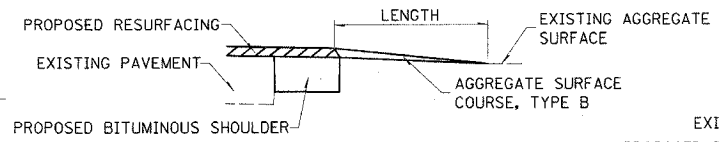

SECTION C-C

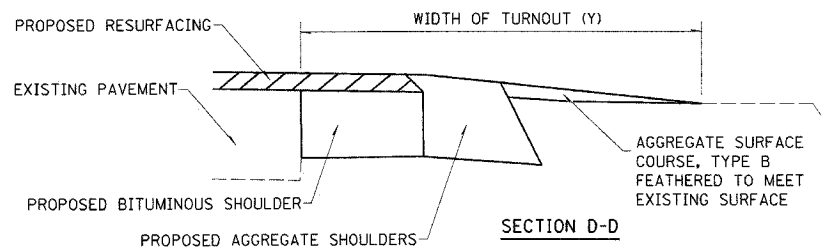
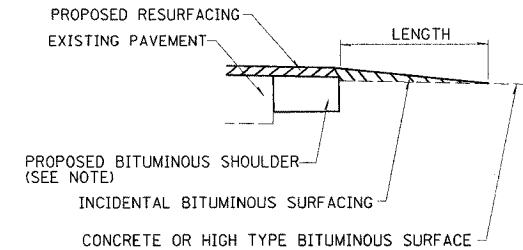

TYPICAL SECTION AT MAILBOX TURNOUT

NOTE: SEE STANDARD 406201 FOR MAILBOX TURNOUT DETAILS

NOTES

LENGTH = 10' UNLESS OTHERWISE NOTED ON PLANS

THE THICKNESS OF THE BITUMINOUS SHOULDERS THROUGH COMMERCIAL ENTRANCES (BITUMINOUS) AND PUBLIC ROADS SHALL BE 10". THE COST OF THE EXTRA THICKNESS SHALL BE INCLUDED WITH THE BITUMINOUS SHOULDERS PAY ITEM.

THE COST OF THE BITUMINOUS MATERIALS AND AGGREGATE (PRIME COAT) FOR ENTRANCES AND PUBLIC ROAD APPROACHES SHALL BE INCLUDED IN THE PAY ITEM INCIDENTAL BITUMINOUS SURFACING.

BITUMINOUS SHOULDERS SHALL NOT BE CONSTRUCTED THROUGH A PCC ENTRANCE OR PCC PUBLIC ROAD APPROACH.

SIDE	STATION	TYPE	INCIDENTAL BITUMINOUS SURFACING*		AGGREGATE SURFACE COURSE, TYPE B
			TON	TON	
LT	720+25	PRA	10.3		
RT	720+25	PRA	5.3		
LT	746+60	PRA	5		
RT	746+60	PRA	7.5		
LT	773+60	PRA	8.2		
RT	773+83	PRA	7.8		
LT	782+56	FE		2.1	
RT	782+56	FE		2.1	
LT	792+98	FE		2.1	
RT	792+98	PE		5.9	
LT	805+00	FE		2.1	
RT	805+00	PE		5.9	
LT	812+17	FE		2.1	
RT	812+31	FE		3	
LT	817+96	FE		2.1	
RT	817+96	FE		2.1	
LT	831+60	PRA	11.2		
RT	831+60	PRA	5.9		
TOTALS			61	30	

FE - FIELD ENTRANCE
 PE - PRIVATE ENTRANCE
 CE - COMMERCIAL ENTRANCE
 PRA - PUBLIC ROAD APPROACH
 MBT - MAILBOX TURNOUT

*BITUMINOUS MATERIALS AND AGGREGATE (PRIME COAT) FOR ENTRANCES AND PUBLIC ROAD APPROACHES SHALL BE CONSIDERED INCIDENTAL TO INCIDENTAL BITUMINOUS SURFACING AS NOTED IN THE SPECIAL PROVISIONS

teos\ejck
 4/4/2005
 c:\projects\94866d\02204pa.dgn
 PS 2

FAP R/L	SECTION	COUNTY	TOTAL SHEETS	SHEET NO.
322	26RS-2	MARION	18	9
FED. ROAD DIST. NO. 1		ILLINOIS	FED. AID PROJECT NO.	
CONTRACT NO. 94866				

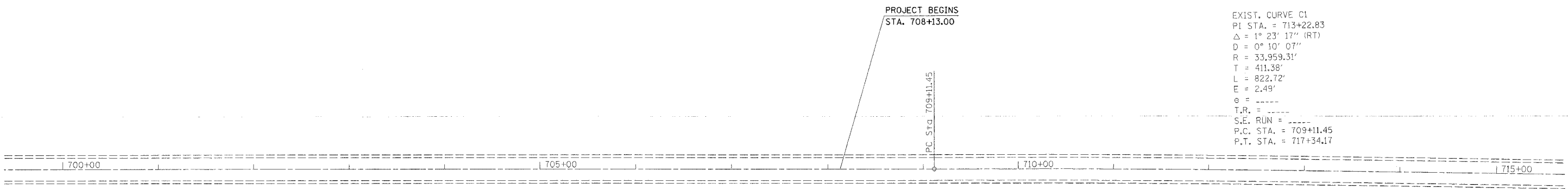
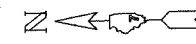

EXIST. CURVE C1
 PI STA. = 713+22.83
 $\Delta = 1^\circ 23' 17''$ (RT)
 $D = 0^\circ 10' 07''$
 $R = 33,959.31'$
 $T = 411.38'$
 $L = 822.72'$
 $E = 2.49'$
 $\theta = \text{---}$
 $T.R. = \text{---}$
 $S.E. RUN = \text{---}$
 $P.C. STA. = 709+11.45$
 $P.T. STA. = 717+34.17$

REVISIONS	
NAME	DATE

ILLINOIS DEPARTMENT OF TRANSPORTATION

**STA 700 + 00
 TO
 STA 715 + 00**

SCALE: VERT. _____
 HORIZ. _____
 DATE _____

DRAWN BY _____
 CHECKED BY _____

teas:leuck
 4/4/2005
 c:\projects\94866d\02204pa.dgn
 PS 3

FAP RTE.	SECTION	COUNTY	TOTAL SHEETS	SHEET NO.
322	26RS-2	MARION	18	10
FED. ROAD DIST. NO. 7		ILLINOIS	FED. AID PROJECT NO.	

CONTRACT NO. 94866

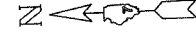

30" RCCP 718+79 LT	TOTALS
PRECAST REINFORCED CONCRETE FLARED END SECTIONS 30"	1 EACH
CONCRETE COLLAR	1 EACH

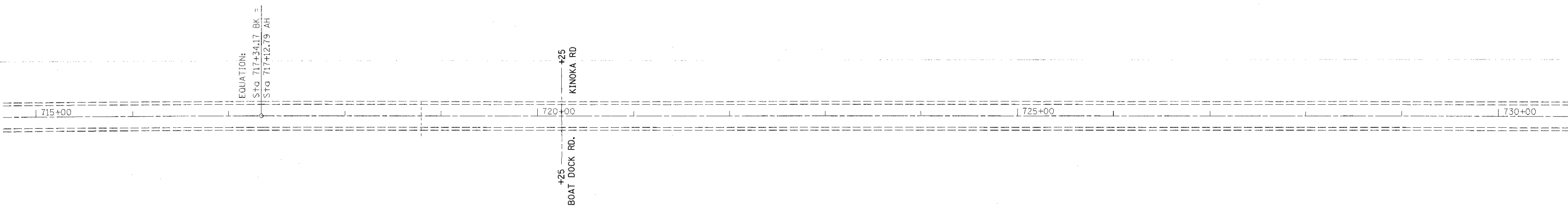

REVISIONS	
NAME	DATE

ILLINOIS DEPARTMENT OF TRANSPORTATION
STA 715 + 00
TO
STA 730 + 00
 SCALE: VERT. DATE HORIZ. DATE DRAWN BY CHECKED BY

teesleyck
 4/4/2005
 c:\projects\94866d\02204pa.dgn

PS 4

FAP RTE.	SECTION	COUNTY	TOTAL SHEETS	SHEET NO.
322	26RS-2	MARION	18	11
FED. ROAD DIST. NO. 7		ILLINOIS	FED. AID PROJECT NO.	

CONTRACT NO. 94866

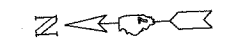

AGGREGATE SHOULDERS, TYPE B 6"	SQ YD
LT STA 729+21.75 TO STA 736+43.25	561
RT STA 728+83.00 TO STA 737+42.00	668
TOTAL	1229

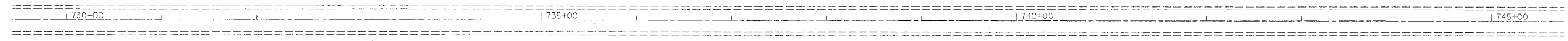

REVISIONS		ILLINOIS DEPARTMENT OF TRANSPORTATION
NAME	DATE	
		STA 730 + 00 TO STA 745 + 00

SCALE: VERT.
 DATE: HORIZ.
 DRAWN BY
 CHECKED BY

tees\eyck
 4/4/2005
 c:\projects\94866d\02204pa.dgn
 PS 5

FAP RTE.	SECTION	COUNTY	TOTAL SHEETS	SHEET NO.
322	26RS-2	MARION	18	12
FED. ROAD DIST. NO. 7		ILLINOIS	FED. AID PROJECT NO.	

CONTRACT NO. 94866

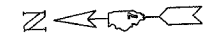

DOUBLE 24" RCCP 746+94 LT	TOTALS
PRECAST REINFORCED CONCRETE FLARED END SECTIONS 24"	2 EACH
CONCRETE COLLAR	2 EACH

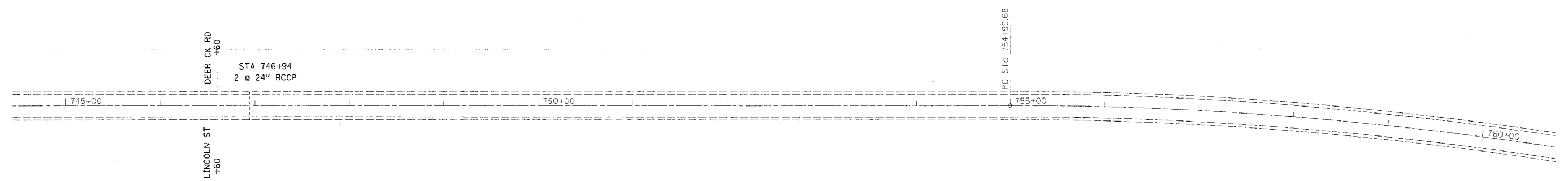

DOUBLE 24" RCCP 746+94 RT	TOTALS
PRECAST REINFORCED CONCRETE FLARED END SECTIONS 24"	2 EACH
CONCRETE COLLAR	2 EACH

NOTE: SEE DETAIL SHEET 5

REVISIONS		ILLINOIS DEPARTMENT OF TRANSPORTATION
NAME	DATE	
		<p align="center">STA 745 + 00 TO STA 760 + 00</p> <p>SCALE: VERT. DRAWN BY HORIZ. CHECKED BY DATE</p>

teesleyck
 4/4/2005
 c:\projects\94866d\02201pa.dgn
 PS 6

FAP NO.	SECTION	COUNTY	TOTAL SHEETS	SHEET NO.
322	26RS-2	MARION	18	13
FED. ROAD DIST. NO. 7		ILLINOIS	FED. AID PROJECT NO.	

CONTRACT NO. 94866



EXIST. CURVE C2
 PI STA. = 765+51.21
 $\Delta = 30^\circ 46' 23''$ (RT)
 $D = 1^\circ 29' 58''$
 $R = 3,821.07'$
 $T = 1,051.53'$
 $L = 2,052.26'$
 $E = 142.05'$
 $\theta =$ -----
 $T.R. =$ -----
 S.E. RUN = -----
 P.C. STA. = 754+99.68
 P.T. STA. = 775+51.94

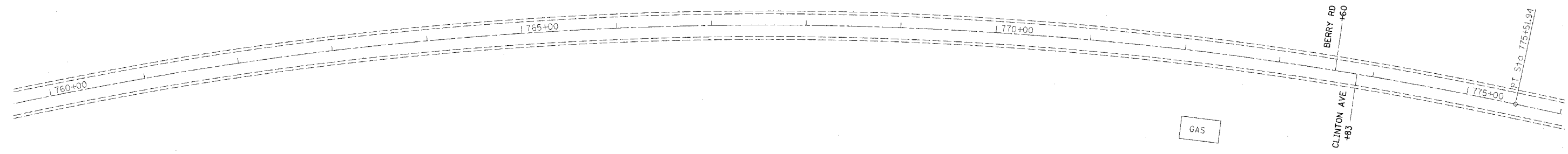

REVISIONS	
NAME	DATE

ILLINOIS DEPARTMENT OF TRANSPORTATION

**STA 760+00
 TO
 STA 775+00**

SCALE: VERT. _____
 HORIZ. _____

DATE _____ DRAWN BY _____
 CHECKED BY _____

teasleuck
 4/4/2005
 c:\projects\94866d\02204ps.dgn
 ps 7

FAP SITE	SECTION	COUNTY	TOTAL SHEETS	SHEET NO.
322	26RS-2	MARION	18	14
FED. ROAD DIST. NO. 1		ILLINOIS	FED. AID PROJECT NO.	

CONTRACT NO. 94866

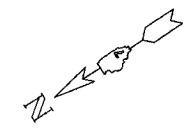

DOUBLE 48" RCCP 784+20 LT	TOTALS
PRECAST REINFORCED CONCRETE FLARED END SECTIONS 48"	2 EACH
CONCRETE COLLAR	2 EACH

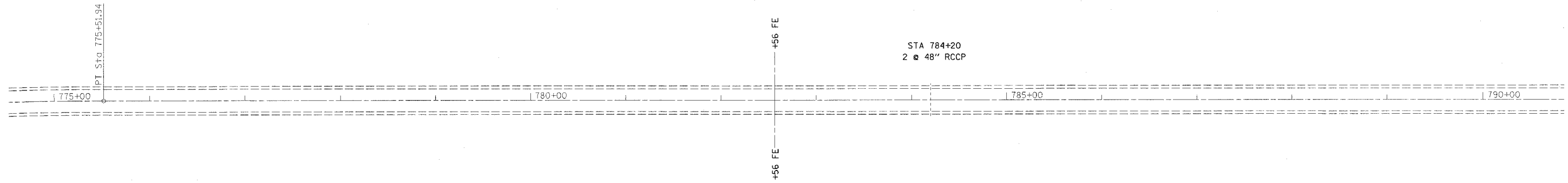

STA 784+20
 2 @ 48" RCCP

DOUBLE 48" RCCP 784+20 RT	TOTALS
PRECAST REINFORCED CONCRETE FLARED END SECTIONS 48"	2 EACH
CONCRETE COLLAR	2 EACH

NOTE: SEE DETAIL SHEET 5

REVISIONS	
NAME	DATE

ILLINOIS DEPARTMENT OF TRANSPORTATION

STA 775 + 00
TO
STA 790 + 00

SCALE: VERT. _____
 DATE: _____ HORIZ. _____

DRAWN BY _____
 CHECKED BY _____

teasleyck
 4/4/2005
 c:\projects\94866d\02204pa.dgn
 PS 8

FAP NO.	SECTION	COUNTY	TOTAL SHEETS	SHEET NO.
322	26RS-2	MARION	18	15
FED. ROAD DIST. NO. 7		ILLINOIS	FED. AID PROJECT NO.	

CONTRACT NO. 94866

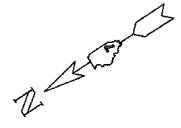
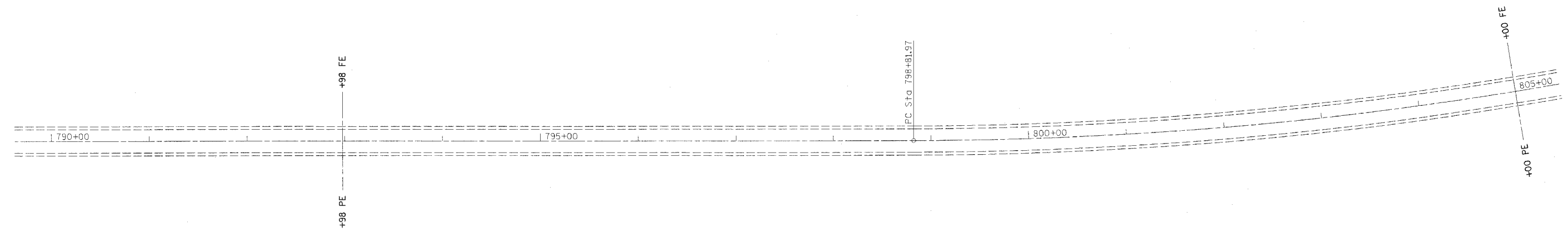

REVISIONS	
NAME	DATE

ILLINOIS DEPARTMENT OF TRANSPORTATION

**STA 790+00
 TO
 STA 805+00**

SCALE: VERT. _____
 HORIZ. _____

DATE _____ DRAWN BY _____
 CHECKED BY _____

teasleuck
 4/4/2005
 c:\projects\94866d\02204pa.dgn
 PS @

FAP No.	SECTION	COUNTY	TOTAL SHEETS	SHEET NO.
322	26RS-2	MARION	18	16
FED. ROAD DIST. NO. 7		BLINDS	FED. AID PROJECT NO.	

CONTRACT NO. 94866

AGGREGATE SHOULDERS, TYPE B 6"	SQ YD
LT STA 813+50.50 TO STA 817+80.00	301
RT STA 812+79.50 TO STA 817+84.00	360
TOTAL	661



EXIST. CURVE C3
 PI STA. = 809+91.13
 $\Delta = 32^\circ 23' 19''$ (LT)
 $D = 1^\circ 30' 01''$
 $R = 3,819.18'$
 $T = 1,109.16'$
 $L = 2,158.93'$
 $E = 157.80'$
 $\theta = \text{-----}$
 T.R. = -----
 S.E. RUN = -----
 P.C. STA. = 798+81.97
 P.T. STA. = 820+40.90

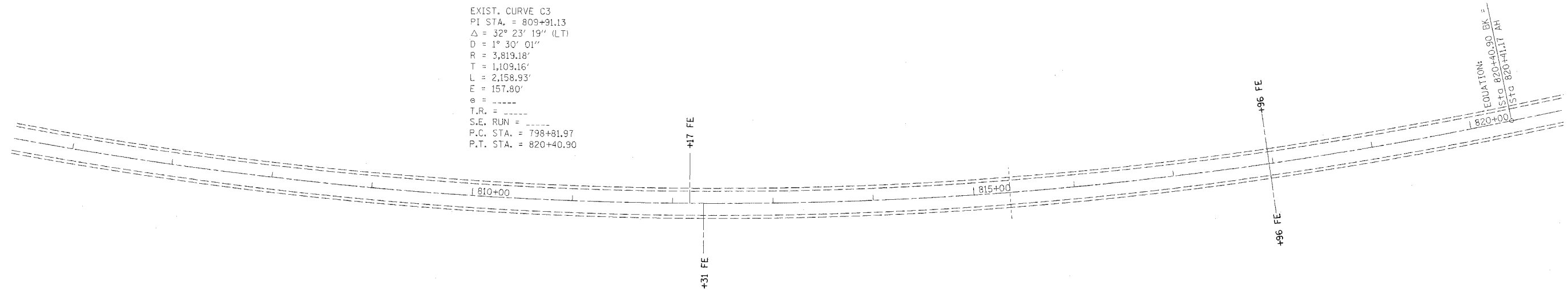

REVISIONS	
NAME	DATE

ILLINOIS DEPARTMENT OF TRANSPORTATION

**STA 805 + 00
 TO
 STA 820 + 00**

SCALE: VERT. _____
 HORIZ. _____
 DATE _____ DRAWN BY _____
 CHECKED BY _____

teasleyck
 4/4/2005
 c:\projects\94866d\02204pa.dgn
 PS 10

FAP RTE.	SECTION	COUNTY	TOTAL SHEETS	SHEET NO.
322	26RS-2	MARION	18	17
FED. ROAD DIST. NO. 1		ILLINOIS	FED. AID PROJECT NO.	
CONTRACT NO. 94866				

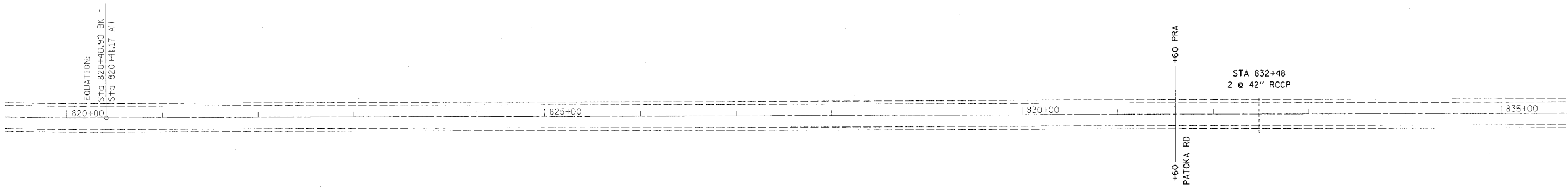
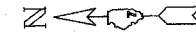

EQUATION:
 STG 820+40.90 BK =
 ISTO 820+41.17 AH

REVISIONS	
NAME	DATE

ILLINOIS DEPARTMENT OF TRANSPORTATION

STA 820 + 00
TO
STA 835 + 00

SCALE: VERT. DRAWN BY
 HORIZ. CHECKED BY
 DATE

teaslejack
 4/4/2005
 c:\projects\94866\d02204pa.dgn
 PS 11

FAP ATEL	SECTION	COUNTY	TOTAL SHEETS	SHEET NO.
322	26RS-2	MARION	18	18
FED. ROAD DIST. NO. 1		ILLINOIS	FED. AID PROJECT NO.	

CONTRACT NO. 94866

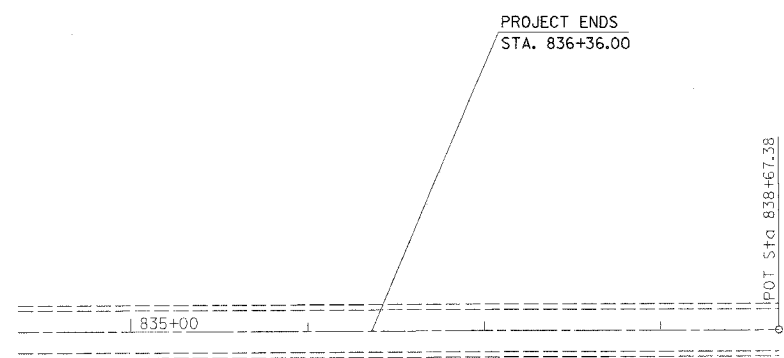
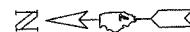

REVISIONS	
NAME	DATE

ILLINOIS DEPARTMENT OF TRANSPORTATION

**STA 835 + 00
 TO
 STA 838 + 67.38**

SCALE: VERT.
 HORIZ.
 DATE

DRAWN BY
 CHECKED BY