

ROUTE	SECTION	CITY	TOTAL SHEETS	SHEET NO.
F.A.U. 8533	99-00043-00-PV	FLORA	18	10
CONTRACT NO. 95420		ILLINOIS	PROJECT M-5023(9)	

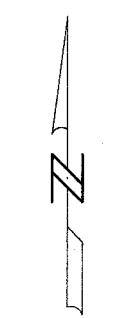

SCALE 1" = 10'

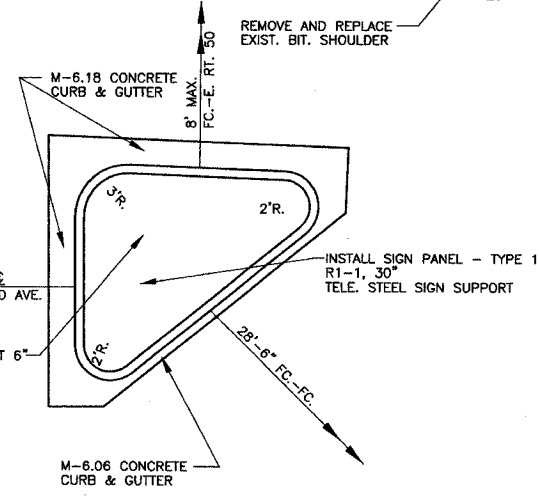
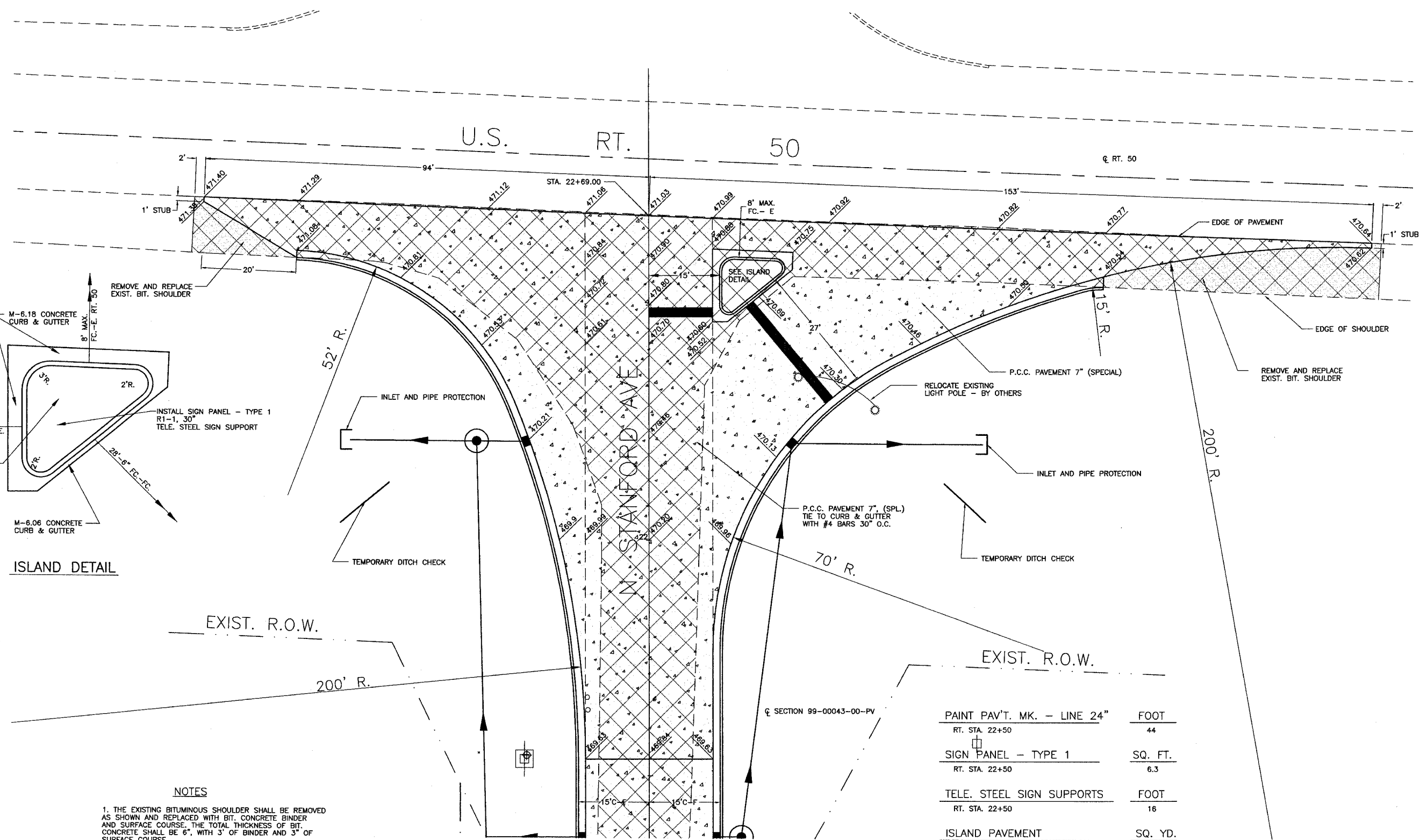

ISLAND DETAIL

NOTES

1. THE EXISTING BITUMINOUS SHOULDER SHALL BE REMOVED AS SHOWN AND REPLACED WITH BIT. CONCRETE BINDER AND SURFACE COURSE. THE TOTAL THICKNESS OF BIT. CONCRETE SHALL BE 6", WITH 3" OF BINDER AND 3" OF SURFACE COURSE.
2. THE CONTRACTOR SHALL SAW CONTRACTION JOINTS AT 12.5' MAX. SPACING AND AS DIRECTED BY THE ENGINEER.

PAINT PAV'T. MK. - LINE 24"	FOOT
RT. STA. 22+50	44
SIGN PANEL - TYPE 1	SQ. FT.
RT. STA. 22+50	6.3
TELE. STEEL SIGN SUPPORTS	FOOT
RT. STA. 22+50	16
ISLAND PAVEMENT	SQ. YD.
RT. STA. 22+50	11
COMB. CONC. CURB & GUTTER, TYPE M- 6.06	FOOT
RT. STA. 22+50	18
COMB. CONC. CURB & GUTTER, TYPE M- 6.18	FOOT
RT. STA. 22+50	31