

ROUTE	SECTION	CITY	TOTAL SHEETS	SHEET NO.
F.A.U. 8533	99-00043-00-PV	FLORA	18	1
CONTRACT NO. 95420		ILLINOIS	PROJECT M-5023(9)	

STATE OF ILLINOIS
DEPARTMENT OF TRANSPORTATION
DIVISION OF HIGHWAYS

PLANS FOR PROPOSED
SURFACE TRANSPORTATION URBAN SECTION

SECTION 99-00043-00-PV CITY OF FLORA

JOB NO. C-97-083-00

STANFORD AVENUE - F.A.U. 8533

PROJECT M-5023(9)

Joint Utility Locating Information for Excavators
JULIE 1-800-892-0123

THE ACCEPTANCE OF THIS PROJECT IS BASED ON THE
MINIMUM DESIGN REQUIREMENTS FOR A FEDERAL-AID
URBAN IMPROVEMENT ON THE FEDERAL-AID URBAN SYSTEM.

Maureen Kasel
DISTRICT ENGINEER OF LOCAL ROADS AND STREETS

INDEX OF SHEETS

SHEET	ITEM
1	COVER SHEET
2	TYPICAL SECTIONS
3	SUMMARY OF QUANTITIES
4	DRAINAGE STRUCTURES & STORM SEWER
5-8	PLAN & PROFILE
9-10	INTERSECTION DETAILS
11-12	EROSION CONTROL DETAILS
13-18	CROSS SECTIONS
	STANDARD 000001-04
	STANDARD 280001-02
	STANDARD 420001-05
	STANDARD 424001-03
	STANDARD 542301
	STANDARD 542606
	STANDARD 602301
	STANDARD 602306
	STANDARD 602401
	STANDARD 602601
	STANDARD 602701
	STANDARD 604001-02
	STANDARD 604036-01
	STANDARD 604051-01
	STANDARD 604086-01
	STANDARD 608001-02
	STANDARD 701006-02
	STANDARD 701201-02
	STANDARD 701301-02
	STANDARD 701311-02
	STANDARD 701501-03
	STANDARD 702001-05
	STANDARD 720001
	STANDARD 720006
	STANDARD 780001-01
	STANDARD BLR 10-4
	STANDARD BLR 21-6
	STANDARD BLR 22-4

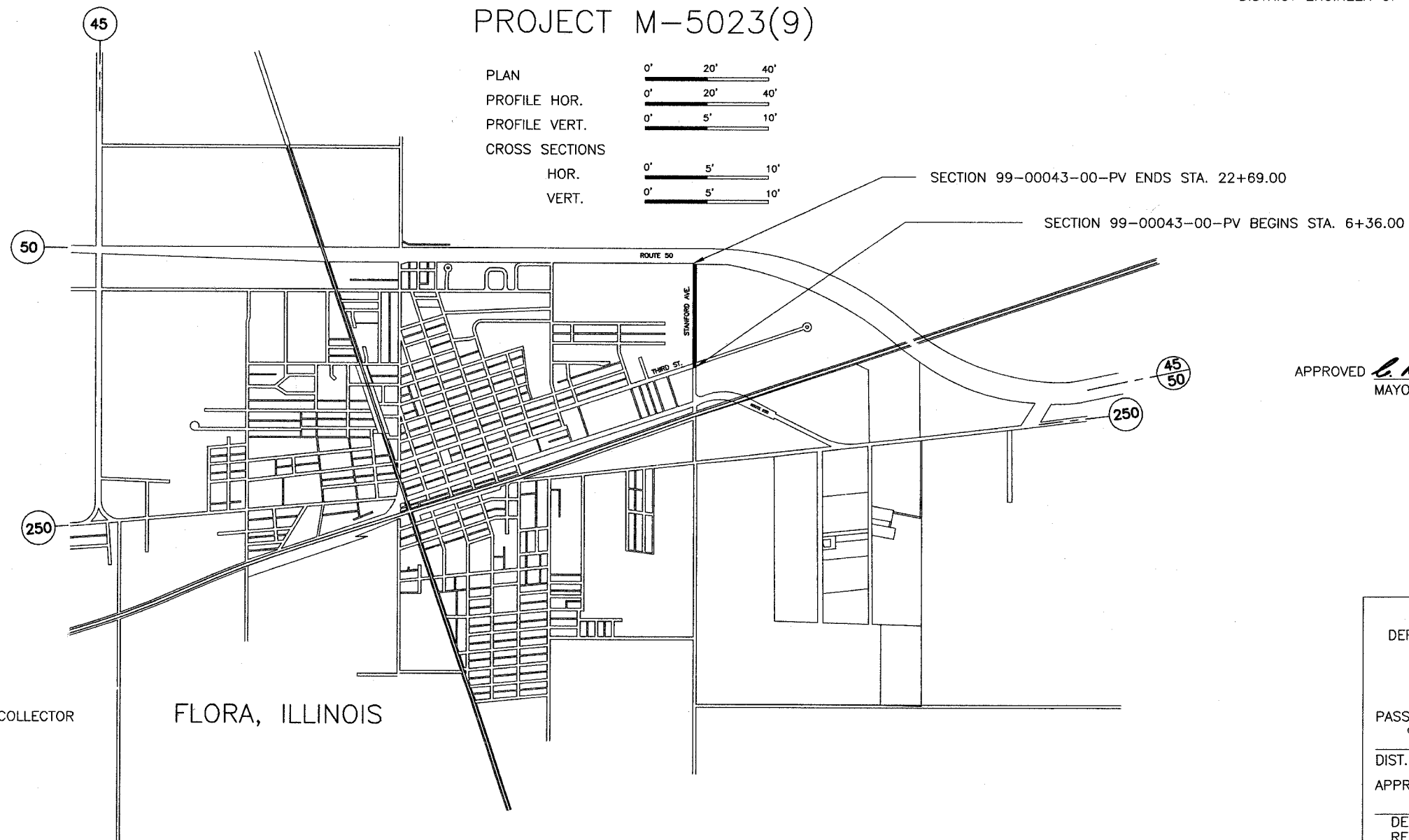

PLAN	0' 20' 40'
PROFILE HOR.	0' 20' 40'
PROFILE VERT.	0' 5' 10'
CROSS SECTIONS	
HOR.	0' 5' 10'
VERT.	0' 5' 10'

FUNCTIONAL CLASSIFICATION - URBAN COLLECTOR
ADT = 2579
DESIGN SPEED = 30 MPH

CONTRACT NO. 95420

FLORA, ILLINOIS

NET LENGTH SECTION 99-00043-00-PV = 1633.00 Ft. = 0.309 Mi.

APPROVED *C. A. Crowder* DATE *04/14/05*
MAYOR - CITY OF FLORA

Roger A. Charleston
Ill. Reg. Prof. Eng. #29195
4/14/05

Lic. Expires 11/30/05

CHARLESTON ENGINEERING INC.
105 N. KITCHELL
P.O. BOX 397
OLNEY, ILLINOIS 62450
PH. 618-392-0736



STATE OF ILLINOIS
DEPARTMENT OF TRANSPORTATION
DIVISION OF HIGHWAYS

PASSED *4/15 20 05*
Maureen Kasel
DIST. ENGINEER OF LOCAL ROADS

APPROVED *4/15 20 05*
Charles R. Reed
DEPUTY DIRECTOR OF HIGHWAYS
REGION FOUR ENGINEER

ROUTE	SECTION	CITY	TOTAL SHEETS	SHEET NO.
F.A.U. 8533	99-00043-00-PV	FLORA	18	2
CONTRACT NO. 95420		ILLINOIS	PROJECT M-5023(9)	

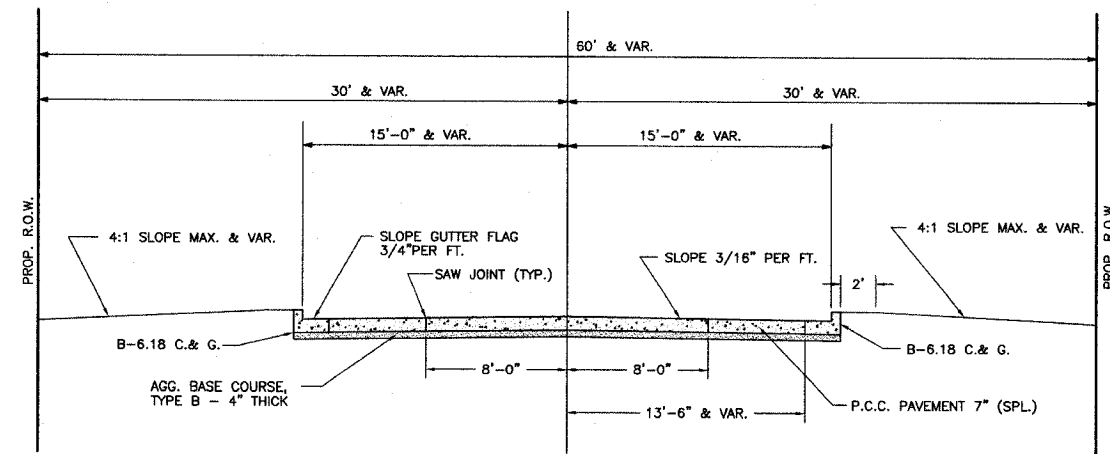

PROPOSED TYPICAL CROSS SECTION

STA. 19+38.00 TO 22+69.00

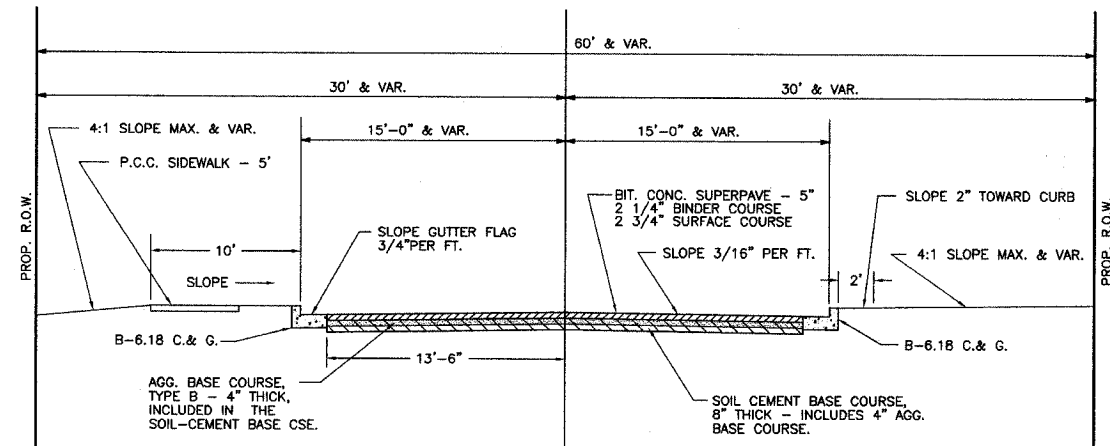

PROPOSED TYPICAL CROSS SECTION

STA. 6+36.00 TO 19+38.00

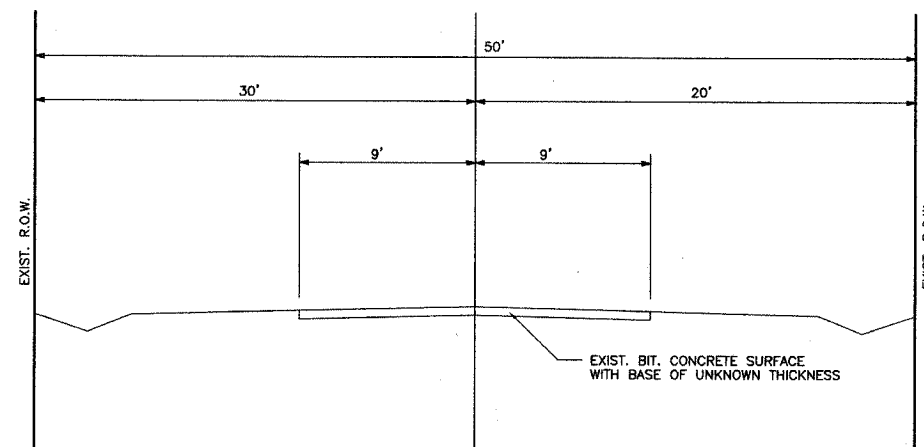

EXISTING TYPICAL CROSS SECTION

THE THICKNESS OF THE EXISTING BITUMINOUS CONCRETE SURFACE VARIES FROM 3" TO 6" THICK. THE AVERAGE THICKNESS WILL BE APPROXIMATELY 4".

GENERAL NOTES

- SEEDING: THIS WORK SHALL BE PERFORMED IN ACCORDANCE WITH THE APPLICABLE PORTIONS OF SECTION 250 OF THE STANDARD SPECIFICATIONS AND SHALL BE PAID FOR AT THE CONTRACT UNIT PRICE FOR SEEDING CLASS 1 (SPECIAL).
 - SPRING SEEDING SHALL EXTEND FROM JANUARY 1 TO JUNE 30
FALL SEEDING SHALL EXTEND FROM JULY 1 TO DECEMBER 31
 - FERTILIZER NUTRIENTS SHALL BE APPLIED AT THE RATE OF 100 LB./ACRE
 - MULCHING SHALL BE DONE IN ACCORDANCE WITH SECTION 251 OF THE STANDARD SPECIFICATIONS AND SHALL BE DONE BY METHOD 2, PROCEDURE 2 AT THE RATE OF 2 TONS PER ACRE.
- THE CONTRACTOR SHALL PROTECT AND CAREFULLY PRESERVE ALL PROPERTY MARKS AND MONUMENTS UNTIL THE OWNER, AN AUTHORIZED AGENT OR SURVEYOR HAS WITNESSED OR OTHERWISE REFERENCED THEIR LOCATION
- ALL EXISTING SIGNS REQUIRING RELOCATION SHALL BE STORED AND REINSTALLED BY THE CONTRACTOR AS DIRECTED BY THE ENGINEER.
- NO PAYMENT FOR OVERHAUL WILL BE MADE ON THIS SECTION
- IT SHALL BE THE RESPONSIBILITY OF THE CONTRACTOR TO PROVIDE FOR THE DELIVERY OF THE U.S. MAIL TO RESIDENCES ALONG THE PROJECT.
- THE CONTRACTOR SHALL CONTACT J.U.L.I.E. BEFORE INSTALLING ANY TRAFFIC CONTROL SIGNS.
- ALL EXISTING PIPE CULVERTS SHALL BE REMOVED BY THE CONTRACTOR. ANY PIPE CULVERTS DEEMED SALVAGABLE BY THE ENGINEER SHALL BECOME THE PROPERTY OF THE CITY OF FLORA AND SHALL BE STOCKPILED ON THE RIGHT-OF-WAY. THE CONTRACTOR SHALL DISPOSE OF ALL UNSALVAGABLE PIPE CULVERTS.
- EXCEPT FOR TREE REMOVAL, ALL OTHER CLEARING AND GRUBBING SHALL BE INCLUDED IN THE UNIT PRICE BID FOR EARTH EXCAVATION.
- THE QUANTITY OF BITUMINOUS CONCRETE WAS ESTIMATED USING A FACTOR OF 112.0 POUNDS PER SQUARE YARD PER INCH THICKNESS.
- FOUR (4) INCHES OF AGGREGATE BASE COURSE TYPE B (CRUSHED STONE) SHALL BE PLACED AND COMPACTED UNDER ALL P.C.C. PAVEMENT 7" (SPECIAL) AND UNDER ALL COMMERCIAL ENTRANCES.
- TIE BARS SHALL BE PLACED BETWEEN THE CURB AND GUTTER AND ALL CONCRETE PAVEMENT AND CONCRETE DRIVEWAYS. THE TIE BARS SHALL BE #6 AT 24" CENTERS.
- THE BITUMINOUS CONCRETE SUPERPAVE SURFACE COURSES SHALL BE PLACED IN TWO LIFTS. THE FIRST LIFT SHALL BE 1 1/2" THICK AND THE SECOND LIFT SHALL BE 1 1/4" THICK.

PAVEMENT DESIGN DATA

ADT = 2579 CLASS II
 P = 2473
 SU = 85
 MU = 21
 IBS = 3.0
 T.F. = 0.145
 URBAN COLLECTOR
 PAVEMENT TYPE: BITUMINOUS CONCRETE, SUPERPAVE, 5" THICK
 BASE TYPE: SOIL CEMENT - 8" THICK

SUMMARY OF QUANTITIES			
CODE NO.	ITEM	UNIT	QUANT.
20100110	TREE REMOVAL (6 TO 15 UNITS DIAMETER)	UNIT	22
20100210	TREE REMOVAL (OVER 15 UNITS DIAMETER)	UNIT	102
20200100	EARTH EXCAVATION	CU.YD.	1095
20200410	EARTH EXCAVATION (SPECIAL)	CU.YD.	290
20400800	FURNISHED EXCAVATION	CU.YD.	450
20800150	TRENCH BACKFILL	CU.YD.	196
25000900	SEEDING, CLASS 1 (SPECIAL)	ACRE	1.25
28000250	TEMPORARY EROSION CONTROL SEEDING	POUND	1000
28000300	TEMPORARY DITCH CHECKS	EACH	2
28000500	INLET AND PIPE PROTECTION	EACH	19
28000900	FENCE (EROSION CONTROL)	FOOT	110
28100805	STONE DUMPED RIPRAP, CLASS A3	TON	65
35101400	AGGREGATE BASE COURSE, TYPE B	TON	1380
35200300	PROCESSING SOIL-CEMENT BASE COURSE 8"	SQ.YD.	3906
35200500	CEMENT	100 WT.	2500
40200800	AGGREGATE SURFACE COURSE, TYPE B	TON	250
40600100	BITUMINOUS MATERIALS (PRIME COAT)	GALLON	460
40600300	AGGREGATE (PRIME COAT)	TON	10
42300200	PORTLAND CEMENT CONCRETE DRIVEWAY PAVEMENT, 6 INCH	SQ.YD.	478
42400100	PORTLAND CEMENT CONCRETE SIDEWALK 4 INCH	SQ.FT.	4132
44000035	BITUMINOUS SURFACE REMOVAL	SQ.YD.	213
44000200	DRIVEWAY PAVEMENT REMOVAL	SQ.YD.	10
44000500	COMBINATION CURB AND GUTTER REMOVAL	FOOT	100
44000600	SIDEWALK REMOVAL	SQ.FT.	37
44001300	BITUMINOUS CONCRETE SURFACE REMOVAL (SPECIAL)	SQ.YD.	4196
50105220	PIPE CULVERT REMOVAL	FOOT	610
54001000	BOX CULVERT END SECTIONS	EACH	4
54010804	PRECAST CONCRETE BOX CULVERT 8' X 4'	FOOT	132
54213657	PRECAST REINFORCED CONCRETE FLARED END SECTIONS 12"	EACH	4
54213663	PRECAST REINFORCED CONCRETE FLARED END SECTIONS 18"	EACH	1
54216180	REINFORCED CONCRETE PIPE TEE, 12" PIPE WITH 12" RISER	EACH	15
54216190	REINFORCED CONCRETE PIPE TEE, 18" PIPE WITH 12" RISER	EACH	11
54247110	GRATING FOR CONCRETE FLARED END SECTION 18"	EACH	1
550B0050	STORM SEWERS, CLASS B, TYPE 1 12"	FOOT	1706
60100905	PIPE DRAINS 4"	FOOT	6
60218400	MANHOLES, TYPE A, 4'-DIAMETER, TYPE 1 FRAME, CLOSED LID	EACH	11
60236200	INLETS, TYPE A, TYPE 8 GRATE	EACH	15
60236800	INLETS, TYPE A, TYPE 11 FRAME AND GRATE	EACH	7
60237460	INLETS, TYPE A, TYPE 23 FRAME AND GRATE	EACH	24

SUMMARY OF QUANTITIES			
CODE NO.	ITEM	UNIT	QUANT.
60238610	INLETS, TYPE A, WITH SALVAGED GRATE	EACH	1
60244130	INLETS, SPECIAL, WITH TYPE 11 FRAME AND GRATE	EACH	2
60244213	INLETS, SPECIAL, WITH TYPE 23 FRAME AND GRATE	EACH	2
60255500	MANHOLES TO BE ADJUSTED	EACH	5
60266600	VALVE BOXES TO BE ADJUSTED	EACH	6
60500060	REMOVING INLETS.	EACH	3
60600605	CONCRETE CURB, TYPE B	FOOT	30
60604400	COMBINATION CONCRETE CURB AND GUTTER, TYPE B-6.18	FOOT	3661
60608600	COMBINATION CONCRETE CURB AND GUTTER, TYPE M-6.06	FOOT	18
60609800	COMBINATION CONCRETE CURB AND GUTTER, TYPE M-6.18	FOOT	31
60625600	ISLAND PAVEMENT (6")	SQ.YD.	11
70100450	TRAFFIC CONTROL AND PROTECTION, STANDARD 701201	L SUM	1
70102620	TRAFFIC CONTROL AND PROTECTION, STANDARD 701501	L SUM	1
70103700	TRAFFIC CONTROL COMPLETE	L SUM	1
72000100	SIGN PANEL - TYPE 1	SQ.FT.	6.3
72800100	TELESCOPING STEEL SIGN SUPPORT	FOOT	16
78001110	PAINT PAVEMENT MARKING - LINE 4"	FOOT	411
78001180	PAINT PAVEMENT MARKING - LINE 24"	FOOT	44
LR420025	PORTLAND CEMENT CONCRETE PAVEMENT 7" (SPECIAL)	SQ.YD.	1756
X0322033	STORM SEWER (WATER MAIN REQUIREMENTS) 12 INCH	FOOT	414
X0322035	STORM SEWER (WATER MAIN REQUIREMENTS) 18 INCH	FOOT	895
X4066428	BITUMINOUS CONCRETE SURFACE COURSE, SUPERPAVE, MIX "D", N90	TON	686
X4066616	BITUMINOUS CONCRETE BINDER COURSE, SUPERPAVE, IL-19.0, N70	TON	500
XX000856	MAILBOX REMOVAL AND RELOCATION	EACH	5
Z0013825	CONTROLLED LOW-STRENGTH MATERIAL	CU.YD.	70
Z0051500	REMOVING AND RESETTING STREET SIGNS	EACH	7

EXCAVATION AND EMBANKMENT

ITEM	CU.YD.
EARTH EXCAVATION FROM ROADWAY	1095
EARTH EXCAVATION (SPECIAL) FROM DITCH UNDERCUT*	290
TOTAL	1385
OTHER SOURCES OF EARTH FROM TRENCHES	180
FROM STORM SEWER	450
TOTAL	630
EMBANKMENT REQUIRED FOR ROADWAY TO FILL DITCH UNDERCUT	1450
TOTAL	290
	1740

* EARTH EXCAVATION FROM DITCH UNDERCUT SHALL NOT BE USED IN ANY EMBANKMENT BUT SHALL BE DISPOSED OF BY THE CONTRACTOR.

ROUTE	SECTION	CITY	TOTAL SHEETS	SHEET NO.
F.A.U. 8533	99-00043-00-PV	FLORA	18	3
CONTRACT NO. 95420		ILLINOIS	PROJECT M-5023(9)	

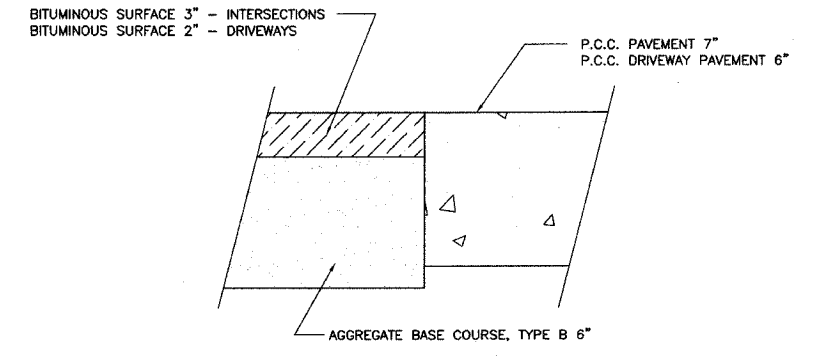

INTERSECTION & DRIVEWAY TRANSITION DETAILS

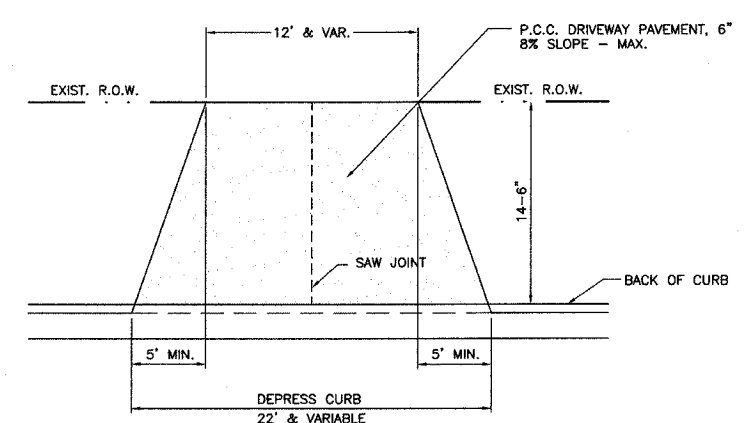

PRIVATE ENTRANCE DETAILS

- NOTES
- DRIVEWAYS WIDER THAN 30' AT THE CURB SHALL HAVE SAW JOINTS AT 15' SPACING MAX.

ROUTE	SECTION	CITY	TOTAL SHEETS	SHEET NO.
F.A.U. 8533	99-00043-00-PV	FLORA	18	4
CONTRACT NO. 95420		ILLINOIS	PROJECT M-5023(9)	

DRAINAGE STRUCTURES

NO.	DIST.	STA.	ITEM	GRATE	INV.
1	17' LT.	6+06	P.R.C.F.E.S. 12"	-	469.60
2	17' LT.	6+61	PIPE TEE, 12"P. 12"R.	-	468.68
3	32' LT.	6+60	INLET, TY-A, W/TY-11 F&G	470.91	468.94
4	42' LT.	6+56	EXISTING INLET	472.09	469.09
5	18' LT.	6+98	PIPE TEE, 12"P. 12"R.	-	468.09
6	21' LT.	6+98	INLET, TY-A, W/TY-23 F&G	470.57	468.25
7	28' LT.	7+13	INLET, TY-A, W/SALVAGED GRATE	469.65	468.30
8	18' LT.	7+60	M.H., TY-A, 4" DIA., W/TY-1 F&CL	470.35	469.97
9	14' LT.	7+60	INLET, TY-A, W/TY-23 F&G	469.86	468.56
10	18' LT.	8+00	PIPE TEE, 18"P. 12"R.	-	469.50
11	29' LT.	8+00	INLET, TY-A, W/TY-8 GR	469.50	468.86
12	18' LT.	8+50	PIPE TEE, 18"P. 12"R.	-	466.05
13	14.5' LT.	8+50	INLET, TY-A, W/TY-23 F&G	469.10	466.35
14	18' LT.	8+60	PIPE TEE, 18"P. 12"R.	-	465.95
15	29' LT.	8+60	INLET, TY-A, W/TY-8 GR	468.75	466.30
16	18' LT.	9+35	PIPE TEE, 18"P. 12"R.	-	465.19
17	14.5' LT.	9+35	INLET, TY-A, W/TY-23 F&G	468.77	464.52
18	18' LT.	10+00	PIPE TEE, 18"P. 12"R.	-	464.52
19	28' LT.	10+00	INLET, TY-A, W/TY-8 GR	467.50	465.00
20	18' LT.	10+15	PIPE TEE, 18"P. 12"R.	-	464.37
21	14.5' LT.	10+15	INLET, TY-A, W/TY-23 F&G	468.45	464.67
22	18' LT.	10+35	PIPE TEE, 18"P. 12"R.	-	464.17
23	28' LT.	10+35	INLET, TY-A, W/TY-8 GR	467.50	465.00
24	18' LT.	11+21	CONNECT TO BOX CULVERT	-	463.30
25	14.5' LT.	11+22	INLET, SPECIAL, W/TY-23 F&G	468.03	-
26	18' LT.	11+42	CONNECT TO BOX CULVERT	-	463.64
27	18' LT.	11+80	PIPE TEE, 18"P. 12"R.	-	463.88
28	14.5' LT.	11+80	INLET, TY-A, W/TY-23 F&G	467.83	464.18
29	18' LT.	12+48	M.H., TY-A, 4" DIA., W/TY-1 F&CL	468.20	464.31
30	14.5' LT.	12+48	INLET, SPECIAL, W/TY-11 F&G	467.73	464.35
31	14.5' LT.	12+53	INLET, TY-A, W/TY-11 F&G	467.73	464.40
32	14.5' LT.	13+60	PIPE TEE, 18"P. 12"R.	-	465.13
33	29' LT.	13+60	INLET, TY-A, W/TY-8 GR	467.50	465.23
34	18' LT.	13+68	PIPE TEE, 18"P. 12"R.	-	465.18
35	14.5' LT.	13+68	INLET, TY-A, W/TY-23 GR	467.99	465.48
36	18' LT.	14+80	M.H., TY-A, 4" DIA., W/TY-1 F&CL	469.05	465.90
37	14.5' LT.	14+80	INLET, TY-A, W/TY-23 F&G	468.76	466.05
38	34' LT.	14+80	P.R.C.F.E.S. 18" W/GRATING	-	467.00
39	18' LT.	15+43	M.H., TY-A, 4" DIA., W/TY-1 F&CL	469.70	466.50
40	14.5' LT.	15+43	INLET, TY-A, W/TY-23 F&G	469.43	466.55
41	32' LT.	15+55	INLET, TY-A, W/TY-8 GR	469.25	466.68
42	32' LT.	16+25	INLET, TY-A, W/TY-8 GR	469.50	467.38
43	14.5' LT.	16+25	INLET, TY-A, W/TY-23 F&G	470.34	467.93
44	32' LT.	16+65	INLET, TY-A, W/TY-8 GR	469.50	467.78
45	30' LT.	19+45	INLET, TY-A, W/TY-8 GR	471.50	468.00
46	31' LT.	19+99	PIPE TEE, 12"P. 12"R.	-	467.74
47	14.5' LT.	20+00	INLET, TY-A, W/TY-23 F&G	471.29	468.79
48	33' LT.	20+68	PIPE TEE, 12"P. 12"R.	-	467.40
49	14.5' LT.	20+68	INLET, TY-A, W/TY-23 F&G	470.04	467.60
50	35' LT.	21+37	PIPE TEE, 12"P. 12"R.	-	467.04
51	14.5' LT.	21+38	INLET, TY-A, W/TY-11 F&G	469.60	467.14
52	14.5' LT.	21+33	INLET, TY-A, W/TY-11 F&G	469.60	467.20
53	37' LT.	22+21	M.H., TY-A, 4" DIA., W/TY-1 F&CL	470.00	466.62
54	26' LT.	22+21	INLET, TY-A, W/TY-23 F&G	470.21	466.70
55	63' LT.	22+21	P.R.C.F.E.S. 12"	-	466.50
56	18' RT.	6+06	P.R.C.F.E.S. 12"	-	469.60
57	17' RT.	6+82	PIPE TEE, 12"P. 12"R.	-	468.46
58	28' RT.	6+82	INLET, TY-A, W/TY-8 GR	469.90	468.52
59	18' RT.	7+09	PIPE TEE, 12"P. 12"R.	-	468.08
60	55' RT.	7+08	PIPE TEE, 12"P. 12"R.	-	468.27
61	66' RT.	7+07	INLET, TY-A, W/TY-8 GR	469.70	468.32
62	56' RT.	7+25	INLET, TY-A, W/TY-8 GR	469.70	468.39
63	19.5' RT.	7+60	M.H., TY-A, 4" DIA., W/TY-1 F&CL	470.35	467.32
64	14.5' RT.	7+60	INLET, TY-A, W/TY-23 F&G	469.86	467.36
65	19.5' RT.	8+50	PIPE TEE, 12"P. 12"R.	-	468.30
66	14.5' RT.	8+50	INLET, TY-A, W/TY-23 F&G	469.10	466.35
67	19.5' RT.	9+35	PIPE TEE, 12"P. 12"R.	-	465.44
68	14.5' RT.	9+35	INLET, TY-A, W/TY-23 F&G	468.77	465.50
69	19.5' RT.	9+65	PIPE TEE, 12"P. 12"R.	-	465.13
70	29' RT.	9+65	INLET, TY-A, W/TY-8 GR	468.50	466.00
71	19.5' RT.	10+15	PIPE TEE, 12"P. 12"R.	-	464.62
72	14.5' RT.	10+15	INLET, TY-A, W/TY-23 F&G	468.45	464.67
73	19.5' RT.	11+01	CONNECT TO BOX CULVERT	-	463.75
74	14.5' RT.	11+22	INLET, SPECIAL, W/TY-23 F&G	468.06	-
75	19.5' RT.	11+23	CONNECT TO BOX CULVERT	-	463.75
76	19.5' RT.	11+80	PIPE TEE, 18"P. 12"R.	-	464.12
77	14.5' RT.	11+80	INLET, TY-A, W/TY-23 F&G	467.83	464.42
78	19.5' RT.	12+48	M.H., TY-A, 4" DIA., W/TY-1 F&CL	468.20	464.56
79	14.5' RT.	12+48	INLET, SPECIAL, W/TY-11 F&G	467.73	464.60
80	14.5' RT.	12+53	INLET, TY-A, W/TY-11 F&G	467.73	464.65
81	19.5' RT.	13+10	PIPE TEE, 12"P. 12"R.	-	465.05
82	29' RT.	13+10	INLET, TY-A, W/TY-8 GR	467.50	465.05
83	19.5' RT.	13+60	PIPE TEE, 12"P. 12"R.	-	465.37
84	14.5' RT.	13+60	INLET, TY-A, W/TY-23 F&G	467.95	465.45
85	19.5' RT.	14+50	M.H., TY-A, 4" DIA., W/TY-1 F&CL	469.00	465.95
86	14.5' RT.	14+50	INLET, TY-A, W/TY-23 F&G	468.50	466.00
87	19.5' RT.	15+70	PIPE TEE, 12"P. 12"R.	-	467.20
88	14.5' RT.	15+70	INLET, TY-A, W/TY-23 F&G	469.78	467.26
89	19.5' RT.	16+95	M.H., TY-A, 4" DIA., W/TY-1 F&CL	471.75	468.40
90	14.5' LT.	16+95	INLET, TY-A, W/TY-23 F&G	471.28	468.70
91	29' RT.	17+13	INLET, TY-A, W/TY-8 GR	470.25	468.70
92	19.5' RT.	20+00	M.H., TY-A, 4" DIA., W/TY-1 F&CL	471.80	467.59
93	14.5' RT.	20+00	INLET, TY-A, W/TY-23 F&G	471.29	467.64
94	19.5' RT.	21+38	M.H., TY-A, 4" DIA., W/TY-1 F&CL	470.10	466.12
95	14.5' RT.	21+38	INLET, TY-A, W/TY-11 F&G	469.60	467.54
96	14.5' RT.	21+33	INLET, TY-A, W/TY-11 F&G	469.60	467.58
97	30' RT.	22+21	INLET, TY-A, W/TY-23 F&G	469.13	465.70
98	71' RT.	22+21	P.R.C.F.E.S. 12"	-	465.30
R1	24' LT.	6+63	REMOVING INLETS	-	-
R2	15' LT.	6+98	REMOVING INLETS	-	-
R3	19' LT.	7+00	REMOVING INLETS	-	-

STORM SEWERS

LOCATION	TY-1,12"	W.M.R. 12"	W.M.R. 18"	TR.B'FILL
1 TO 2		50		2.0
2 TO 3		13		1.7
2 TO 5		35		4.6
5 TO 6		3		0.4
5 TO 8		60		4.8
7 TO 8		46		2.1
8 TO 9		2		0.3
8 TO 10			38	
10 TO 11			10	
10 TO 12			50	
12 TO 13		4		0.6
12 TO 14			10	1.3
14 TO 15			10	
14 TO 16			75	4.5
16 TO 17		4		0.7
17 TO 18			64	
18 TO 19		14		
18 TO 20			14	3.1
20 TO 21		4		1.1
20 TO 22			20	5.1
22 TO 23		14		
22 TO 24			85	
26 TO 27			38	
27 TO 28		4		0.8
27 TO 29			68	
29 TO 30			4	0.9
30 TO 31		4		0.9
29 TO 32			100	2.6
32 TO 33				
32 TO 34		10		
34 TO 35			8	
34 TO 36		4		0.5
34 TO 37			110	
36 TO 37				
36 TO 38			6	0.6
36 TO 39			40	
39 TO 40		4		0.6
40 TO 41			18	
41 TO 42			68	7.7
42 TO 43			15	0.5
43 TO 44			38	3.3
45 TO 46	54			6.3
46 TO 47	16			0.4
46 TO 48	66			6.9
48 TO 49	18			0.4
48 TO 50	70			
50 TO 51	18			0.4
51 TO 52	4			0.5
50 TO 53	82			
53 TO 54	10			0.7
53 TO 55	20			
56 TO 57	70			1.6
57 TO 58	8			
57 TO 59	26			3.4
59 TO 60	36			4.8
60 TO 61	10			
60 TO 62	24			2.4
59 TO 63	48			4.0
63 TO 64	5			0.4
63 TO 65	88			
65 TO 66	5			0.5
65 TO 67	84			
67 TO 68	5			0.6
67 TO 69	28			
69 TO 70	8			
69 TO 71	50			5.3
71 TO 72	5			0.8
72 TO 73	86			6.9
75 TO 76			58	
76 TO 77	5			0.7
76 TO 78			66	
78 TO 79			3	0.6
79 TO 80	5			1.0
78 TO 81	62			
81 TO 82	8			
81 TO 83	50			4.8
83 TO 84	5			0.4
83 TO 85	88			
85 TO 86	5			0.4
85 TO 87	118			
87 TO 88	5			0.4
87 TO 89	124			3.3
89 TO 90	5			0.4
89 TO 91	18			
92 TO 93	5			0.4
92 TO 94	134			
94 TO 95	5			0.4
95 TO 96	4			0.5
94 TO 97	82			1.0
97 TO 98	34			1.0
R1				0.7
R2				0.7
R3				0.7
	1706	414	895	114.4

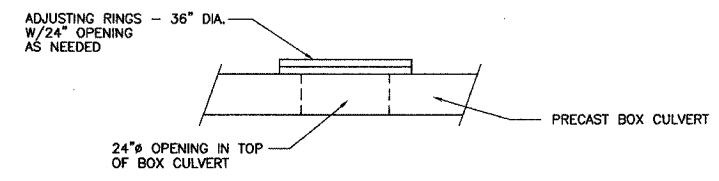

INLET, SPECIAL, W/TY.-23 F. & G.

LT. STA. 11+22
RT. STA. 11+22

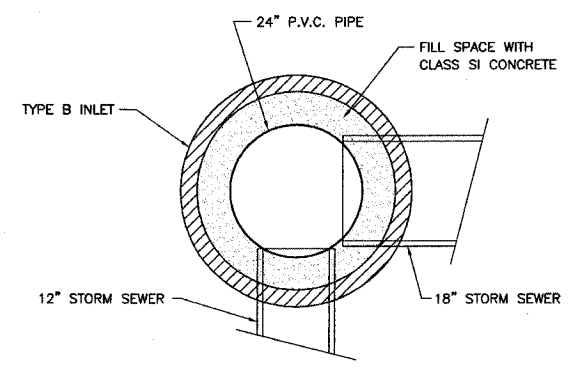

INLET, B, SPECIAL, W/TY-11 F&G

LT. STA. 12+48
RT. STA. 12+48

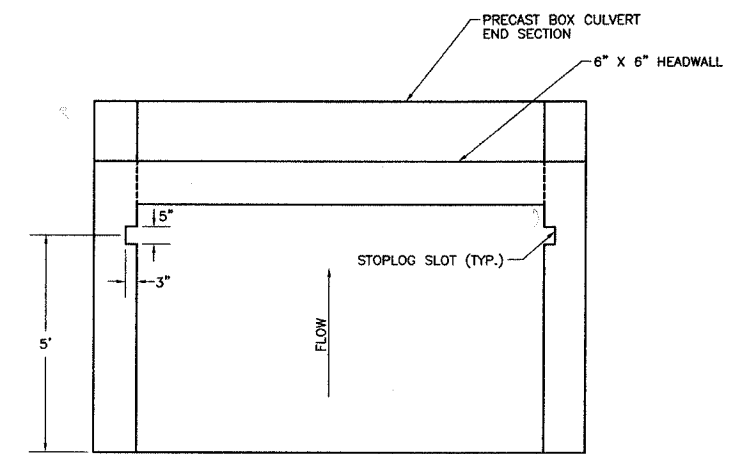

BOX CULVERT END SECTION STOPLOG SLOT DETAIL

BOTH UPSTREAM END SECTIONS ONLY

ROUTE	SECTION	CITY	TOTAL SHEETS	SHEET NO.
F.A.U. 8533	99-00043-00-PV	FLORA	18	5
CONTRACT NO. 95420		ILLINOIS	PROJECT M-5023(9)	

SCALES:
1" = 20' HOR
1" = 5' VER

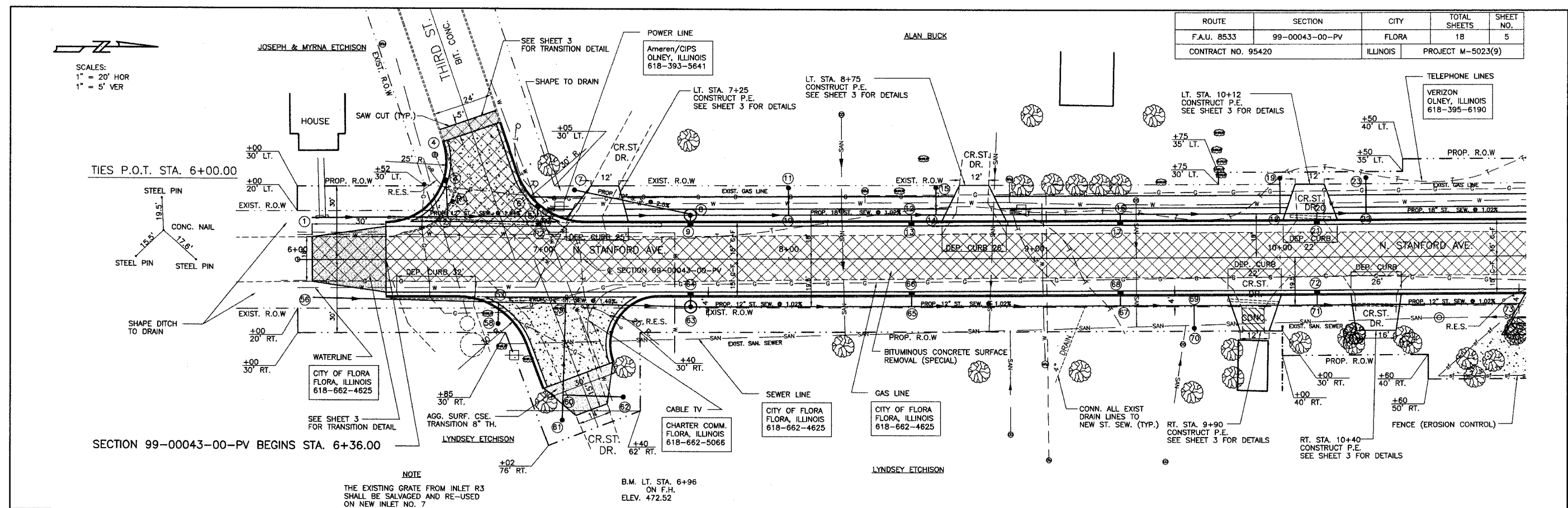

NOTE
THE EXISTING GRATE FROM INLET R3 SHALL BE SALVAGED AND RE-USED ON NEW INLET NO. 7

B.M. LT. STA. 6+96 ON F.H. ELEV. 472.52

485					SIDEWALK REMOVAL	SQ. FT.		AGG. SURF. CSE., TY.-B	TON	COMB. CONC. CURB & GUTTER	FOOT	485
480					PIPE CULVERT REMOVAL	FOOT				SEEDING CLASS 1 (SPL.)	ACRE	480
475	BIT. CONC. BINDER CSE., SUPERPAVE, IL-19.0, N70	TON										
470	BIT. CONC. SURFACE CSE., SUPERPAVE, MIX "D", N90	TON										
465												
460	MANHOLES TO BE ADJUSTED	EACH										
455	PAINT PAV'T. MARKING LINE 4"	FOOT										
450	DRIVEWAY PAVEMENT REMOVAL	SQ. YD.										
445												
440												

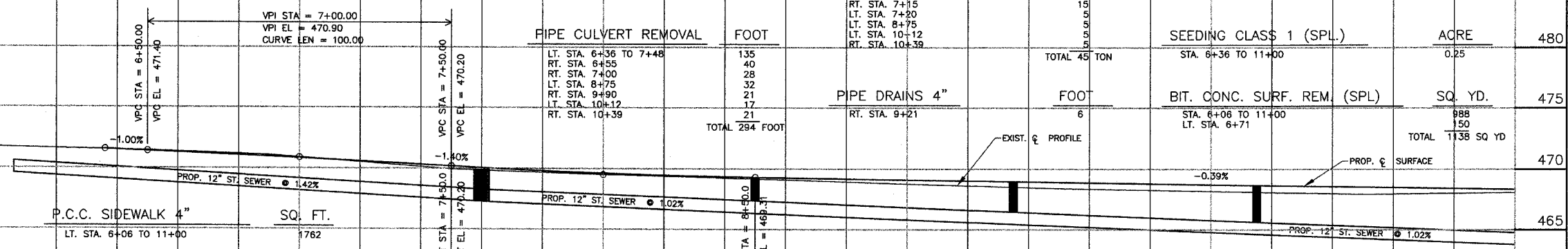

TIES P.O.T. STA. 14+00.00

ROUTE	SECTION	CITY	TOTAL SHEETS	SHEET NO.
F.A.U. 8533	99-00043-00-PV	FLORA	18	6
CONTRACT NO. 95420		ILLINOIS	PROJECT M-5023(9)	

COMM. SCHOOL DIST. #133

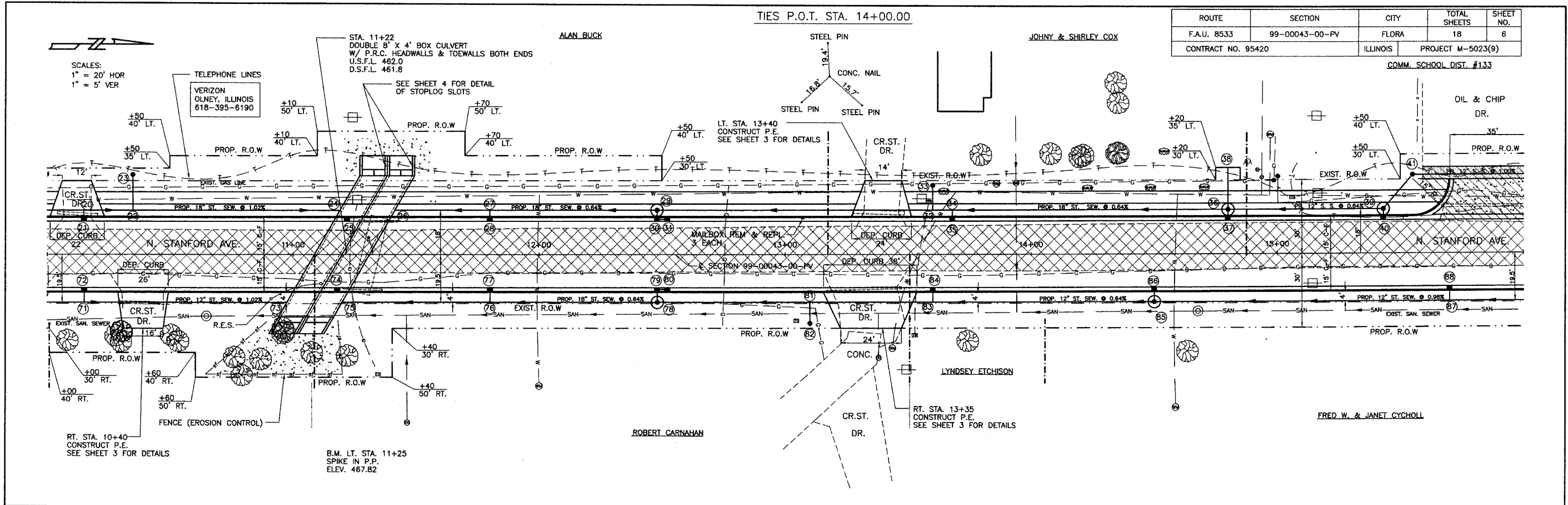

485	BIT CONC. SUPERPAVE. IL-19.C, N70	BINDER CSE., 1.02%	TON	192	P.C.C. DRIVEWAY PAV'T. 6"	SQ. YD.	51	AGG. BASE. CSE., TY.-B	TON	330	AGG. SURF. CSE., TY.-E	TON	5	COMB. CONC. CURB & GUTTER TYPE B-5.18	FOOT	1000
480	BIT CONC. SURFACE SUPERPAVE. MIX "D", N90	CSE., 1.02%	TON	242	RT. STA. 13+35 LT. STA. 13+40 LT. STA. 15+88	SQ. YD.	32 60	RT. STA. 11+00 TO 16+00 LT. STA. 15+82	TON	362	MANHOLES TO BE ADJUSTED	EACH	1	SEEDING CLASS 1 (SPL.)	ACRE	0.35
475			TON	248	VPI STA = 11+50.00 VPC EL = 468.14			VPI STA = 12+50.00 VPI EL = 467.75 CURVE LEN = 200.00			P.C.C. SIDEWALK 4"	SQ. FT.	2190	C.L.S.M.	CU.YD.	70
470		PROP. SURFACE			MAILBOX REM. & REL.		3	EXIST. PROFILE								1.22%
465		PROP. SURFACE														
460	PAINT PAV'T. MARKING LINE 4"		FOOT	125	PROCESSING SOIL-CEMENT BASE COURSE 8"	SQ. YD.	1500	PIPE CULVERT REMOVAL	FOOT	32						
455	BIT. CONC. SURF. REM. (SPL)		SQ. YD.	1000	TREE REMOVAL (6 TO 15 UNITS DIA.)	UNIT DIA.	22	TRENCH BACKFILL	CU.YD.	4	PREC. CONC. BOX CULV. 8' X 4'	FOOT	132	STONE DUMP RIPRAP, CLASS A3	TON	65
450	BITUMINOUS SURFACE REMOVAL		SQ. YD.	125	TREE REMOVAL (OVER 15 UNITS DIA.)	UNIT DIA.	102	TRENCH BACKFILL	CU.YD.	4	CEMENT	100 WT.	960	REM. & RESET ST. SIGNS	EACH	
445																
440																

10+00 11+00 12+00 13+00 14+00 15+00 16+00

SCALES:
1" = 20' HOR
1" = 5' VER

ROUTE	SECTION	CITY	TOTAL SHEETS	SHEET NO.
F.A.U. 8533	99-00043-00-PV	FLORA	18	7
CONTRACT NO. 95420		ILLINOIS	PROJECT M-5023(9)	

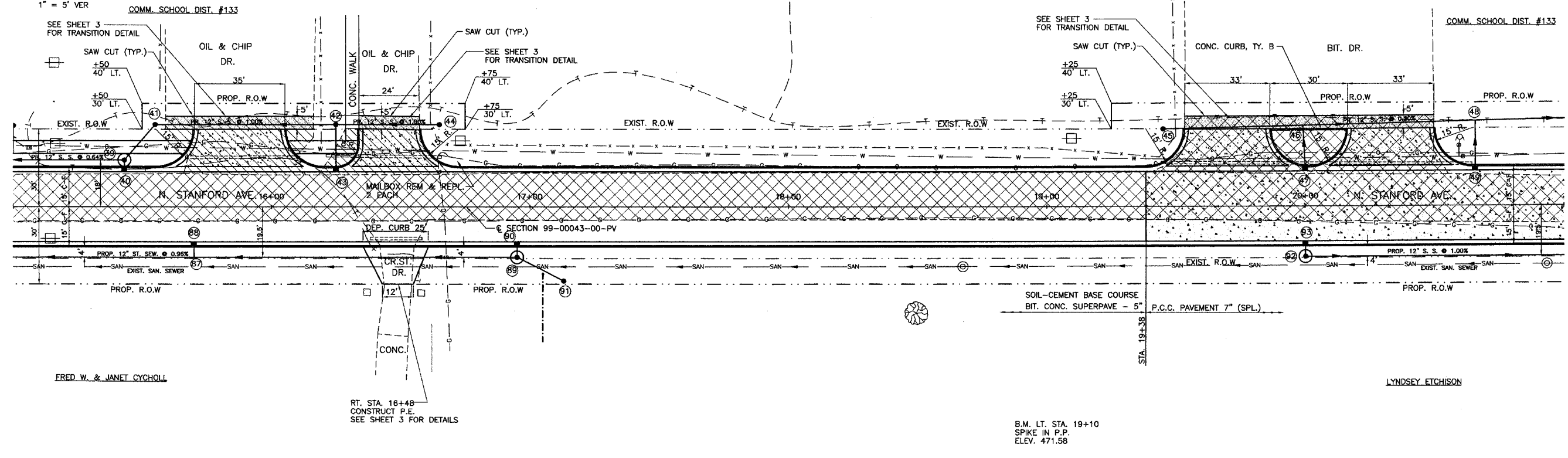

FRED W. & JANET CYGHOLL

LYNDSY ETCHEISON

RT. STA. 16+48
CONSTRUCT P.E.
SEE SHEET 3 FOR DETAILS

B.M. LT. STA. 19+10
SPIKE IN P.P.
ELEV. 471.58

485	BIT. CONC. BINDER CSE., SUPERPAVE, IL-19.0, N70	TON	131	BITUMINOUS SURFACE REMOVAL	SQ. YD.	88	SEEDING CLASS 1 (SPL.)	ACRE	0.35	485
480	BIT. CONC. SURFACE CSE., SUPERPAVE, MIX "D", N90	TON	167	AGG. BASE. CSE., TY.-B	TON	345	CEMENT	100 WT.	650	480
475	TOTAL 181 TON			TOTAL 413 TON			SIDEWALK REMOVAL	SQ. FT.	25	475
470										470
465	PIPE CULVERT REMOVAL	FOOT	45	P.C.C. DRIVEWAY PAV'T. 6"	SQ. YD.	39	MAILBOX REM. & REL.	EACH	2	465
460	TOTAL 186 FOOT			TOTAL 182 SQ. YD.			COMB. CONC. CURB & GUTTER TYPE B-6.18	FOOT	1000	460
455	P.C.C. PAVEMENT 7" (SPL.)	SQ. YD.	486	PAINT PAV'T. MARKING LINE 4"	FOOT	125	VALVE BOXES TO BE ADJUSTED	EACH	2	455
450	BIT. CONC. SURF. REM. (SPL)	SQ. YD.	1000	MANHOLES TO BE ADJUSTED	EACH	1	PROCESSING SOIL-CEMENT BASE COURSE 8"	SQ. YD.	1014	450
445	TOTAL 1248 SQ. YD.			TOTAL 2 EACH			AGG. SURF. CSE., TY.-B	TON	5	445
440							CONCRETE CURB, TYPE B	FOOT	30	440

ROUTE	SECTION	CITY	TOTAL SHEETS	SHEET NO.
F.A.U. 8533	99-00043-00-PV	FLORA	18	10
CONTRACT NO. 95420		ILLINOIS	PROJECT M-5023(9)	

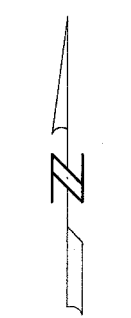

SCALE 1" = 10'

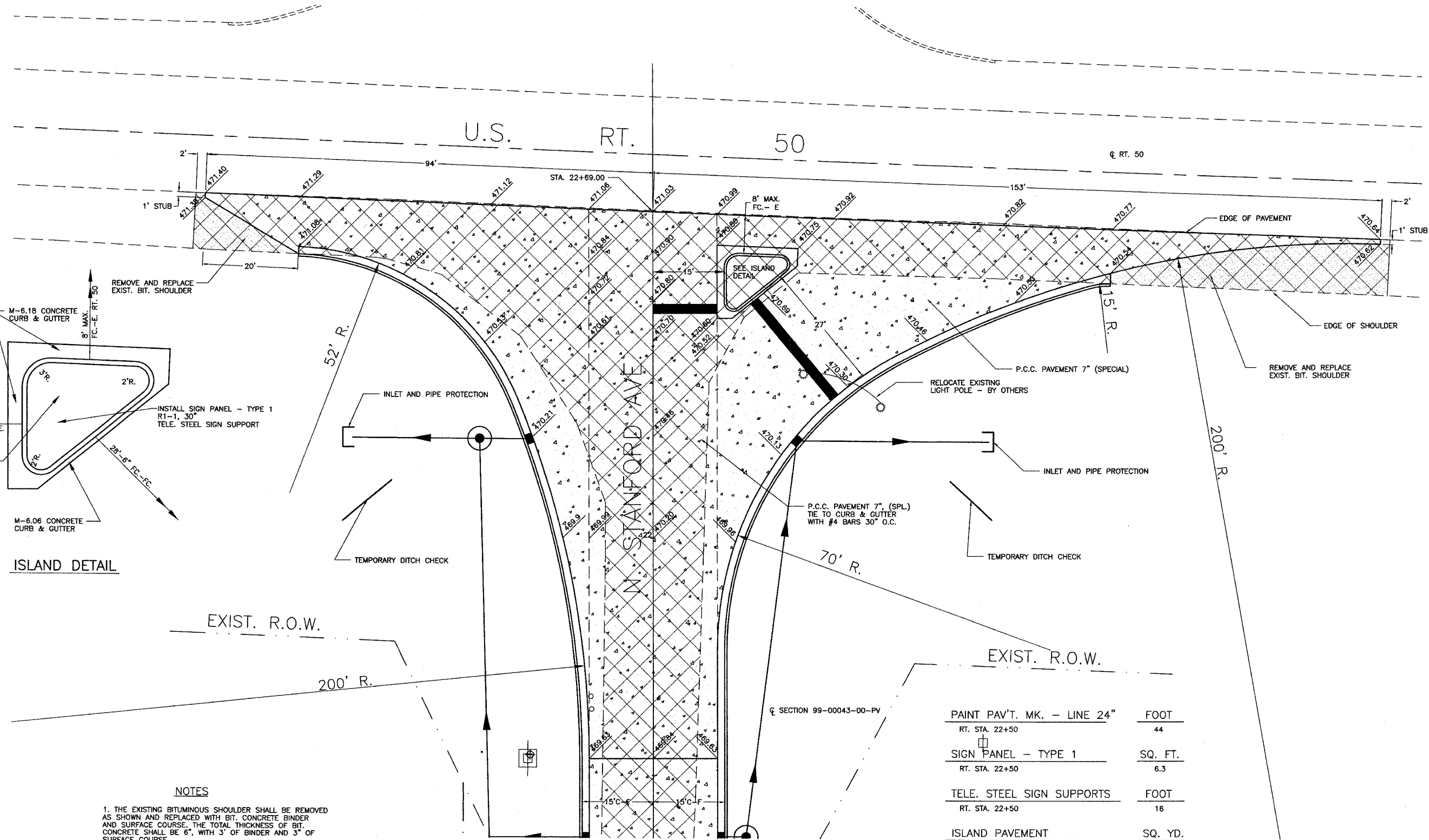

ROUTE	SECTION	CITY	TOTAL SHEETS	SHEET NO.
F.A.U. 8533	99-00043-00-PV	FLORA	18	11
CONTRACT NO. 95420		ILLINOIS	PROJECT M-5023(9)	

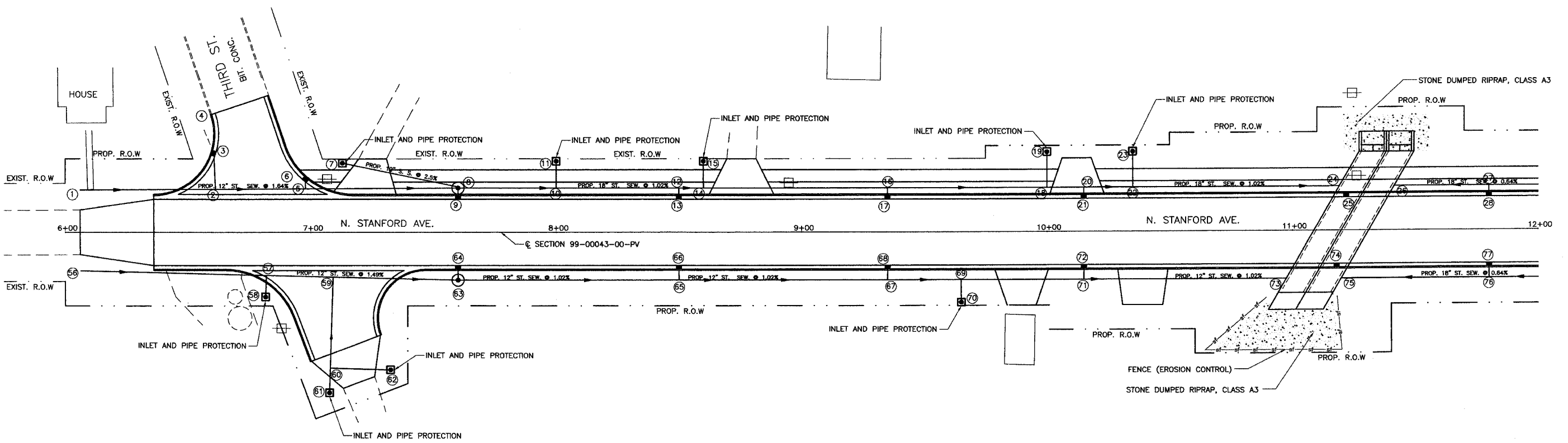

STONE DUMP RIPRAP, CLASS A3	TON	INLET AND PIPE PROTECTION	EACH	FENCE (EROSION CONTROL)	FOOT
LT. & RT. STA. 11+25	65	LT. & RT. STA. 6+00 TO 12+00	9	RT. STA. 11+00	110
		LT. & RT. STA. 12+00 TO 18+00	7		
			TOTAL 16 EACH		

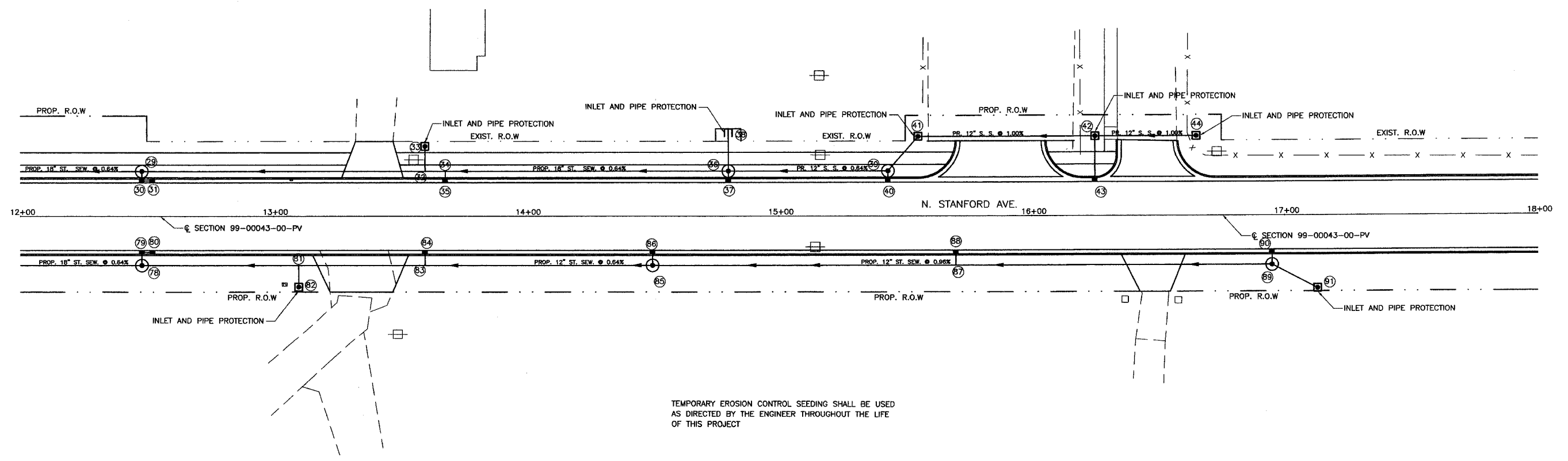

TEMPORARY EROSION CONTROL SEEDING SHALL BE USED AS DIRECTED BY THE ENGINEER THROUGHOUT THE LIFE OF THIS PROJECT

EROSION CONTROL DETAILS

ROUTE	SECTION	CITY	TOTAL SHEETS	SHEET NO.
F.A.U. 8533	99-00043-00-PV	FLORA	18	12
CONTRACT NO. 95420		ILLINOIS	PROJECT M-5023(9)	

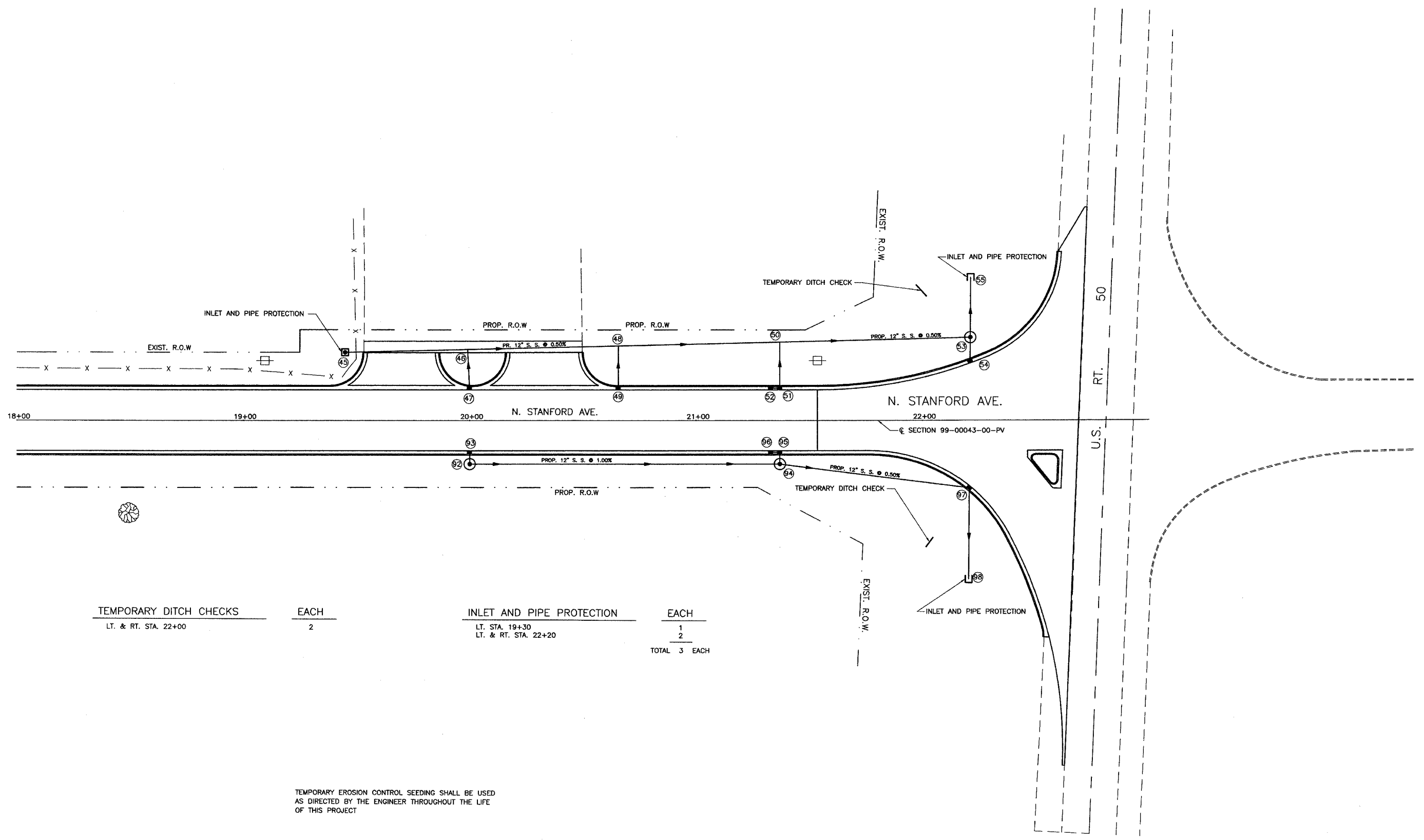

TEMPORARY DITCH CHECKS EACH
 LT. & RT. STA. 22+00 2

INLET AND PIPE PROTECTION EACH
 LT. STA. 19+30 1
 LT. & RT. STA. 22+20 2
 TOTAL 3 EACH

TEMPORARY EROSION CONTROL SEEDING SHALL BE USED AS DIRECTED BY THE ENGINEER THROUGHOUT THE LIFE OF THIS PROJECT

EROSION CONTROL DETAILS

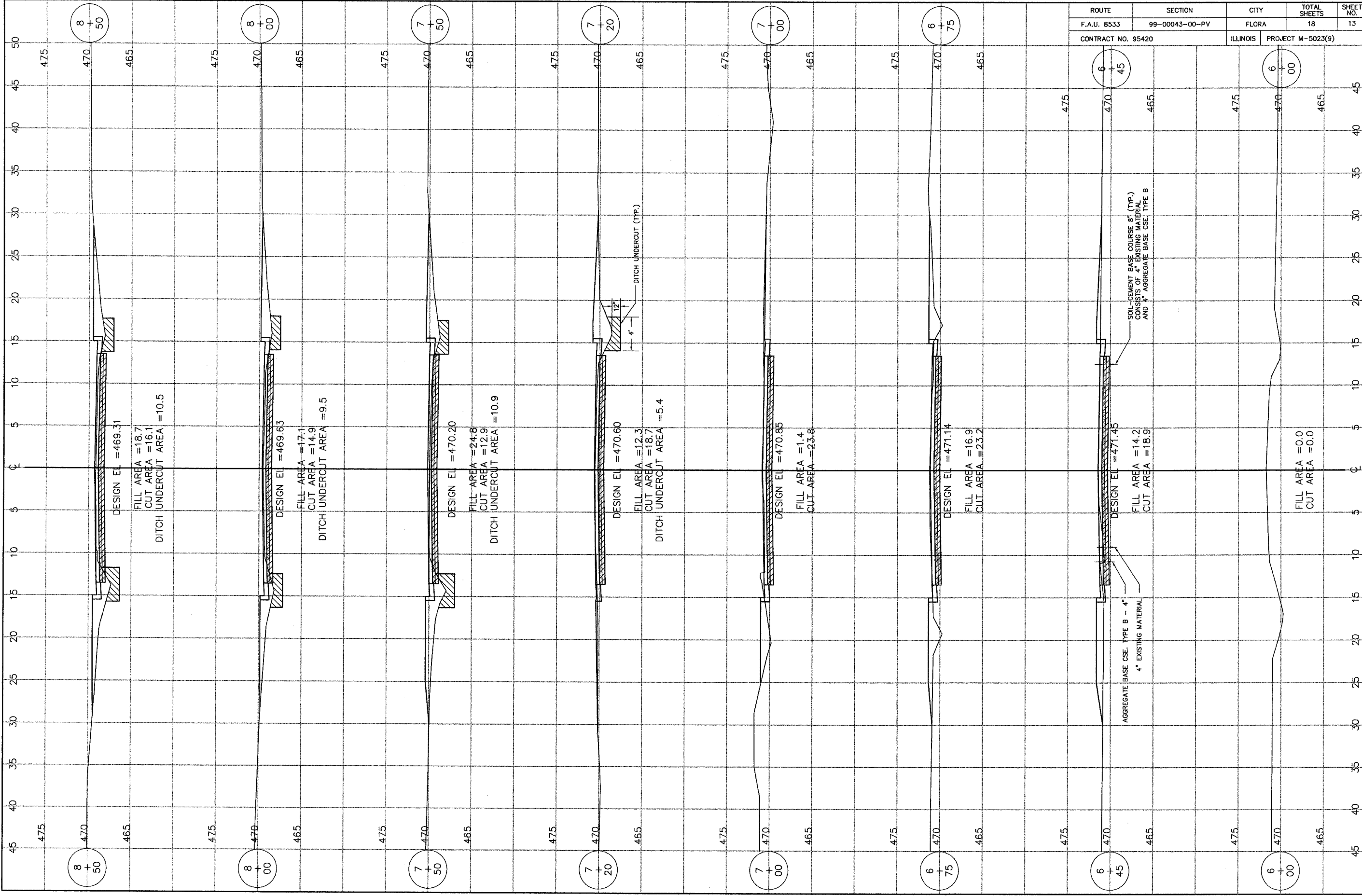

ROUTE	SECTION	CITY	TOTAL SHEETS	SHEET NO.
F.A.U. 8533	99-00043-00-PV	FLORA	18	13
CONTRACT NO. 95420		ILLINOIS	PROJECT M-5023(9)	

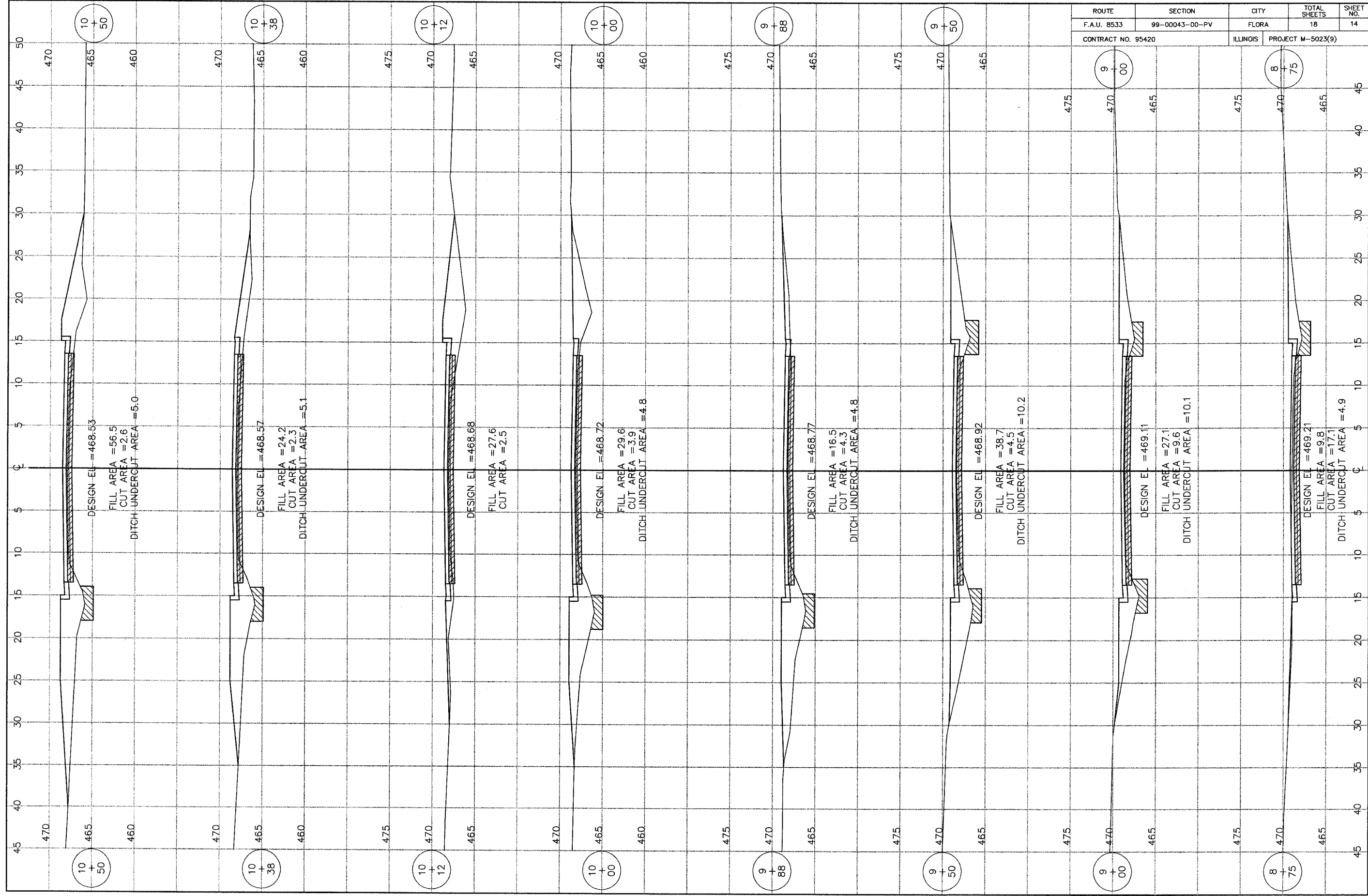

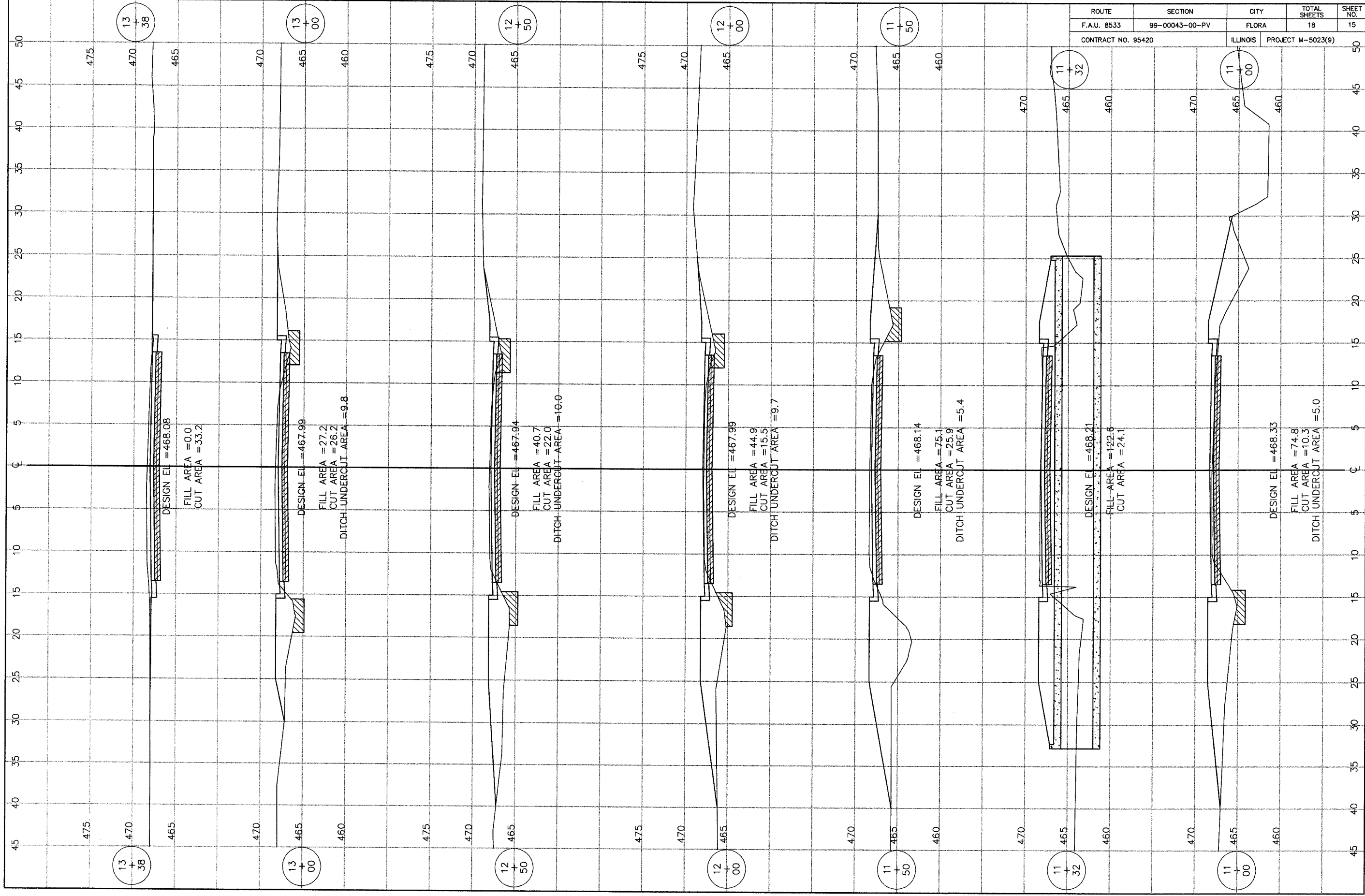

ROUTE	SECTION	CITY	TOTAL SHEETS	SHEET NO.
F.A.U. 8533	99-00043-00-PV	FLORA	18	15
CONTRACT NO. 95420		ILLINOIS	PROJECT M-5023(9)	

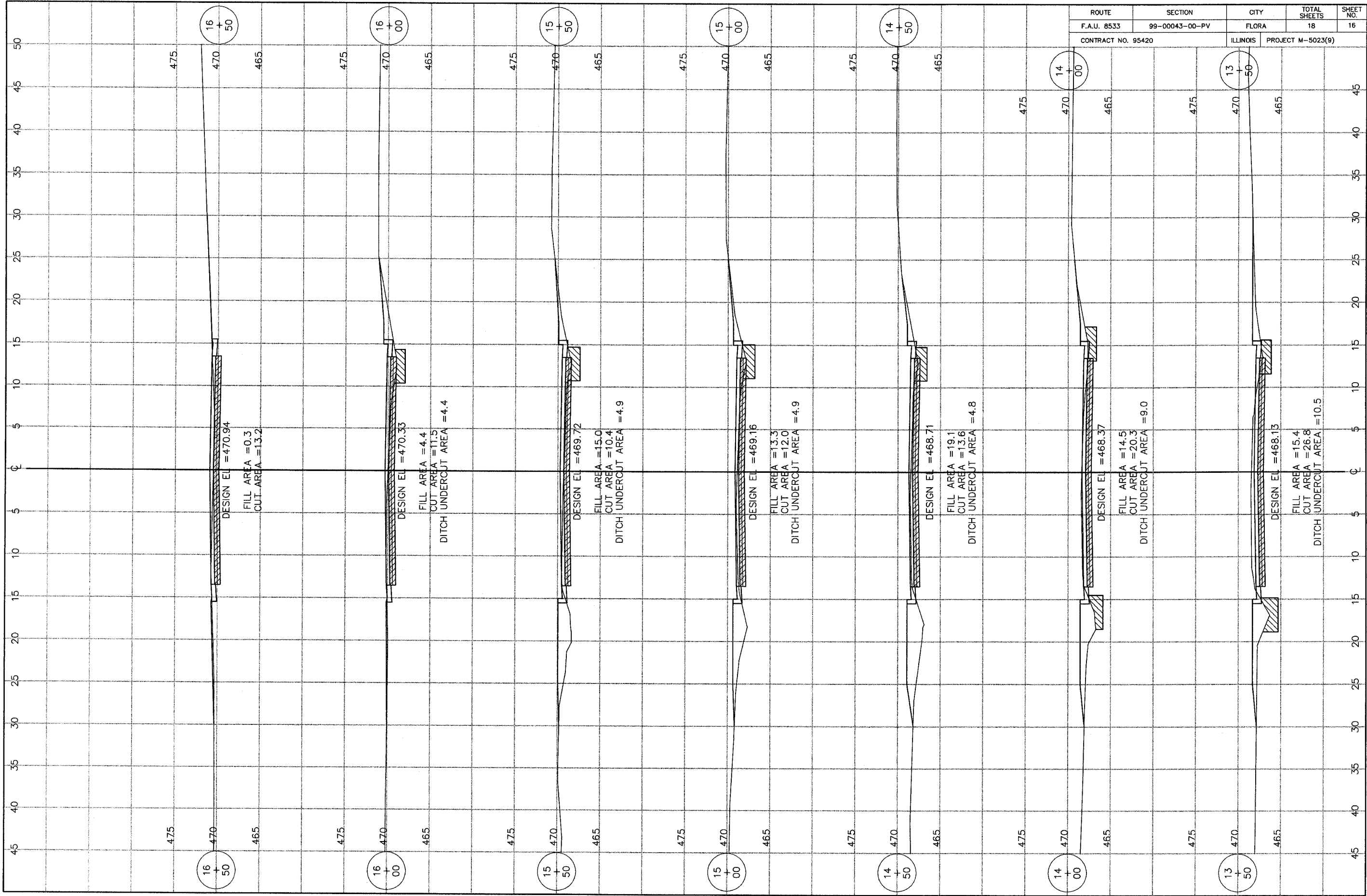

ROUTE	SECTION	CITY	TOTAL SHEETS	SHEET NO.
F.A.U. 8533	99-00043-00-PV	FLORA	18	16
CONTRACT NO. 95420		ILLINOIS	PROJECT M-5023(9)	

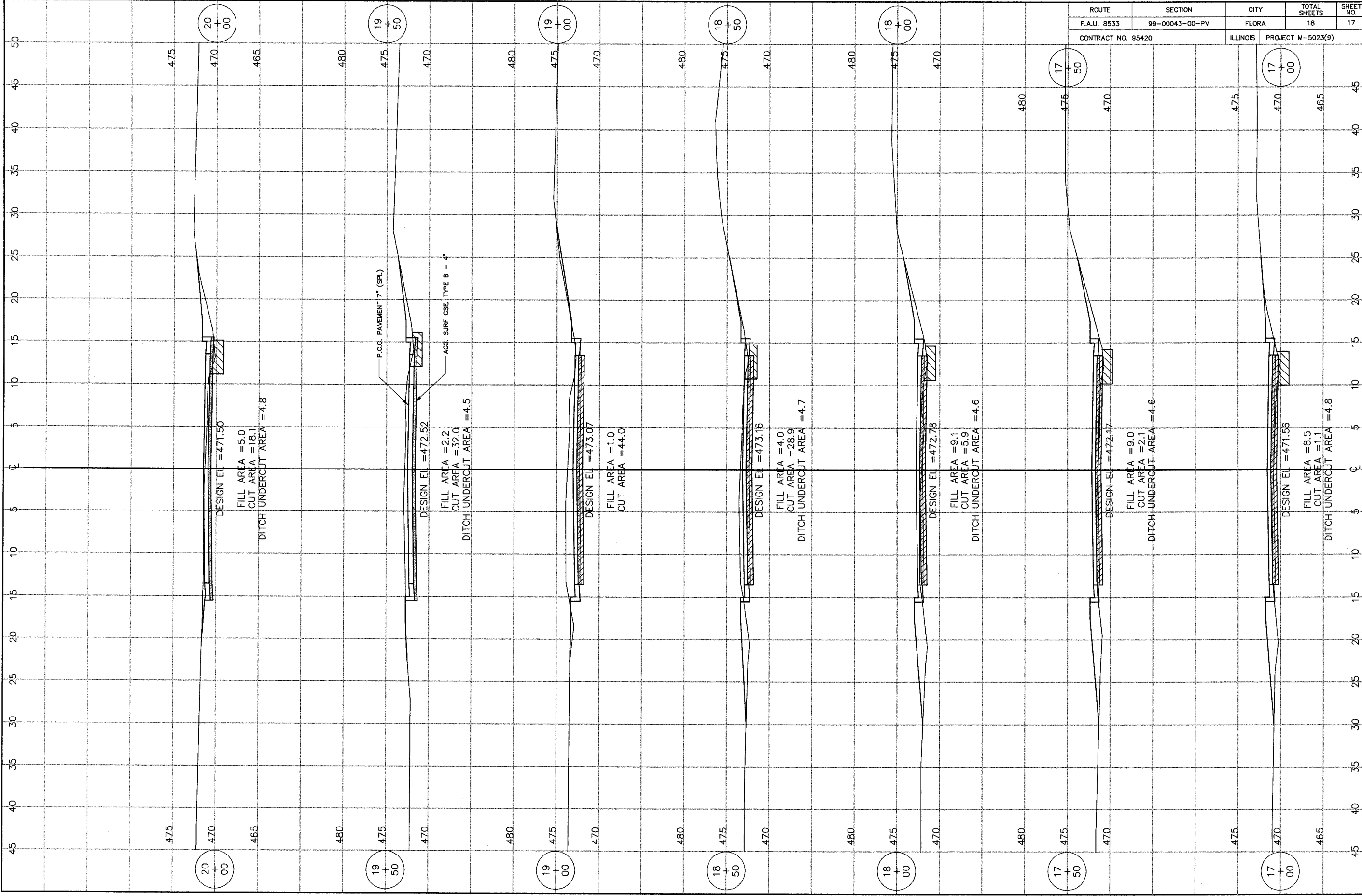

ROUTE	SECTION	CITY	TOTAL SHEETS	SHEET NO.
F.A.U. 8533	99-00043-00-PV	FLORA	18	17
CONTRACT NO. 95420		ILLINOIS	PROJECT M-5023(9)	

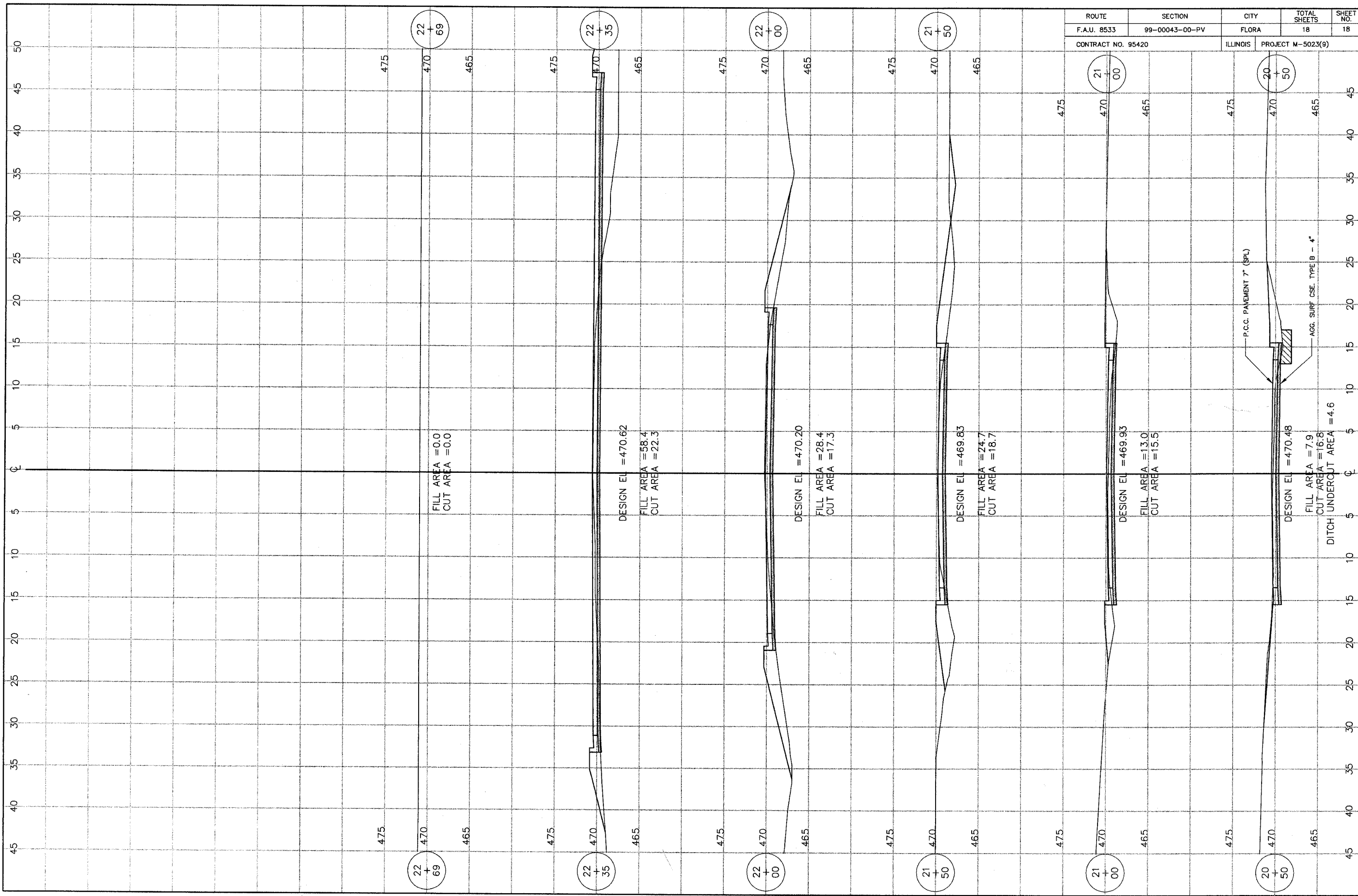

ROUTE	SECTION	CITY	TOTAL SHEETS	SHEET NO.
F.A.U. 8533	99-00043-00-PV	FLORA	18	18
CONTRACT NO. 95420		ILLINOIS	PROJECT M-5023(9)	

22
+
69

22
+
35

22
+
00

21
+
50

21
+
00

20
+
50

22
+
69

22
+
35

22
+
00

21
+
50

21
+
00

20
+
50

FILL AREA = 0.0
CUT AREA = 0.0

DESIGN EL = 470.62
FILL AREA = 58.4
CUT AREA = 22.3

DESIGN EL = 470.20
FILL AREA = 28.4
CUT AREA = 17.3

DESIGN EL = 469.83
FILL AREA = 24.7
CUT AREA = 18.7

DESIGN EL = 469.93
FILL AREA = 13.0
CUT AREA = 15.5

DESIGN EL = 470.48
FILL AREA = 7.9
CUT AREA = 16.8
DITCH UNDERCUT AREA = 4.6

P.C.C. PAVEMENT 7" (SPL)

AGG. SURF. CSE. TYPE B - 4"