

ROUTE	SECTION	COUNTY	TOTAL SHEETS	SHEET NO.
TR 22	04-15109-00-BR	MARION	10	1
FED. ROAD DIST. NO. 7 ILLINOIS		FEDERAL AID PROJECT		
CONTRACT NO. 95430				

STATE OF ILLINOIS
DEPARTMENT OF TRANSPORTATION

PLANS FOR PROPOSED FEDERAL - AID BRIDGE REPLACEMENT AND REHABILITATION PROGRAM

TR 22 (POPE ROAD) SECTION 04-15109-00-BR PROJECT NO. BROS-121(40) MARION COUNTY OVER LOST CREEK C-97-098-04

INDEX OF SHEETS

1. COVER SHEET
2. SUMMARY OF QUANTITIES AND TYPICAL SECTIONS
3. PLAN AND PROFILE OF ROADWAY
4. CROSS SECTIONS OF ROADWAY
5. GENERAL PLAN AND ELEVATION
- 6.-7. PRECAST PRESTRESSED CONCRETE DECK BEAM DETAILS
8. STEEL RAILING, TYPE S1 DETAILS
9. ABUTMENT DETAILS
10. PIER DETAILS

STANDARDS ARE INCLUDED IN PLANS AFTER SHEET NO. 10

000001-04	STANDARD SYMBOLS, ABBREVIATIONS AND PATTERNS
515001-02	NAME PLATE FOR BRIDGES
630001-05	STEEL PLATE BEAM GUARD RAIL
635006-02	REFLECTOR AND TERMINAL MARKER PLACEMENT
702001-05	TRAFFIC CONTROL DEVICES
BLR 21-6	TYPICAL APPLICATION OF TRAFFIC CONTROL DEVICES FOR CONSTRUCTION ON RURAL LOCAL HIGHWAYS

SOIL BORINGS (SEE SPECIFICATIONS)

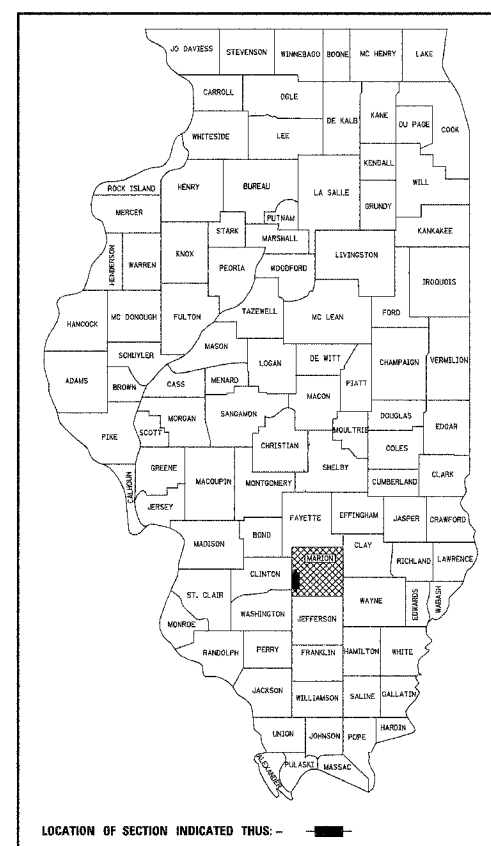

LOCATION OF SECTION INDICATED THUS: - [shaded box] -

DESIGN CLASSIFICATION: LOCAL ROAD (RURAL)
ADT₂₀₀₄ : 75
ADT₂₀₂₄ : 100
DESIGN SPEED - 30 MPH

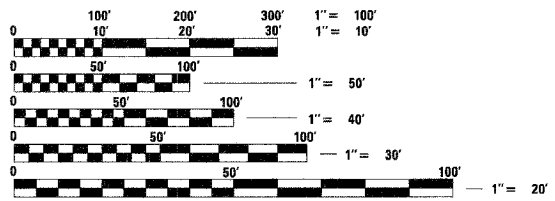

FULL SIZE PLANS HAVE BEEN PREPARED USING STANDARD ENGINEERING SCALES, REDUCED SIZED PLANS WILL NOT CONFORM TO STANDARD SCALES, IN MAKING MEASUREMENTS ON REDUCED PLANS, THE ABOVE SCALES MAY BE USED.

J.U.L.I.E.
JOINT UTILITY LOCATING INFORMATION FOR EXCAVATORS
1-800-892-0123 Website: <http://www.illinois1call.com>

CONTRACT NUMBER: 95430

SECTION 04-15109-00-BR
INCLUDES THE CONSTRUCTION OF A THREE (3) SPAN PRECAST PRESTRESSED CONCRETE DECK BEAM BRIDGE CARRYING TR 22 OVER LOST CREEK, 94'-4 1/2" BK TO BK ABUTMENTS, 45° AH. RT. SKEW. EXISTING STRUCTURE NO. 061-3189 PROPOSED STRUCTURE NO. 061-3299

SECTION ENDS
STA. 10+67.20

SECTION BEGINS
STA. 9+16.82

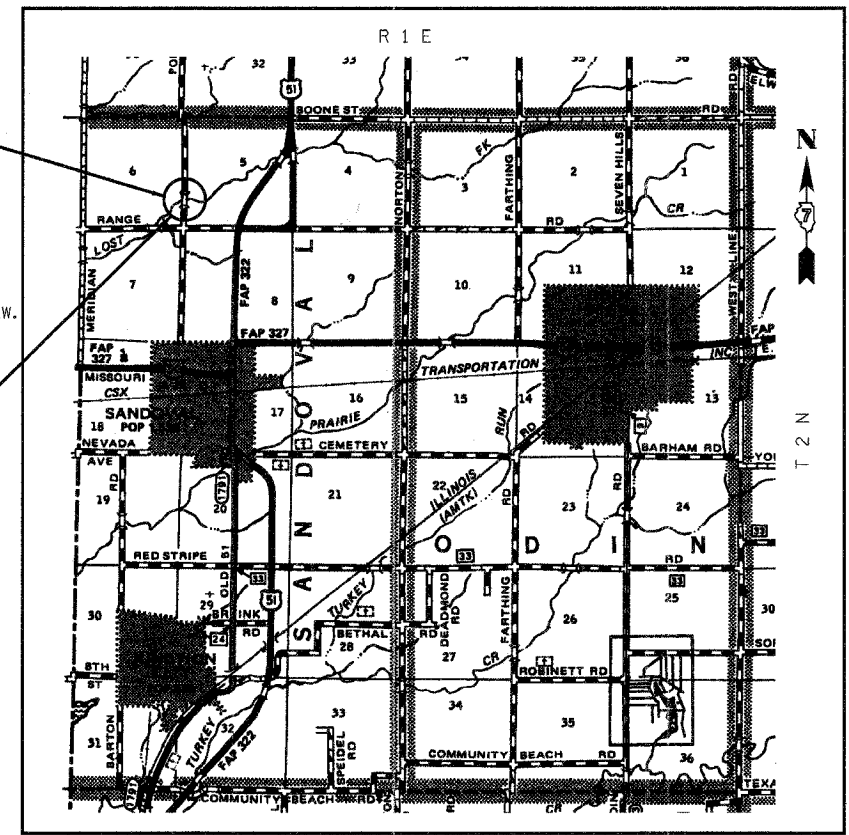

LOCATION: NEAR THE SE CORNER, SE 1/4, SECTION 6, T2N, R1E, 3RD P.M.
NET LENGTH OF PROJECT: 150.38 FT = 0.028 MI

APPROVED _____ 3-15, 2005
Jerry E. Ammon
COUNTY ENGINEER

THE ACCEPTANCE OF THIS PROJECT IS BASED ON THE MINIMUM DESIGN CRITERIA FOR A FEDERAL-AID BRIDGE REPLACEMENT AND REHABILITATION PROGRAM.

PASSED _____ 4/4, 2005
Maurice Karl
DISTRICT ENGINEER OF LOCAL ROADS AND STREETS

APPROVED _____ 4/4, 2005
Christie M. Reed
DEPUTY DIRECTOR OF HIGHWAYS
REGION FOUR ENGINEER

STATE OF ILLINOIS
DEPARTMENT OF TRANSPORTATION



Gary L. Hahn 03-15-05
GARY L. HAHN
CENTRALIA, ILLINOIS
ILLINOIS LICENSED PROFESSIONAL
ENGINEER NO. 62-42606
EXPIRES NOV. 30, 2005



Gary L. Hahn 03-15-05
GARY L. HAHN
CENTRALIA, ILLINOIS
ILLINOIS LICENSED STRUCTURAL
ENGINEER NO. 81-4853
EXPIRES NOV. 30, 2006