

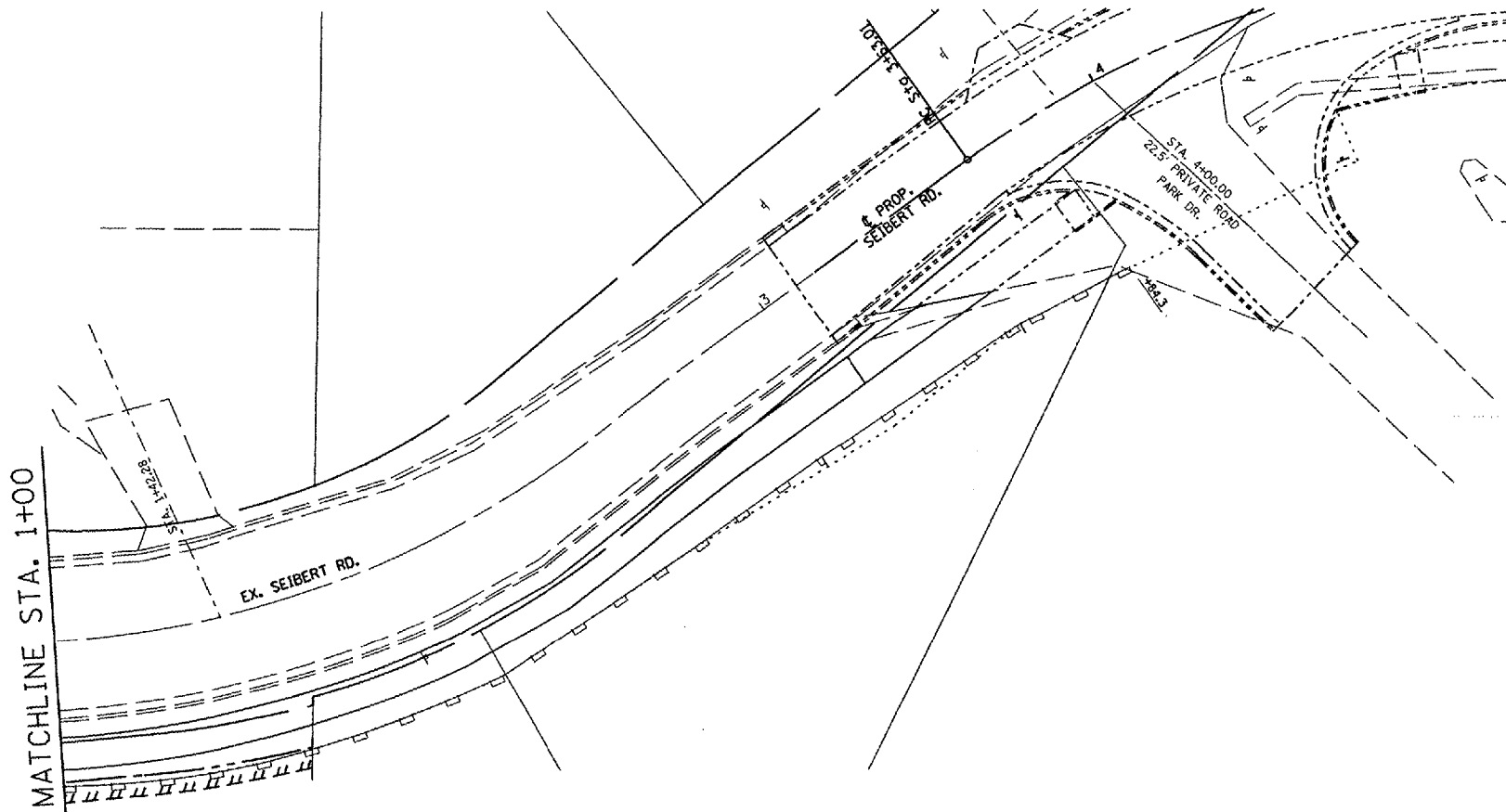



CONTRACT NO. 97245

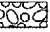

LEGEND

-  TEMPORARY DITCH CHECK
-  STONE RIPRAP CLASS A4 WITH FILTER FABRIC
-  INLET AND PIPE PROTECTION
-  PERIMETER EROSION BARRIER

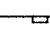
PLAN	REVISIONS	DATE
NO.	BY	
NOTED BY CHECKED BY DATE		
NOTE BOOK NO. DATE		
FILE NAME		

PROFILE	REVISIONS	DATE
NO.	BY	
NOTED BY CHECKED BY DATE		
NOTE BOOK NO. DATE		
FILE NAME		

**THOUVENOT,
WADE &
MOERCHEN, INC.**
ENGINEERS • SURVEYORS • PLANNERS



CORPORATE OFFICE

4940 OLD COLLINSVILLE RD.
SWANSEA, ILLINOIS 62226
TEL (618) 624-4488
FAX (618) 624-6688
corp@twm-inc.com

WATERLOO OFFICE

118 EAST THIRD STREET
WATERLOO, ILLINOIS 62298
TEL (618) 939-5050
FAX (618) 939-3938
waterloo@twm-inc.com

ST. LOUIS OFFICE

1001 CRAIG ROAD, SUITE 260
ST. LOUIS, MISSOURI 63146
TEL (314) 236-5052
FAX (314) 872-2194
stlouis@twm-inc.com

PROFESSIONAL REGISTRATIONS	LICENSE NO.
ILLINOIS PROFESSIONAL DESIGN FIRM	104-00220
PROFESSIONAL ENGINEERING CORP.	62-005370
PROFESSIONAL STRUCTURAL ENGR. CORP.	81-005202
ILLINOIS PROF. LAND SURVEYING CORP.	048-000029
MISSOURI PROFESSIONAL ENGR. CORP.	MC 001528
MISSOURI LAND SURVEYING CORP.	MC 000346

SEAL

Renewed Date:
Signature Date:

STATEMENT OF RESPONSIBILITY

I hereby confirm that the document herein to be authorized by my seal is restricted to this sheet, and I hereby disclaim any responsibility for all other drawings, specifications, estimates, reports or other documents or instruments relating to or intended to be utilized for any other part of the architectural, engineering or survey project.

EROSION CONTROL SHEETS

BIKE TRAIL
VILLAGE OF SHILOH
ST. CLAIR COUNTY, ILLINOIS

REV.	DATE	DESCRIPTION
△	/ /	
△	/ /	

DRAWN BY:	SHEET 18 OF 37 SHEETS
DESIGNED BY:	
CHECKED BY:	
CONTRACT NUMBER:	
PROJECT NUMBER:	
<input checked="" type="checkbox"/> ISSUED FOR REVIEW <input type="checkbox"/> ISSUED FOR BIDDING <input type="checkbox"/> ISSUED FOR CONSTR. <input type="checkbox"/> RECORD DRAWING	

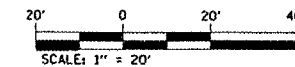

#FILES #DATES