

PAVEMENT MARKINGS

FEDERAL AID PROJECT
CONTRACT NO. 97248

REALIGNMENT SECTION
STA. 51+00 TO STA. 69+00

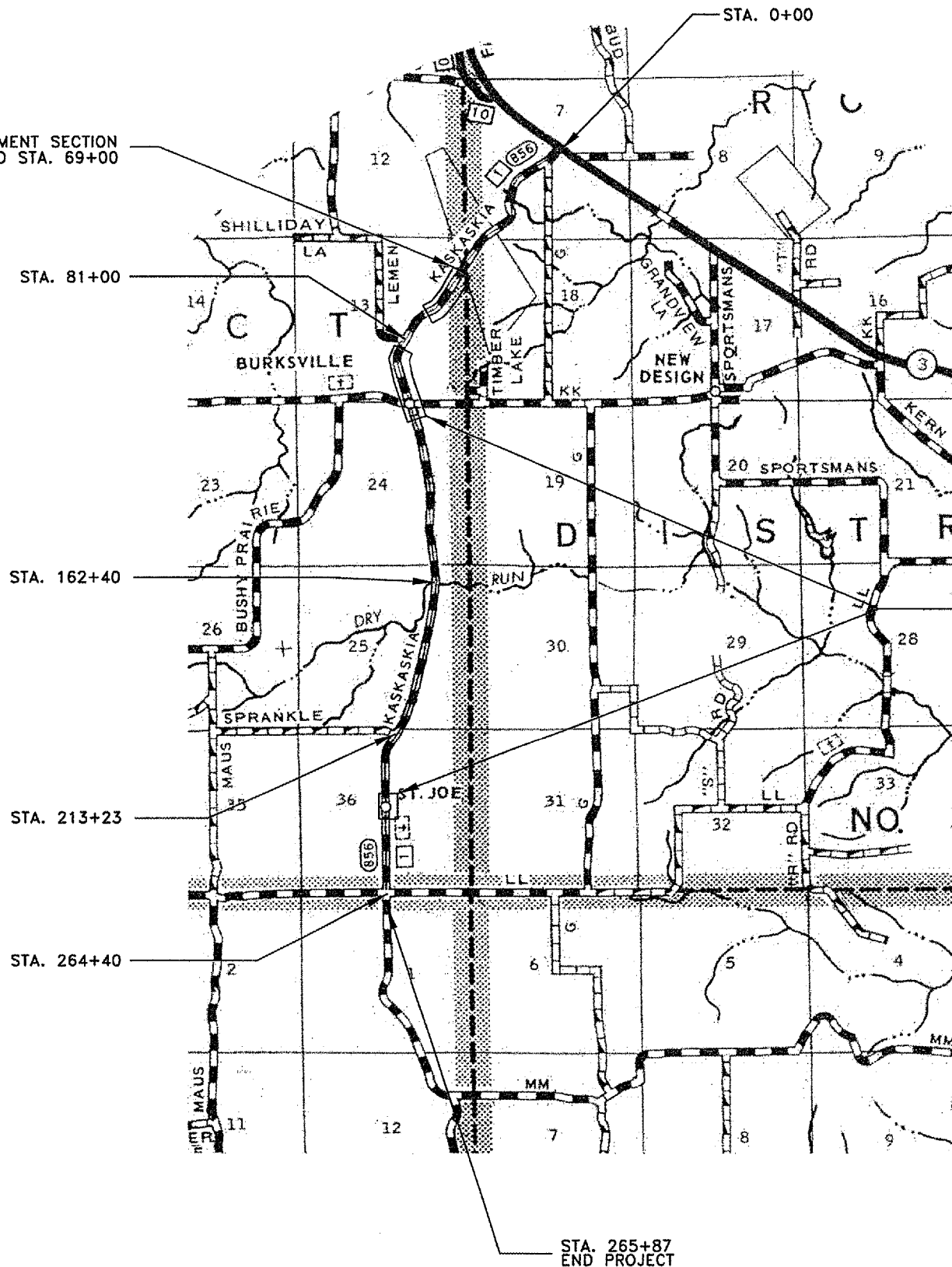

LOCATION MAP
NOT TO SCALE

STATION	PAINT			THERMOPLASTIC			RAISED REFLECTIVE PAVEMENT MARKER	
	SKIP-DASH YELLOW 4" (FT)	SOLID YELLOW 4" (FT)		SOLID WHITE 8" (FT)	SOLID WHITE 12" (FT)	SYMBOLS RT. ARROW (SF)	RAISED REFLECTIVE PAVEMENT MARKER	
		NO. PASSING	ZONE				AMBER 2-WAY (EACH)	CRYSTAL 1-WAY (EACH)
1883+76.34 TO 1879+33.34	---	---	---	443	---	---	31.2	11
0+11 TO 4+00	---	360	360	962	278	197	31.2	8
4+00 TO 6+23	56	---	---	446	---	---	9	8
6+23 TO 6+65	10	---	---	42	---	---	---	---
6+65 TO 12+32	142	---	---	1134	---	---	---	---
12+32 TO 20+04	193	---	772	1544	---	---	---	---
20+04 TO 23+57	88	---	---	706	---	---	---	---
23+57 TO 31+47	197	790	---	1580	---	---	48	---
31+47 TO 33+70	75	---	---	800	---	---	8	---
33+70 TO 41+08	184	---	738	1476	---	---	2	---
41+08 TO 44+57	87	---	---	698	---	---	---	---
44+57 TO 51+44	172	687	---	1374	---	---	---	---
51+44 TO 51+94	---	50	---	100	---	---	---	---
51+94 TO 62+57	266	---	1063	2126	---	---	---	---
62+57 TO 76+93	---	1438	1436	2872	---	---	---	---
76+93 TO 80+63	92	370	---	740	---	---	---	---
80+63 TO 81+37	18	74	---	74	---	---	---	---
81+37 TO 87+98	165	661	---	1322	---	---	---	---
87+98 TO 101+64	342	---	---	2732	---	---	---	---
101+64 TO 102+83	38	---	---	38	---	---	---	---
102+83 TO 104+68	46	---	---	370	---	---	---	---
104+68 TO 108+49	95	---	381	762	---	---	---	---
108+49 TO 109+90	35	---	---	282	---	---	---	---
109+90 TO 118+93	226	903	---	1806	---	---	---	---
118+93 TO 123+27	108	---	---	868	---	---	---	---
123+27 TO 132+37	228	---	910	1820	---	---	---	---
132+37 TO 134+30	48	---	---	386	---	---	---	---
134+30 TO 139+69	135	539	---	1078	---	---	---	---
139+69 TO 143+97	---	428	428	856	---	---	---	---
143+97 TO 150+35	160	---	638	1276	---	---	---	---
150+35 TO 162+83	---	1248	1248	2496	---	---	---	---
162+83 TO 173+31	262	1048	---	2096	---	---	---	---
173+31 TO 177+59	107	---	---	856	---	---	---	---
177+59 TO 187+71	253	---	1012	2024	---	---	---	---
187+71 TO 189+16	---	145	145	290	---	---	---	---
189+16 TO 198+96	245	980	---	1960	---	---	---	---
198+96 TO 199+79	---	83	83	166	---	---	---	---
199+79 TO 206+56	169	---	677	1354	---	---	---	---
206+56 TO 208+93	59	---	---	474	---	---	---	---
208+93 TO 212+96	101	403	---	806	---	---	---	---
212+96 TO 213+50	14	54	---	54	---	---	---	---
213+50 TO 217+35	96	385	---	770	---	---	---	---
217+35 TO 223+44	152	---	---	1218	---	---	---	---
223+44 TO 234+50	276	---	1106	2212	---	---	---	---
234+50 TO 240+45	---	595	595	1190	---	---	---	---
240+45 TO 251+42	274	1097	---	2194	---	---	---	---
251+42 TO 264+15	318	---	---	2546	---	---	---	---
264+15 TO 264+65	12	---	---	---	---	---	---	---
264+65 TO 265+87	30	---	---	244	---	---	---	---
SUBTOTALS	5566	12336	11642	53463	278	197	62.4	67
TOTALS			83007		278	197	62.4	67

BITUMINOUS SURFACE REMOVAL, 2"
STA. 83+61 TO STA. 107+98
STA. 231+74 TO STA. 239+78

PAINT PAVEMENT MARKINGS REMOVAL

EDGELINE RT. 3 - 4"
1883+76.34 TO 1881+26.34 250'
1878+72 TO 1878+50 22'
1878+00.75 TO 1876+87.08 114'
386'

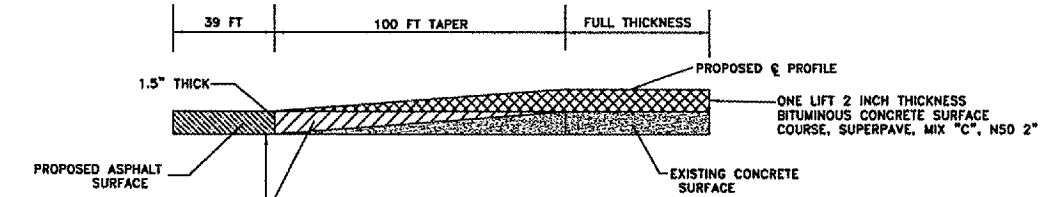

ASPHALT TAPER/CONCRETE BUTT JOINT DETAIL
STA. 0+11 TO STA. 1+50
COLD MILL EXISTING PAVEMENT AS INDICATED. COST OF COLD MILLING SHALL BE PAID AS PORTLAND CEMENT CONCRETE SURFACE REMOVAL - BUTT JOINT

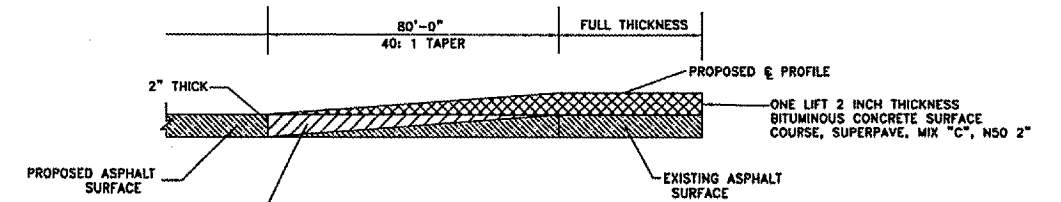

ASPHALT TAPER/BUTT JOINT DETAIL
STA. 82+81 TO STA. 83+61
STA. 107+98 TO STA. 108+78
STA. 230+94 TO STA. 231+74
STA. 239+78 TO STA. 240+58
COLD MILL EXISTING PAVEMENT AS INDICATED. COST OF COLD MILLING SHALL BE PAID AS BITUMINOUS SURFACE REMOVAL - BUTT JOINT

KASKASKIA ROAD
LOCATION MAP
SECTION 02-00041-01-RS
MONROE COUNTY, IL