

F.A.P. NO.	SECTION	COUNTY	TOTAL SHEETS	SHEET NO.
869	(103)I	SALINE	64	22
STA.	TO STA.			
FED. ROAD DIST. NO.	ILLINOIS	FED. AID PROJECT		

CONTRACT NO. 98896

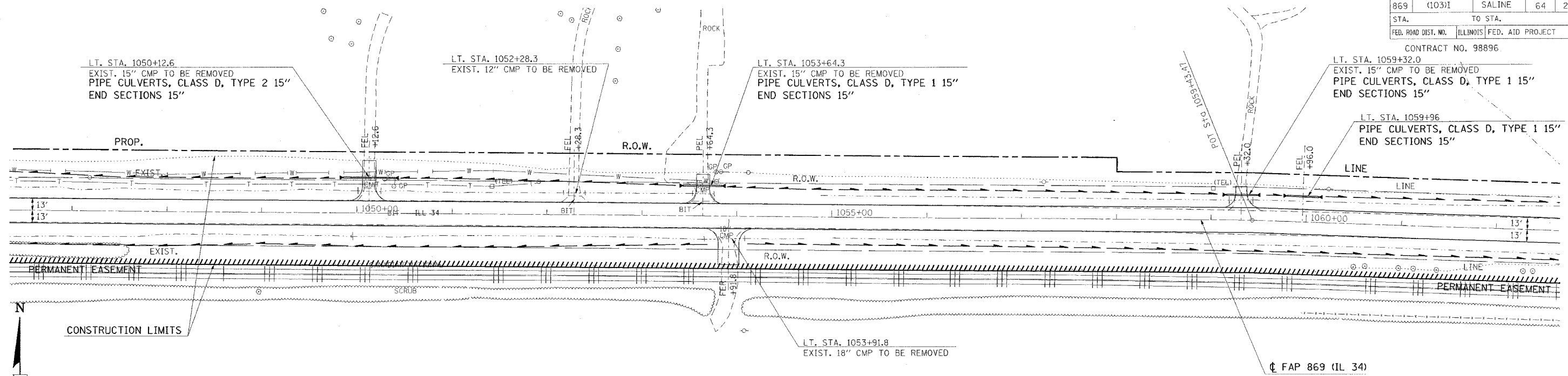

FROM STA. 1056+50 TO STA. 1062+50 THE PROPOSED CENTERLINE OF PAVEMENT DEVIATES FROM THE EXISTING ALIGNMENT. IN THIS LOCATION, CONSTRUCT IN ACCORDANCE WITH THE PROPOSED CROSS-SECTIONS.

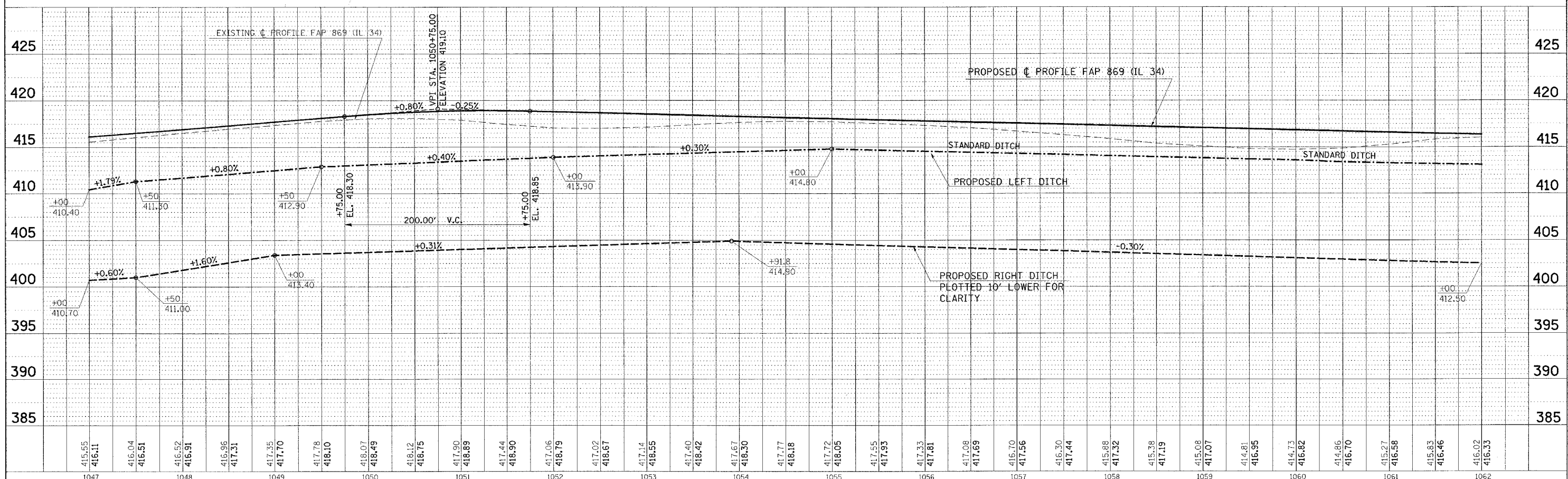

PLAN PROFILE SHEET STA. 1047+00 TO STA. 1062+00

PLAN	DATE
BY	
CHECKED	
DATE	
NOTE BOOK NO.	
FILE NAME	

PROFILE	DATE
BY	
CHECKED	
DATE	
NOTE BOOK NO.	
FILE NAME	

34mm3 FEBRUARY 14, 2005 MORNING
D903502/090350222.dgn