

F.A.P. R/L	SECTION	COUNTY	TOTAL SHEETS	SHEET NO.
869	(103)I	SALINE	64	26
STA.	TO STA.			
FED. ROAD DIST. NO.	ILLINOIS	FED. AID PROJECT		
CONTRACT NO. 98896				

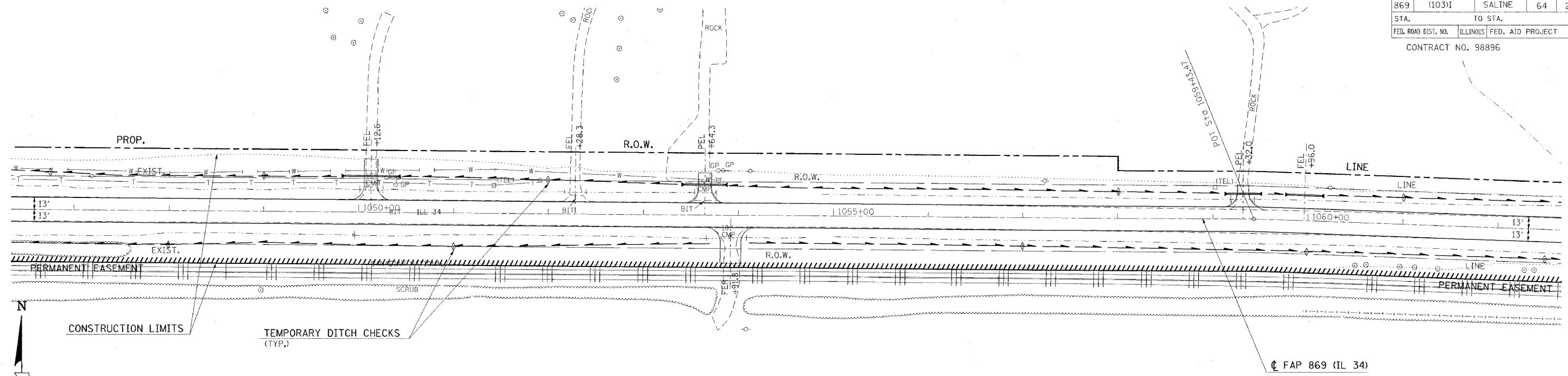

FROM STA. 1056+50 TO STA. 1062+50 THE PROPOSED CENTERLINE OF PAVEMENT DEVIATES FROM THE EXISTING ALIGNMENT. IN THIS LOCATION, CONSTRUCT IN ACCORDANCE WITH THE PROPOSED CROSS-SECTIONS.

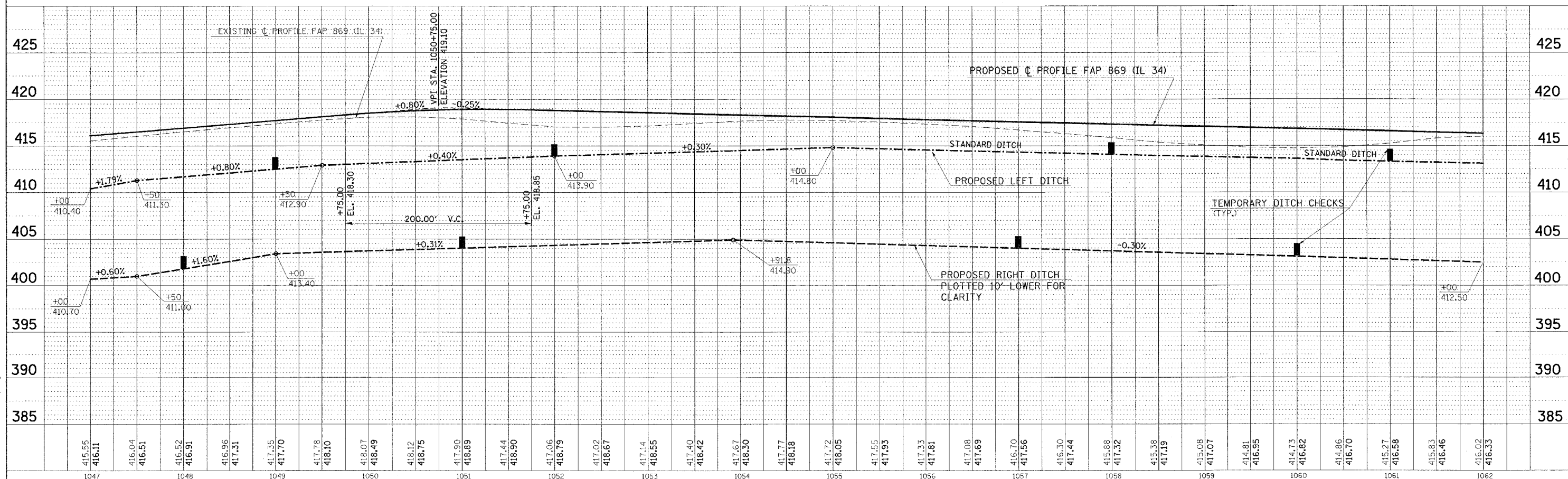

**TEMPORARY EROSION CONTROL STA. 1047+00 TO STA. 1062+00**

DATE	
BY	
REVISIONS	
NO.	
DESCRIPTION	

DATE	
BY	
REVISIONS	
NO.	
DESCRIPTION	

34min3 FEBRUARY 14, 2005 MRRRNING  
 0903502/0903502b2.dgn