

ROUTE	SECTION	COUNTY	TOTAL SHEETS	SHEET NO.
FAS 929	01-00056-00-RS	JOHNSON	27	3
PROJECT NO. SR-929(119)		CONTRACT NO. 99164		

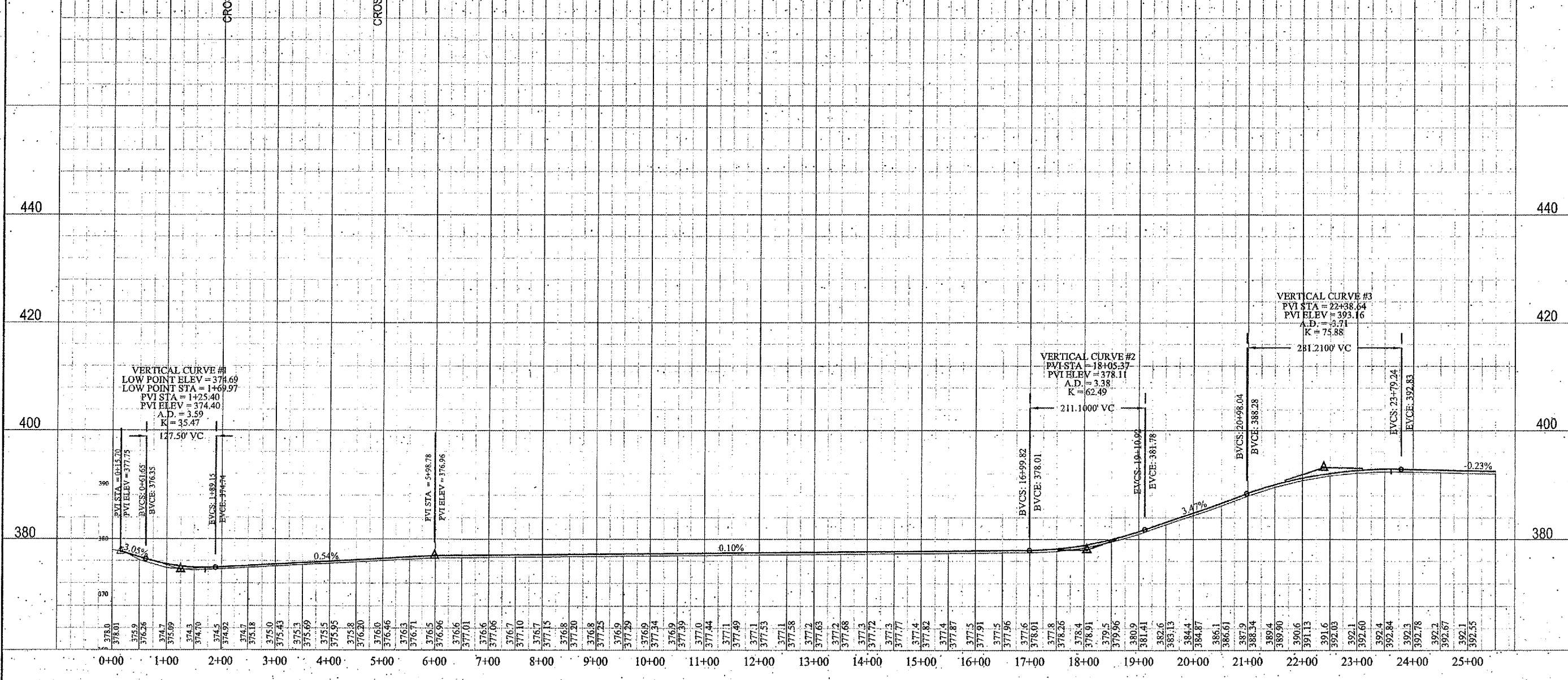

SIGNATURE  
11/30/05  
LIC. EXP. DATE

**SHAWNEE SURVEY & CONSULTING, INC**

PHONE: (618) 658-6065 FAX: (618) 658-9190  
P.O. BOX 125  
104 S. FOURTH STREET  
VIENNA, IL 62995

SSCI

PLSF NO.: 048-000151 PDF NO.: 104-02944

**JOHNSON COUNTY HIGHWAY DEPARTMENT**

P.O. BOX 247  
VIENNA, IL 62995

**OLD METROPOLIS ROAD RESURFACING PROJECT**  
FAS ROUTE 929, CHS  
SECTION 01-00056-00-RS

FUNDING OR PROJECT NUMBER

DRAWING INFORMATION	
DRAWN BY: P. RUZICH	PRELIMINARY
CHECKED BY: KDM	RD / CONSTRUCTION
SCALE: 1" = 200'	FINAL / RECORD
JOB NO.: 2001-134	
DRAWING REVISIONS	
REV.	DATE
1	01/23/02
2	08/12/02
3	12/13/04
3	1/14/06

SHEET NUMBER  
**03**  
PLAN / PROFILE SHEET