

ROUTE	SECTION	COUNTY	TOTAL SHEETS	SHEET NO.
FAS 929	01-00056-00-RS	JOHNSON	27	23
PROJECT NO. SR-929(119)		CONTRACT NO. 99164		

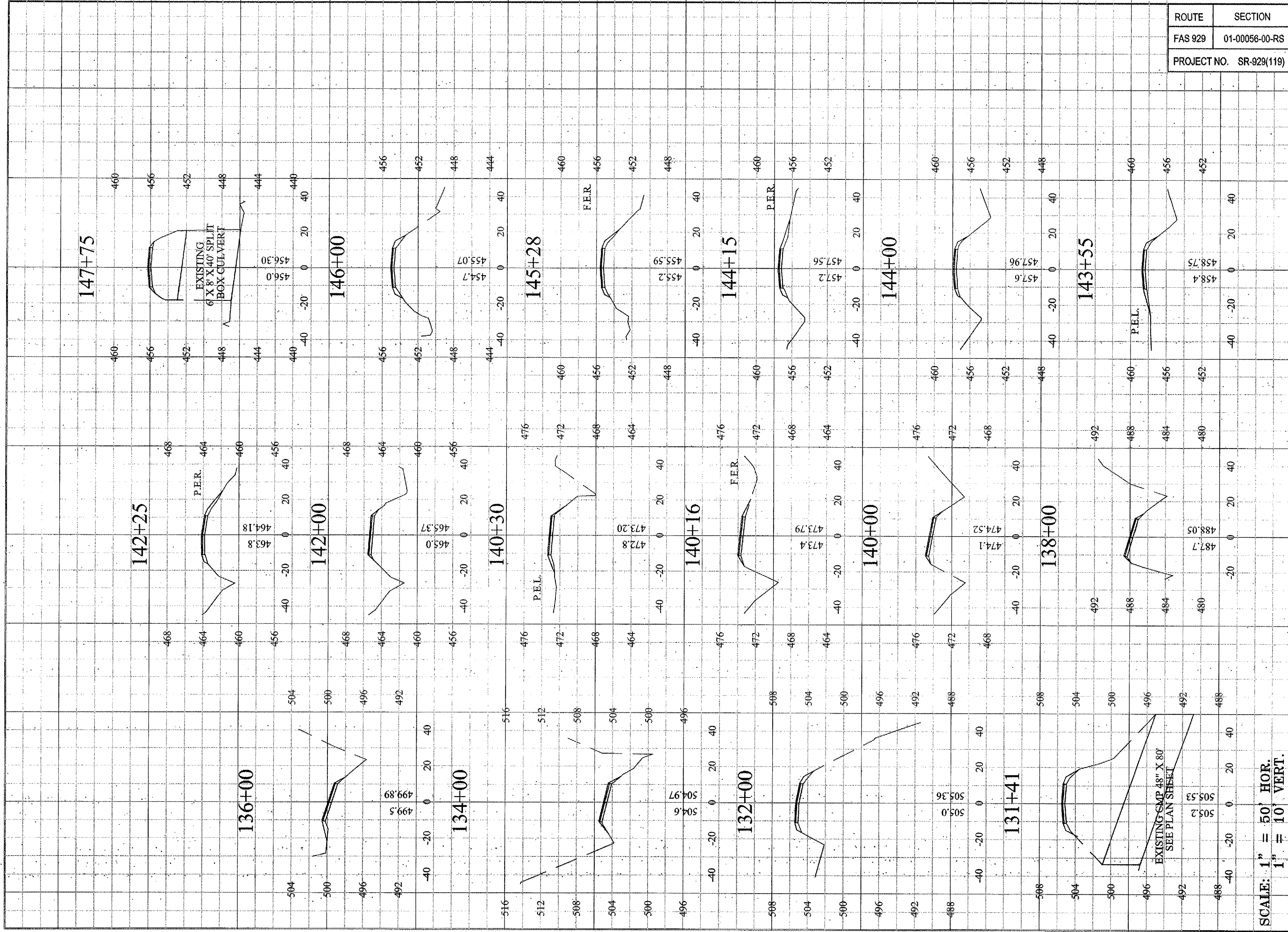

SCALE: 1" = 50' HOR.
1" = 10' VERT.

DRAWING INFORMATION		
DRAWN BY: P. RUZICH	<input checked="" type="checkbox"/> PRELIMINARY	
DATE:	<input type="checkbox"/> BID / <input type="checkbox"/> CONSTRUCTION	
CHECKED BY: KDM	<input type="checkbox"/> FINAL / <input type="checkbox"/> RECORD	
SCALE:		
JOB NO.: 2001-134	<input type="checkbox"/> FINAL / <input type="checkbox"/> RECORD	
DRAWING REVISIONS		
REV.	DATE	REVISIONS
1	01/23/04	
2	08/12/04	
3	12/13/04	
3	1/14/05	

JOHNSON COUNTY
HIGHWAY DEPARTMENT
P.O. BOX 247
VIENNA, IL 62995
OLD METROPOLIS ROAD
RESURFACING PROJECT
FAS ROUTE 929, CH5
SECTION 01-00056-00-RS
FUNDING OR PROJECT NUMBER

SHAWNEE SURVEY &
CONSULTING, INC
PHONE: (618) 668-6065 FAX: (618) 668-9160
P.O. BOX 125
104 S. FOURTH STREET
VIENNA, IL 62995
SIGNATURE
5/03/11
LIC. EXP. DATE
PLSF NO.: 048-000151 PDF NO.: 104-02344

23
CROSS SECTION SHEET