

STATE-LOCAL MARKING QUANTITIES			
DESCRIPTION	UNIT AREA	NO. REQUIRED	TOTAL AREA
TAXIWAY CENTERLINE	686	1	686
TIE DOWN	40	8,925	357
GROUND ROD	7	4	28
HELIPAD	473	1	473
TOTAL MARKING			1,544

LOCAL ONLY MARKING QUANTITIES			
DESCRIPTION	UNIT AREA	NO. REQUIRED	TOTAL AREA
LOGAN CO.	921	-	921
TOTAL MARKING			921

TIE DOWN REMOVAL NOTES

THE EXISTING TIE DOWNS LOCATED IN THE AREAS TO BE OVERLAID WILL BE REMOVED AND DISPOSED OF OFF THE AIRPORT SITE. THE PROPOSED TIE DOWNS WILL BE INSTALLED IN THE EXACT SAME LOCATION EXCEPT FOR THE THREE TIE DOWNS LOCATED IN THE EMERGENCY SERVICE AREA. THESE THREE WILL NOT BE REPLACED.

THE CONTRACTOR WILL USE A CORE DRILL TO SEPARATE THE TIE DOWNS TO BE REMOVED FROM THE SURROUNDING PAVEMENT PRIOR TO PULLING THE TIE DOWN OUT. REMOVAL OF THE TIE DOWN WILL NOT CAUSE ANY DISPLACEMENT OF THE SURROUNDING PAVEMENT. ANY DISPLACEMENT WILL BE CORRECTED BY THE CONTRACTOR TO THE SATISFACTION OF THE RESIDENT ENGINEER.

SINCE THE PROPOSED TIE DOWNS WILL GO BACK IN THE SAME LOCATION AS THE EXISTING TIE DOWNS, THE CONTRACTOR WILL FILL THE HOLE WITH SAND. THIS WILL MAKE LOCATING THESE HOLE EASIER.

THE THREE TIE DOWNS THAT WILL NOT BE REPLACED WILL HAVE THEIR HOLES FILLED WITH CRUSHED AGGREGATE BASE COURSE UP TO 8" FROM THE EXISTING SURFACE. THE REMAINING 8" WILL BE FILLED WITH BITUMINOUS SURFACE COURSE.

ALL MATERIAL REMOVED WILL BE DISPOSED OF OFF THE AIRPORT SITE.

ALL MATERIAL USED IN BACKFILLING THE HOLES WILL BE CONSIDERED AS AN INCIDENTAL ITEM TO THE TIE DOWN REMOVAL AND NO ADDITIONAL COMPENSATION WILL BE ALLOWED.

THE REMOVAL AND DISPOSAL OF THE TIE DOWNS AND FILLING OF THE HOLES WITH SAND WILL BE PAID FOR UNDER ITEM:
AR510900 "REMOVE TIE DOWN"... 29 EA.

GROUND ROD REMOVAL NOTES

THE EXISTING GROUND RODS LOCATED IN THE AREAS TO BE OVERLAID WILL BE REMOVED AND DISPOSED OF OFF THE AIRPORT SITE. THE PROPOSED GROUND RODS WILL BE INSTALLED IN THE EXACT SAME LOCATION. ONLY THE GROUND ROD LOCATED IN THE EMERGENCY SERVICES AREA WILL NOT BE REPLACED.

IF THE CONTRACTOR CAN NOT PULL THE GROUND RODS OUT THEN HE WILL USE A 4" CORE DRILL TO REMOVE THE PAVEMENT AROUND THE GROUND RODS THUS MAKING IT EASIER TO REMOVE THE GROUND RODS. REMOVAL OF THE GROUND RODS WILL NOT CAUSE ANY DISPLACEMENT OF THE SURROUNDING PAVEMENT. ANY DISPLACEMENT WILL BE CORRECTED BY THE CONTRACTOR TO THE SATISFACTION OF THE RESIDENT ENGINEER.

IF A 4" CORE DRILL IS USED IN REMOVING THE GROUND RODS, THEN THE HOLES WILL BE BACKFILLED WITH SAND. IF A LARGER DIAMETER CORE DRILL IS USED, THEN THE HOLES WILL BE FILLED WITH SAND TO A DEPTH OF 8" FROM THE EXISTING FINISHED GRADE AND THE REMAINING DEPTH FILLED WITH BITUMINOUS SURFACE COURSE.

THE GROUND ROD IN THE EMERGENCY SERVICES AREA WILL BE FILLED WITH CRUSHED AGGREGATE BASE COURSE AND BITUMINOUS SURFACE COURSE SIMILAR TO THE FILLING OF THE TIE DOWNS LOCATED IN THIS AREA.

ALL REMOVED MATERIAL WILL BE DISPOSED OF OFF THE AIRPORT SITE.

ALL MATERIAL IN BACKFILLING THE HOLE WILL BE CONSIDERED AS AN INCIDENTAL ITEM TO THE REMOVAL OF THE GROUND ROD AND NO ADDITIONAL COMPENSATION WILL BE ALLOWED.

THE REMOVAL AND DISPOSAL OF THE GROUND RODS AND FILLING OF THE HOLES WITH SAND WILL BE PAID FOR UNDER ITEM:
AR510905 "REMOVE GROUND ROD"... 5 EA.

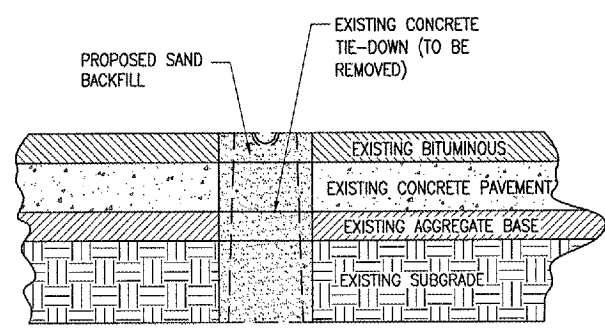
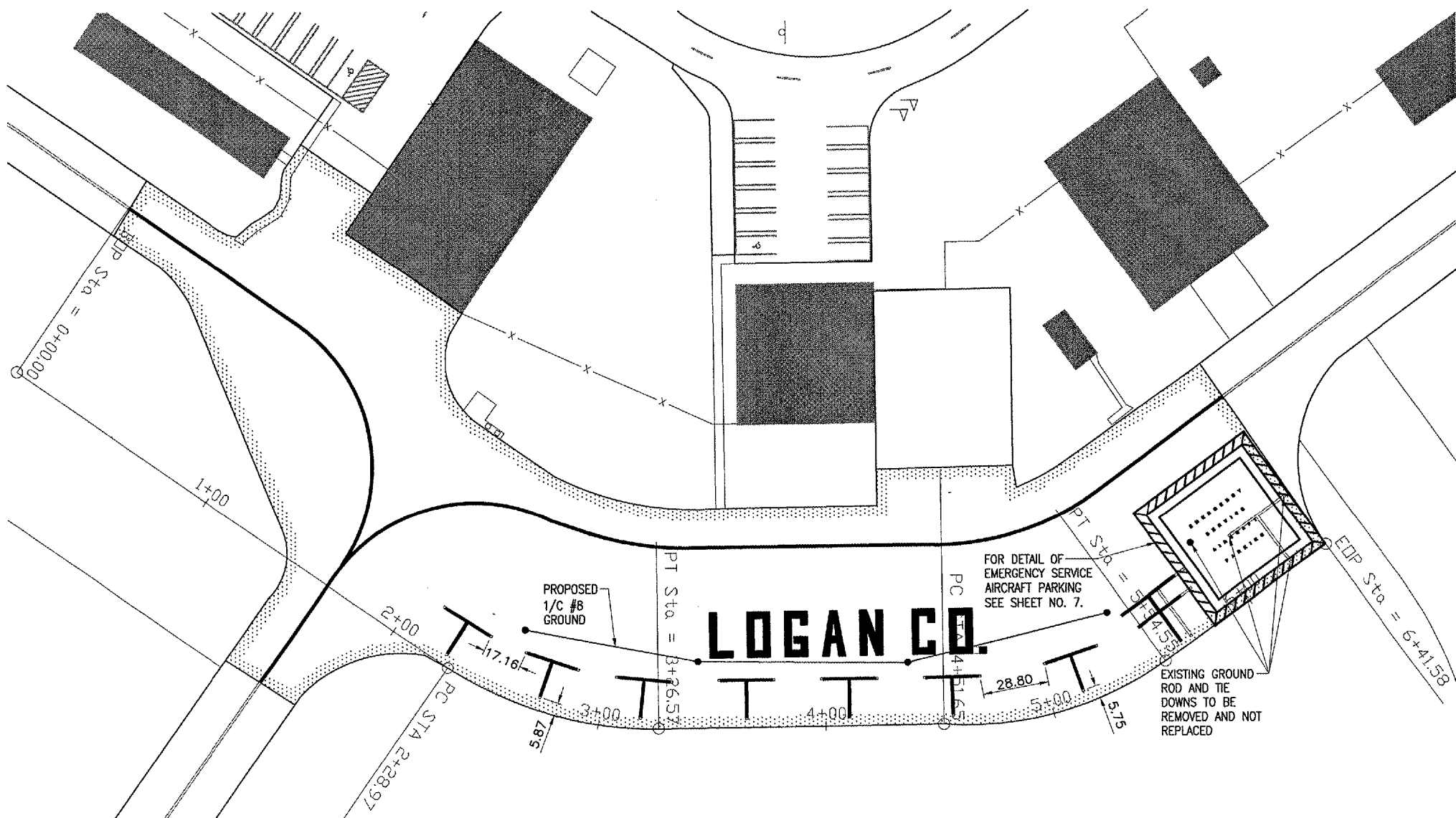

- LEGEND**
- EXISTING IMPROVEMENTS
 - EXISTING BUILDINGS
 - PROPOSED IMPROVEMENTS
 - EXISTING FENCE
 - EXISTING MARKING
 - EXISTING TIE DOWN
 - EXISTING GROUND ROD
 - PROPOSED MARKING

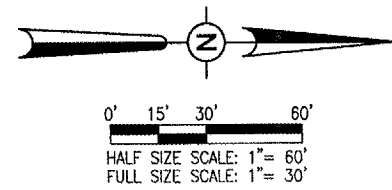

MAY 27, 2005 1:22 PM BAK I:\AIRPORTS\LOGAN\813-05APN\AIRPORT\SHEETS\R-151MRK.DWG - Layout1 O.A. REVIEW: WJM - 3/23/05

DATE	REVISION	BY	
<p>LOGAN COUNTY AIRPORT LINCOLN, ILLINOIS</p>			
<p>IL. PROJ.: AAA-3430 A.I.P. PROJ.: 3-17-0062-812</p>			
<p>HEL Project No.: 813-05APND_0800 Drawn: R-151MRK.DWG Scale: 1" = 30' Date: 01/04/05</p>	<p>LAYOUT: BKB 01/04/05 DRAWN: BAK 01/04/05 REVIEWED: CAH 03/18/05</p>	<p>HANSON Hanson Professional Services Inc. 1525 South Sixth Street Springfield, Illinois 62760-2886 Chicago Nationwide</p>	
<p>REHABILITATE THE G.A. APRON</p>		<p>PROPOSED MARKING PLAN</p>	
<p>8</p>			
<p>8 of 26 sheets</p>			