

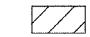







LEGEND

-  WORK AREA
-  IMPACT ATTENUATORS, TEMPORARY
-  TEMPORARY CONCRETE BARRIER
-  DRUM WITH STEADY BURN MONODIRECTIONAL LIGHT
-  DIRECTION INDICATOR BARRICADE WITH STEADY BURN MONODIRECTIONAL LIGHT
-  TYPE II BARRICADES
-  SIGN
-  ARROW BOARD
-  TYPE III BARRICADE

STAGE I CONSTRUCTION:

1. REMOVE CONFLICTING EXISTING PAVEMENT MARKING LINES AND RAISED REFLECTIVE PAVEMENT MARKERS UNDER HIGHWAY STANDARD 701427.
2. CLOSE THE OUTSIDE LANES OF US ROUTE 6 AS SHOWN IN THE PLANS AND IN ACCORDANCE WITH HIGHWAY STANDARDS 701601-07, 701411-07 AND DISTRICT 1 STANDARD TC10.
3. PERFORM OUTSIDE LANE STRUCTURAL AND APPROACH SLAB REPAIRS AS SHOWN IN THE STRUCTURAL PLANS, AS WELL AS THE COMBINATION CURB AND GUTTER REMOVAL AND REPLACEMENT AS SHOWN ON THE PAVEMENT MARKING PLANS.

NOTES:

1. FIRST TWO WARNING SIGNS IN EACH DIRECTION AND WARNING SIGNS ALONG SIDE STREETS REQUIRE MONO-DIRECTIONAL FLASHING BEACONS.
2. CHANGEABLE MESSAGE SIGNS SHALL BE PLACED ALONG NORTHBOUND AND SOUTHBOUND I-94 PRIOR TO EASTBOUND US ROUTE 6 EXITS AND ALONG EASTBOUND AND WESTBOUND US ROUTE 6 TO ADVISE DRIVERS OF CONSTRUCTION ACTIVITY.

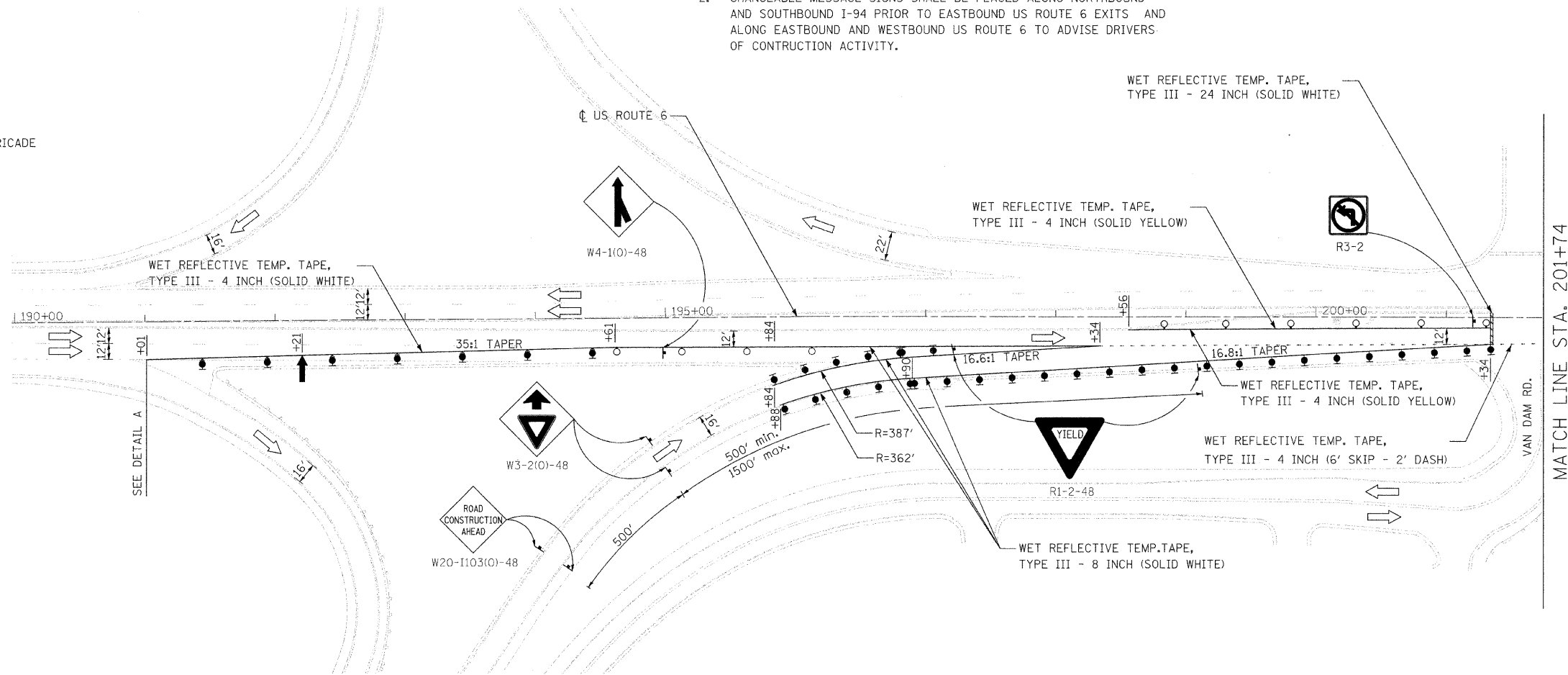
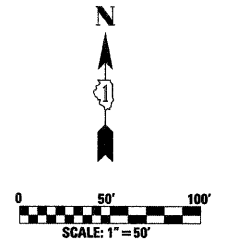

DETAIL A

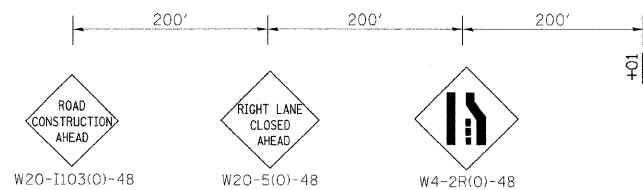

USER NAME = #USER#	DESIGNED - AS	REVISED -
PLOT SCALE = #SCALE#	DRAWN - AS	REVISED -
PLOT DATE = #DATE#	CHECKED - ST	REVISED -
	DATE - 04/2011	REVISED -

**STATE OF ILLINOIS
DEPARTMENT OF TRANSPORTATION**

**MAINTENANCE OF TRAFFIC - STAGE 1
US ROUTE 6 OVER LITTLE CALUMET RIVER**

SCALE: 1"=50' SHEET NO. 1 OF 2 SHEETS STA. 190+00 TO STA. 201+74

F.A.P. RTE. 351	SECTION 539W-1-RS	COUNTY COOK	TOTAL SHEETS 56	SHEET NO. 17
			CONTRACT NO. 60K57	
ILLINOIS FED. AID PROJECT				