

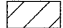

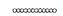

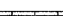

LEGEND

-  WORK AREA
-  IMPACT ATTENUATORS, TEMPORARY
-  TEMPORARY CONCRETE BARRIER
-  DRUM WITH STEADY BURN MONODIRECTIONAL LIGHT
-  DIRECTION INDICATOR BARRICADE WITH STEADY BURN MONODIRECTIONAL LIGHT
-  TYPE II BARRICADES
-  SIGN
-  ARROW BOARD
-  TYPE III BARRICADE

STAGE II CONSTRUCTION:

1. REMOVE CONFLICTING EXISTING PAVEMENT MARKING LINES UNDER HIGHWAY STANDARD 701427.
2. CLOSE THE INSIDE LANES, INCLUDING LEFT TURN LANES, OF US ROUTE 6 AS SHOWN IN THE PLANS AND IN ACCORDANCE WITH HIGHWAY STANDARD 701601-07 AND DISTRICT 1 STANDARD TC 10.
3. PERFORM STRUCTURAL AND APPROACH SLAB REPAIRS AS SHOWN IN THE STRUCTURAL PLANS.
4. APPLY PERMANENT PAVEMENT MARKINGS AND RAISED REFLECTIVE PAVEMENT MARKERS AS SHOWN IN THE PAVEMENT MARKINGS PLANS IN ACCORDANCE WITH HIGHWAY STANDARD 701427.

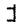
NOTES:

1. FIRST TWO WARNING SIGNS IN EACH DIRECTION AND WARNING SIGNS ALONG SIDE STREETS REQUIRE MONO-DIRECTIONAL FLASHING BEACONS.
2. CHANGABLE MESSAGE SIGNS ALONG NB AND SB I-94 AND ALONG US ROUTE 6 TO REMAIN FROM STAGE I UNTIL PROJECT COMPLETION.

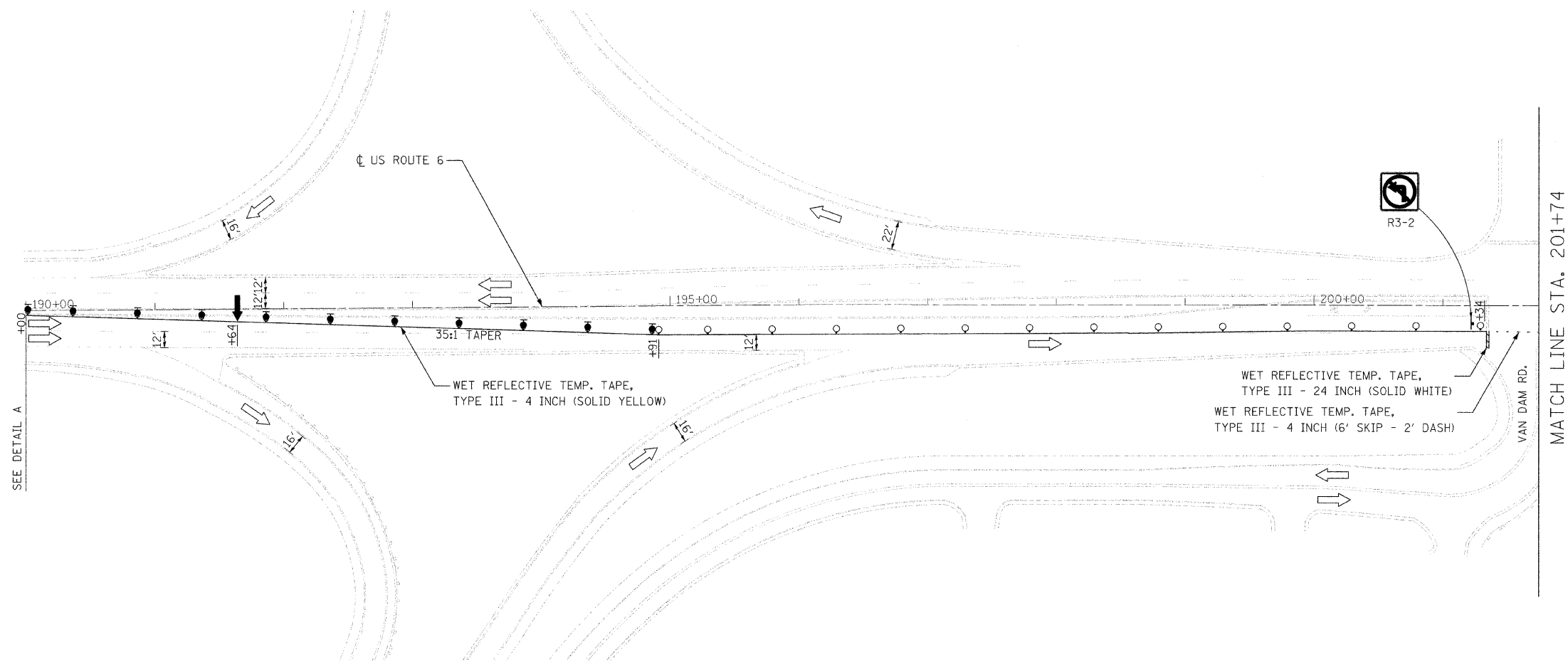
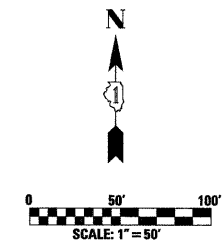

DETAIL A

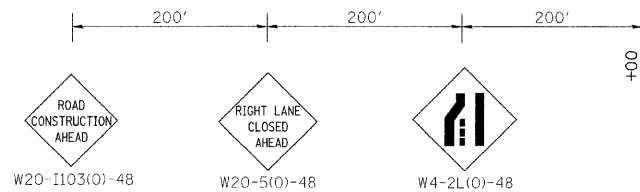

USER NAME = #USER#	DESIGNED - AS	REVISED -
PLOT SCALE = #SCALE#	DRAWN - AS	REVISED -
PLOT DATE = #DATE#	CHECKED - ST	REVISED -
	DATE - 04/2011	REVISED -

**STATE OF ILLINOIS
DEPARTMENT OF TRANSPORTATION**

MAINTENANCE OF TRAFFIC - STAGE 2 US ROUTE 6 OVER LITTLE CALUMET RIVER		
SCALE: 1"=50'	SHEET NO. 1 OF 2 SHEETS	STA. 190+00 TO STA. 201+74

F.A.P. RTE.	SECTION	COUNTY	TOTAL SHEETS	SHEET NO.
351	539W-1-RS	COOK	56	19
CONTRACT NO. 60K57				
ILLINOIS FED. AID PROJECT				