

ROUTE	SECTION	COUNTY	TOTAL SHEETS	SHEET NUMBER
VARIOUS	2010-069-1	VARIOUS	34	20

Contract 60L54

R 14 E

T 38 N

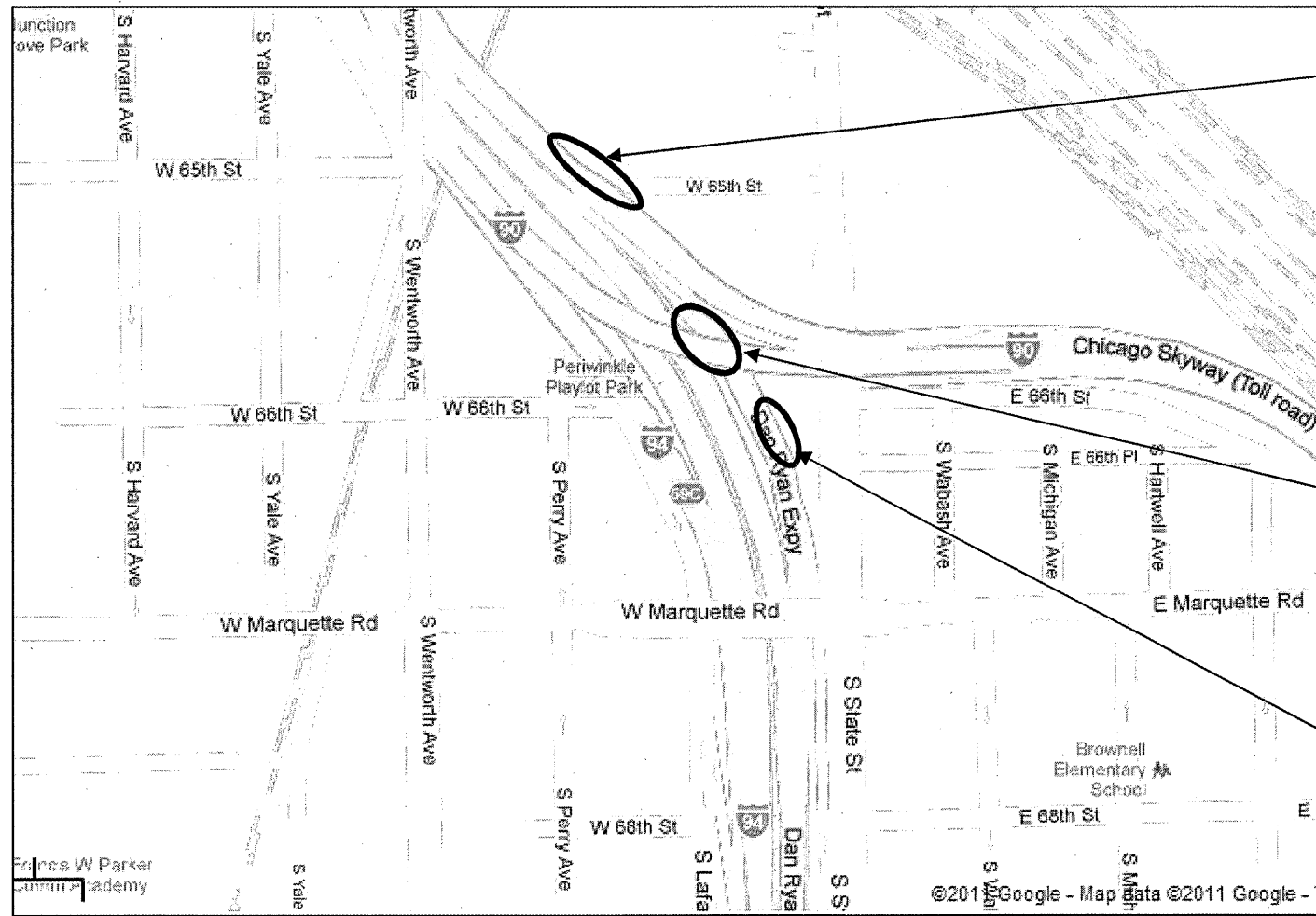

LOCATION 10 & 11
 I-94 (DAN RYAN) BARRIER WALL NB (INBOUND) IN THE LOCAL LANES, RIGHT SIDE @ 65th ST AND LOC 4 IS 220 FT FROM LOCATION 3 @ 66th ST -14' FULL DEPTH REPAIR. LOC. 5 IS 30 FT BEYOND LOC. 4 - 12'-7" FULL DEPTH REPAIR.

LOCATION 12:
 I-94 (DAN RYAN) BARRIER WALL NB (INBOUND) IN THE LOCAL LANES, LEFT SIDE. RIGHT UNDER THE OUTBOUND SKYWAY EXPRESS FLYOVER RAMP @ 66th ST - 10 FT. FULL DEPTH REPAIR.

LOCATION 9:
 I-94 (DAN RYAN) BARRIER WALL NB(INBOUND) IN THE LOCAL LANES, RIGHT SIDE @ 66th ST, NORTH OF 67th ST. EXIT RAMP. FULL DEPTH REPAIR. TWO PLACES WITHIN 1/10th OF A MILE APART: 14 FT AND 17.5 FT

CITY OF CHICAGO
 LAKE TOWNSHIP
 COOK COUNTY

FOR DETAILS SEE SHTS # 21 thru 23

TRAFFIC DATA

I-90/94 SPEED LIMIT = 55 MPH
 2008 ADT = 231700

ILLINOIS DEPARTMENT OF TRANSPORTATION
 MAP FOR LOCATIONS # 9; 10;
 11,12,
 I-94 AT 65th and 66th STREETS