

J:\2009\246 IDOT PTB 153 Hem 2\Cadd\Design\045-0008\045-0008.dgn 8:30:34 AM 3/25/2011

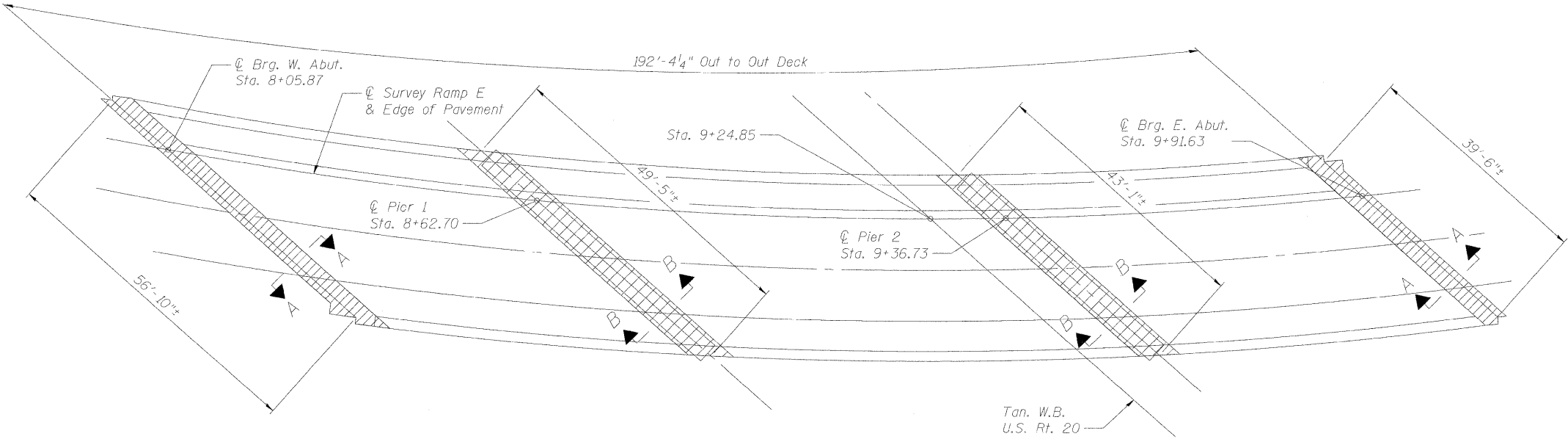

PLAN

**NOTES**

Removal of the existing expansion joints will not be paid for separately but shall be included in the cost for Concrete Removal.

Hatched areas indicate concrete sections to be removed. Care shall be exercised by the contractor during and following concrete removal to ensure the existing reinforcement remaining in place is not damaged. All existing reinforcing to be incorporated into new construction shall be blast-cleaned, straightened and properly positioned prior to concrete placement. Any reinforcement damaged during concrete removal shall be repaired or replaced using an approved Mechanical Bar Splicer System. Cost of removal shall be included with pay item for Concrete Removal. Cost of replacement shall be included with pay item for Concrete Superstructure.

Parapets shall be removed and replaced within the limits of hatched areas shown. All longitudinal parapet reinforcement shall remain in place.

The Contractor shall use extreme care during concrete removal so as not to damage the Steel Wide Flange Beams.

**LEGEND**

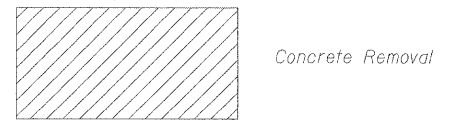

**BILL OF MATERIAL**

Item	Unit	Total
Concrete Removal	Cu. Yd.	32.0

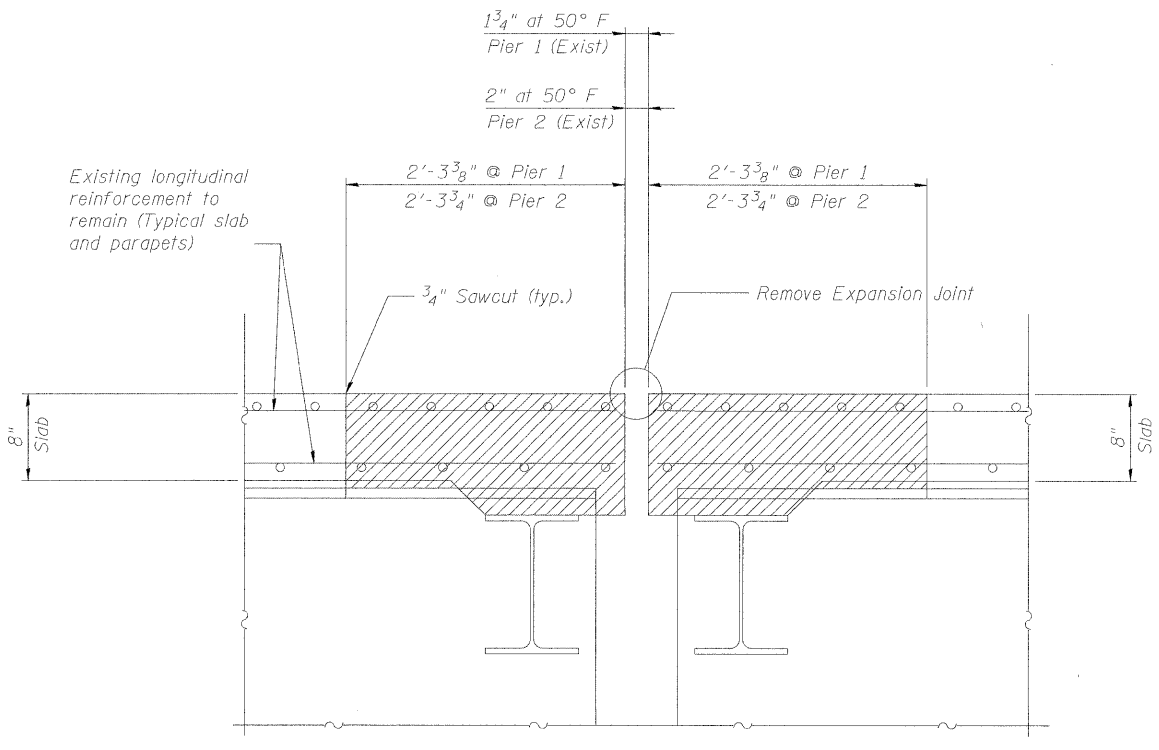

SECTION B-B

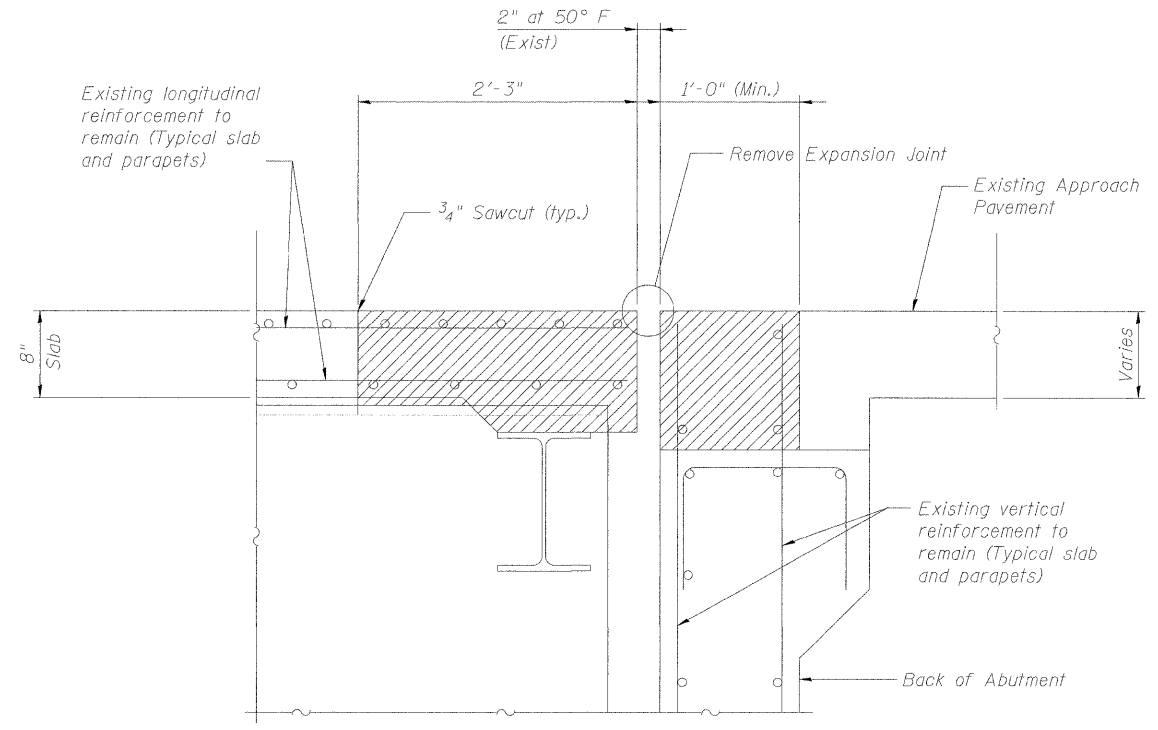

SECTION A-A

**ABNA**  
 DESIGN FIRM REG. 184.002117  
 9901 S. Western Ave.  
 Chicago, IL 60643  
 Ph. 773-881-4788  
 F: 773.239.3728

DESIGNED - TBS	REVISED -
CHECKED - RJL	REVISED -
DRAWN - JJE	REVISED -
CHECKED - TBS	REVISED -

**STATE OF ILLINOIS  
 DEPARTMENT OF TRANSPORTATION**

**EXPANSION JOINT REMOVAL**

SHEET NO. 4 OF 8 SHEETS

F.A.U. RTE.	SECTION	COUNTY	TOTAL SHEETS	SHEET NO.
426	BR-HR-1182)	KANE	124	104
STA. TO STA.	CONTRACT NO.		60M46	
FED. ROAD DIST. NO.	ILLINOIS FED. AID PROJECT			