

INDEX OF SHEETS

SHEET NO.	DESCRIPTION
1	COVER SHEET
2	INDEX, GENERAL NOTES AND HIGHWAY STANDARDS
3	SUMMARY OF QUANTITIES
4	SCHEDULE OF QUANTITIES
5	TYPICAL SECTIONS
6-10	ROADWAY AND PAVEMENT MARKING PLANS
11-12	RUMBLE STRIPE DETAILS
13	DETAILS FOR DEPRESSED CURB AND GUTTER AND SHOULDER TREATMENT AT T&T TY 1 SPL (BD34)
14	TRAFFIC CONTROL AND PROTECTION FOR SIDEROADS, INTERSECTIONS AND DRIVEWAYS (TC10)
15	RAISED REFLECTIVE PAVEMENT MARKERS (SNOW PLOW RESISTANT) (TC11)
16	DISTRICT ONE TYPICAL PAVEMENT MARKINGS (TC13)
17	TEMPORARY INFORMATION SIGNING (TC22)

HIGHWAY STANDARDS

STD. NO.	TITLE
000001-06	STANDARD SYMBOLS, ABBREVIATIONS AND PATTERNS
280001-05	TEMPORARY EROSION CONTROL SYSTEMS
482006-03	HMA SHOULDER ADJACENT TO RIGID PAVEMENT
630001-09	STEEL PLATE BEAM GUARDRAIL
630301-05	SHOULDER WIDENING FOR TYPE 1 (SPECIAL) GUARDRAIL TERMINALS
631011-07	TRAFFIC BARRIER TERMINAL, TYPE 2
635006-03	REFLECTOR AND TERMINAL MARKER PLACEMENT
635011-02	REFLECTOR MARKER AND MOUNTING DETAILS
642001-01	SHOULDER RUMBLE STRIPS
701101-02	OFF-ROAD OPERATIONS, MULTILANE, 15' (4.5 m) TO 24" (600 mm) FROM PAVEMENT EDGE
701606-07	URBAN LANE CLOSURE, MULTILANE, 2W WITH MOUNTABLE MEDIAN
701901-01	TRAFFIC CONTROL DEVICES
720001-01	SIGN PANEL MOUNTING DETAILS
720006-06	SIGN PANEL ERECTION DETAILS
728001-01	TELESCOPING STEEL SIGN SUPPORT
780001-02	TYPICAL PAVEMENT MARKINGS

GENERAL NOTES

- BEFORE STARTING ANY EXCAVATION, THE CONTRACTOR SHALL CALL "J.U.L.I.E." AT 800-892-0123 FOR FIELD LOCATIONS OF BURIED ELECTRIC, TELEPHONE AND GAS FACILITIES. (48 HOUR NOTIFICATION IS REQUIRED).
- THE CONTRACTOR SHALL COORDINATE CONSTRUCTION ACTIVITIES WITH UTILITY COMPANIES.
- THE CONTRACTOR WILL NOT BE ALLOWED TO SET UP A YARD OR FIELD OFFICE ON STATE PROPERTY WITHOUT WRITTEN PERMISSION FROM THE DEPARTMENT.
- WHEN ARTIFICIAL LIGHTING IS USED IN NIGHT OPERATIONS THE CONTRACTOR SHALL EXERCISE THE UTMOST PRECAUTIONS IN PREVENTING ADVERSE VISIBILITY TO THE MOTORING PUBLIC AND ADJOINING RESIDENTIAL AREAS.
- WHEN MILLED PAVEMENT IS OPEN TO TRAFFIC THE MAXIMUM GRADE DIFFERENTIAL BETWEEN PASSES OF THE MILLING MACHINE SHALL NOT EXCEED 1 1/2 INCHES (40 MM) WHERE THE SPEED LIMIT IS 45 MPH (80 KM/H) OR LESS AND 1 INCH (25 MM) WHERE THE SPEED LIMIT IS GREATER THAN 45 MPH (80 KM/H). WITH WRITTEN APPROVAL FROM THE ENGINEER, A MAXIMUM GRADE DIFFERENTIAL OF 3 INCHES (75 MM) MAY BE ALLOWED IF THE EDGE OF THE MILLING IS SLOPED A MINIMUM 1:3 (V:H).
- THE CONTRACTOR SHALL CONTACT THE TRAFFIC CONTROL SUPERVISOR AT (847) 705-4470 A MINIMUM 72 HOURS IN ADVANCE OF BEGINNING WORK.
- THE RESIDENT ENGINEER SHALL CONTACT PATRICE HARRIS, AREA TRAFFIC FIELD TECHNICIAN, AT 708-597-9800 AT LEAST (2) WEEKS PRIOR TO PLACING PERMANENT PAVEMENT MARKINGS.
- THE CONTRACTOR SHALL BE REQUIRED TO PROVIDE ACCESS TO ABUTTING PROPERTY AT ALL TIMES DURING THE CONSTRUCTION OF THIS PROJECT.
- WHEN GUARDRAIL POSTS ARE PLACED BEHIND CONCRETE HEADWALLS, THE POSTS SHALL NOT BE PLACED TO BLOCK THE DRAINAGE OPENING.

FILE NAME =	USER NAME = _USER_	DESIGNED - EF	REVISED -	STATE OF ILLINOIS DEPARTMENT OF TRANSPORTATION	IL 19 - EAST OF DES PLAINES RIVER RD TO IL 171 INDEX OF SHEETS, HIGHWAY STANDARDS, AND GENERAL NOTES			F.A.P. RTE.	SECTION	COUNTY	TOTAL SHEETS	SHEET NO.			
FILEL		DRAWN - EF	REVISED -		SCALE: NTS	SHEET NO. 1	OF 1	SHEETS	STA.	TO STA.	345	2010-118-1	COOK	17	2
		PLOT SCALE = 50.0000' / IN.	CHECKED - RS		REVISED -	CONTRACT NO. 60M55									
		PLOT DATE = 4/11/2011	DATE - 04-12-2011		REVISED -	ILLINOIS FED. AID PROJECT									

SUMMARY OF QUANTITIES

90% FED.
10% STATE
URBAN

PAY ITEM NUMBER	DESCRIPTION	UNIT	TOTAL QUANTITY	0021 SAFETY
20200600	EXCAVATING AND GRADING EXISTING SHOULDER	UNIT	5	5
21101615	TOPSOIL FURNISH AND PLACE, 4"	SQ YD	217	217
25000210	SEEDING, CLASS 2A	ACRE	0.04	0.04
25000400	NITROGEN FERTILIZER NUTRIENT	POUND	4	4
25000500	PHOSPHORUS FERTILIZER NUTRIENT	POUND	4	4
25000600	POTASSIUM FERTILIZER NUTRIENT	POUND	4	4
25100630	EROSION CONTROL BLANKET	SQ YD	217	217
40600895	CONSTRUCTING TEST STRIP	EACH	1	1
48101620	AGGREGATE SHOULDERS, TYPE B 10"	SQ YD	464	464
48102100	AGGREGATE WEDGE SHOULDER, TYPE B	TON	94	94
48203029	HOT-MIX ASPHALT SHOULDERS, 8"	SQ YD	2,413	2,413
63000001	STEEL PLATE BEAM GUARDRAIL, TYPE A, 6 FOOT POSTS	FOOT	163	163
63100045	TRAFFIC BARRIER TERMINAL, TYPE 2	EACH	2	2
63100167	TRAFFIC BARRIER TERMINAL, TYPE 1 (SPECIAL) TANGENT	EACH	6	6
63200310	GUARDRAIL REMOVAL	FOOT	130	130
64200105	SHOULDER RUMBLE STRIPS	FOOT	5,050	5,050
67000400	ENGINEER'S FIELD OFFICE, TYPE A	CAL MO	6	6
67100100	MOBILIZATION	L SUM	1	1
70102625	TRAFFIC CONTROL AND PROTECTION, STANDARD 701606	L SUM	1	1
70300520	PAVEMENT MARKING TAPE, TYPE III 4"	FOOT	6,224	6,224
70301000	WORK ZONE PAVEMENT MARKING REMOVAL	SQ FT	2,075	2,075
* 72000100	SIGN PANEL - TYPE 1	SQ FT	101	101
* 72400310	REMOVE SIGN PANEL - TYPE 1	SQ FT	18	18
* 72400100	REMOVE SIGN PANEL ASSEMBLY - TYPE A	EACH	13	13
* 72800100	TELESCOPING STEEL SIGN SUPPORT	FOOT	165	165
* 78000200	THERMOPLASTIC PAVEMENT MARKING - LINE 4"	FOOT	12,200	12,200
78100100	RAISED REFLECTIVE PAVEMENT MARKER	EACH	155	155
78200420	GUARDRAIL MARKERS, TYPE B	EACH	5	5
78201000	TERMINAL MARKER-DIRECT APPLIED	EACH	6	6
78300100	PAVEMENT MARKING REMOVAL	SQ FT	3,745	3,745
78300200	RAISED REFLECTIVE PAVEMENT MARKER REMOVAL	EACH	155	155
X2020110	GRADING AND SHAPING SHOULDERS	UNIT	50	50
Δ X2503100	MOWING	UNIT	20	20
Z0030850	TEMPORARY INFORMATION SIGNING	SQ FT	51	51
X0325866	CENTER LINE - RUMBLE STRIP	FOOT	3,594	3,594

* DENOTES SPECIALTY ITEM
Δ NON-PARTICIPATING

FILE NAME =	USER NAME = _USER_	DESIGNED - EF	REVISED -	STATE OF ILLINOIS DEPARTMENT OF TRANSPORTATION	IL 19 - EAST OF DES PLAINES RIVER RD TO IL 171 SUMMARY OF QUANTITIES	F.A.P. RTE.	SECTION	COUNTY	TOTAL SHEETS	SHEET NO.	
FILEL		DRAWN - EF	REVISED -			345	2010-118-1	COOK	17	3	
	PLOT SCALE = 50.0000' / IN.	CHECKED - RS	REVISED -			CONTRACT NO. 60M55					
	PLOT DATE = 4/11/2011	DATE - 04-12-2011	REVISED -			SCALE: NTS	SHEET NO. 1 OF 1 SHEETS	STA.	TO STA.	ILLINOIS FED. AID PROJECT	

SCHEDULE OF QUANTITIES- SIGNS

STATION	OFFSET		REMOVE SIGN PANEL - TYPE 1 (SQ.FT.)	SIGN PANEL ASSEMBLY REMOVAL (EACH)	Sign	SIGN ID #	SIZE (inches)	SIGN PANEL TYPE 1 (SQ.FT.)	TELESCOPING STEEL SIGN SUPPORT (FT.)
105+42	38.9	LT	3	0	Black and Yellow Striped Object Marker	OM-3L	12x36	3	0
105+80	27.7	RT	0	1	Black and Yellow Striped Object Marker	OM-3R	12x36	3	13
104+25	38.8	RT	0	1	Equestrain	W11-7	36x36	9	15.25
103+15	39.5	RT	0	1	SPEED LIMIT 40	R2-1	30x36	7.5	13
108+45	26.1	RT	0	1	Black and Yellow Striped Object Marker	OM-3L	12x36	3	13
108+63	27.3	RT	0	1	Equestrain	W11-7	36x36	9	15.25
108+09	36.2	LT	0	1	Black and Yellow Striped Object Marker	OM-3R	12x36	3	13
108+71	32.6	LT	0	1	Equestrain	W11-7	36x36	9	15.25
110+93	32.9	RT	0	1	SPEED LIMIT 45	R2-1	30x36	7.5	13
110+91	35.1	LT	0	1	SPEED LIMIT 40	R2-1	30x36	7.5	13
114+81	35.6	LT	0	1	Equestrain	W11-7	36x36	9	15.25
117+99	30.3	RT	0	1	Black and Yellow Striped Object Marker	OM-3L	12x36	0	0
127+92	29.7	LT	0	1	SPEED LIMIT 45	R2-1	30x36	7.5	13
131+23	34.7	RT	0	1	SPEED LIMIT 45	R2-1	30x36	7.5	13
151+44	35.1	RT	7.5	0	SPEED LIMIT 35	R2-1	30x36	7.5	0
152+08	33.9	LT	7.5	0	SPEED LIMIT 45	R2-1	30x36	7.5	0
		TOTALS	18	13				101	165

SCHEDULE OF QUANTITIES - ROADWAY

From	To	Side	Measured Length	Total SY	X2020110 GRADING AND SHAPING SHOULDERS	48102100 AGGREGATE WEDGE SHOULDER, TYPE B	48203029 HOT-MIX ASPHALT SHOULDERS, 8"	64200105 SHOULDER RUMBLE STRIP	X0325866 CENTERLINE RUMBLE STRIPS	78000200 THERMOPLASTIC PAVEMENT MARKING - LINE 4" YELLOW C/L	78000200 THERMOPLASTIC PAVEMENT MARKING - LINE 4" WHITE EDGE	78300100 PAVEMENT MARKING REMOVAL	78100100 RAISED REFLECTIVE PAVEMENT MARKER
106+00	112+00	LT	0	0.0	0	0	0	0	295	396	0	132	10
		RT	4	1.9	0	0	2	4			4	1	
112+00	118+00	LT	211	103.5	2	4	104	211	600	1,054	211	422	26
		RT	600	288.7	6	11	289	600			600	200	
118+00	124+00	LT	600	288.7	6	11	289	600	600	1,200	600	600	30
		RT	600	288.7	6	11	289	600			600	200	
124+00	130+00	LT	528	254.0	5	10	254	528	600	1,044	528	524	26
		RT	586	281.9	6	11	282	586			586	195	
130+00	136+00	LT	600	288.7	6	11	289	600	600	1,000	600	533	25
		RT	262	126.1	3	5	126	262			262	87	
136+00	142+00	LT	454	218.4	5	8	218	454	600	1,044	454	499	26
		RT	535	257.4	5	10	257	535			535	178	
142+00	148+00	LT	0	0.0	0	0	0	0	299	486	0	162	12
		RT	31	14.9	0	1	15	31			31	10	
148+00	152+08	LT	0	0.0	0	0	0	0		0	0	0	0
		RT	0	0.0	0	0	0	0		0	0	0	0
		TOTAL	5,011	2,413	50	94	2,413	5,011	3,594	6,224	5,011	3,745	155

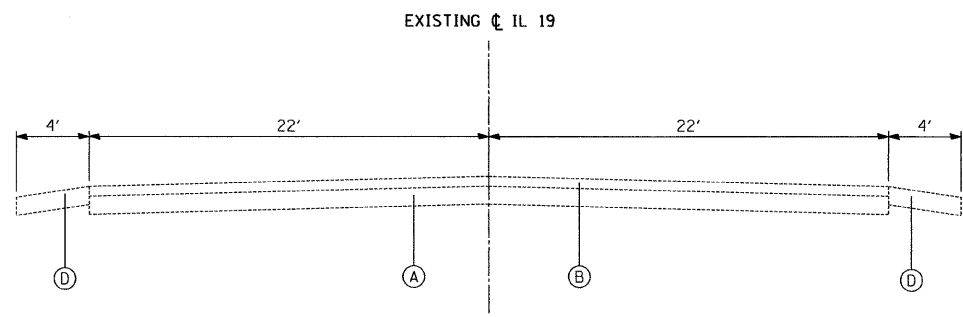

EXISTING TYPICAL SECTION
 RIGHT
 STA. 111+96 TO STA. 142+31
 LEFT
 STA. 115+89 TO STA. 141+43

EXISTING CONDITIONS:

- (A) PCC BASE COURSE, 8"±
- (B) HOT-MIX ASPHALT SURFACE COURSE, 3"±
- (C) COMBINATION CONCRETE CURB AND GUTTER, TYPE B-6.12
- (D) AGGREGATE SHOULDER

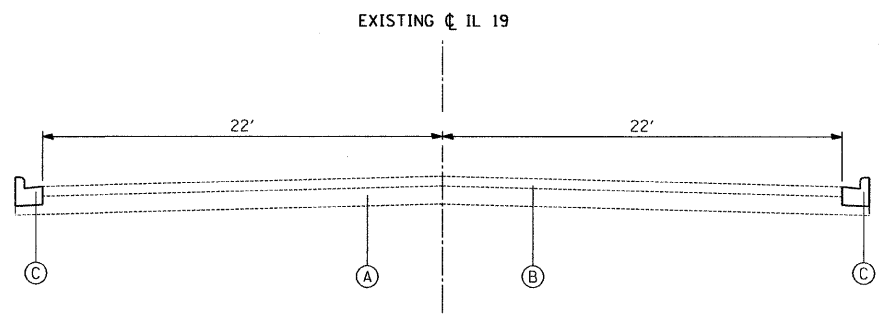

EXISTING TYPICAL SECTION
 RIGHT
 STA. 109+05 TO STA. 111+96
 STA. 142+91 TO STA. 144+95
 LEFT
 STA. 109+05 TO STA. 114+95
 STA. 141+43 TO STA. 144+95

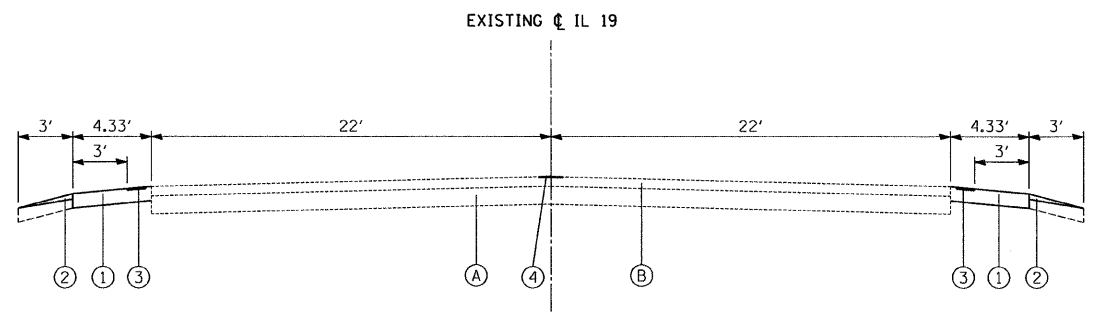

PROPOSED TYPICAL SECTION
 RIGHT
 STA. 111+96 TO STA. 142+31
 LEFT
 STA. 115+89 TO STA. 141+43

PROPOSED IMPROVEMENTS:

- (1) HOT-MIX ASPHALT SHOULDERS, 8"
- (2) AGGREGATE WEDGE SHOULDER, TYPE B
- (3) SHOULDER RUMBLE STRIPES - SEE SHEET 11 FOR DETAILS
- (4) CENTER LINE RUMBLE STRIPES - SEE SHEET 12 FOR DETAILS

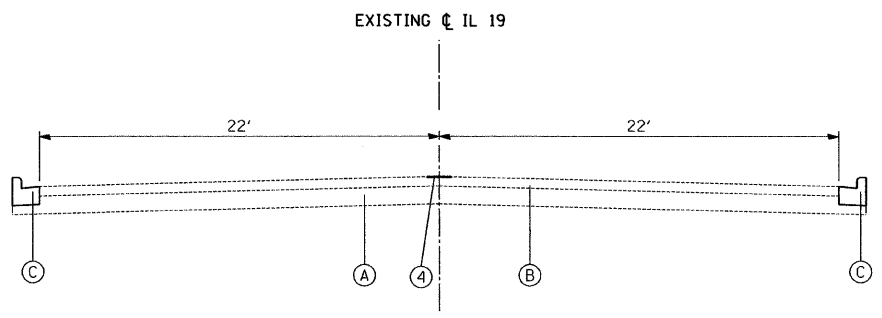

PROPOSED TYPICAL SECTION
 RIGHT
 STA. 109+05 TO STA. 111+96
 STA. 142+91 TO STA. 144+95
 LEFT
 STA. 109+05 TO STA. 114+95
 STA. 141+43 TO STA. 144+95

HOT-MIX ASPHALT MIXTURE REQUIREMENTS	
MIXTURE TYPE	AIR VOIDS @ Ndes
HOT-MIX ASPHALT SHOULDERS	
HOT-MIX ASPHALT SURFACE COURSE, MIX "D", N70 (IL 9.5mm) (2")	4% @ 70 GYR
HMA BINDER COURSE, IL-19mm, N70 (IN 2 LIFTS) (6")	4% @ 70 GYR

THE UNIT WEIGHT USED TO CALCULATE ALL HOT-MIX ASPHALT SURFACE MIXTURE A IS 112 LBS/SQ YD/IN.
 THE "AC TYPE" FOR POLYMERIZED HMA MIXES SHALL BE "SBS/SBR PG 70-22" AND FOR NON-POLYMERIZED HMA THE "AC TYPE" SHALE BE "PG 64-22" UNLESS MODIFIED BY DISTRICT ONE SPECIAL PROVISIONS.
 FOR "PERCENT OF RAP" SEE DISTRICT ONE SPECIAL PROVISIONS.

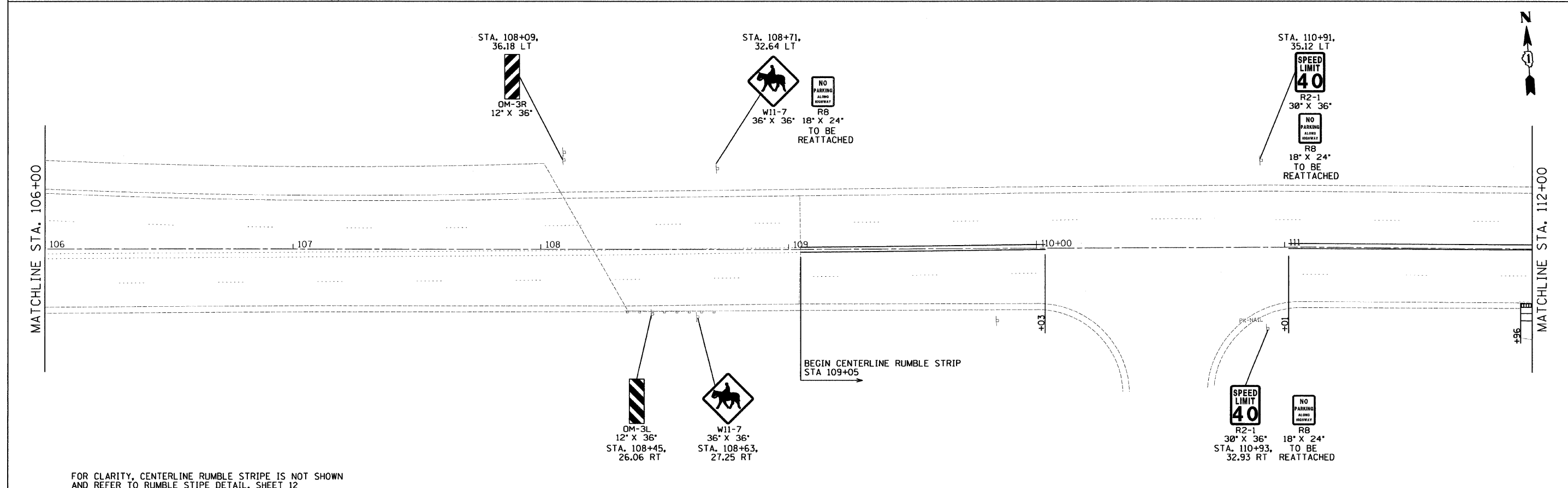
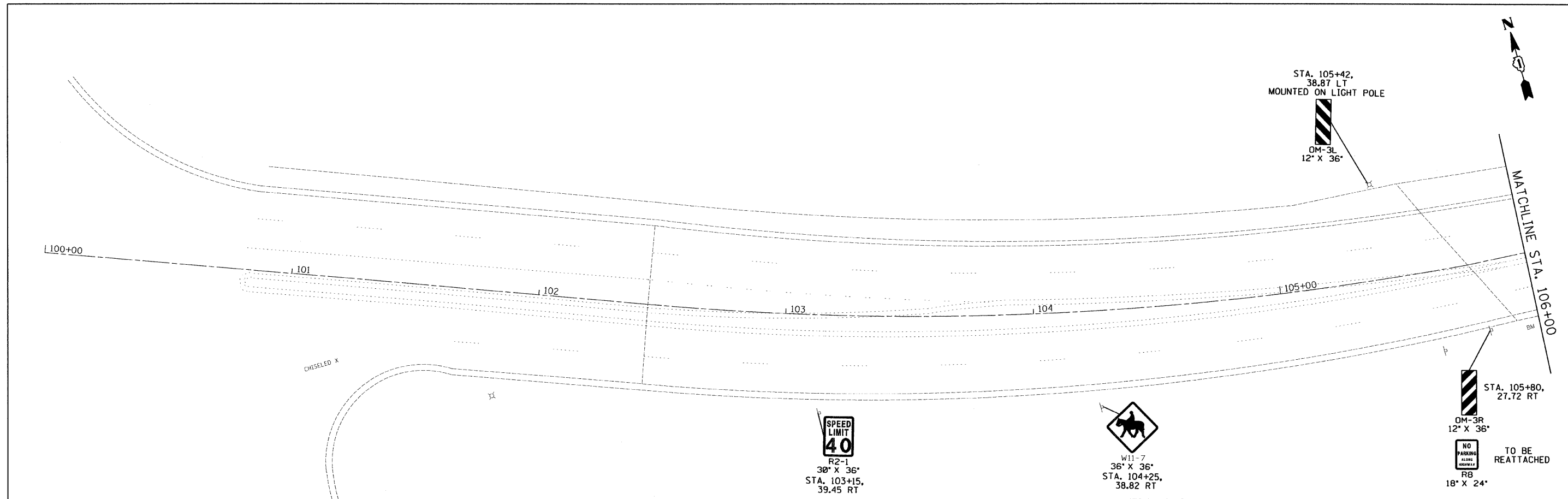

FOR CLARITY, CENTERLINE RUMBLE STRIPE IS NOT SHOWN
AND REFER TO RUMBLE STRIPE DETAIL, SHEET 12

FILE NAME =	USER NAME = USER	DESIGNED - EF	REVISED -	STATE OF ILLINOIS DEPARTMENT OF TRANSPORTATION	IL 19 - EAST OF DES PLAINES RIVER RD TO IL 171 ROADWAY PLANS	F.A.P. RTE.	SECTION	COUNTY	TOTAL SHEETS	SHEET NO.	
#FILE#	PLOT SCALE = 20,000' / IN.	DRAWN - EF	REVISED -			345	2010-118-1	COOK	17	6	
	PLOT DATE = 4/11/2011	CHECKED - RS	REVISED -			CONTRACT NO. 60M55					
		DATE - 04-12-2011	REVISED -			ILLINOIS FED. AID PROJECT					
					SCALE: 20	SHEET NO. 1 OF 5 SHEETS		STA. 100+00 TO STA. 112+00			

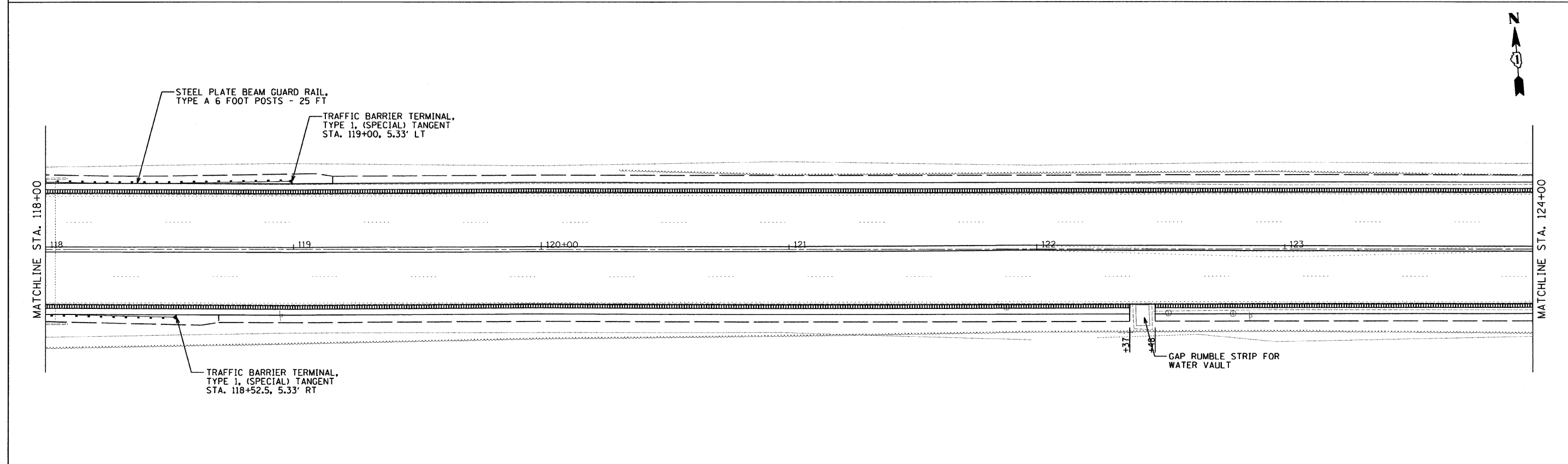
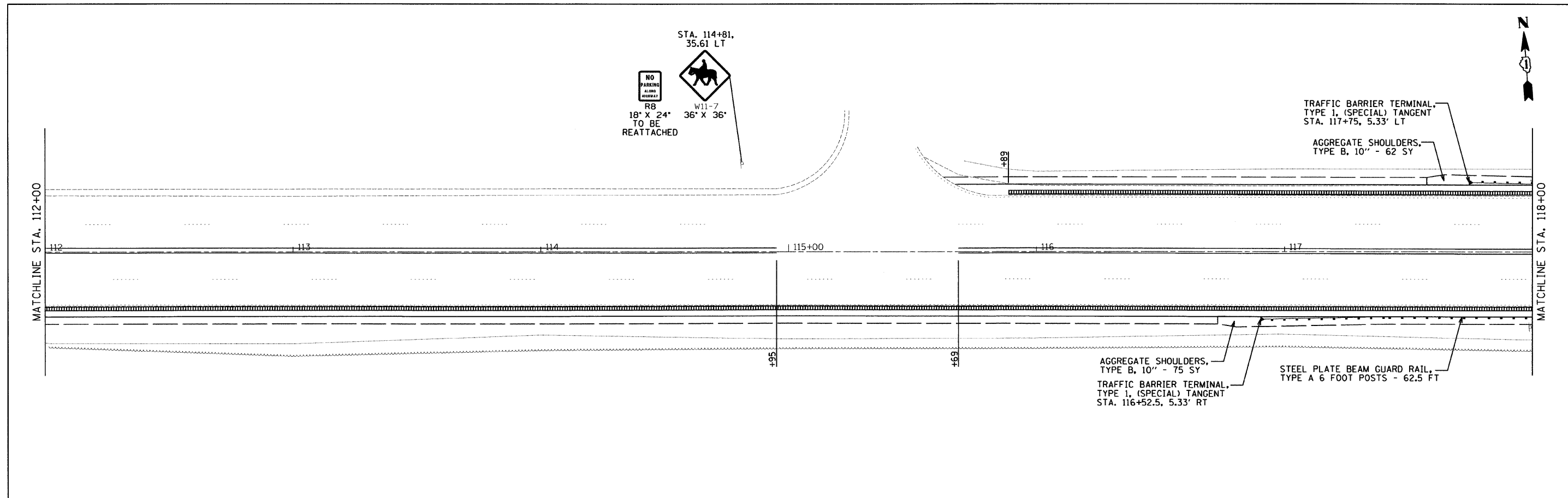

FOR CLARITY, CENTERLINE RUMBLE STRIPE IS NOT SHOWN
AND REFER TO RUMBLE STRIPE DETAIL, SHEET 12

FILE NAME =	USER NAME = .USER.	DESIGNED - EF	REVISED -	STATE OF ILLINOIS DEPARTMENT OF TRANSPORTATION	IL 19 - EAST OF DES PLAINES RIVER RD TO IL 171 ROADWAY PLANS			F.A.P. RTE.	SECTION	COUNTY	TOTAL SHEETS	SHEET NO.
*FILEL#	PLOT SCALE = 20.0000' / IN.	DRAWN - EF	REVISED -					345	2010-118-1	COOK	17	7
	PLOT DATE = 4/11/2011	CHECKED - RS	REVISED -		SCALE: 20 SHEET NO. 2 OF 5 SHEETS STA. 112+00 TO STA. 124+00			CONTRACT NO. 60M55		ILLINOIS FED. AID PROJECT		
		DATE - 04-12-2011	REVISED -									

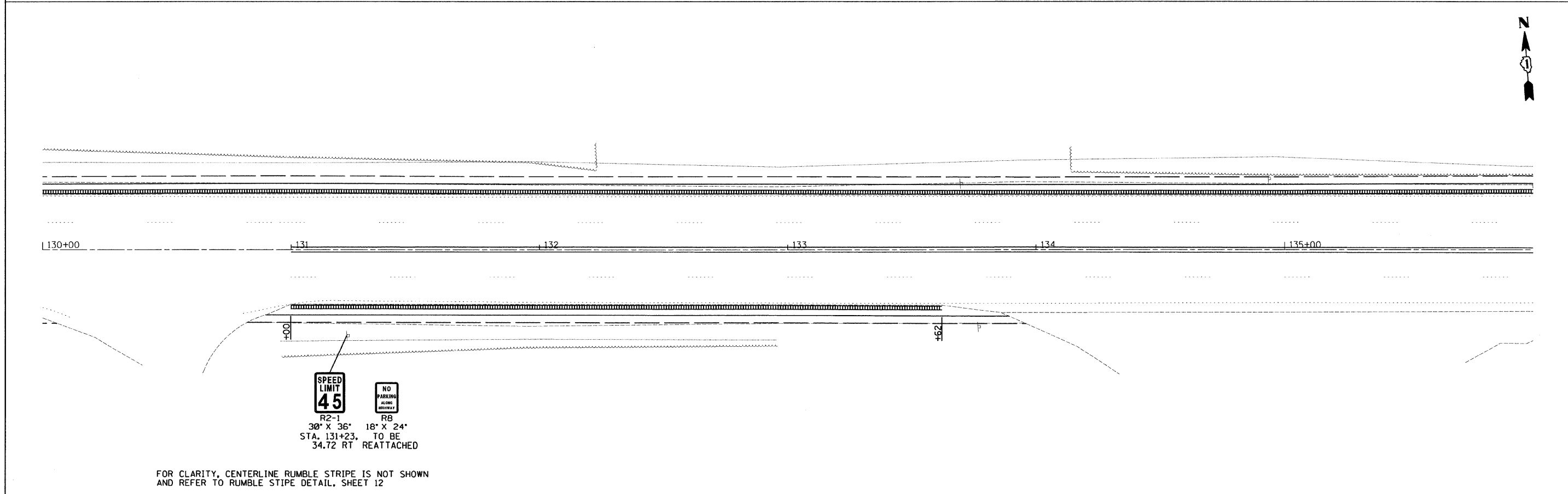
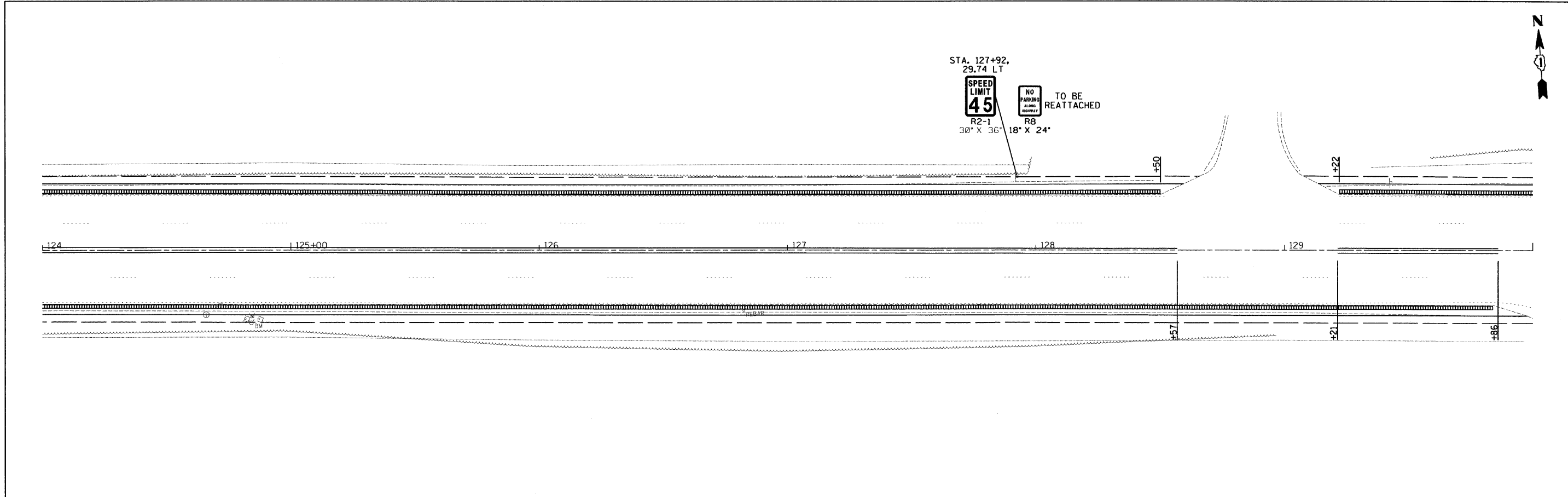

FILE NAME = *FILEL*	USER NAME = .USER.	DESIGNED - EF	REVISED -	STATE OF ILLINOIS DEPARTMENT OF TRANSPORTATION	IL 19 - EAST OF DES PLAINES RIVER RD TO IL 171 ROADWAY PLANS	F.A.P. RTE. = 345	SECTION = 2010-118-1	COUNTY = COOK	TOTAL SHEETS = 17	SHEET NO. = 8
	PLOT SCALE = 20.0000' / IN.	CHECKED - RS	REVISED -			SCALE: 20	SHEET NO. 3 OF 5 SHEETS	STA. 124+00 TO STA. 136+00	CONTRACT NO. 60M55	
PLOT DATE = 4/11/2011	DATE = 04-12-2011	REVISED -	REVISED -							

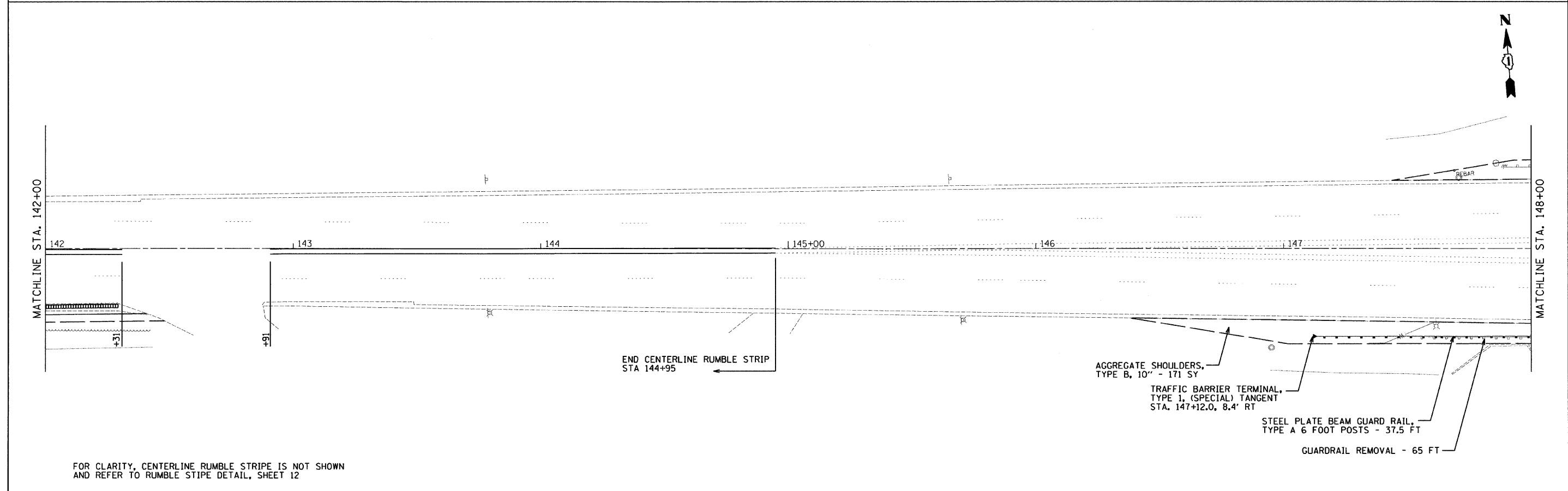
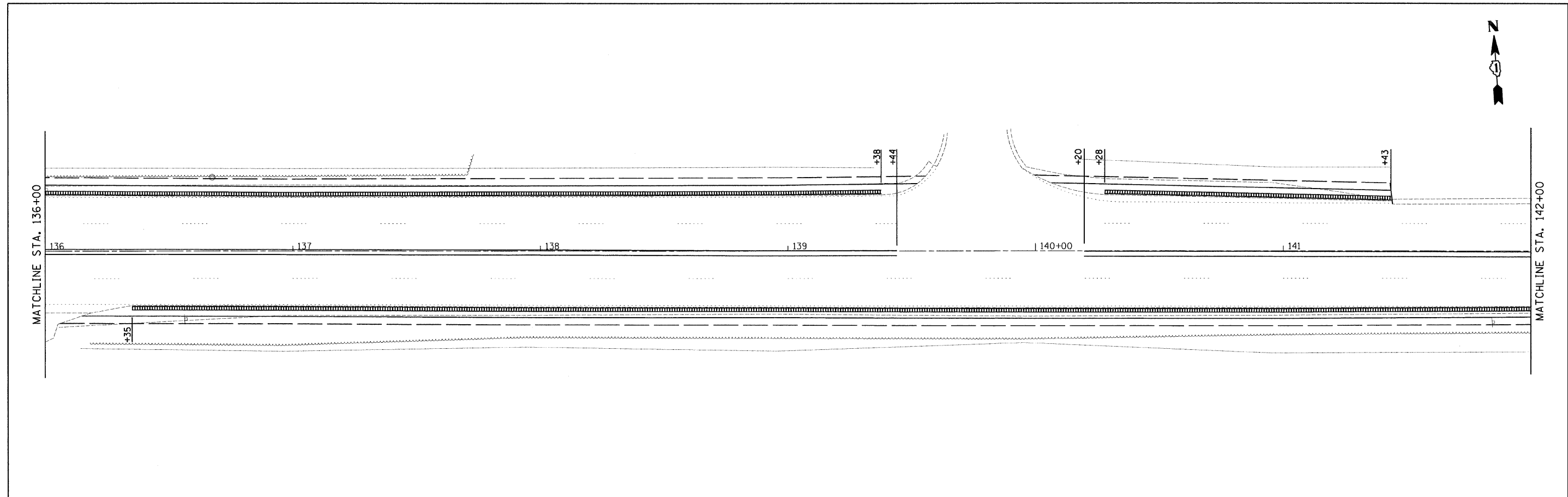

FOR CLARITY, CENTERLINE RUMBLE STRIPE IS NOT SHOWN AND REFER TO RUMBLE STRIPE DETAIL, SHEET 12

FILE NAME = *FILEL*	USER NAME = USER.	DESIGNED - EF	REVISED -	STATE OF ILLINOIS DEPARTMENT OF TRANSPORTATION	IL 19 - EAST OF DES PLAINES RIVER RD TO IL 171 ROADWAY PLANS			F.A.P. RTE.	SECTION	COUNTY	TOTAL SHEETS	SHEET NO.
	PLOT SCALE = 20.0000' / IN.	DRAWN - EF	REVISED -					345	2010-118-1	COOK	17	9
PLOT DATE = 4/11/2011	CHECKED - RS	DATE - 04-12-2011	REVISED -	SCALE: 20	SHEET NO. 4 OF 5 SHEETS	STA. 136+00 TO STA. 148+00	ILLINOIS FED. AID PROJECT					
							CONTRACT NO. 60M55					

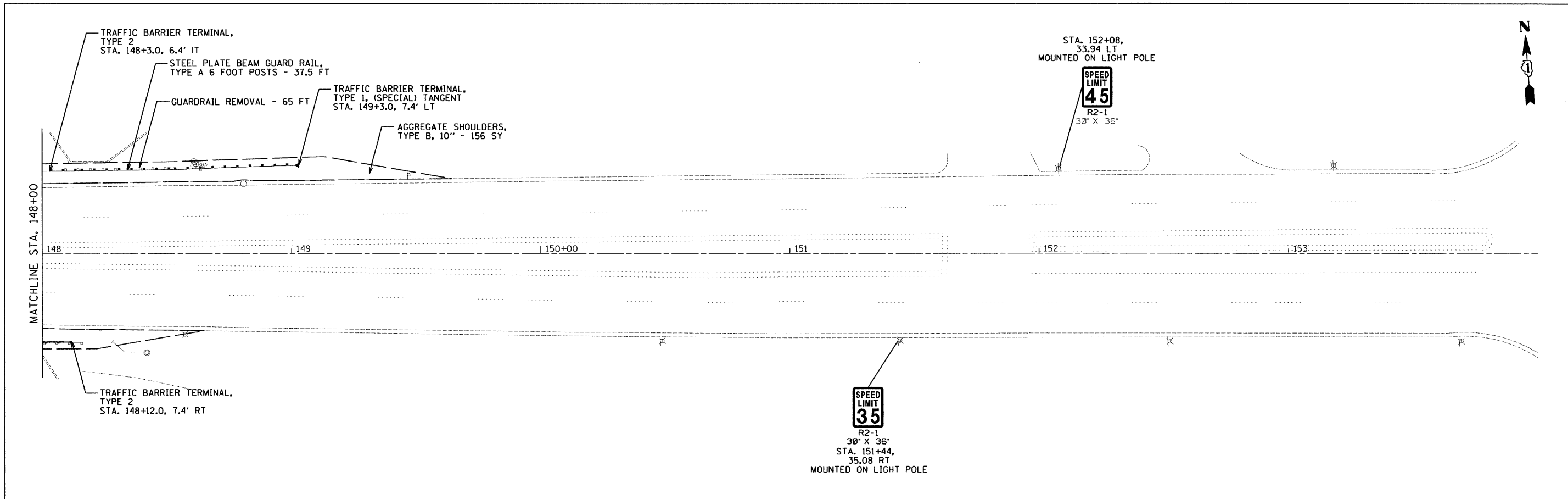

FILE NAME = #FILE1*	USER NAME = .USER.	DESIGNED - EF	REVISED -	STATE OF ILLINOIS DEPARTMENT OF TRANSPORTATION	IL 19 - EAST OF DES PLAINES RIVER RD TO IL 171 ROADWAY PLANS		F.A.P. RTE.	SECTION	COUNTY	TOTAL SHEETS	SHEET NO.
	PLOT SCALE = 20,0000' / IN.	DRAWN - EF	REVISED -				345	2010-118-I	COOK	17	10
PLOT DATE = 4/11/2011	CHECKED - RS	REVISED -	SCALE: 20		SHEET NO. 5 OF 5 SHEETS		STA. 148+00 TO STA. 154+00		CONTRACT NO. 60M55		
	DATE - 04-12-2011	REVISED -	ILLINOIS FED. AID PROJECT								

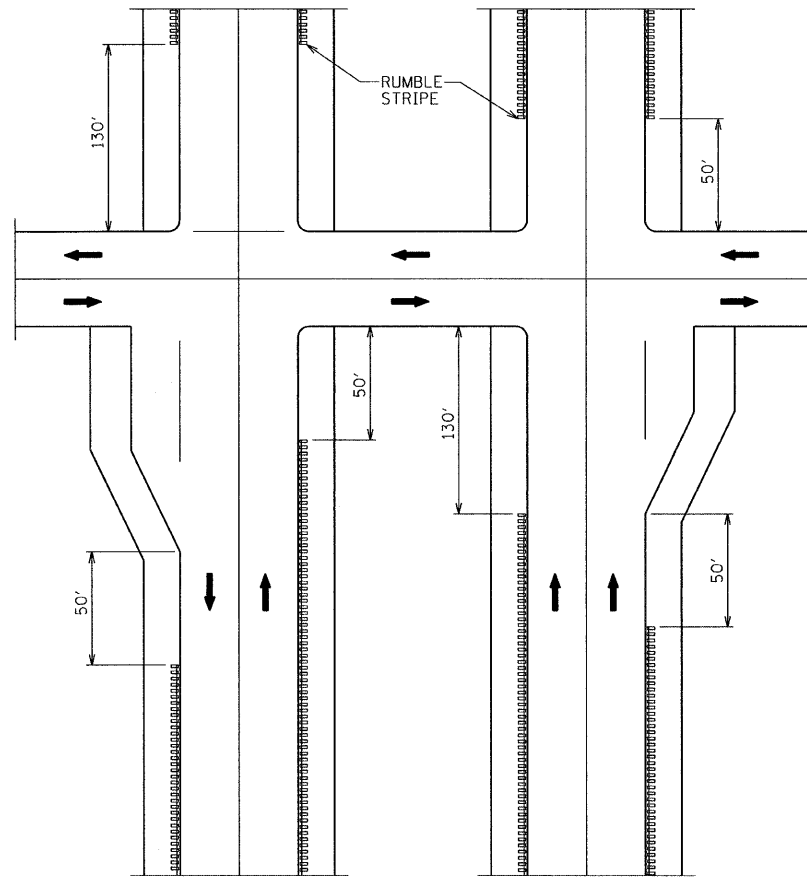

RUMBLE STRIPE EXPRESSWAY DIVIDED

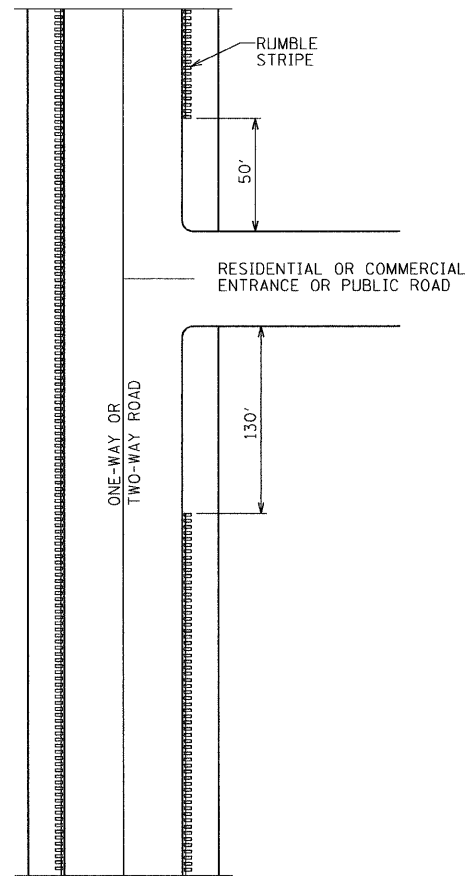

RUMBLE STRIPE INTERSECTION

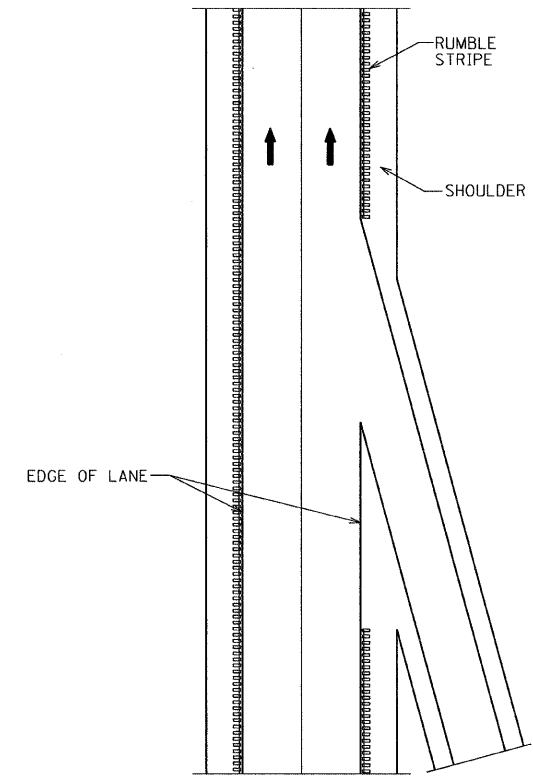

ACCELERATION LANE SHOWN
RUMBLE STRIPE
ACCELERATION OR DECELERATION LANE

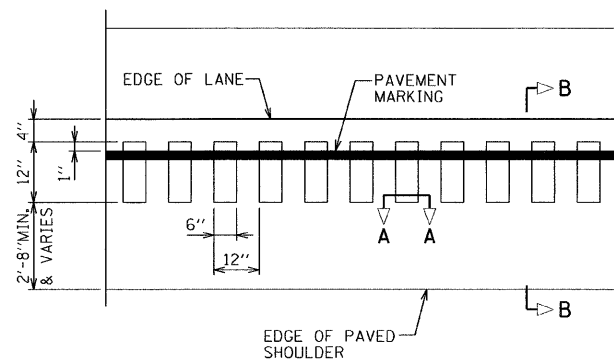

PLAN FOR RUMBLE STRIPE

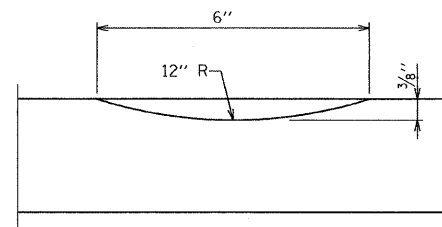

SECTION A-A

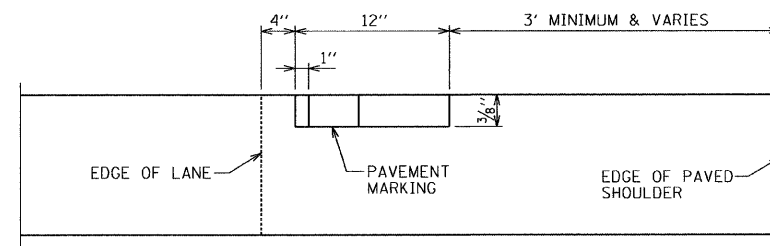

SECTION B-B

GENERAL NOTES:
ON PORTLAND CEMENT CONCRETE SHOULDERS,
NO SHOULDER RUMBLE STRIPE SHALL BE LOCATED
CLOSER THAN 150mm (6") TO A TRANSVERSE JOINT.
OMIT SHOULDER RUMBLE STRIP ACROSS STRUCTURES.

SHOULDER RUMBLE STRIPES TO BE PAID FOR AS
SHOULDER RUMBLE STRIP AND THERMOPLASTIC
PAVEMENT MARKING - LINE 4".

FILE NAME =	USER NAME = USER.	DESIGNED - EF	REVISED -	STATE OF ILLINOIS DEPARTMENT OF TRANSPORTATION	IL 19 - EAST OF DES PLAINES RIVER RD TO IL 171 SHOULDER RUMBLE STRIPE DETAIL	F.A.P. RTE.	SECTION	COUNTY	TOTAL SHEETS	SHEET NO.	
#FILEL*	PLOT SCALE = 40,0000' / IN.	DRAWN - EF	REVISED -			345	2010-118-1	COOK	17	11	
	PLOT DATE = 4/11/2011	CHECKED - RS	REVISED -			CONTRACT NO. 60M55					
		DATE - 04-12-2011	REVISED -			ILLINOIS FED. AID PROJECT					
					SCALE: NTS	SHEET NO. 1 OF 1 SHEETS	STA.	TO STA.			

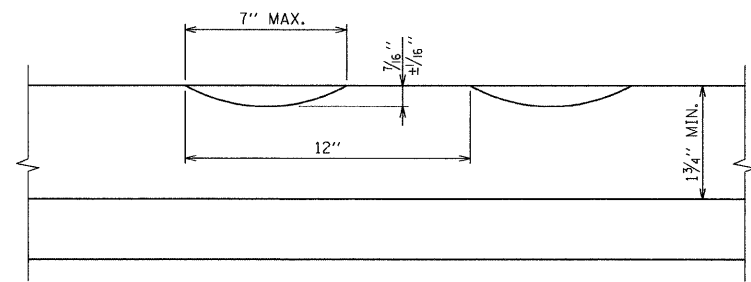

SECTION A-A

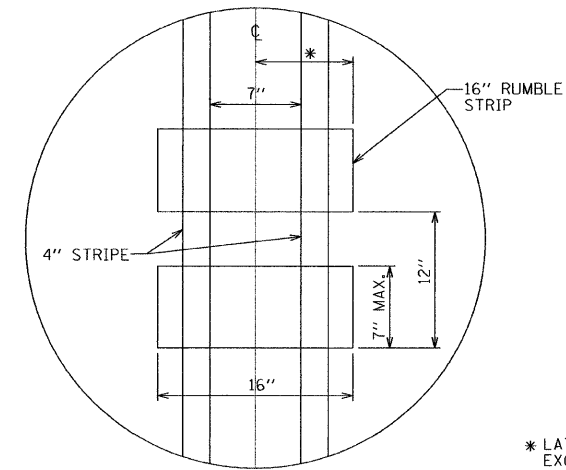

DETAIL B

* LATERAL DEVIATION SHALL NOT EXCEED ONE INCH IN 100 FT.

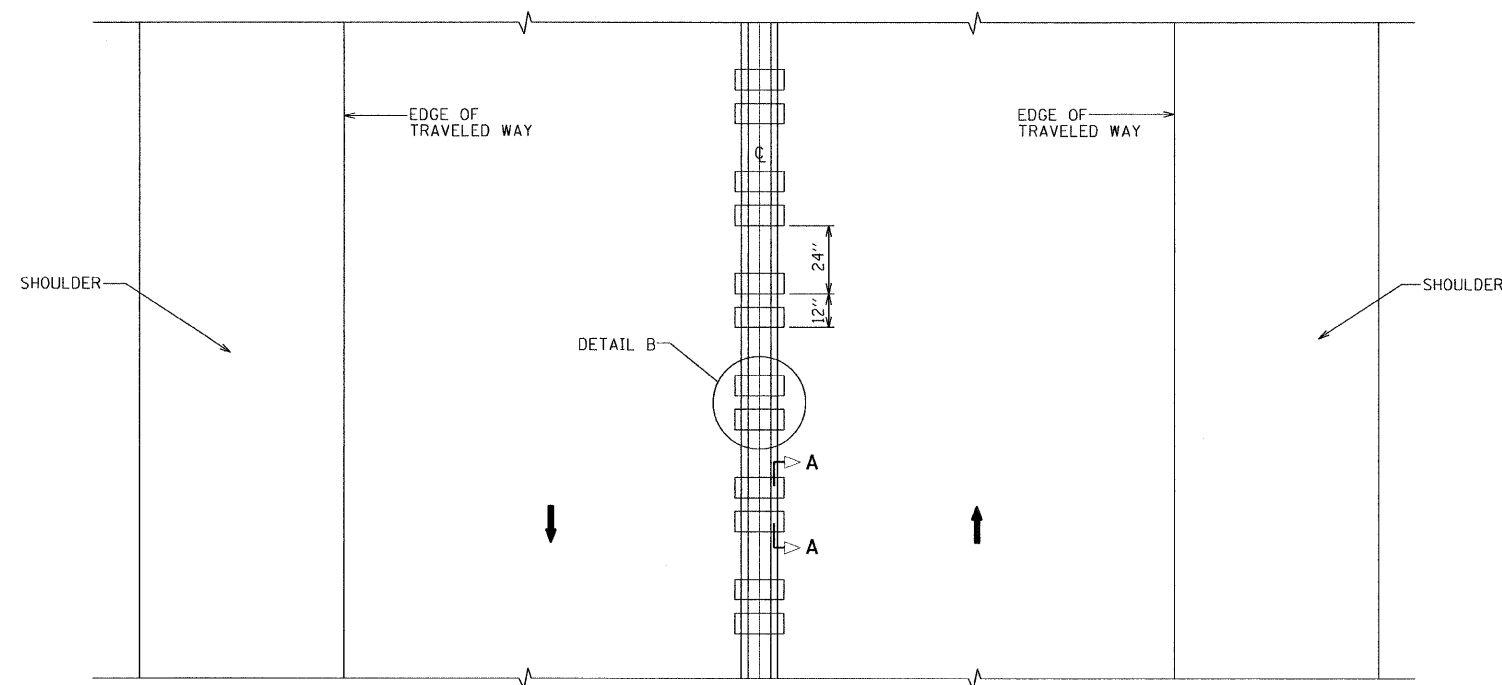

TWO-WAY ROAD

GENERAL NOTES:
 SEE STANDARD 780001 FOR OTHER STRIPING LAYOUTS.
 RUMBLE STRIPS SHALL NOT BE PLACED ON BRIDGES.
 ALL RUMBLE STRIPS SHALL BE MILLED.
 CENTERLINE RUMBLE STRIPS SHALL BE CONTINUOUS THROUGH CONNECTIONS OF SIDEROADS WITH NO LEFT TURN LANES.
 DISCONTINUE CENTERLINE RUMBLE STRIPS THROUGH THE LIMITS OF ALL LEFT TURN LANES, INCLUDING ANY LANE TAPER SECTIONS.
 WHERE USED, ADJUST SPACING OF RAISED REFLECTIVE PAVEMENT MARKERS TO FALL IN WIDER GAP BETWEEN RUMBLE STRIPS.
 CENTERLINE RUMBLE STRIPES TO BE PAID FOR AS CENTER LINE - RUMBLE STRIP AND THERMOPLASTIC PAVEMENT MARKING LINE 4".

FILE NAME = #FILE#	USER NAME = .USER.	DESIGNED - EF	REVISED -	STATE OF ILLINOIS DEPARTMENT OF TRANSPORTATION	IL 19 - EAST OF DES PLAINES RIVER RD TO IL 171 CENTER RUMBLE STRIPE DETAIL	F.A.P. RTE.	SECTION	COUNTY	TOTAL SHEETS	SHEET NO.	
	PLOT SCALE = 40,0000' / IN.	DRAWN - EF	REVISED -			345	2010-118-1	COOK	17	12	
PLOT DATE = 4/11/2011	CHECKED - RS	DATE - 04-12-2011	REVISED -	SCALE: NTS	SHEET NO. 1 OF 1 SHEETS	STA.	TO STA.	ILLINOIS FED. AID PROJECT			
						CONTRACT NO. 60M55					

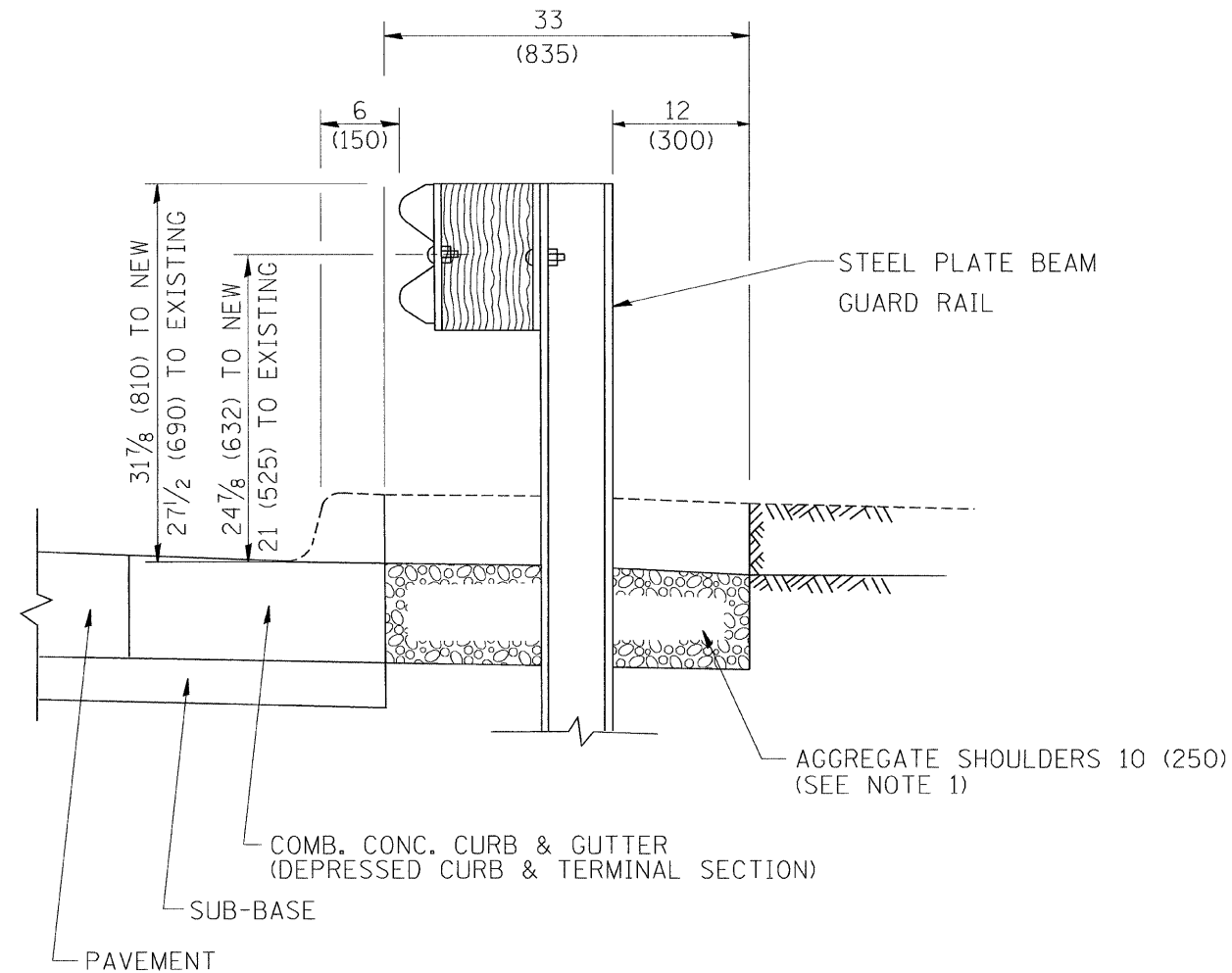

SECTION A-A

- NOTES:
1. THE AGGREGATE SHOULDER, 10" OR HMA SHOULDER, 6" (IF REQUIRED) SHALL EXTEND UNDER THE TRAFFIC BARRIER TERMINAL.
 2. "EXISTING" GUARDRAIL REFERS TO CONNECTING TERMINAL SECTION TO GUARD RAILING PRIOR TO THE MIDWEST GUARDRAIL SYSTEM.
 3. THE CONTRACTOR SHALL VERIFY THE TYPE/HEIGHT OF GUARDRAIL IN-PLACE BEFORE ORDERING THE NEW TERMINAL SECTION. COST INCLUDED WITH THE COST OF THE TERMINAL. THE TERMINAL SECTION HEIGHT TO BE PLACED MUST MATCH THE HEIGHT OF THE IN-PLACE GUARDRAIL.

DETAILS FOR STEEL PLATE BEAM
 GUARD RAIL ADJACENT TO CURB AND GUTTER
 [FOR ROADWAY SPEED 35 MPH (60 kmh) TO 45 MPH (70 kmh)]

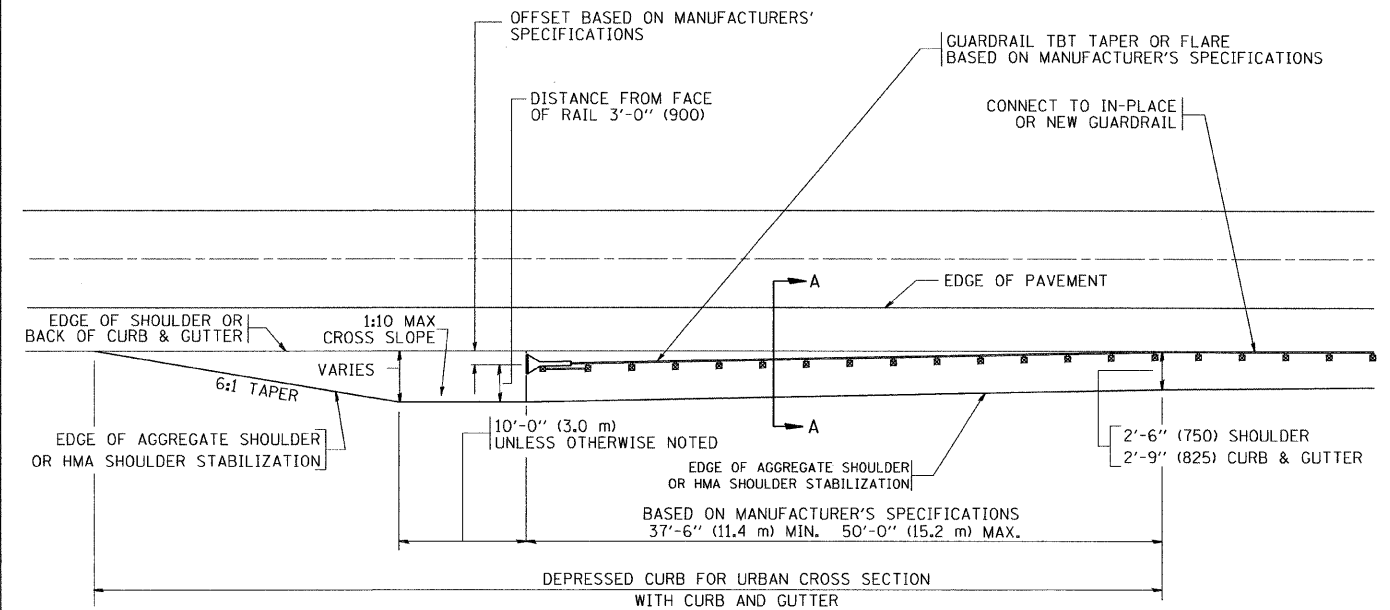

DEPRESSED CURB AND GUTTER AND
 SHOULDER TREATMENT AT TBT TY. 1 SPL.

BASIS OF PAYMENT: HMA SHOULDERS 6 (150) (IF REQUIRED) WILL BE PAID FOR AT THE CONTRACT UNIT PRICE PER SQUARE YARD (SQUARE METER) FOR "HOT-MIX ASPHALT SHOULDERS 6" (150 mm)".

STEEL PLATE BEAM GUARD RAIL AND TRAFFIC BARRIER TERMINAL, OF THE TYPE SPECIFIED WILL BE PAID FOR SEPARATELY.

TBT = TRAFFIC BARRIER TERMINAL

ALL DIMENSIONS ARE IN INCHES (MILLIMETERS) UNLESS OTHERWISE SHOWN.

FILE NAME =	USER NAME = drivakosgn	DESIGNED - M. DE YONG	REVISED - E. GOMEZ 08-28-00
ct:\pwork\PIWIDOT\DR\IVAKOSGN\d0108315\bd34.dgn		DRAWN -	REVISED - R. BORO 01-01-07
	PLOT SCALE = 49.9999 1 / IN.	CHECKED -	REVISED - R. BORO 12-08-2008
	PLOT DATE = 9/21/2009	DATE - 09-22-90	REVISED - R. BORO 09-14-2009

STATE OF ILLINOIS
 DEPARTMENT OF TRANSPORTATION

DETAILS FOR DEPRESSED CURB & GUTTER AND
 SHOULDER TREATMENT AT TBT TY 1 SPL.

SCALE: NONE SHEET NO. 1 OF 1 SHEETS STA. TO STA.

F.A.P. RTE.	SECTION	COUNTY	TOTAL SHEETS	SHEET NO.
345	2010-118-I	COOK	17	13
BD600-10 (BD 34)		CONTRACT NO. 60M55		
FED. ROAD DIST. NO. 1 ILLINOIS FED. AID PROJECT				

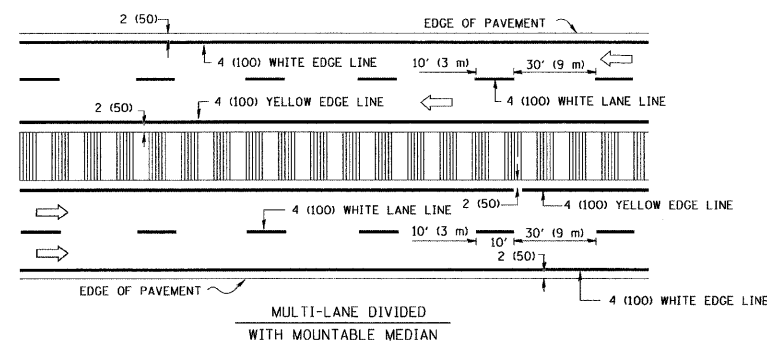
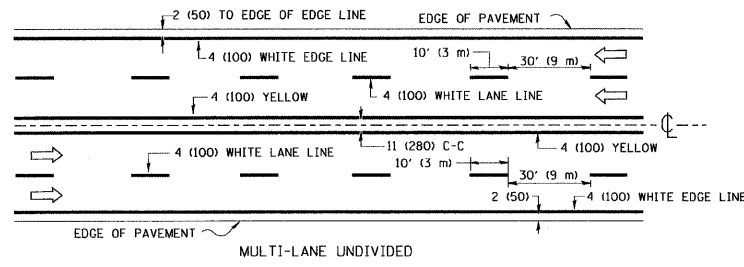
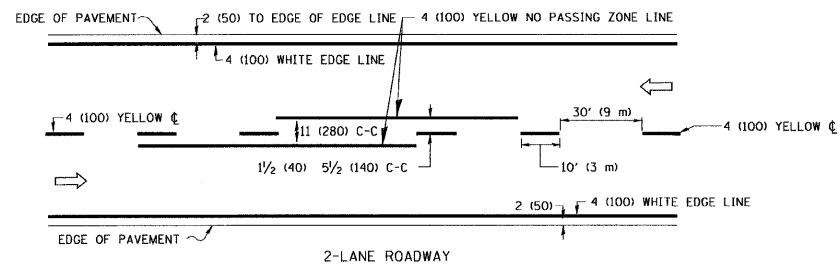

NOTE: MEDIANS WITH BARRIER CURB DO NOT REQUIRE AN EDGE LINE

TYPICAL LANE AND EDGE LINE MARKING

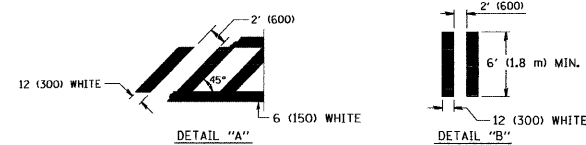
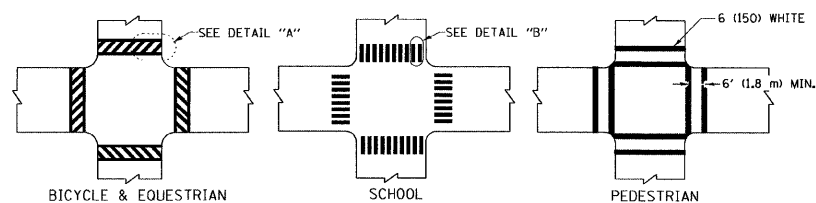

TYPICAL CROSSWALK MARKING

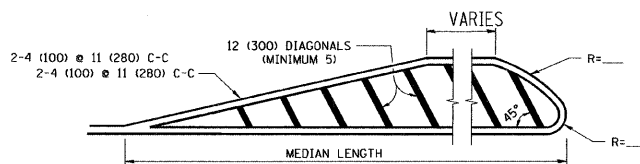
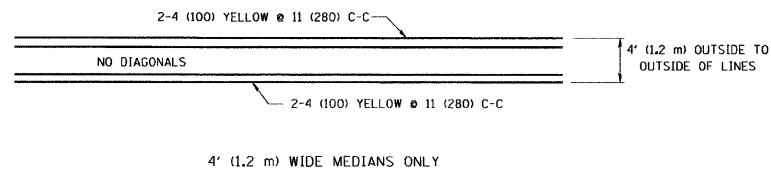

FOR MEDIAN LENGTHS WHERE DIAGONAL SPACING CANNOT BE ATTAINED, USE 5 (FIVE) EQUALLY SPACED DIAGONAL LINES.
 DIAGONAL LINE SPACING: 50' (15 m) C-C (LESS THAN 30MPH (50 km/h))
 75' (25 m) C-C 30MPH (50 km/h) TO 45MPH (70 km/h)
 150' (45 m) C-C (MORE THAN 45MPH (70 km/h))

MEDIANS OVER 4' (1.2 m) WIDE

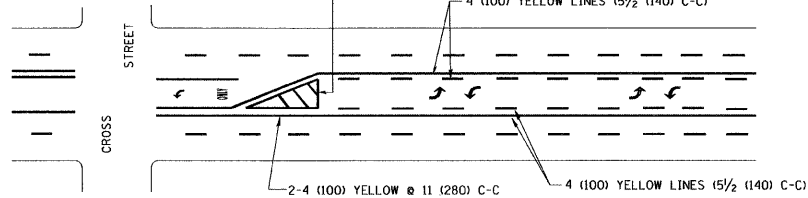

A MINIMUM OF TWO PAIRS OF TURN ARROWS SHALL BE USED, WHITE IN COLOR. ADDITIONAL PAIRS SHALL BE PLACED AT 200' (60 m) TO 300' (90 m) INTERVALS.

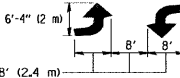

MEDIAN WITH TWO-WAY LEFT TURN LANE

TYPICAL PAINTED MEDIAN MARKING

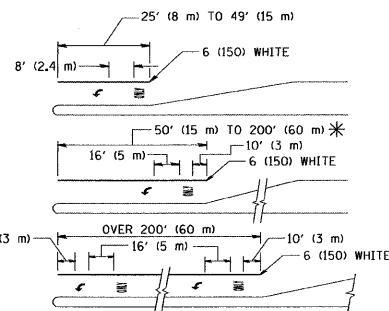

FULL SIZE LETTERS 8' (2.4 m) AND ARROWS SHALL BE USED.
 AREA = 15.6 SQ. FT. (1.5 m²) ONLY AREA = 20.8 SQ. FT. (1.9 m²)
 * TURN LANES IN EXCESS OF 400' (120 m) IN LENGTH MAY HAVE AN ADDITIONAL SET OF ARROW - "ONLY" INSTALLED MIDWAY BETWEEN THE OTHER TWO SETS OF ARROW - "ONLY".

TYPICAL LEFT (OR RIGHT) TURN LANE

TYPICAL TURN LANE MARKING

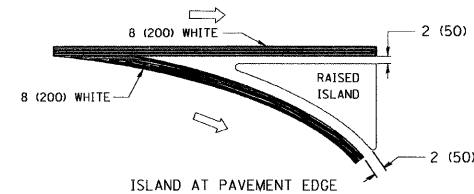
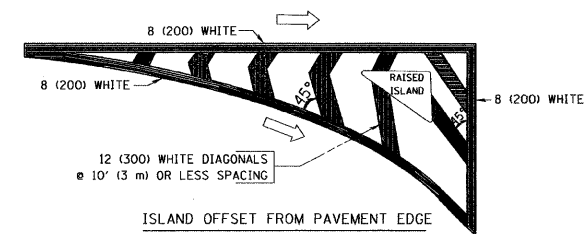

TYPICAL ISLAND MARKING

TYPE OF MARKING	WIDTH OF LINE	PATTERN	COLOR	SPACING / REMARKS
CENTERLINE ON 2 LANE PAVEMENT	4 (100)	SKIP-DASH	YELLOW	10' (3 m) LINE WITH 30' (9 m) SPACE
CENTERLINE ON MULTI-LANE UNDIVIDED PAVEMENT	2 @ 4 (100)	SOLID	YELLOW	11 (280) C-C
NO PASSING ZONE LINES: FOR ONE DIRECTION FOR BOTH DIRECTIONS	4 (100) 2 @ 4 (100)	SOLID SOLID	YELLOW YELLOW	5/2 (140) C-C FROM SKIP-DASH CENTERLINE 11 (280) C-C OMIT SKIP-DASH CENTERLINE BETWEEN
LANE LINES	4 (100) 5 (125) ON FREEWAYS	SKIP-DASH SKIP-DASH	WHITE WHITE	10' (3 m) LINE WITH 30' (9 m) SPACE
DOTTED LINES (EXTENSIONS OF CENTER, LANE OR TURN LANE MARKINGS)	SAME AS LINE BEING EXTENDED	SKIP-DASH	SAME AS LINE BEING EXTENDED	2' (600) LINE WITH 6' (1.8 m) SPACE
EDGE LINES	4 (100)	SOLID	YELLOW-LEFT WHITE-RIGHT	OUTLINE MOUNTABLE MEDIANS IN YELLOW; EDGE LINES ARE NOT USED NEXT TO BARRIER CURB
TURN LANE MARKINGS	6 (150) LINE; FULL SIZE LETTERS & SYMBOLS (8' (2.4m))	SOLID	WHITE	SEE TYPICAL TURN LANE MARKING DETAIL
TWO WAY LEFT TURN MARKING	2 @ 4 (100) EACH DIRECTION 8' (2.4m) LEFT ARROW	SKIP-DASH AND SOLID IN PAIRS	YELLOW WHITE	10' (3 m) LINE WITH 30' (9 m) SPACE FOR SKIP-DASH; 5/2 (140) C-C BETWEEN SOLID LINE AND SKIP-DASH LINE SEE TYPICAL TWO-WAY LEFT TURN MARKING DETAIL
CROSSWALK LINES (PEDESTRIAN) A. DIAGONALS (BIKE & EQUESTRIAN) B. LONGITUDINAL BARS (SCHOOL)	2 @ 6 (150) 12 (300) @ 45° 12 (300) @ 90°	SOLID SOLID SOLID	WHITE WHITE WHITE	NOT LESS THAN 6' (1.8 m) APART 2' (600) APART 2' (600) APART SEE TYPICAL CROSSWALK MARKING DETAILS.
STOP LINES	24 (600)	SOLID	WHITE	PLACE 4' (1.2 m) IN ADVANCE OF AND PARALLEL TO CROSSWALK, IF PRESENT, OTHERWISE, PLACE AT DESIRED STOPPING POINT, PARALLEL TO CROSSROAD CENTERLINE, WHERE POSSIBLE
PAINTED MEDIANS	2 @ 4 (100) WITH 12 (300) DIAGONALS @ 45° NO DIAGONALS USED FOR 4' (1.2 m) WIDE MEDIANS	SOLID	YELLOW; TWO WAY TRAFFIC WHITE; ONE WAY TRAFFIC	11 (280) C-C FOR THE DOUBLE LINE SEE TYPICAL PAINTED MEDIAN MARKING.
CORE MARKING AND CHANNELIZING LINES	8 (200) WITH 12 (300) DIAGONALS @ 45°	SOLID	WHITE	DIAGONALS: 15' (4.5 m) C-C (LESS THAN 30MPH (50 km/h)) 20' (6 m) C-C 30MPH (50 km/h) TO 45MPH (70 km/h) 30' (9 m) C-C (OVER 45MPH (70 km/h))
RAILROAD CROSSING	24 (600) TRANSVERSE LINES; "RR" IS 6' (1.8 m) LINE FOR "X"	SOLID	WHITE	SEE STATE STANDARD 780001 AREA OF: "R"=3.6 SQ. FT. (0.33 m ²) EACH "X"=54.0 SQ. FT. (5.0 m ²)
SHOULDER DIAGONALS	12 (300) @ 45°	SOLID	WHITE - RIGHT YELLOW - LEFT	50' (15 m) C-C (LESS THAN 30MPH (50 km/h)) 75' (25 m) C-C (30 MPH (50 km/h) TO 45MPH (70 km/h)) 150' (45 m) C-C (OVER 45MPH (70 km/h))

FOR FURTHER DETAILS ON PAVEMENT MARKING REFER TO STANDARD SPECIFICATIONS FOR ROAD AND BRIDGE CONSTRUCTION AND STATE STANDARD 780001.

All dimensions are in inches (millimeters) unless otherwise shown.

FILE NAME =	USER NAME = drivakosgn	DESIGNED - EVERS	REVISED -T, RAMMACHER 10-27-94	STATE OF ILLINOIS DEPARTMENT OF TRANSPORTATION	DISTRICT ONE TYPICAL PAVEMENT MARKINGS	F.A.P. RTE.	SECTION	COUNTY	TOTAL SHEETS	SHEET NO.
ct:\pe_work\pwidot\drivakosgn\d0108315\to	3.dgn	DRAWN -	REVISED -C, JUCIUS 09-09-09			345	2010-118-I	COOK	17	16
PLOT SCALE = 50.000 ' / IN.	CHECKED -	REVISIED -				TC-13		CONTRACT NO. 60M55		
PLOT DATE = 9/9/2009	DATE - 03-19-90	REVISED -				SCALE: NONE	SHEET NO. 1 OF 1 SHEETS	STA. TO STA.	FED. ROAD DIST. NO. 1	ILLINOIS FED. AID PROJECT

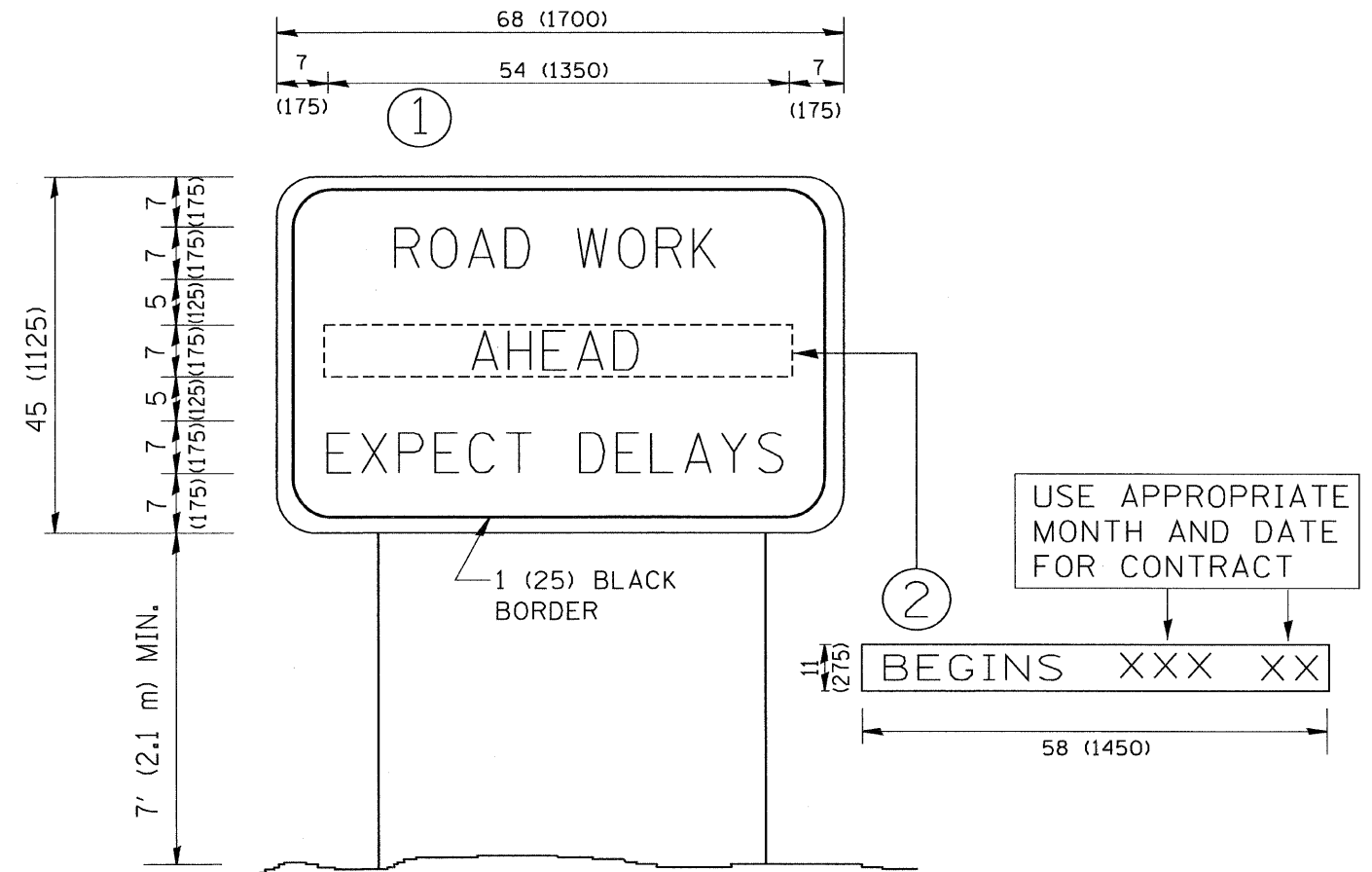

NOTES:

1. USE BLACK LETTERING ON ORANGE BACKGROUND.
2. ERECT SIGNS IN ADVANCE OF THE LOCATION FOR THE "ROAD CONSTRUCTION AHEAD" SIGN AT LOCATIONS AS DIRECTED BY THE ENGINEER.
3. ERECT SIGN ① WITH INSTALLED PANEL ② ONE WEEK PRIOR TO THE START OF CONSTRUCTION.
4. REMOVE PANEL ② SOON AFTER THE START OF CONSTRUCTION.
5. SEE SPECIAL PROVISION FOR "TEMPORARY INFORMATION SIGNING" FOR ADDITIONAL INFORMATION.
6. ONE SIGN ASSEMBLY EQUALS 25.70 SQ. FT. (2.3 SQ. M.)
7. SHALL BE PAID FOR AS TEMPORARY INFORMATION SIGNING.

ALL DIMENSIONS ARE IN INCHES (MILLIMETERS) UNLESS OTHERWISE SHOWN.

FILE NAME - M:\diststd\22x34\to22.dgn	USER NAME - gaglionobt	DESIGNED -	REVISED - R. MIRS 09-15-97	STATE OF ILLINOIS DEPARTMENT OF TRANSPORTATION	ARTERIAL ROAD INFORMATION SIGN			F.A.P. RTE.	SECTION	COUNTY	TOTAL SHEETS	SHEET NO.
	PLOT SCALE = 50.000' / IN.	DRAWN -	REVISED - R. MIRS 12-11-97		345	2010-118-I	COOK	17	17			
	PLOT DATE = 1/4/2008	CHECKED -	REVISED - T. RAMMACHER 02-02-99		TC-22			CONTRACT NO. 60M55				
		DATE -	REVISED - C. JUCIUS 01-31-07		SCALE: NONE	SHEET NO. 1 OF 1 SHEETS	STA.	TO STA.		FED. ROAD DIST. NO. 1 ILLINOIS FED. AID PROJECT		