

NOTE: Skew angle shown for Pier 39 (Exist.) to Pier 33 (Exist.) are measured from \odot Pier to a tangent to curve (TC) at \odot Pier stations along Ramp D \odot .

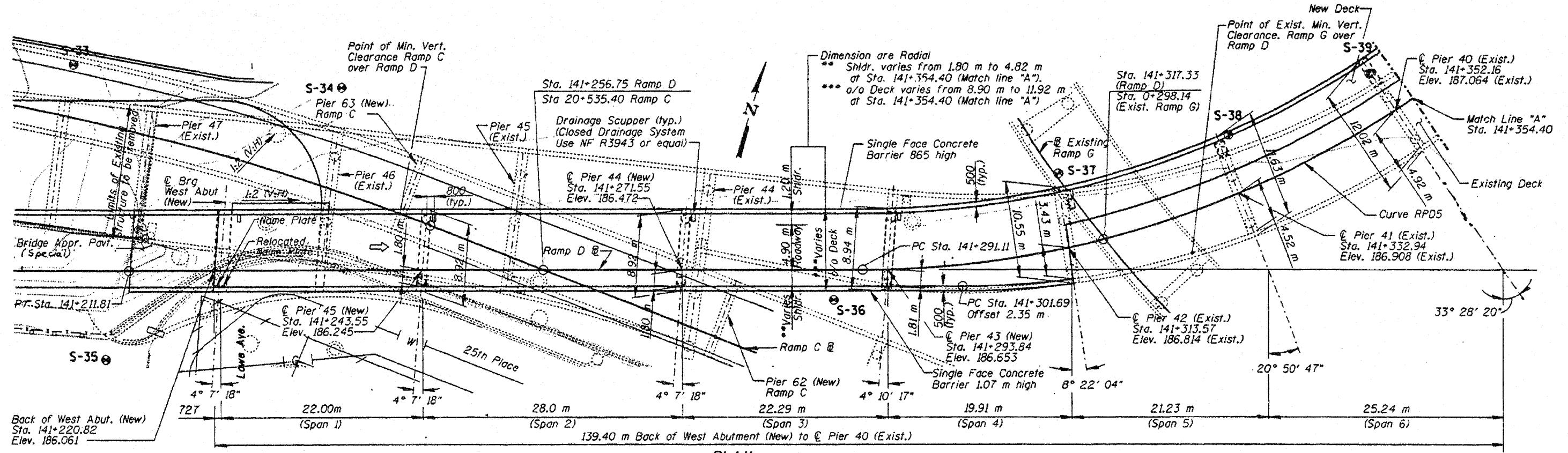

PLAN

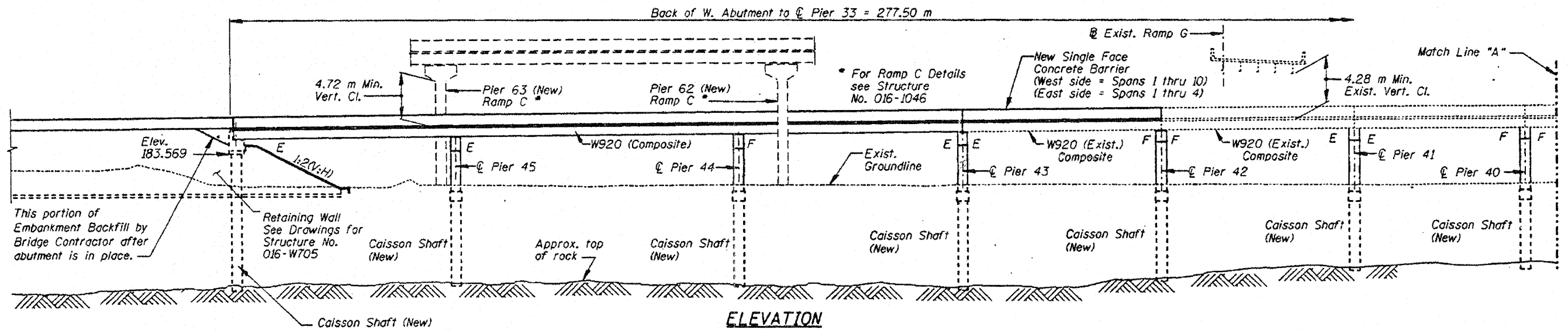

ELEVATION

FILE NAME =	USER NAME = rgal	DESIGNED - AMR	REVISED -	STATE OF ILLINOIS DEPARTMENT OF TRANSPORTATION	GENERAL PLAN & ELEVATION - LOCATION 8 STRUCTURE NO. 016-1059			F.A.I. RTE. 94	SECTION 2010-127-BP	COUNTY COOK	TOTAL SHEETS 160	SHEET NO. 118
PLOT SCALE = 1/8" = 1' IN.	PLOT DATE = 3/28/2011	DRAWN - AMR	REVISED -		SCALE: NTS	SHEET NO. 1 OF 9 SHEETS	STA.	TO STA.	CONTRACT NO. 60N01			
CHECKED - JMH	DATE - MARCH, 2011	REVISED -	REVISED -		ILLINOIS FED. AID PROJECT							