

IL. ROUTE 53

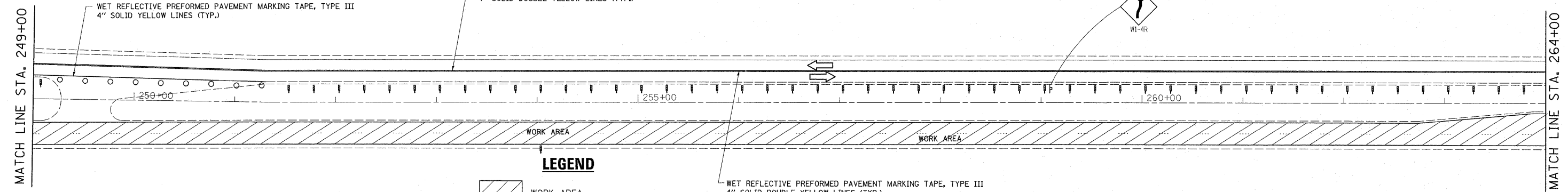

**LEGEND**

- WORK AREA
- VERTICAL PANEL (BACK TO BACK)
- TYPE III BARRICADE WITH FLASHING LIGHT
- TYPE II BARRICADE OR DRUM WITH MONO-DIRECTIONAL STEADY BURN LIGHT, 25' C-C
- SIGN
- DIRECTION OF TRAFFIC FLOW
- MONODIRECTIONAL FLASHING BEACON
- ARROW BOARD
- DIRECTION INDICATOR BARRICADE WITH STEADY BURN MONODIRECTIONAL LIGHT
- TEMPORARY PAVEMENT

**NOTES**

THE ROAD CONSTRUCTION AHEAD SIGN SHALL BE LOCATED ONE MILE IN ADVANCE OF THE PROJECT LIMITS PER STANDARD 701431.

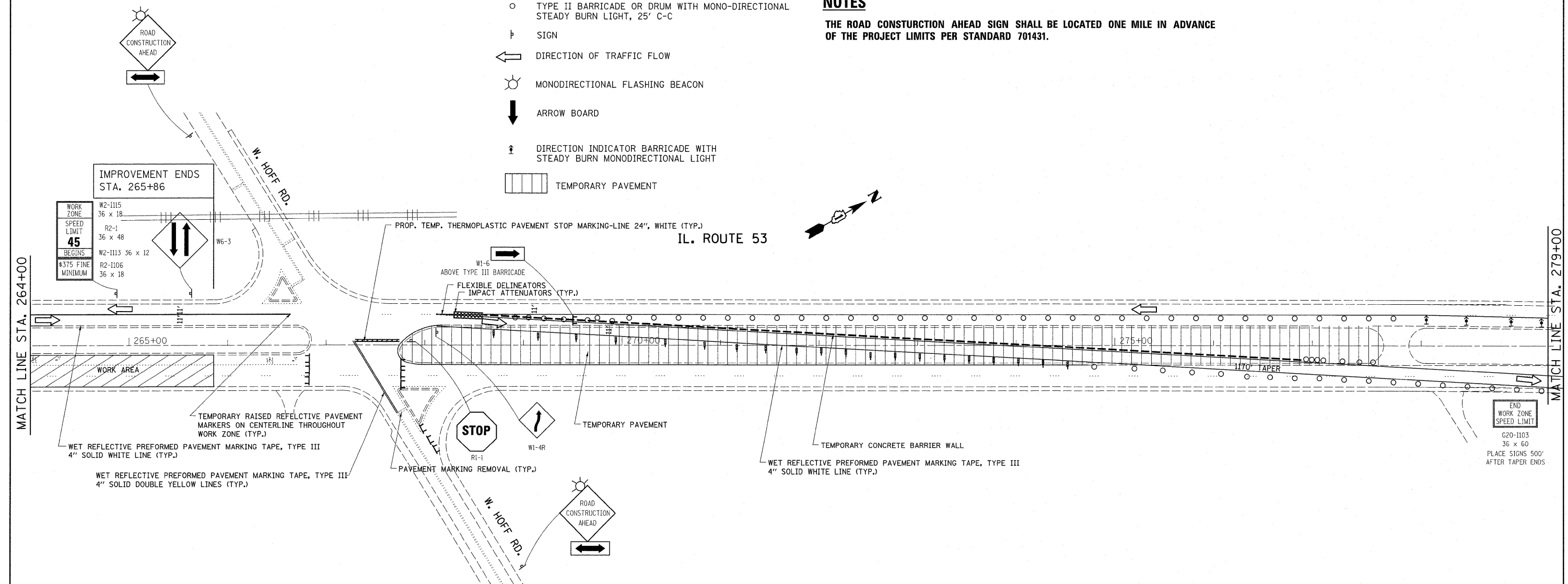

FILE NAME =	USER NAME = qureshiya	DESIGNED -	REVISED -	<b>STATE OF ILLINOIS DEPARTMENT OF TRANSPORTATION</b>	<b>SUGGESTED TRAFFIC CONTROL STAGE ONE</b>			F.A.P. RTE.	SECTION	COUNTY	TOTAL SHEETS	SHEET NO.	
c:\p_w\work\p\dot\qureshiya\d0255746\012211-shr-p1.dgn	PLOT SCALE = 50.0000' / IN.	DRAWN -	REVISED -		SCALE:	SHEET NO. 9 OF 20 SHEETS	STA.	TO STA.	846	4-RS-4	WILL	25	15
PLOT DATE = 5/25/2011	DATE -	CHECKED -	REVISED -		CONTRACT NO. 60N05								
		DATE -	REVISED -		ILLINOIS FED. AID PROJECT								