

STATE OF ILLINOIS  
DEPARTMENT OF TRANSPORTATION  
DIVISION OF HIGHWAYS  
**PROPOSED  
HIGHWAY PLANS**

F.A.P. 846 (ILL 53)  
SECTION 4-RS-4  
HOFF RD. TO ARSENAL RD.  
RESURFACING  
WILL COUNTY  
C-91-222-11

FOR INDEX OF SHEETS, SEE SHEET NO. 2

THE IMPROVEMENT IS LOCATED  
WITHIN UNINCORPORATED WILL COUNTY

OMISSION  
STA. 114+71 TO STA. 115+72

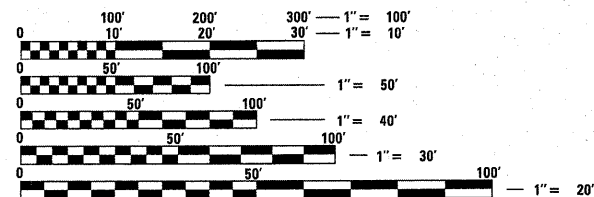

FULL SIZE PLANS HAVE BEEN PREPARED USING STANDARD ENGINEERING SCALES. REDUCED SIZED PLANS WILL NOT CONFORM TO STANDARD SCALES. IN MAKING MEASUREMENTS ON REDUCED PLANS, THE ABOVE SCALES MAY BE USED.

J.U.L.I.E.  
JOINT UTILITY LOCATION INFORMATION FOR EXCAVATION  
1-800-892-0123  
OR 811

PROJECT ENGINEER: JENPAI CHANG (847) 705-4432  
PROJECT MANAGER: KEN ENG (847) 702-4247

**CONTRACT NO. 60N05**

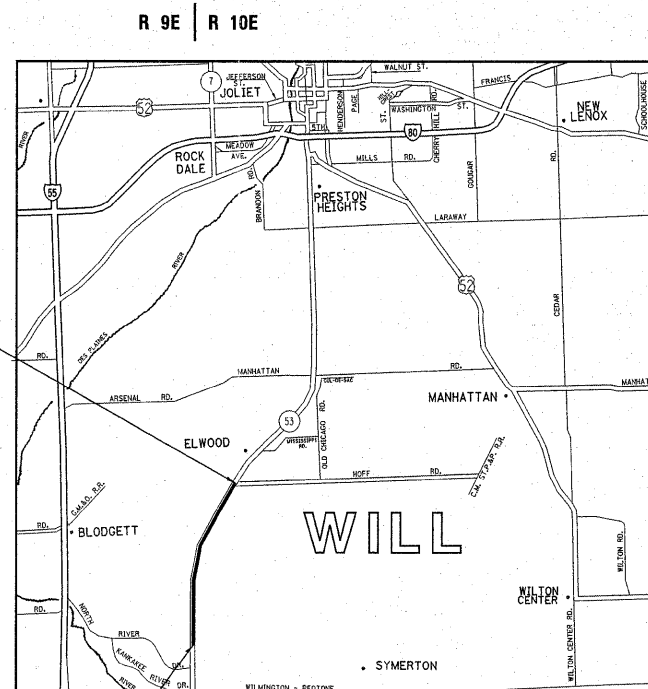

END PROJECT  
STA. 265+86

T 34N  
T 33N

BEGIN PROJECT  
STA. 36+76

JACKSON, WILMINGTON AND FLORENCE TOWNSHIPS

GROSS LENGTH OF PROJECT = 22,910 FT = 4.34 MI.  
GROSS LENGTH OF PROJECT = 22,809 FT = 4.32 MI.

**TRAFFIC DATA**

2009 ADT - 6,700  
POSTED SPEED LIMIT - 55 MPH

F.A.P. RTE. 846	SECTION 4-RS-4	COUNTY WILL	TOTAL SHEETS 25	SHEET NO. 1
FED. ROAD DIST. NO.		ILLINOIS	CONTRACT NO. 60N05	

# 25 + 17 = 42

D-91-222-11

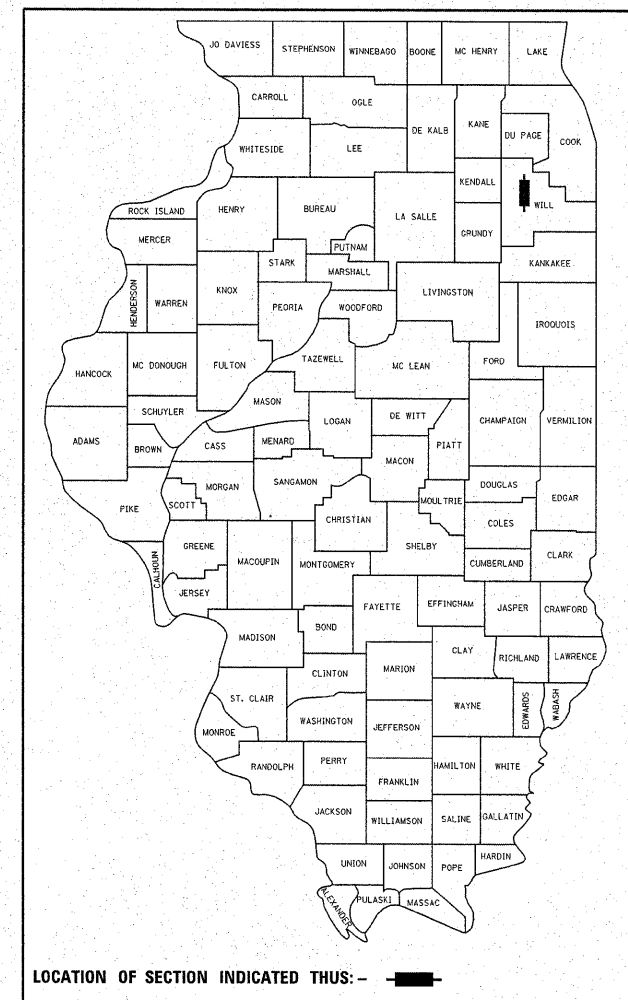

STATE OF ILLINOIS  
DEPARTMENT OF TRANSPORTATION  
DIVISION OF HIGHWAYS

SUBMITTED APRIL 5, 2011

*Diana M. O'Keefe*  
DEPUTY DIRECTOR OF HIGHWAYS, REGION ENGINEER

May 13 2011  
*Scott E. Stitt, P.E.*  
ENGINEER OF DESIGN AND ENVIRONMENT

May 13 2011  
*Christine M. Reed*  
DIRECTOR OF HIGHWAYS, CHIEF ENGINEER

**PRINTED BY THE AUTHORITY  
OF THE STATE OF ILLINOIS**