

**NOTES**

1) A CANTILEVERED SHEET PILING DESIGN DOES NOT APPEAR FEASIBLE AND ADDITIONAL MEMBERS OR OTHER RETENTION SYSTEMS MAY BE NECESSARY. THE CONTRACTOR SHALL SUBMIT A TEMPORARY SOIL RETENTION SYSTEM DESIGN INCLUDING PLAN DETAILS AND CALCULATIONS FOR REVIEW AND ACCEPTANCE BY THE ENGINEER.

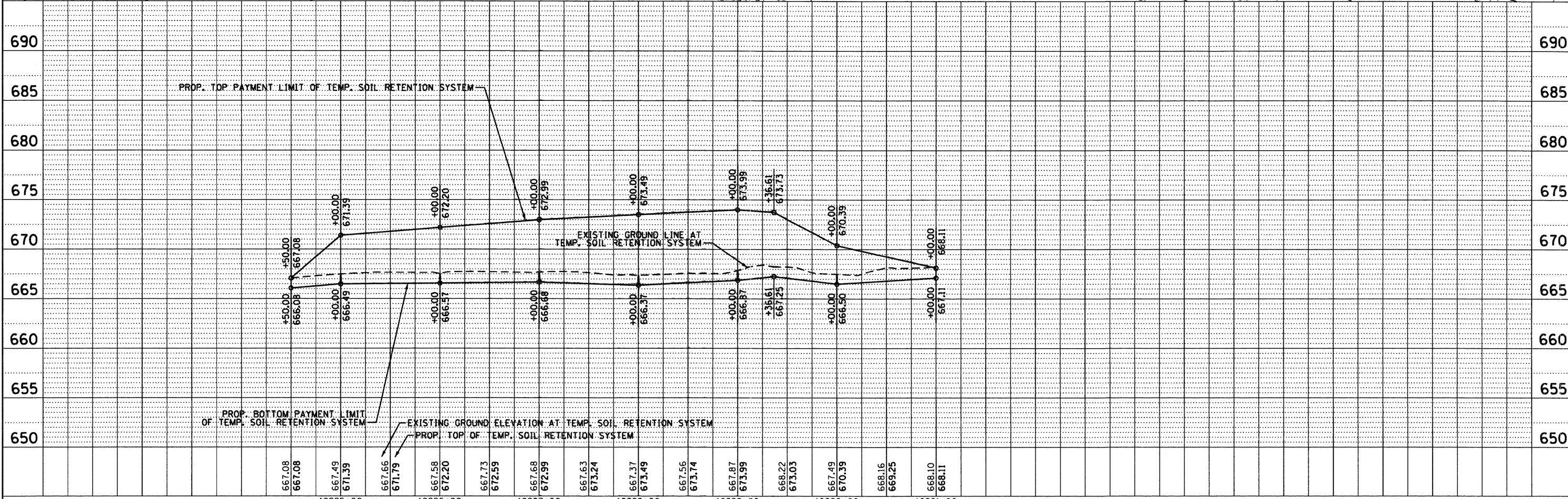
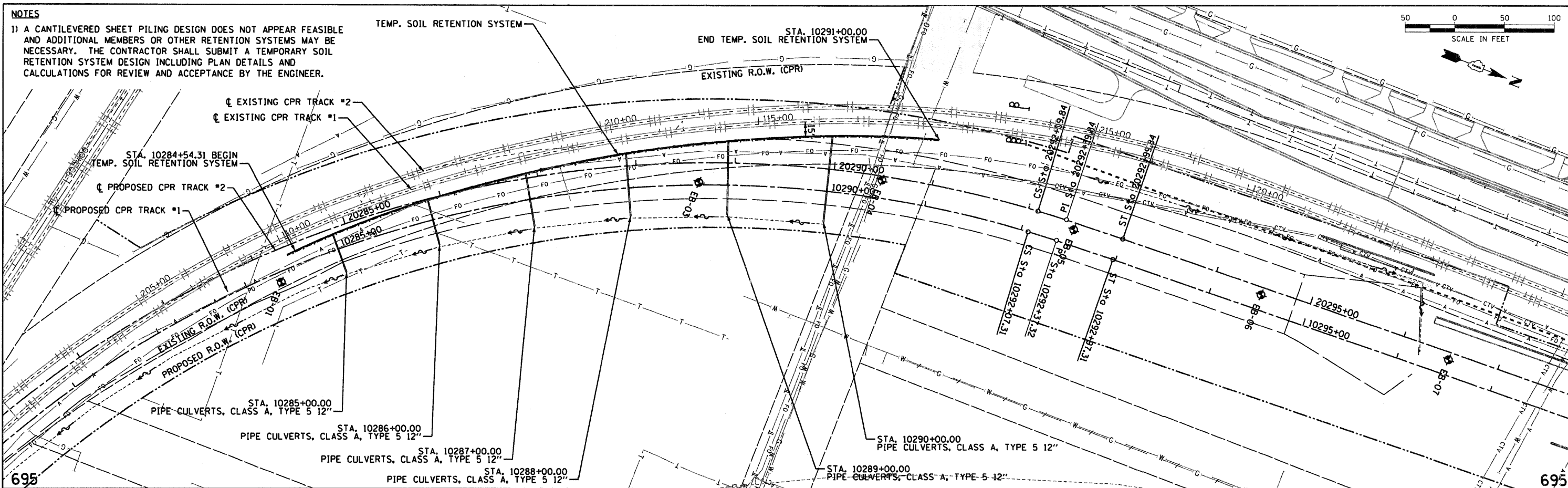
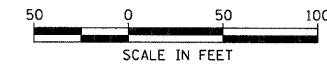

DATE	
BY	
REVISION	
NO.	
PLAN	
NO.	
NOTE BOOK	
NO.	
DATE	
BY	
REVISION	
NO.	
PROFILE	
NO.	
NOTE BOOK	
NO.	
DATE	
BY	
REVISION	
NO.	

DATE	
BY	
REVISION	
NO.	
PROFILE	
NO.	
NOTE BOOK	
NO.	
DATE	
BY	
REVISION	
NO.	