

150 140 130 120 110 100 90 80 70 60 50 40 30 20 10 0 10 20 30 40 50 60 70 80 90 100 110 120 130 140 150

NOTES:
 1) UTILITIES NOT SHOWN ON CROSS SECTIONS.
 SEE UTILITY PLANS FOR LOCATION OF EXISTING UTILITIES.
 2) FOR DESIGN CLARITY NOT ALL PROPOSED FUTURE TRACKS
 (BY OTHERS) ARE SHOWN.
 3) CULVERT INLET AND OUTLET PROTECTION NOT SHOWN.
 SEE EROSION CONTROL PLAN FOR DESIGN DETAILS.

DATE	
BY	
NO.	
FINAL SURVEY	
SKETCHED	
PLOTTED	
NOTE BOOK	
AREAS CHECKED	

DATE	
BY	
NO.	
ORIGINAL SURVEY	
SKETCHED	
PLOTTED	
NOTE BOOK	
AREAS CHECKED	

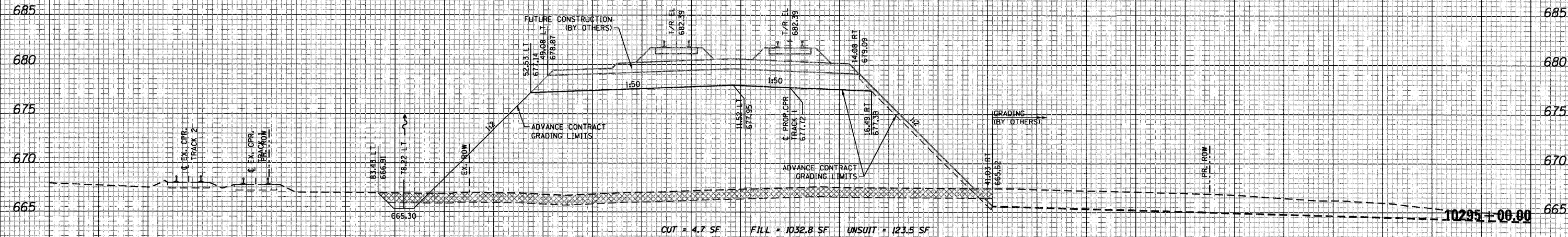
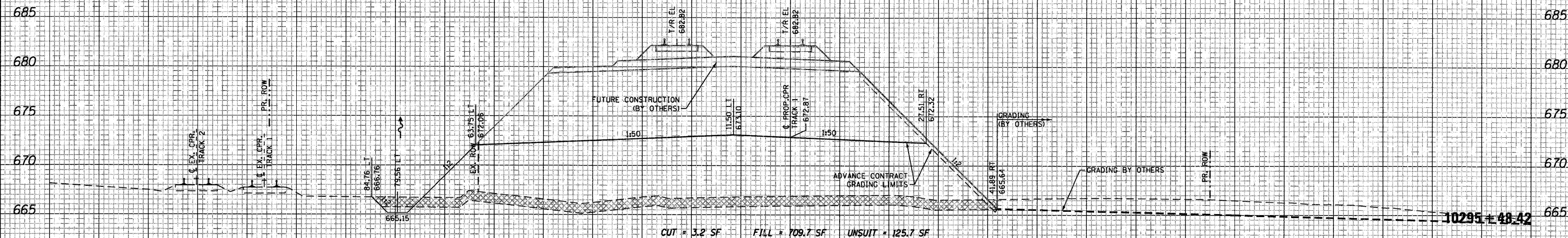

150 140 130 120 110 100 90 80 70 60 50 40 30 20 10 0 10 20 30 40 50 60 70 80 90 100 110 120 130 140 150

FILE NAME = ...\\D160N06-SHT-XSC-Res1.dgn

USER NAME = nratern
 DESIGNED - NMR
 DRAWN - NMR
 CHECKED - LGP
 DATE - 03/17/2011

REVISED -
 REVISED -
 REVISED -
 REVISED -

STATE OF ILLINOIS
 DEPARTMENT OF TRANSPORTATION

CANADIAN PACIFIC RAILWAY CROSS SECTIONS
 SCALE: SHEET NO. 9 OF 10 SHEETS STA. 10295+00.00 TO STA. 10295+48.42

F.A.U. RTE.	SECTION	COUNTY	TOTAL SHEETS	SHEET NO.
1321	2010-134-T	DUPAGE	40	39
CONTRACT NO. 60N06			ILLINOIS FED. AID PROJECT	