

IMPROVEMENT BEGINS
STA. 5 + 92.58
OS = 79.06', RT.

IMPROVEMENT ENDS
STA. 18 + 74.83
OS = 28.10', RT.

- 1 EXISTING CB TO BE ADJUSTED
 TYPE 1 FRAM, CLOSED LID
 STA. 9+54.31, O/S=36.29', RT.
 T.G. 428.54
 INV. 424.94(E)
- 2 CB TYP C, 2' DIA.,
 TYPE 8 FRAM & GRATE
 STA. 9+57.33, O/S=48.93', RT.
 T.G. 427.55
 INV. 425.03(W)
- A PROPOSED 15" STORM SEWER,
 CLASS A, TY-1, 15", 9.0' @ 1%

- SEE DETAIL (1)
- 1
- A
- 2

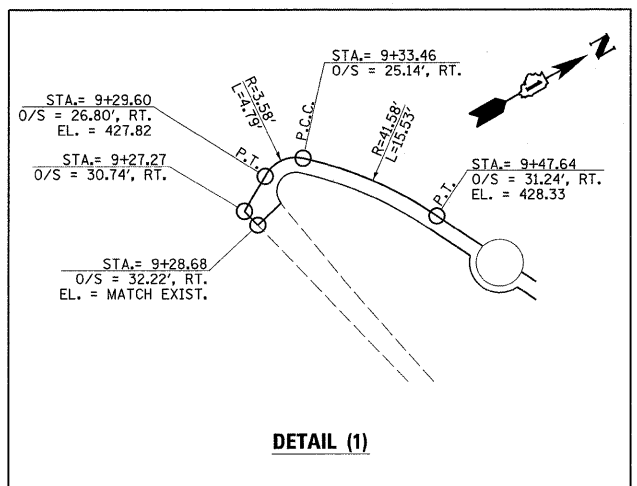

DETAIL (1)

- NOTES:**
- * THE CONTRACTOR SHALL REUSE THE EXISTING LID TYPE 8 GRATE ON THE PROPOSED CATCH BASIN NO.2.
 - * THE CONTRACTOR SHALL REPLACE EXISTING LID TYPE 8 GRATE WITH NEW CLOSED FRAME AND LID TYPE 1.

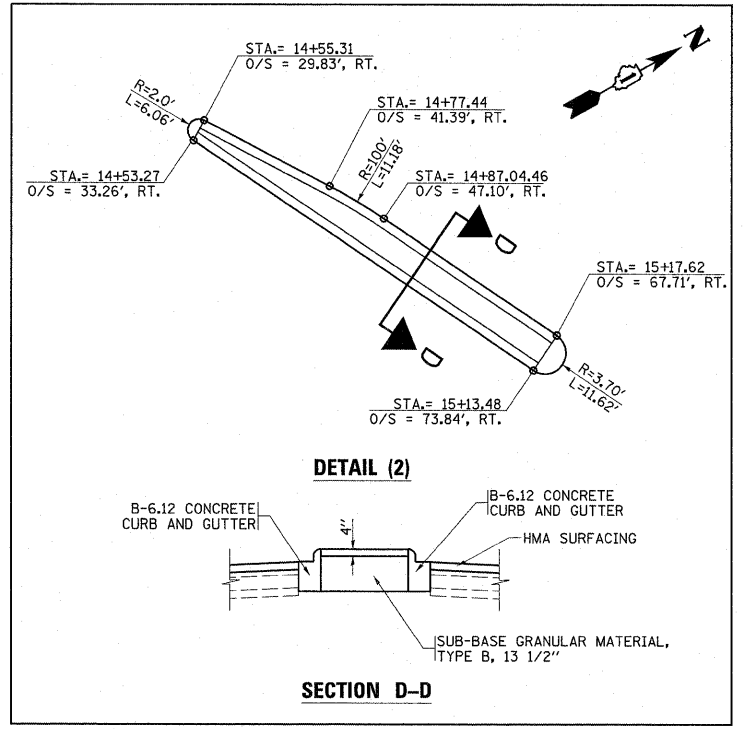

DETAIL (2)

SECTION D-D

FILE NAME =	USER NAME = Hamdaneh	DESIGNED -	REVISED -	STATE OF ILLINOIS DEPARTMENT OF TRANSPORTATION	I-57 AT PRARIE VIEW REST AREA IN PEOTONE PROPOSED PLAN (NORTHBOUND REST AREA)	F.A.I. RTE.	SECTION	COUNTY	TOTAL SHEETS	SHEET NO.	
ca:\pwork\pwork\hamdaneh\08264490\shp\plan.dgn	PLOT SCALE = 50.0000' / IN.	DRAWN -	REVISED -			57	99-1-RA-WRS	WILL	14	8	
	PLOT DATE = 5/11/2011	CHECKED -	REVISED -			CONTRACT NO. 60PO8					
		DATE -	REVISED -			ILLINOIS FED. AID PROJECT					
					SCALE:	SHEET NO. 1 OF 2 SHEETS		STA. TO STA.			